

B.M. 172.93 "4" in 1949 Top of N end of NW cor Oakwood & N Brookside Parkway
 Stationing on R.

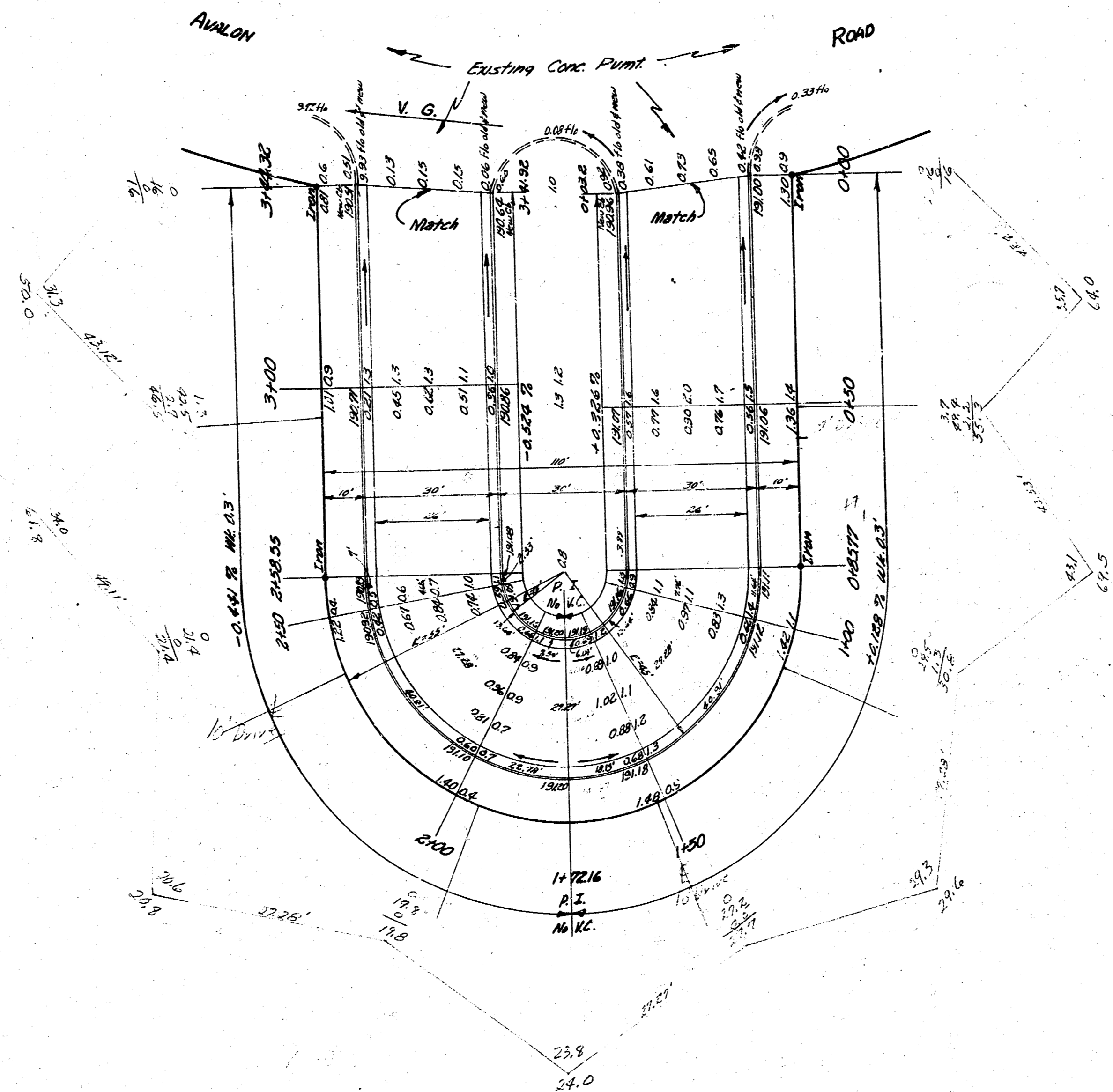

PLS
 K.V.
 K.V.
 1/2
 1/2

Excavation			
City	Sut	PRSP	Fill
0	319.7		0
	14 1/2	25.0	
	Total	351.7	



AVALON COURT
 E.L. AVALON TO E.L. AVALON
 26-2-30 A.C.
 CITY OF WICHITA KANSAS
 B.E. SMITH CITY ENGINEER
 JUNE 1954 PROJ. No. C13-90