

**ARLENE & BATTIN**  
 E.L. Block 4, Prairie Hills Addition-S.L. 25th St. No.  
 DAKS569026

**TYPICAL SECTIONS of 30' ASPHALTIC CONCRETE PAVEMENT**

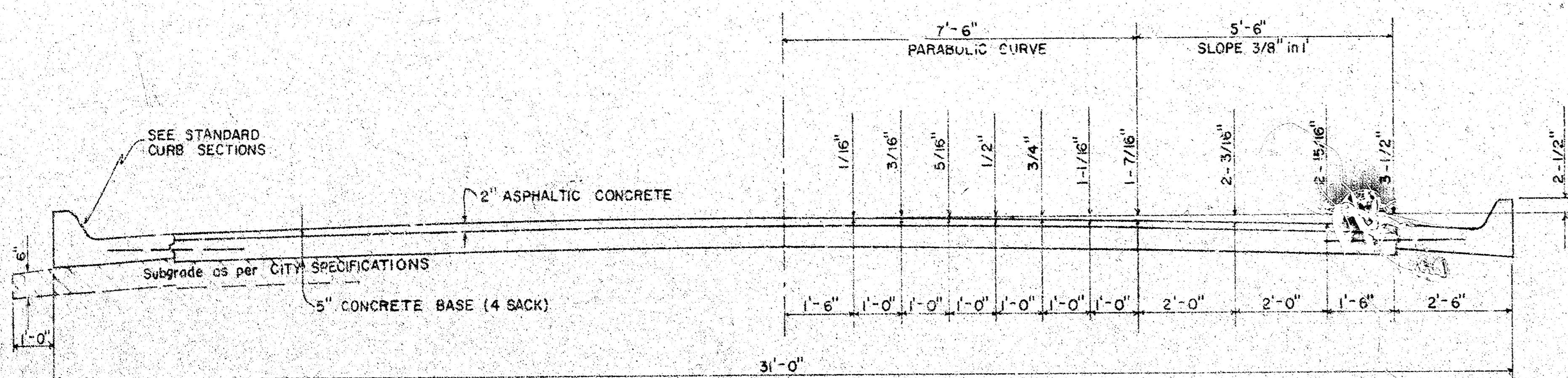

TYPICAL SECTION WITH STANDARD CROWN

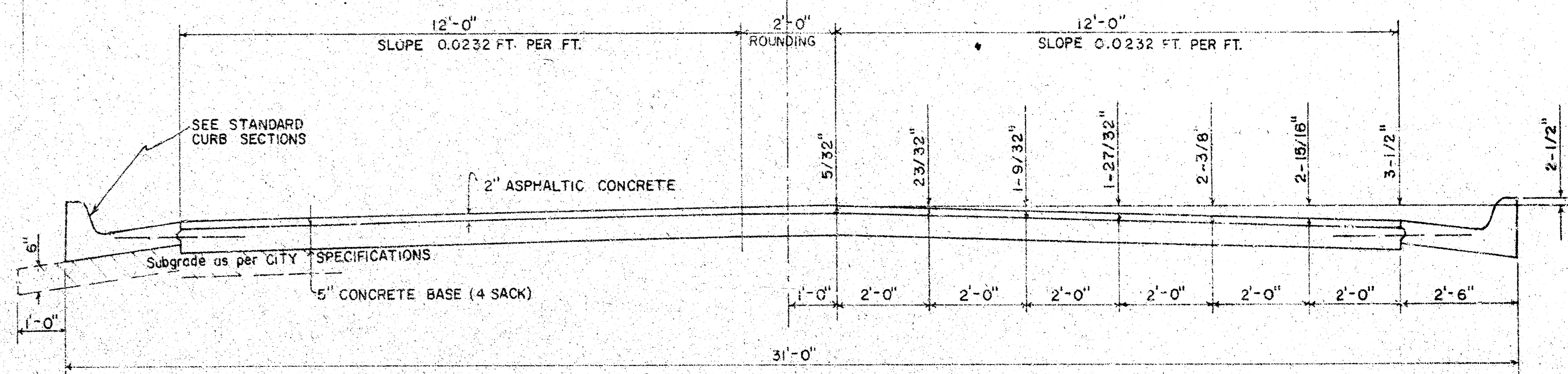

TYPICAL SECTION WITH ALTERNATE CROWN

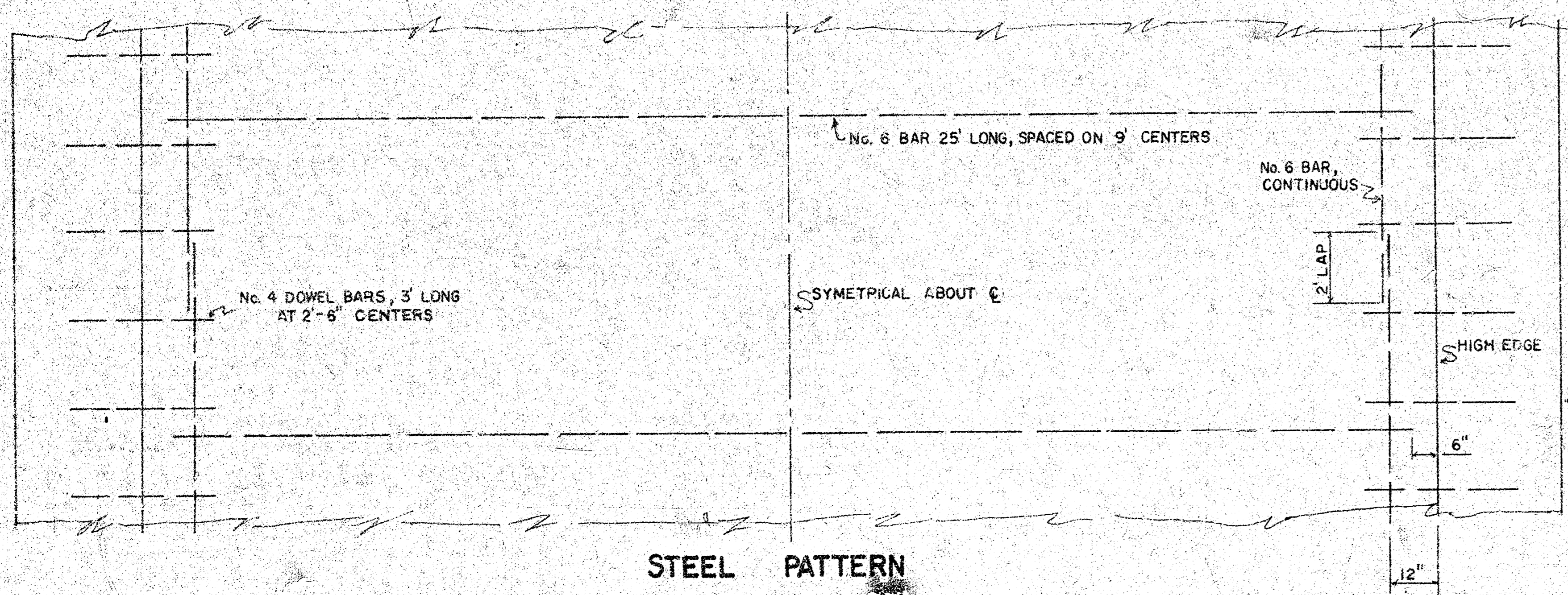

STEEL PATTERN

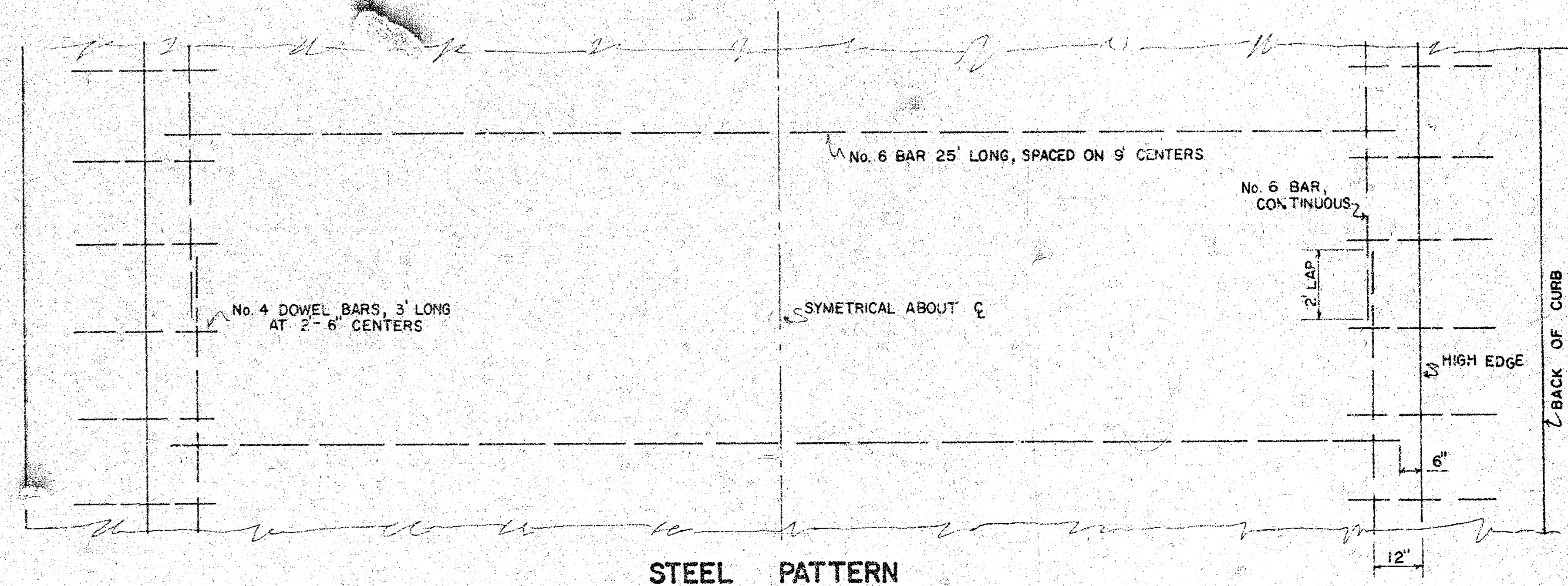

STEEL PATTERN

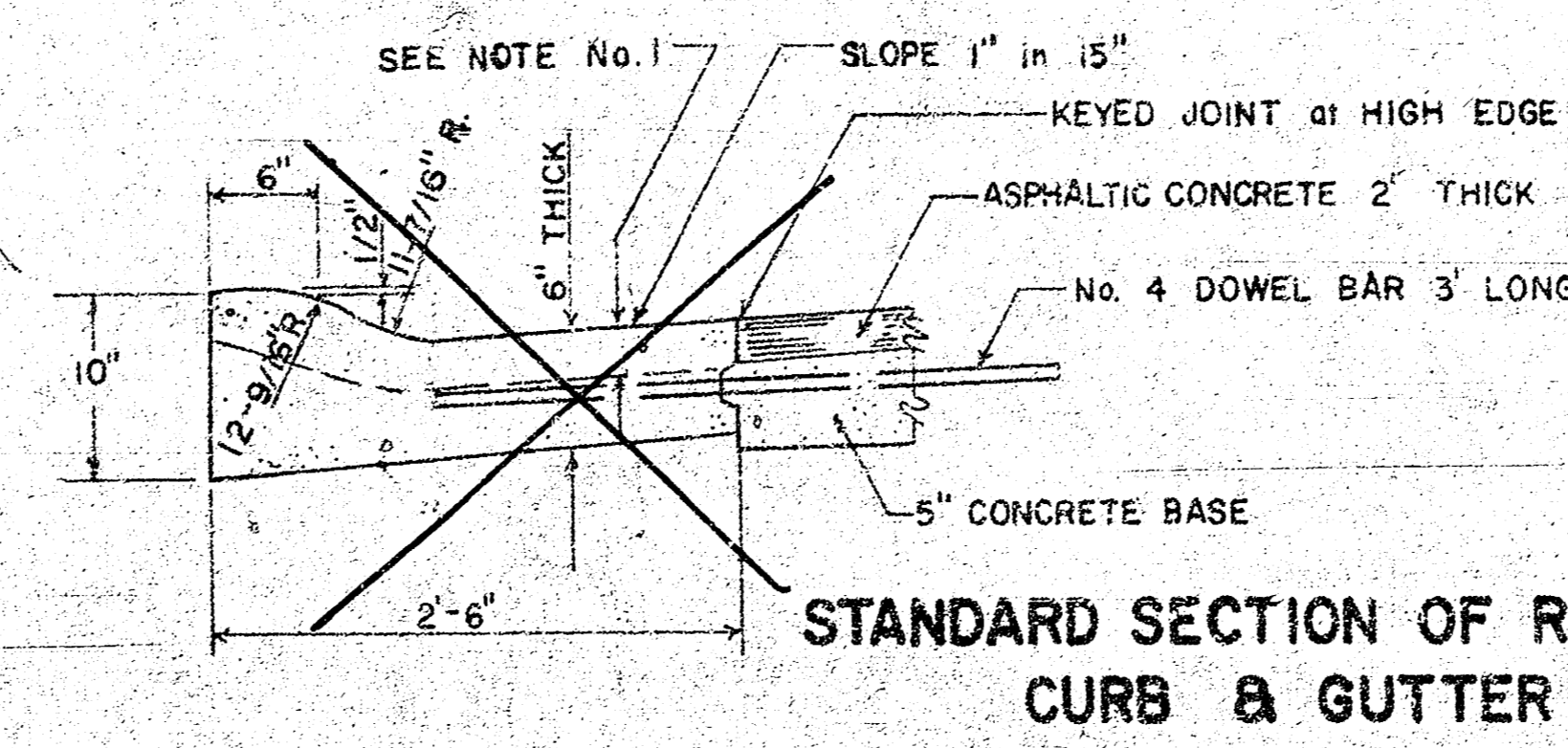
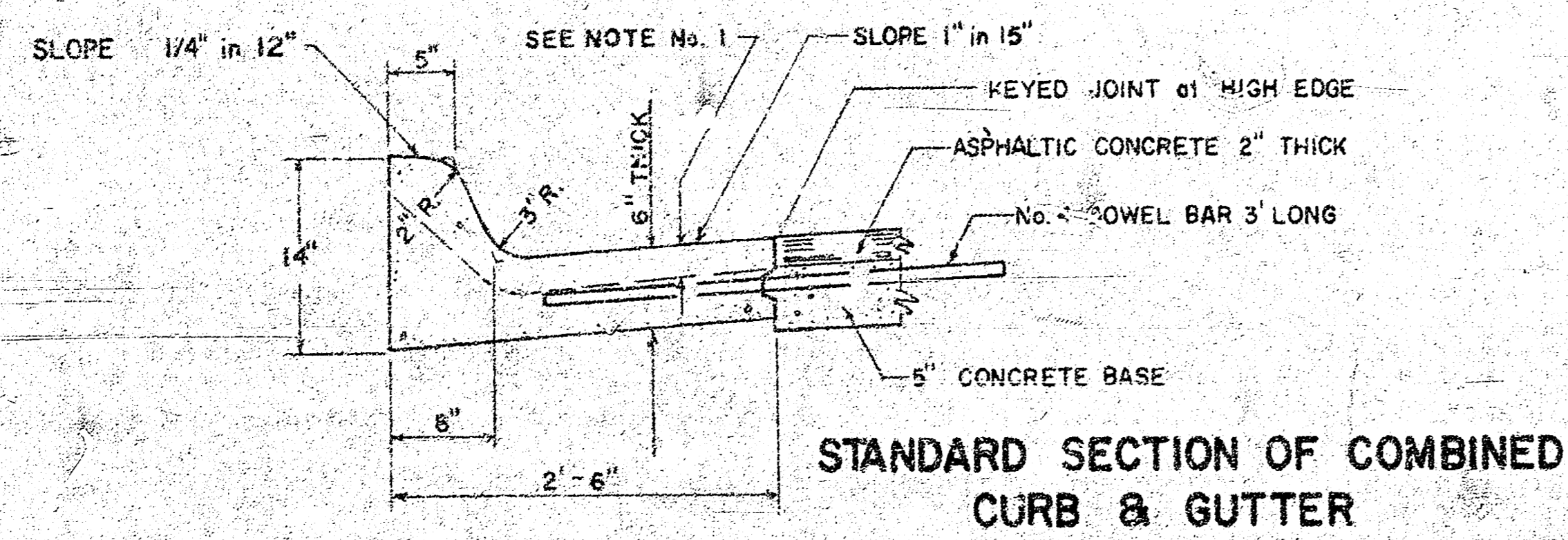

**GENERAL NOTES**  
 1. CONTRACTION JOINTS MAY BE CONSTRUCTED IN COMBINED CURB AND GUTTER BY SAWING WITH AN APPROVED CONCRETE SAW. THE SAW CUT SHALL EXTEND 2-1/2" BELOW THE SURFACE OF THE GUTTER AND CURB. SAWED CONTRACTION JOINTS SHALL HAVE A MAXIMUM SPACING OF 10' AND BE FILLED WITH A SPECIFIED JOINT FILLER, SUCH THAT THE JOINT IN THE GUTTER SECTION WILL BE COMPLETELY FILLED.



CITY OF WICHITA, KANSAS  
 Department of Public Works-Engineering Division  
 R.W. Linn City Engineer  
 Date: SEPT. 1976 Project No. DAKS569026

Baseline Is Ctr. Of Arlene & Battin  
 B.M. 174.486 NW COR. OLIVER & 25TH ST. N.  
 B.M. 183.79 ON TOP CURB WS. OLIVER, 1ST JOINT N OF SL. ARLENE EXT.  
 B.M. 186.39 SW COR. CONC. PORCH, HO. # 4914 E 24TH ST. N.

No More Than 25 - 20' Drives Are To Be Const. On This Project.

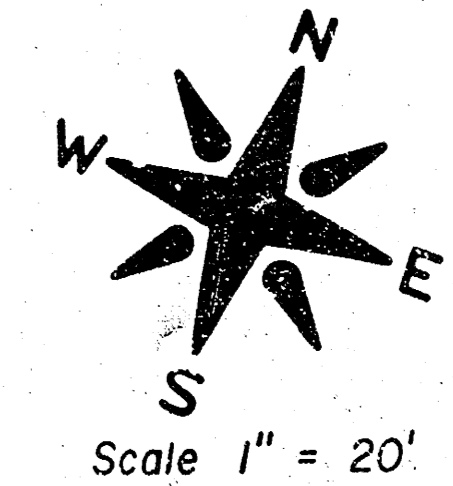

Δ = 41°28'19" R. = 563.27' T. = 485.1' L. = 80094' L.C. = 735.15'

CURVE DATA BASED ON  $\frac{1}{2}$  RAD. Δ = 40°44'02"

STA	ARC	CHORD LENGTH	CHORD BEARING	DEFLECTION	TOTAL DEFLECTION
0+77.85				0°00'00"	0°00'00"
1+00	22.15'	21.24'	23.05'	1°07'36"	1°07'36"
1+06.35	4.35'	6.09'	6.61'	0°15'22"	1°26'58"
1+25	18.65'	17.89'	19.41'	0°56'55"	2°23'53"
1+39.82	14.32'	13.73'	14.90'	0°43'42"	3°07'35"
1+50	10.68'	10.24'	11.12'	0°32'35"	3°40'10"
1+75	25.00'	23.98'	26.02'	1°16'18"	4°56'28"
2+00	25.00'	23.98'	26.02'	1°16'17"	6°12'45"
2+25	25.00'	23.98'	26.02'	1°16'18"	7°29'03"
2+50	25.00'	23.98'	26.02'	1°16'17"	8°45'20"
2+75	25.00'	23.98'	26.02'	1°16'17"	10°01'37"
3+00	25.00'	23.98'	26.02'	1°16'18"	11°17'55"
3+11.23	11.13'	10.68'	11.58'	0°33'58"	11°51'53"
3+25	13.81'	13.30'	14.44'	0°42'19"	12°34'12"
3+48.58	23.48'	22.52'	24.44'	1°11'39"	13°45'51"
3+50	1.52'	1.46'	1.58'	0°04'39"	13°50'30"
3+75	25.00'	23.98'	26.02'	1°16'17"	15°06'47"
3+85.82	10.82'	10.38'	11.26'	0°33'01"	15°39'48"
4+00	14.18'	13.60'	14.76'	0°43'16"	16°23'04"
4+25	25.00'	23.98'	26.02'	1°16'18"	17°39'22"
4+50	25.00'	23.98'	26.02'	1°16'17"	18°55'39"
4+75	25.00'	23.98'	26.02'	1°16'18"	20°11'57"
5+00	25.00'	23.98'	26.02'	1°16'17"	21°28'14"
5+25	25.00'	23.98'	26.02'	1°16'17"	22°44'31"
5+37.22	12.09'	11.60'	12.58'	0°36'54"	23°21'25"
5+50	12.91'	12.38'	13.44'	0°39'24"	24°00'49"
5+70.2	20.19'	19.36'	21.01'	1°01'36"	25°02'25"
5+75	4.81'	4.61'	5.01'	0°14'41"	25°17'06"
6+00	25.00'	23.98'	26.02'	1°16'18"	26°33'24"
6+03.82	3.09'	2.96'	3.22'	0°09'25"	26°42'49"
6+25	21.91'	21.01'	22.80'	1°06'52"	27°49'41"
6+50	25.00'	23.98'	26.02'	1°16'17"	29°05'58"
6+75	25.00'	23.98'	26.02'	1°16'18"	30°22'16"
7+00	25.00'	23.98'	26.02'	1°16'17"	31°38'33"
7+25	25.00'	23.98'	26.02'	1°16'17"	32°54'50"
7+50	25.00'	23.98'	26.02'	1°16'18"	34°11'08"
7+75	25.00'	23.98'	26.02'	1°16'17"	35°27'25"
8+00	25.00'	23.98'	26.02'	1°16'18"	36°43'43"
8+25	25.00'	23.98'	26.02'	1°16'17"	38°00'00"
8+50	25.00'	23.98'	26.02'	1°16'17"	39°16'17"
8+64	14.00'	13.43'	14.57'	0°42'44"	39°59'01"
8+78.6	14.80'	14.20'	15.40'	0°45'10"	40°44'11"

Der. Fr. = 3.0519761 MM.

**SUB-GRADE**  
 TYPE OF SUB-GRADE TREATMENT SHALL BE DETERMINED BY THE FIELD ENGINEER. SUB-GRADE TREATMENT MAY CONSIST OF LIME TREATMENT, CEMENT TREATMENT, SUB-GRADE MODIFICATION, OR ANY COMBINATION OF THESE.

NOTE TO FIELD ENGINEER & CONTRACTOR  
 Grade parking and clear right-of-way for proposed sidewalk. Compact fill in sidewalk area. TO BE CONSTRUCTED BY "OTHERS".

Earthwork Property	
Excavation	2229.0
+10%	222.9
Total	2451.9 C.Y.
Compacted Fill	
	18.0
+10%	1.8
Total	19.8 C.Y.

Earthwork City	
Excavation	2406
+10%	241
Total	2647

Manipulation	
Property	3700.3 S.Y.
City	496.0 S.Y.

General Notes:  
 1. Tree Removal is Standard unless  
 except any tree which in the opinion  
 of the field engineer can be saved  
 shall be saved.

**CAUTION**  
 UNDERGROUND  
 UTILITIES  
 Please Call 311 or 617-260-2200  
 or  
 Telephone Co. for Location

Indicates Proposed 2' X 5' Storm Sewer Inlet

Arlene & Battin  
 E.L. Block 4, Prairie Hills Addition  
 To S.L. 25th St. N.  
 26-2-30 Asphaltic Concrete  
 City Of Wichita, Kansas  
 R. W. Linn City Engineer  
 Project No. DAKS569026  
 Date: Sept 76

(2/4)

FILMED FROM THE BEST  
 AVAILABLE COPY .....

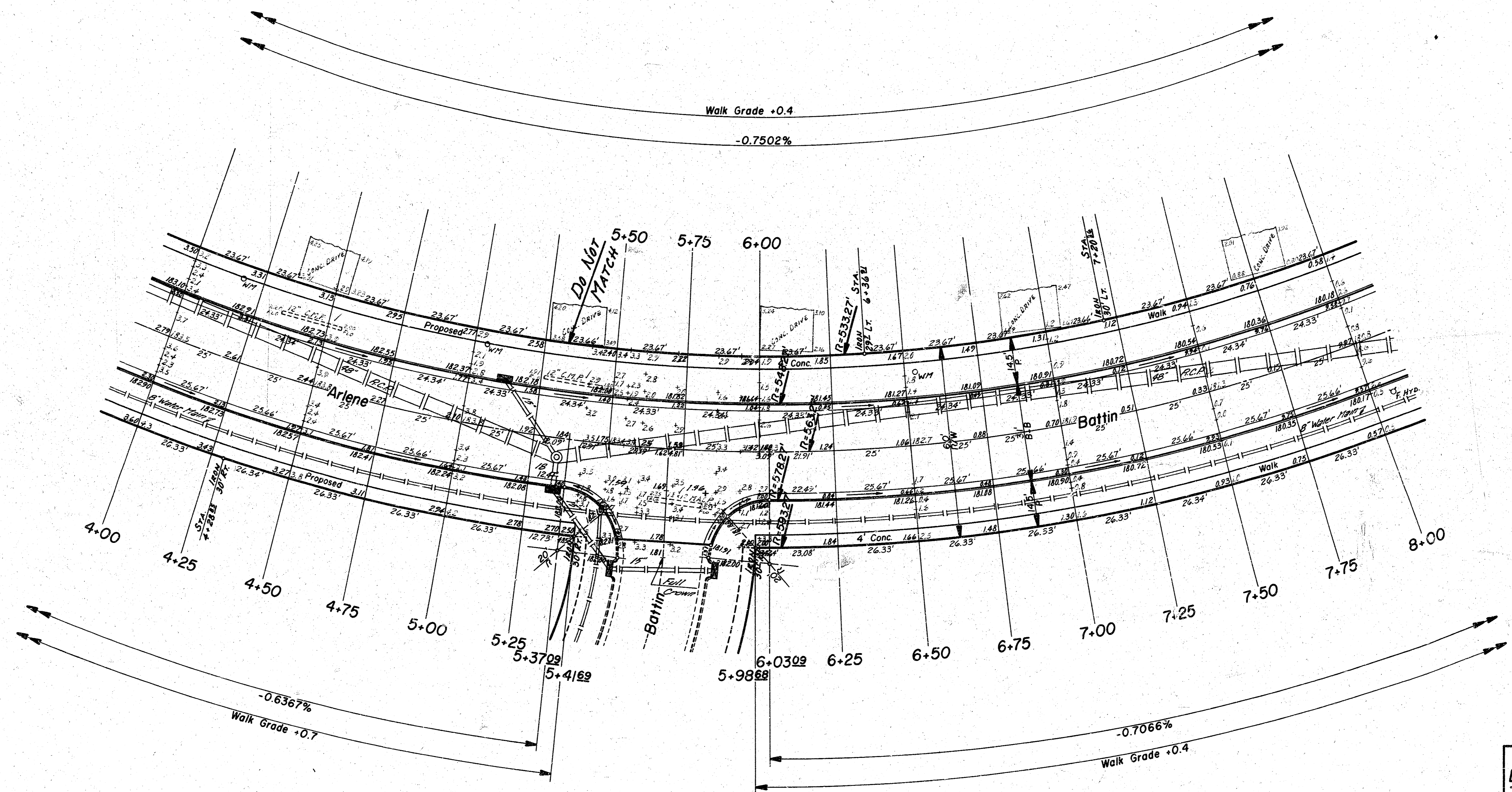
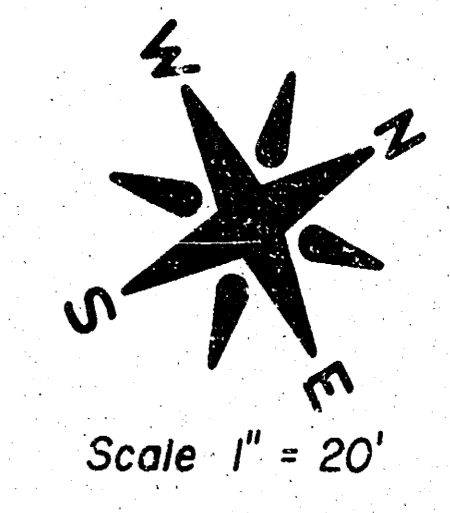

SUNNY DILLER BR 200 023  
FIGHT & ADWELL  
CHECKED

Arlene & Battin  
E.L. Block 4, Prairie Hills Addition  
To S.L. 25th St. N.  
26-2-30 Asphaltic Concrete  
City Of Wichita, Kansas  
R. W. Linn City Engineer  
Project No. DAKS569026  
Date: Sept. 76  
(3/4)

SURVEY DALLAS  
 PLAN: F. ADWELL  
 EX: F. ADWELL  
 CHECKED

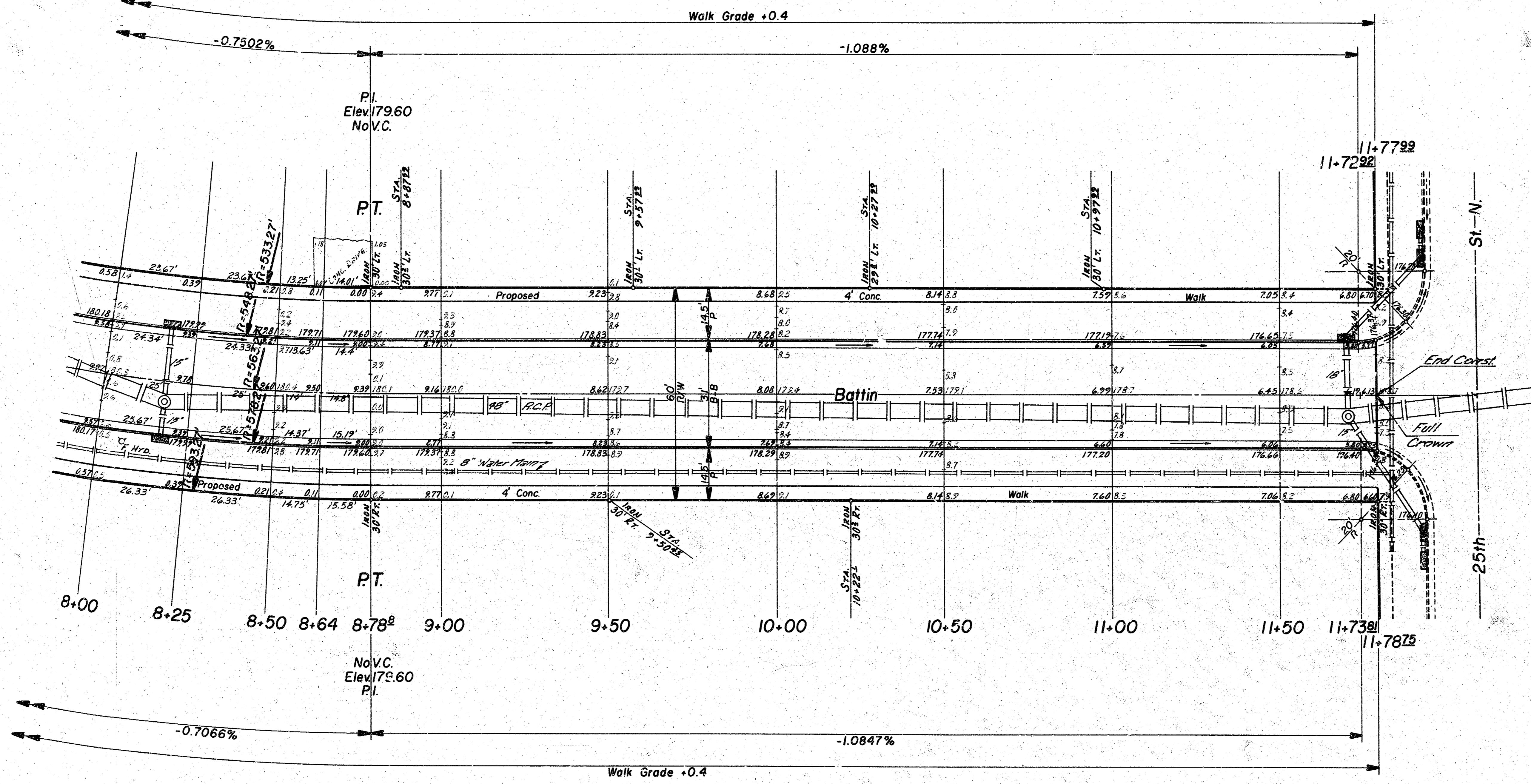

Arlene & Battin  
 E.L. Block 4, Prairie Hills Addition  
 To S.L. 25th St. N.  
 26-2-30 Asphaltic Concrete  
 City Of Wichita, Kansas  
 R. W. Linn City Engineer  
 Project No. DAKS569026  
 Date: Sept. 76

4/4