

Battin Ave. - S.L. 1<sup>st</sup> St to N.L. 2<sup>nd</sup> St.

26' Asph.

B.P. Elev. 170.74 End of curb N.W. Corner & 1<sup>st</sup> St, west side

Note: This information is included in 1st St

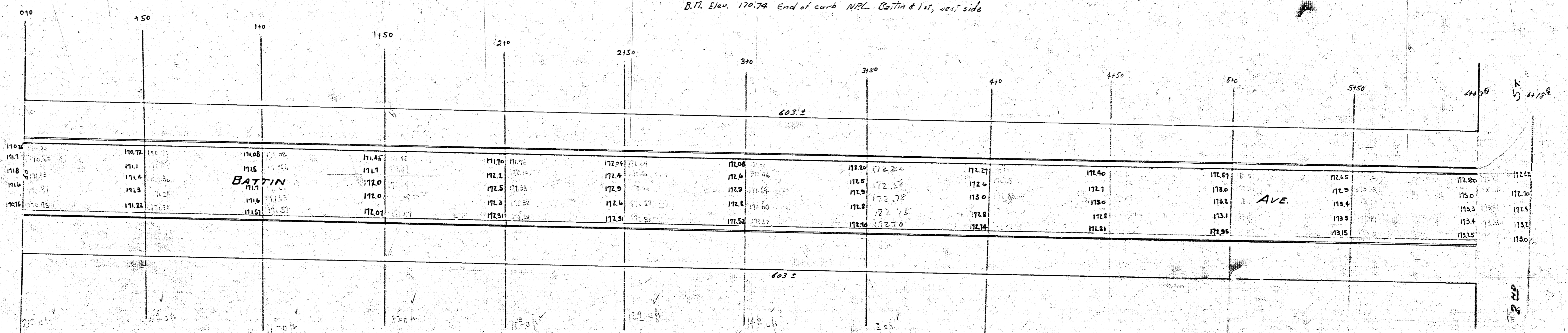

Handwritten notes and calculations below the diagram:  
1100  
1105  
1110  
1115  
1120  
1125  
1130  
1135  
1140  
1145  
1150  
1155  
1160  
1165  
1170  
1175  
1180  
1185  
1190  
1195  
1200  
1100  
1105  
1110  
1115  
1120  
1125  
1130  
1135  
1140  
1145  
1150  
1155  
1160  
1165  
1170  
1175  
1180  
1185  
1190  
1195  
1200  
1100  
1105  
1110  
1115  
1120  
1125  
1130  
1135  
1140  
1145  
1150  
1155  
1160  
1165  
1170  
1175  
1180  
1185  
1190  
1195  
1200