

B. M. 158.34 "R" in Ritchie St. Lincoln & 1/4. ab Royal Road.  
 B. M. 156.29 "X" Top E. ab Royal Rd. & 5' N. of N.L. Bayley.  
 Sta on N. 1/2.

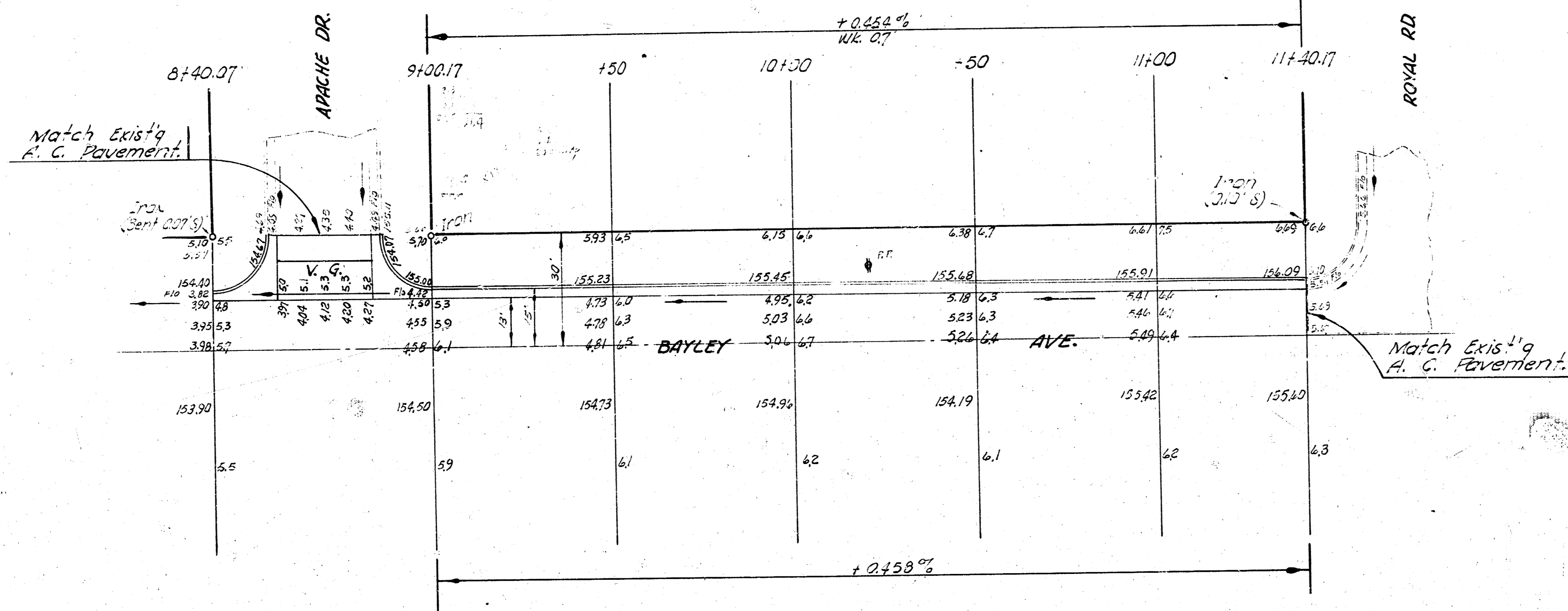
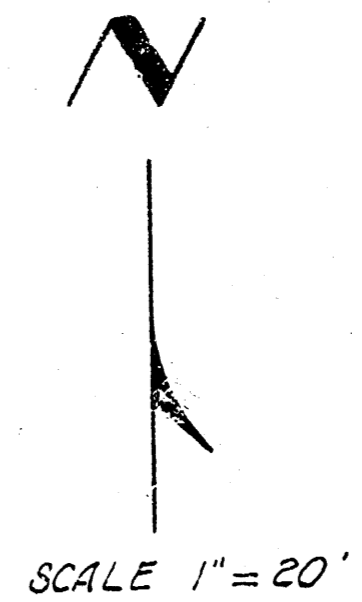

NOTE TO FIELD ENGINEER:  
 Grade S<sub>2</sub> Bayley sufficiently to  
 rem. & fill bank, cross section  
 the S<sub>2</sub> Bayley after Exc.

N<sup>1</sup>/<sub>2</sub> BAYLEY ST.  
 WL APACHE TO WL ROYAL RD.  
 13-2-15 A. C.  
 CITY OF WICHITA, KANSAS  
 B. E. SMITH CITY ENGINEER  
 APRIL 1958 PROJ. NO. C-15-203

TOTAL QUANTITY  
 EXC. 117.1  
 378.2 cu yds. 11.23 cu yds.

