

167
 167
 167

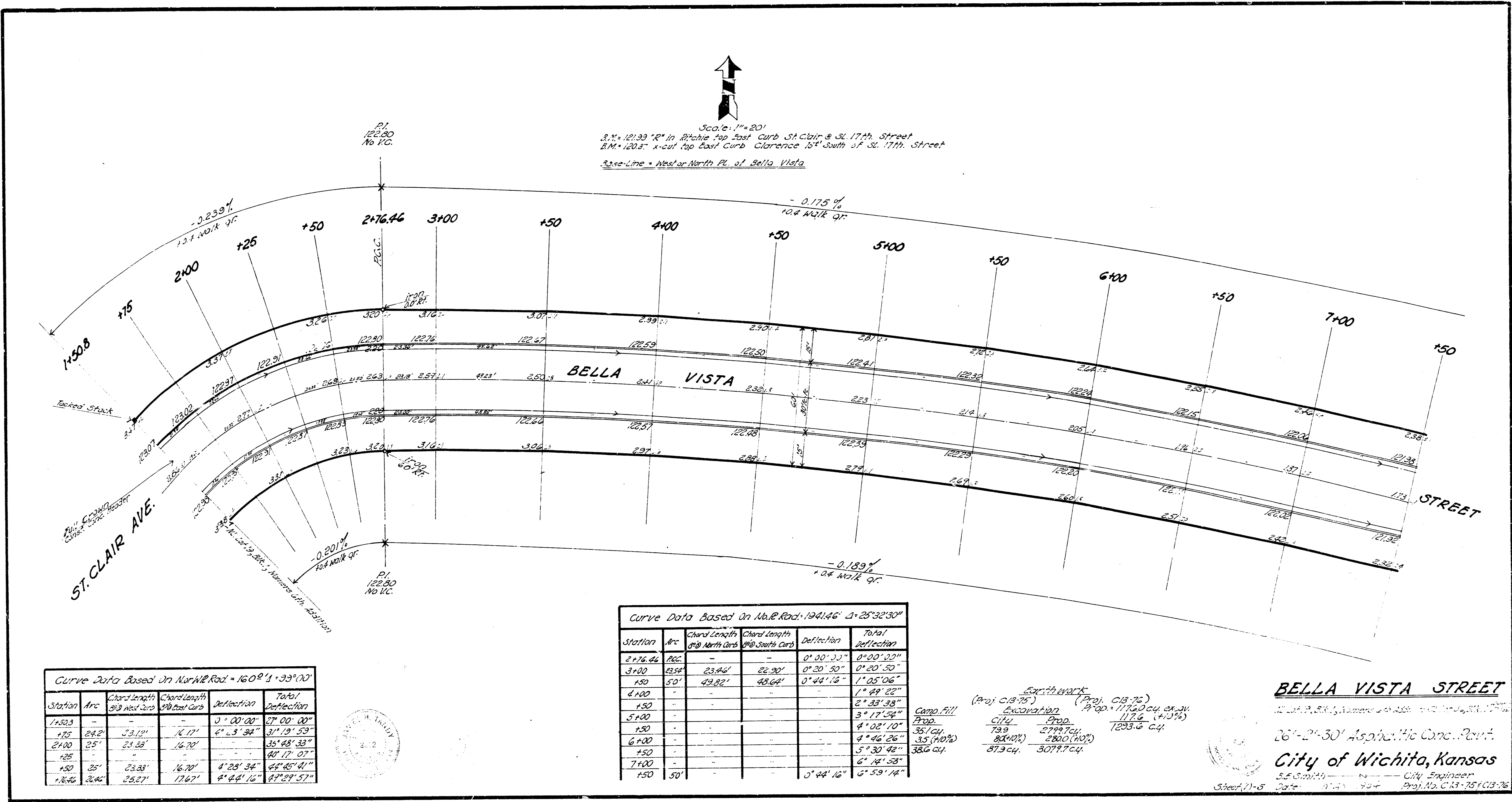

Curve Data Based on Nor. Rad. = 160° 1' 33" 00"

Station	Arc	Chord Length	Chord Length	Deflection	Total
		to Next Curve	to Next Curve		Deflection
1+50.8	-	-	-	0° 00' 00"	67° 00' 00"
+75	24.2'	33.12'	14.17'	2° 3' 34"	31° 19' 53"
2+00	25'	23.33'	14.70'	-	38° 48' 33"
+25	-	-	-	-	60° 17' 07"
+50	25'	23.33'	14.70'	4° 28' 34"	24° 45' 41"
2+76.46	26.6'	25.27'	17.62'	8° 48' 16"	87° 24' 57"

Curve Data Based on Nor. Rad. = 1941.46' Δ = 25° 32' 30"

Station	Arc	Chord Length	Chord Length	Deflection	Total
		to North Curve	to South Curve		Deflection
2+76.46	26.6'	-	-	0° 20' 20"	0° 20' 20"
3+00	23.4'	23.46'	22.90'	0° 30' 50"	0° 20' 50"
+50	23.4'	49.82'	45.64'	0° 44' 16"	1° 05' 06"
4+00	-	-	-	1° 09' 22"	-
+50	-	-	-	2° 33' 33"	-
5+00	-	-	-	3° 17' 54"	-
+50	-	-	-	4° 02' 10"	-
6+00	-	-	-	4° 46' 26"	-
+50	-	-	-	5° 30' 42"	-
7+00	-	-	-	6° 14' 58"	-
+50	50'	-	-	0° 44' 16"	0° 59' 14"

Excavation
 (Proj. C18-75) (Proj. C18-76)
 Excavation (Prop. C18-76)
 79.9 cu yd
 88.0 cu yd
 87.9 cu yd

BELLA VISTA STREET
 26'-2 1/2" Asphaltic Conc. Pavt.
 City of Wichita, Kansas
 S.E. Smith, City Engineer
 Date: 1/23/76
 Proj. No. C18-75/C18-76



(Continued)

Curve Data Based on V.R. Rad. 194.42' Δ 25° 52' 30"					
Station	Arc	Chord Length	Chord Length	Deflection	Total Deflection
		8' to 8' Curve	8' to 8' Curve		
7+50	30'	49.82'	48.66'	0° 44' 14"	0° 51' 14"
8+00	"	"	"	"	1° 43' 50"
8+50	"	"	"	"	3° 57' 45"
9+00	"	"	"	"	5° 58' 18"
9+50	"	"	"	"	8° 40' 34"
10+00	"	"	"	"	11° 51' 50"
11+00	50'	59.82'	48.66'	0° 44' 14"	2° 09' 06"
+41.33	41.33'	41.78'	40.79'	0° 37' 37"	2° 46' 43"

Curve Data Based on V.R. Rad. 176.57' Δ 57° 11'					
Station	Arc	Chord Length	Chord Length	Deflection	Total Deflection
		8' to 8' Curve	8' to 8' Curve		
11+50	"	"	"	"	2° 09' 06"
12+00	50'	7.99'	7.47'	3° 18' 22"	5° 27' 28"
12+50	"	"	"	"	8° 45' 50"
13+00	"	"	"	"	12° 03' 12"
13+50	"	"	"	"	15° 20' 34"
14+00	50'	"	"	"	18° 37' 56"

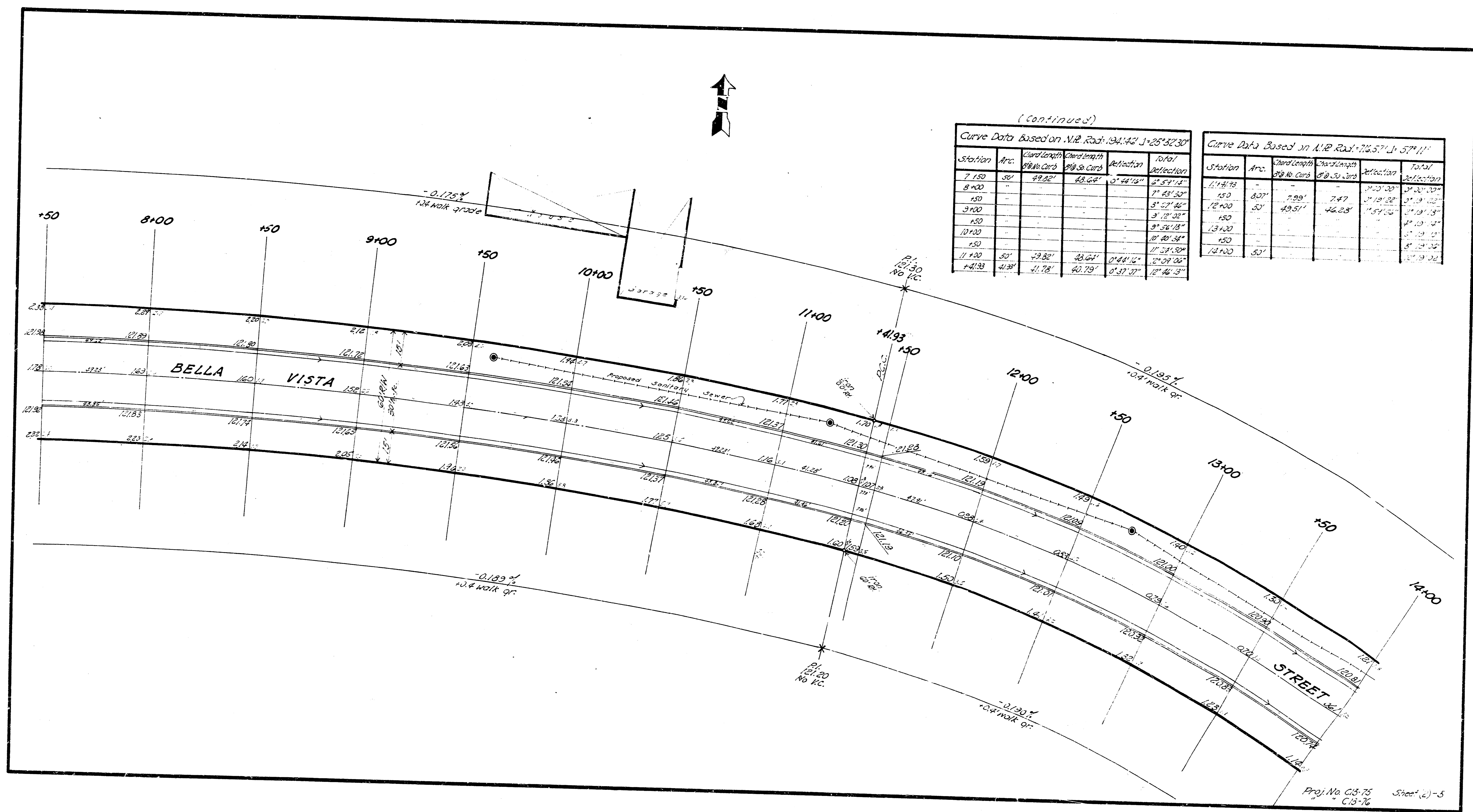

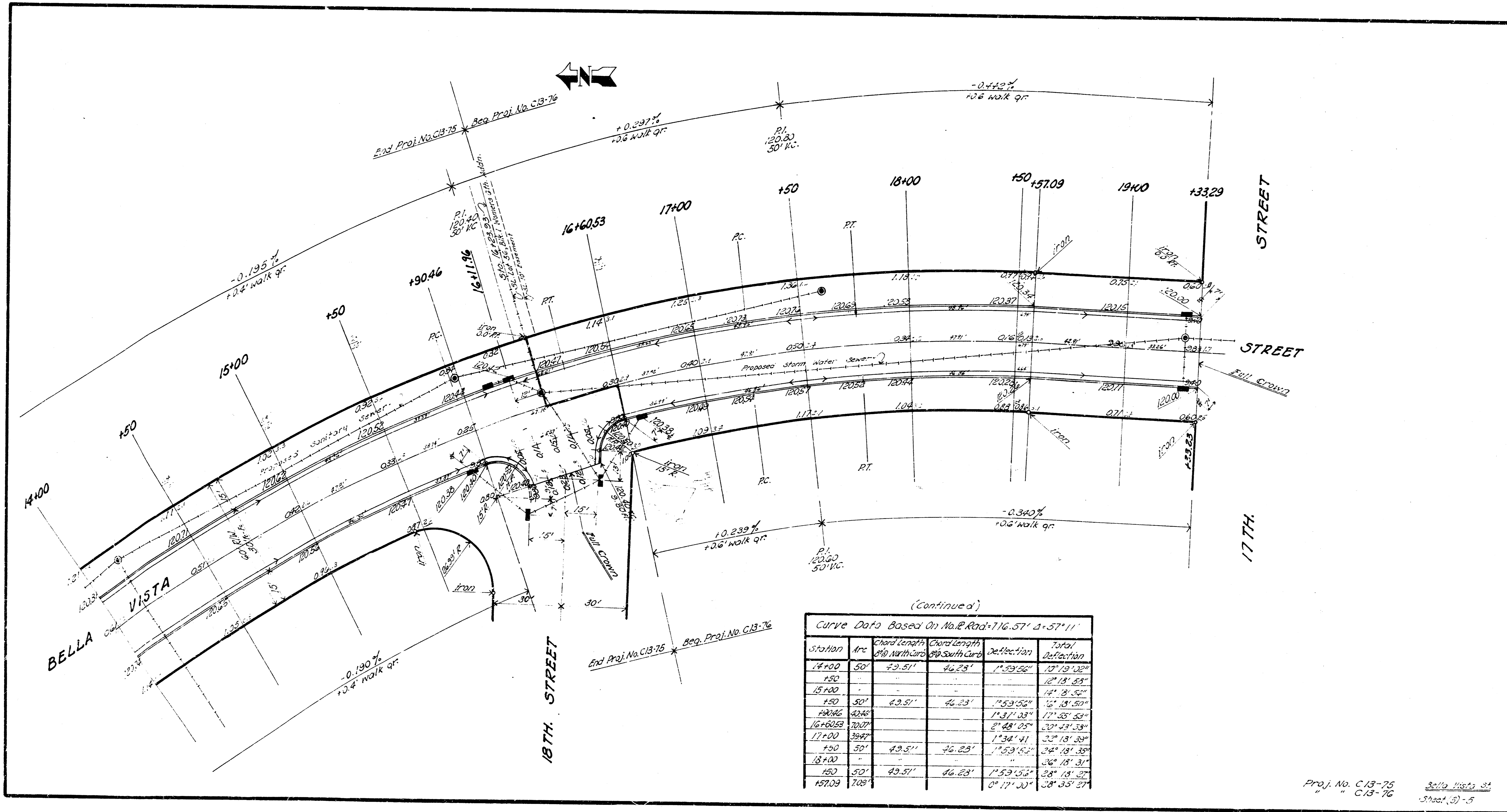

Proj. No. C13-75
C13-76

Bella Vista St
Sheet 5-5