

B.M. 129 74 R.R. Spk on S.E. Side P.P. 36 S.E. Cor. 18<sup>th</sup> & West Dale Dr.  
 B.M. 129 555 R.R. Spk on E. Side P.P. 36 S.E. Cor. Bella Vista & West Dale Dr.

**NOTE:**

Dirt will be furnished to this project from other construction projects for fill. The parkings will be graded to the elevations shown on the plans.

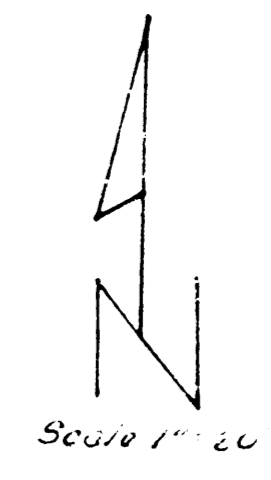

**NOTE: Roll Curb Entire Project**

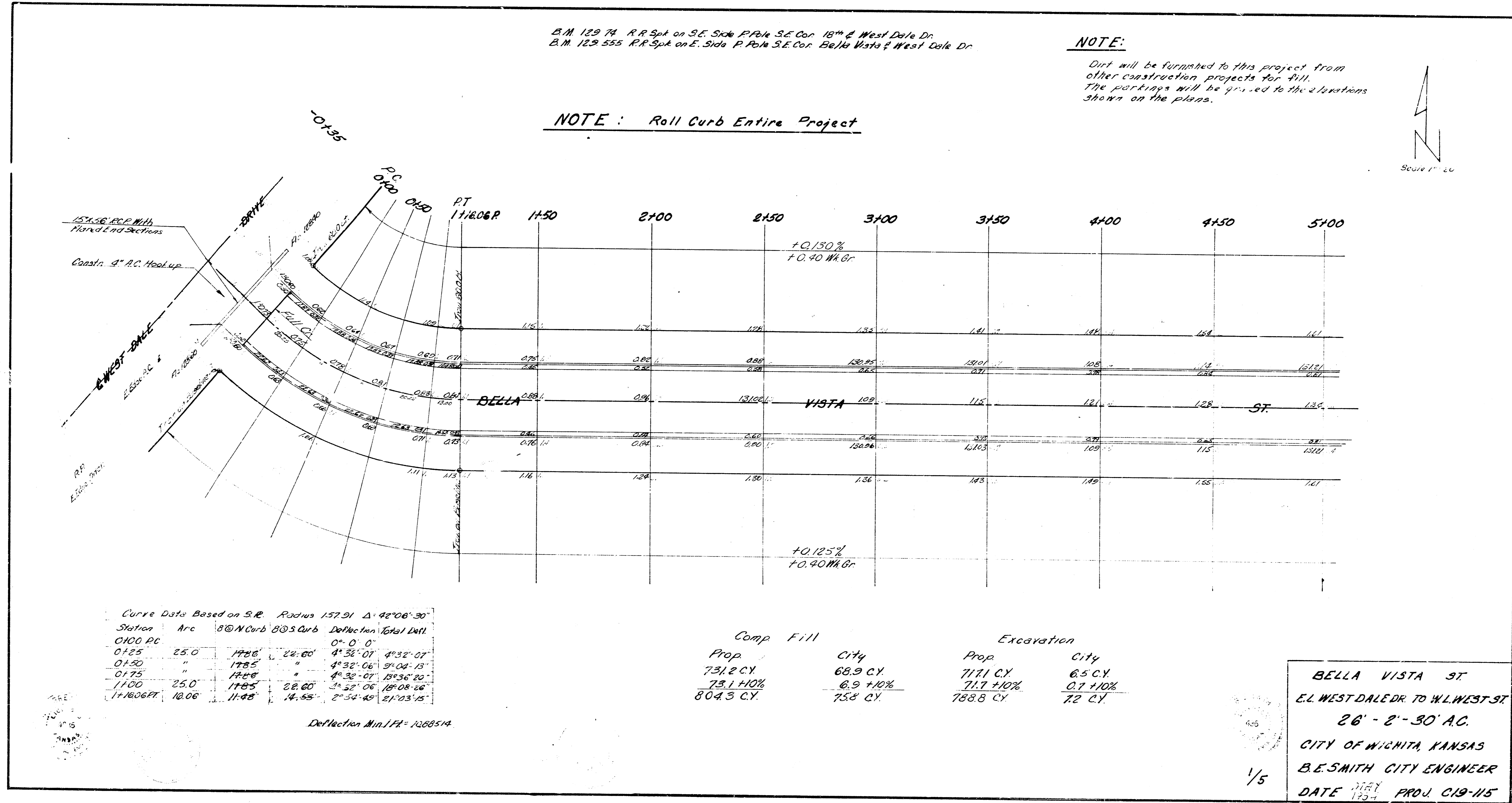

Curve Data Based on S.R. Radius 157.91 Δ: 42°06'30"

Station	Arc	8' @ N Curb	8' @ S Curb	Deflection	Total Luff
0+00 PC				0° 0' 0"	
0+25	25.0	17.86	22.60	4° 32' 07"	4° 32' 07"
0+50	"	17.85	"	4° 32' 06"	9° 04' 13"
0+75	"	17.86	"	4° 32' 07"	13° 36' 20"
1+00	25.0	17.85	22.60	4° 32' 06"	18° 08' 26"
1+1806PT	18.06	11.48	14.58	2° 54' 49"	21° 03' 15"

Deflection Min. IFA = 1268514

Comp Fill		Excavation	
Prop	City	Prop	City
731.2 CY	68.9 CY	717.1 CY	6.5 CY
73.1 +10%	6.9 +10%	717.1 +10%	0.7 +10%
804.3 CY	75.8 CY	788.8 CY	7.2 CY

BELLA VISTA ST  
 E.L. WEST DALE DR. TO W.L. WEST ST.  
 26' - 2" - 30' AC.  
 CITY OF WICHITA, KANSAS  
 B.E. SMITH CITY ENGINEER  
 DATE MAY 1934 PROJ. C19-115

1/5

B.M. 130.765 R.R. Spk on N. Side P. Pole on Back Lot Line 115' S. of Sta 5+25  
 B.M. 131.715 R.R. Spk on N. Side P. Pole on N.E. Cor. West St. & Belle Vista St. East.

