

B.M. RE spike 3 side P.P. NW cor. Hyacinth & 21st 12821
 B.M. "R" in ditch WL Hyacinth on S cb. Benjamin Dr. 12522
 B.M. SE cor conc. porch 2847 Benjamin Dr. 12923
 B.M. RE spike 3 side street light pole NW cor. Benjamin Dr. & Benjamin Ct. 12824
 B.M. "M" in Mueller Fire Hydrant SE cor. Red Bud & Cardinal
 "M" painted yellow 12923

Note: Bench Marks to be used on this project only.

scale 1"=20'

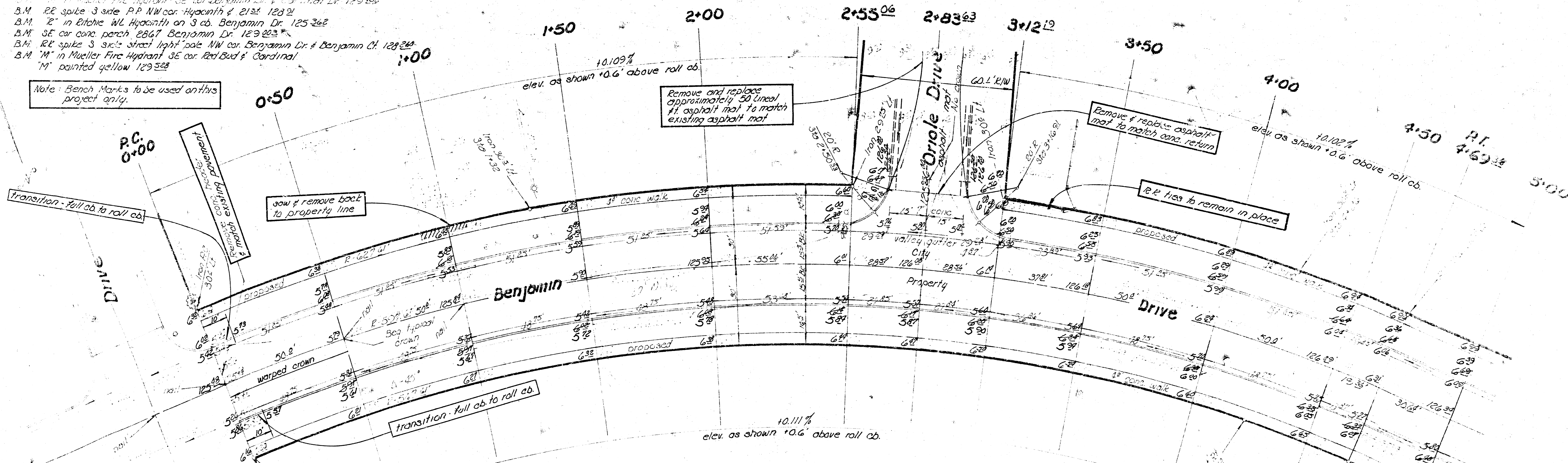

$\Delta = 45^\circ$ R = 597.6' T = L = 469.3' C =

CURVE DATA BASED ON $\frac{L}{R}$ RAD. $\Delta = 45^\circ$				
STA	ARC	CHORD LENGTH	DEFLECTION	TOTAL DEFLECTION
		2' OFF CB	2' OFF VCB	
0+00	—	—	—	0'00'00"
0+50	50'	51.91'	48.06'	2°23'49"
1+00	"	"	"	4°47'37"
1+50	"	"	"	7°11'26"
2+00	50'	51.91'	48.06'	9°35'15"
2+50	50.33'	52.25'	48.33'	11°59'01"
2+55.26'	4.73'	4.91'	4.55'	14°23'37"
3+12.19'	57.13'	59.31'	54.91'	16°57'56"
3+16.21'	4.73'	4.90'	4.54'	19°22'31"
3+50	33.29'	34.36'	31.81'	21°46'41"
4+00	50'	51.91'	48.06'	24°10'30"
4+50	50'	51.91'	48.06'	26°34'19"
4+69.33'	19.33'	20.10'	18.61'	29°08'10"

deflection - $\frac{2.876246}{ft}$

General Notes

- Contractor to clear Right of way, grade parking and compact fill in sidewalk areas. Sidewalk to be constructed by others.
- Type of subgrade treatment shall be as determined by the Field Engineer. Sub grade treatment may consist of lime treatment, cement treatment, subgrade modification, or any combination of these.
- Contractor to grade existing dirt road at Oriole Dr. & Benjamin Dr. intersection to match new pavement according to Field Engineer. Field Engineer to take original and final cross sections as required to determine earthwork pay quantity.
- Field Engineer to determine thickness of existing asphalt mat, and record with office.
- Contractor to remove & replace mail boxes - work to be considered incidental to project.
- All 'irons' to be protected on this project.
- P.R. ties and spreaders to be bid on this project as a "lump sum bid", for removal.
- Roll curb shall be constructed on this project.
- Roll curb shall be depressed through drives constructed as in conjunction with this project.

Earthwork City

Excavation	120.8*	Comp. fill	0.0
+10%	12.1	+10%	—
Total	132.9		0.0

Earthwork Property

Excavation	818.5	Comp. fill	16.3
+10%	81.9	+10%	1.6
Total	900.4		17.9

* includes 32.2 Cu yds excavation for asphalt hook up at intersection of Oriole Dr. & Benjamin Dr.

Revised 8-2-73

Benjamin Drive
 WL Cardinal Drive to
 S.L. RedBud Lane
 26-2-30 Asphaltic Concrete
 R.W. Linn, City Engineer
 City of Wichita, Kansas
 Project No. DAR3566018
 Date: June 1973

5+00 5+50 6+00 6+50 7+00 7+50 8+00 8+50 9+00 9+50

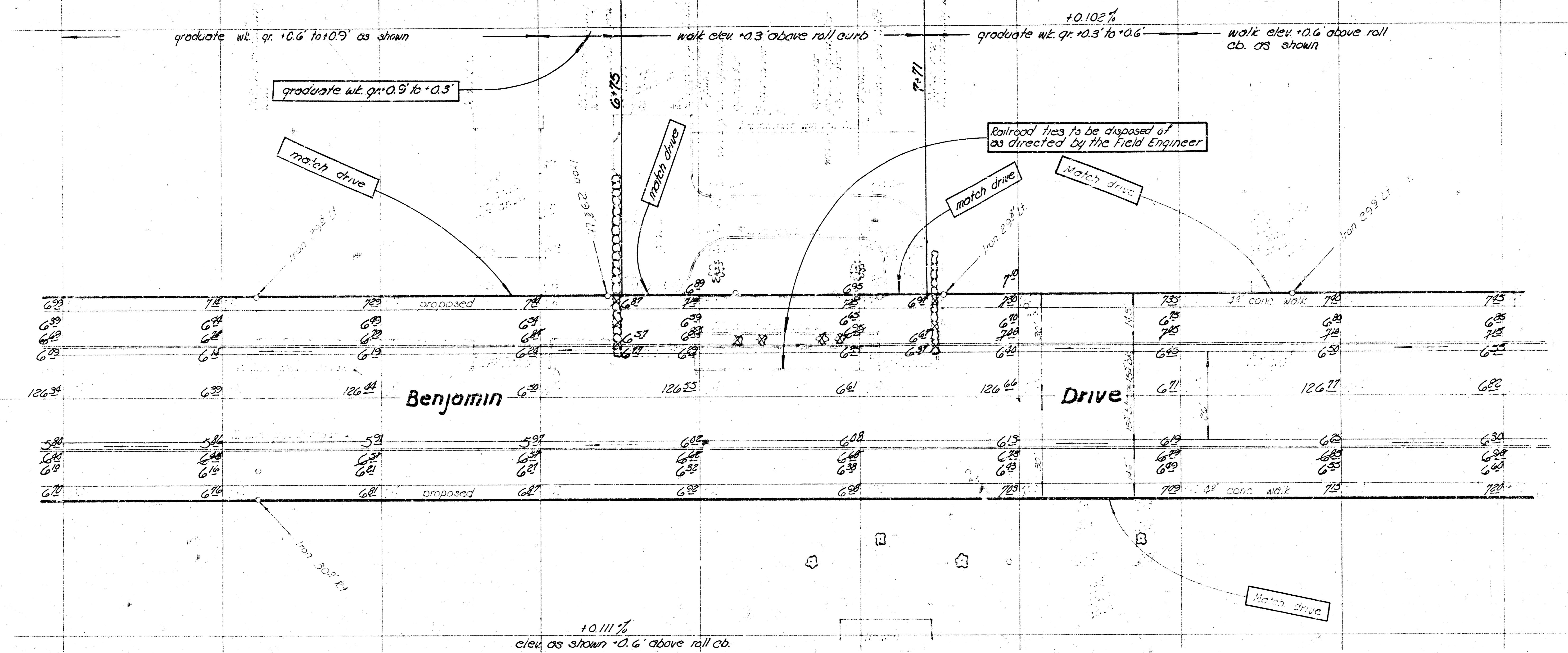

9+50

10+00

10+50

11+00

11+50

12+00

12+50

13+00

13+50

13+99²⁷

elev. as shown +0.6' above roll cb.

+0.102%
set wt. gr. as shown

elev. as shown +1.0' above roll cb.

Scale 1"=20'

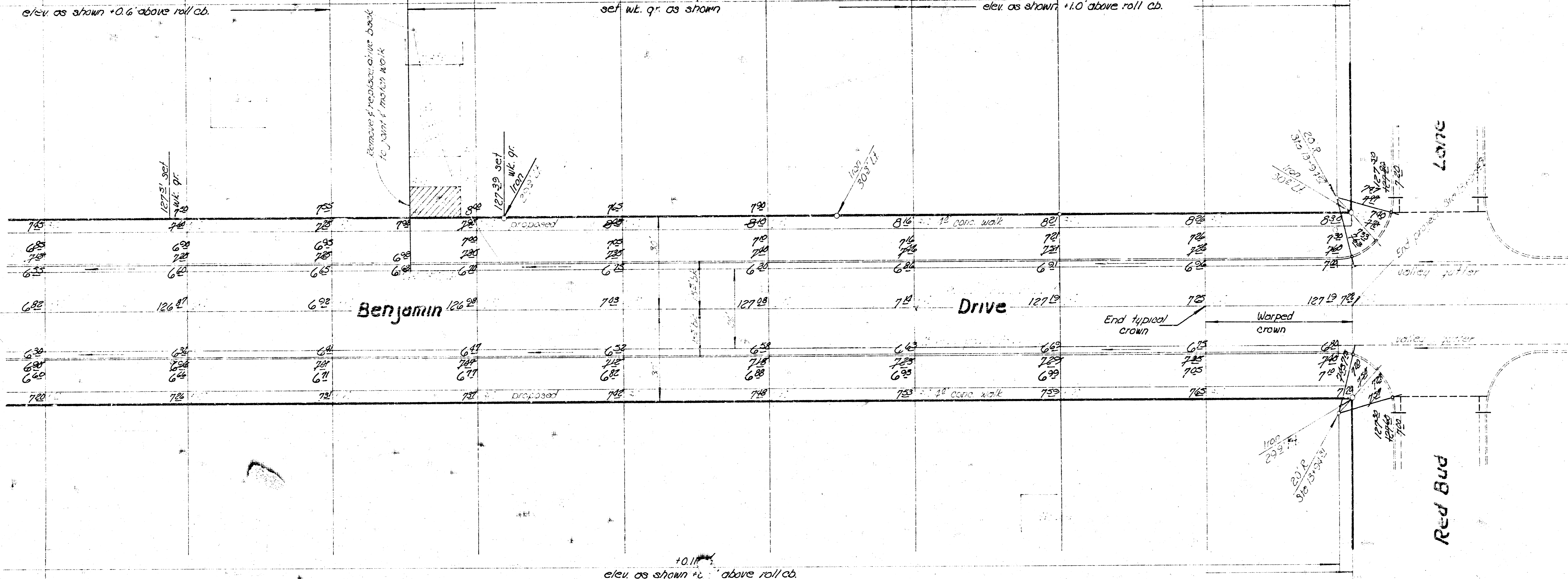

Benjamin

Drive

Lane

Red Bud

13+99³¹

+0.11%
elev. as shown +0.6' above roll cb.

3/5

Project No. 10033000