

BM-127.875 bridge spike W.S. P.Pole E.S. Hyacinth f SL. Riverlawn Heights Addn.

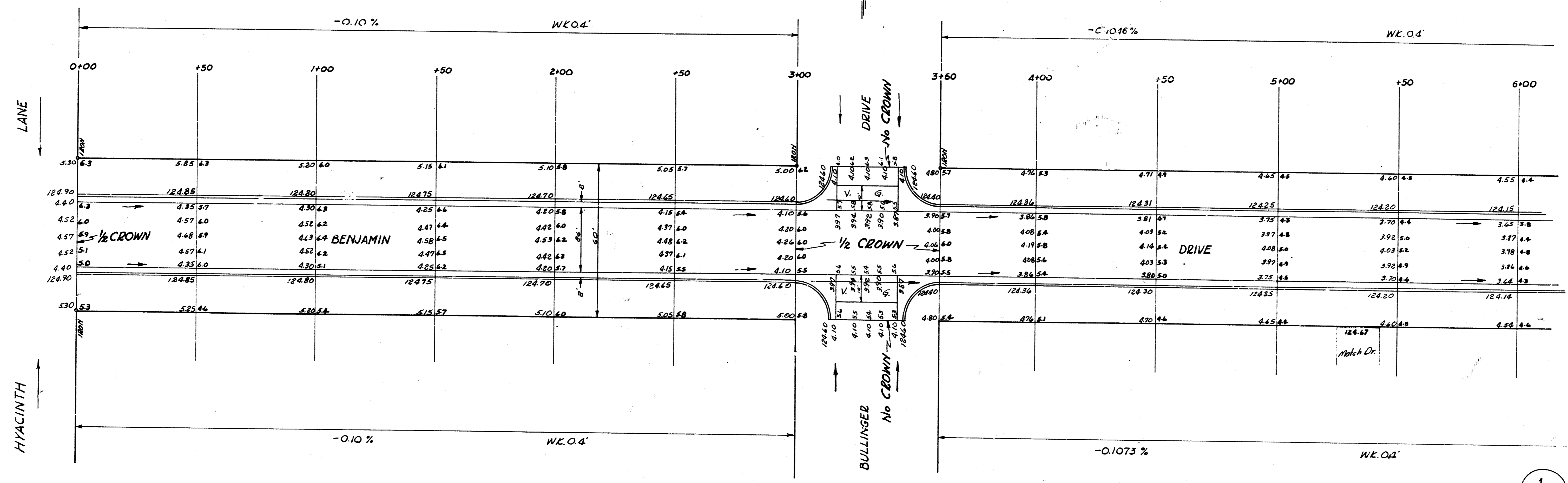

Handwritten notes:
 127.875
 127.875
 127.875

1/3

BENJAMIN DRIVE
 EL Hyacinth NL 21st
 25'-2'-30" AC
 CITY OF WICHITA, KANSAS
 B.E. SMITH CITY ENGINEER
 SEPT. 1956 PROJ. NO. C/5-49

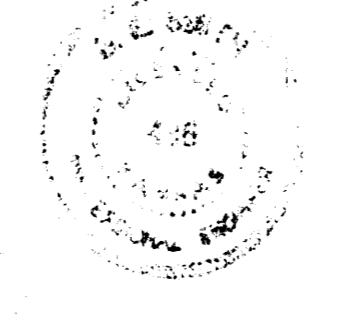
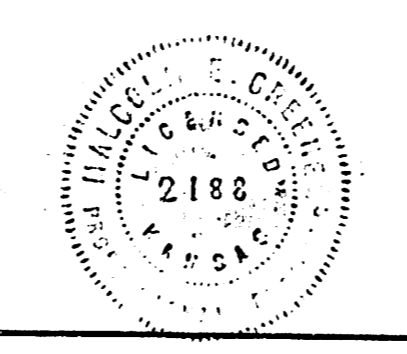

Young
 Greene
 143Y

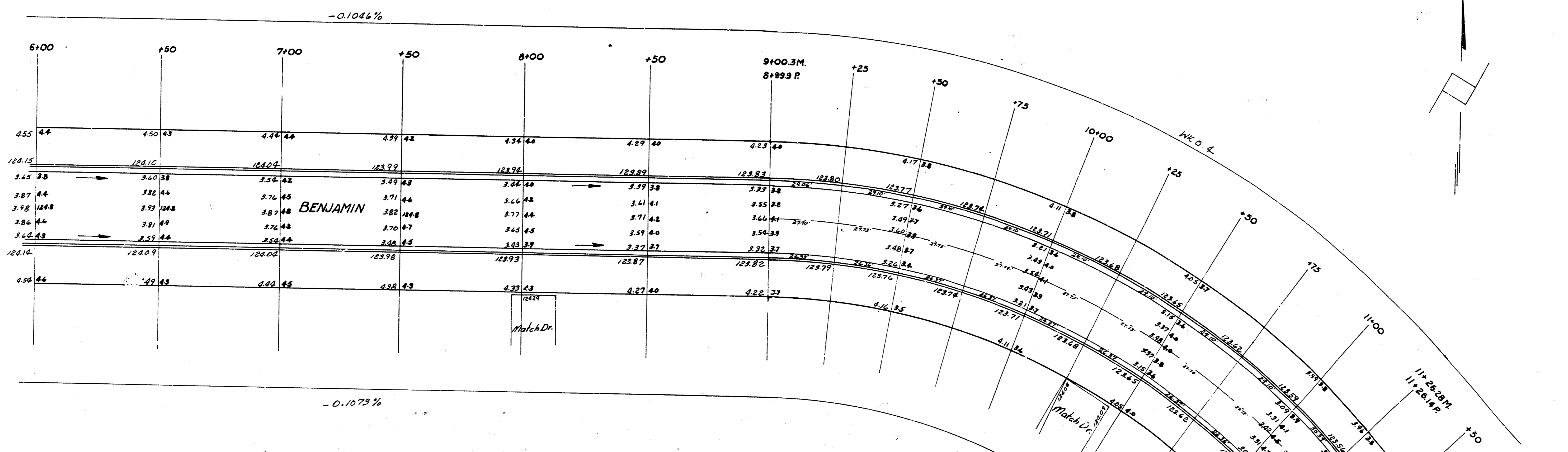

CURVE DATA on 6' offset N/E cb - STA. on S+WR.
 $R = 325.34$ $\Delta = 47^\circ 15'$

Station	Chord Length 6' offset N cb.	Chord Length 6' offset S cb.	Deflection Angle	Total Deflection
9+00.3				
+25	29.60	25.78	2° 36' 26"	2° 36' 26"
+50	29.63	25.81	2° 36' 36"	5° 13' 02"
+75	29.66	25.82	2° 36' 39"	7° 49' 41"
10+00	29.66	25.82	2° 36' 39"	10° 26' 20"
+25	29.66	25.82	2° 36' 39"	13° 02' 59"
+50	29.66	25.82	2° 36' 39"	15° 39' 38"
+75	29.66	25.82	2° 36' 39"	18° 16' 17"
11+00	29.63	25.81	2° 36' 36"	20° 52' 53"
+26.28	31.16	27.14	2° 44' 37"	23° 37' 30"

2
3

BENJAMIN DRIVE C15-49
 E.L. Hyacinth to Nl. 21st St

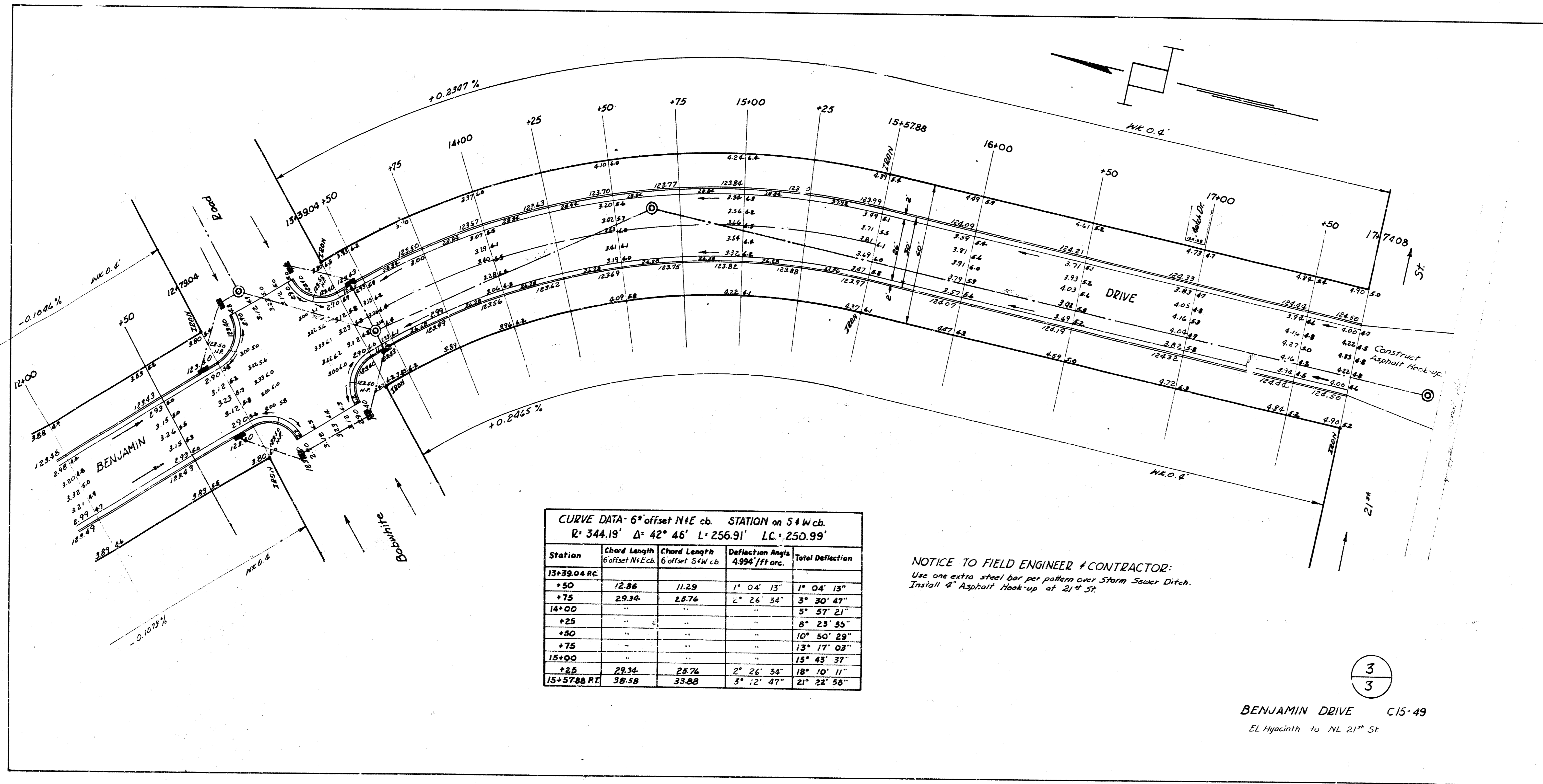

CURVE DATA: 6° offset N+E cb. STATION on S+W cb.
 R: 344.19' Δ: 42° 46' L: 256.91' LC: 250.99'

Station	Chord Length 6 offset N+E cb.	Chord Length 6 offset S+W cb.	Deflection Angle 4.994' / ft arc.	Total Deflection
15+39.04 RC.				
+50	12.86	11.29	1° 04' 13"	1° 04' 13"
+75	29.34	25.76	2° 26' 34"	3° 30' 47"
16+00	"	"	"	5° 57' 21"
+25	"	"	"	8° 23' 55"
+50	"	"	"	10° 50' 29"
+75	"	"	"	13° 17' 03"
15+00	"	"	"	15° 43' 37"
+25	29.34	25.76	2° 26' 34"	18° 10' 11"
15+57.88 RT	38.88	33.88	3° 12' 47"	21° 22' 58"

NOTICE TO FIELD ENGINEER & CONTRACTOR:
 Use one extra steel bar per pattern over Storm Sewer Ditch.
 Install 4" Asphalt Hook-up at 21' ST.

3
3

BENJAMIN DRIVE C15-49
 EL Hyacinth to NL 21" ST