

BM 144.75 "G" IN GLOBE N END NW QTR LINCOLN & BROADVIEW
 BM 160.50 SW COR CONC. PAV. HO # 800 CRESTWAY
 BM 152.10 "A" ON WALK EL BLUFFVIEW 85' N OF NL BOSTON

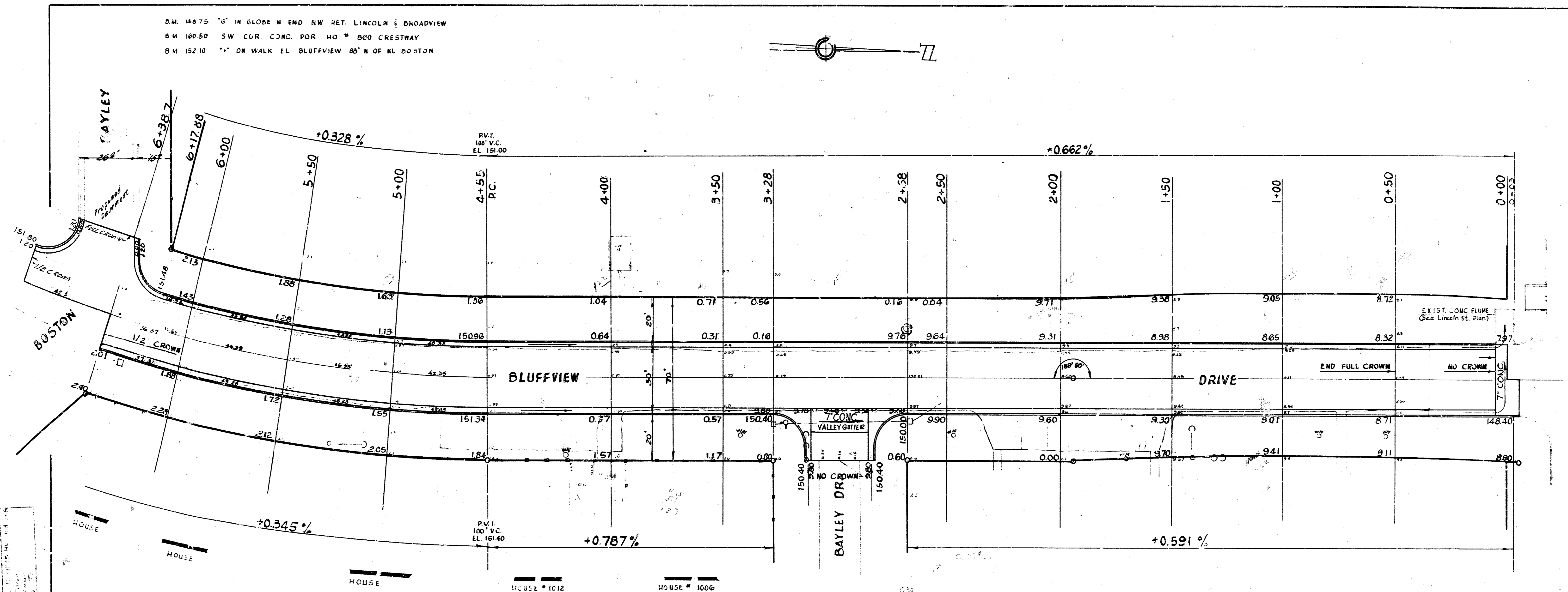

CURVE DATA: R=580.44 Δ/2=9°04' SIFT=296135					
STATION	ARC LENGTH	CHORD LENGTH		TOTAL DEFLECT.	
		δ @ E.C.B.	δ @ W.C.B.	DEFLECT.	DEFLECT.
4+55	P.C.				
5+00	45.00	44.06	40.50	2°13'16"	2°13'16"
5+50	50.00	48.95	33.99	2°28'04"	4°41'20"
6+00	50.00	48.95	44.99	2°28'04"	7°09'24"
6+17.88	17.88	17.51	16.09	0°52'57"	8°02'21"
6+38.70	20.82	20.06	18.43	1°01'39"	9°04'00"

CURVE DATA: R=593211 Δ/2=0°43' d/l=289757					
station	arc length	chord length		deflect.	
		δ @ E.C.B.	δ @ W.C.B.	DEFLECT.	TOTAL DEFLECT.
1+18.60	P.C.				
1+50	30.40	30.49	30.21	0°12'43"	0°12'43"
2+00	50.00	50.05	50.27	0°21'28"	0°34'11"
1+0	50.00	50.05	50.27	0°21'28"	0°55'39"
1+6	18.00	18.04	18.18	0°12'43"	0°08'56"

BLUFFVIEW DR.
 S.L. LINCOLN - N.L. BOSTON
 26'-2'-30" AC
 CITY OF WICHITA, KANSAS
 B. S. SMITH, CITY ENGINEER
 DATE: 11/10/10

