

| FED. ROAD DIST. NO. | STATE | W.E.R. PROJ. NO. | F.A.S. PROJ. NO. | FISCAL YEAR | SHEET NO. | TOTAL SHEETS |
|---------------------|--------|------------------|------------------|-------------|-----------|--------------|
| 5 | KANSAS | 3 | 190A(1) | 1944 | 37 | 107 |

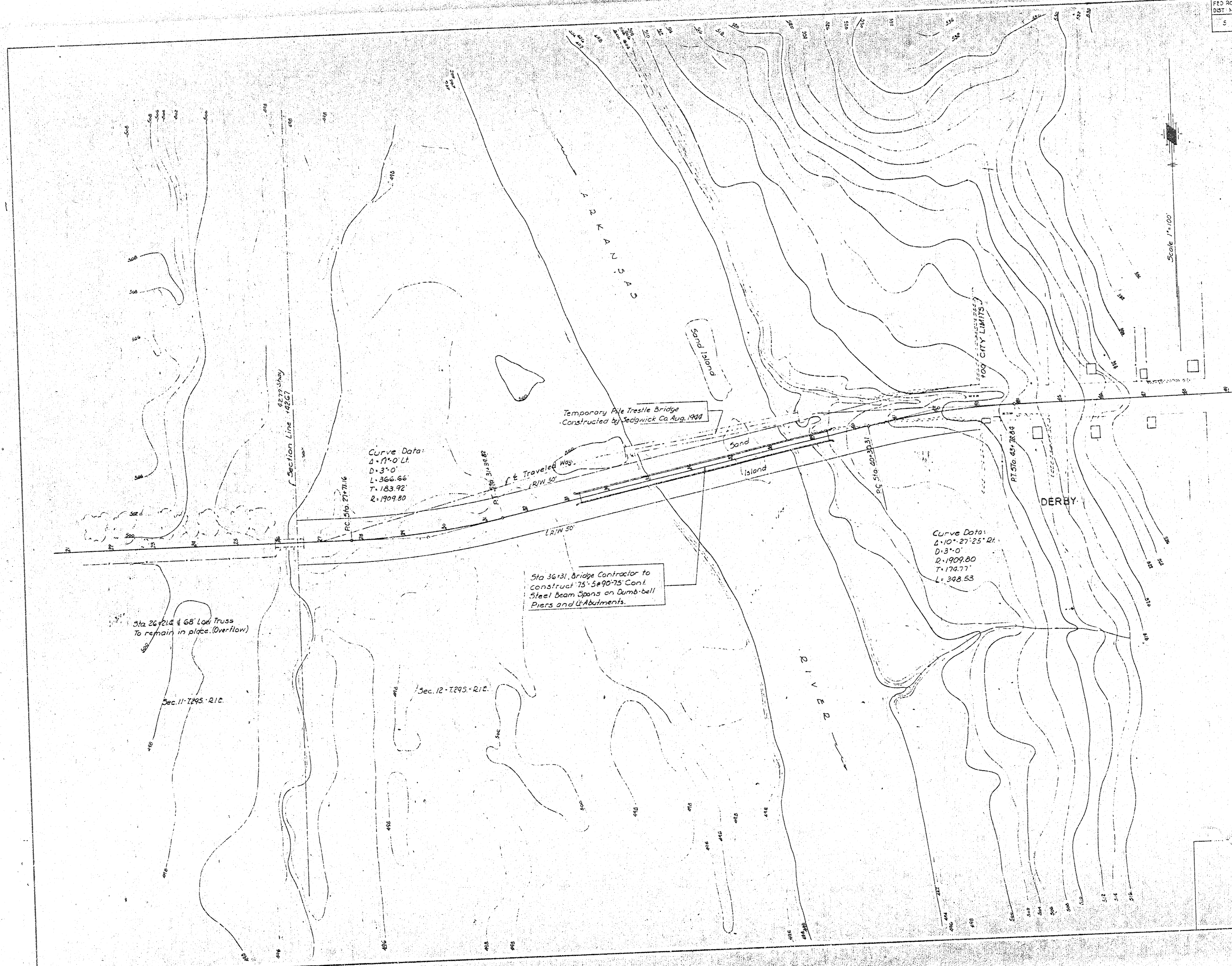

Curve Data:
 1-11°-0' LT
 D-370'
 L-366.66'
 T-183.92'
 2-1909.80'

Curve Data:
 1-10°-27'-25" RT
 D-370'
 L-1909.80'
 T-170.77'
 1-398.53'

Sta 36+31, Bridge Contractor to construct 75'-54'90" Cont. Steel Beam Spans on Dumb-bell Piers and Abutments.

Sta 26+01.4 4 68' Lrd Truss to remain in place. (Overflow)

Sec. 11-7295-21c

Sec. 12-7295-21c

- P.I. Ref. Sta 29+57.08
1" 2" 2" Tacked Hub @ P.I.
- P.O.T. Ref. Sta. 30+64.59
1" 2" 2" Tacked Hub @ P.O.T.
- P.O.T. Ref. Sta. 38+56.06
1" Iron Pin @ P.O.T.
- P.I. Ref. Sta. 42+05.08
1" Iron Pin @ P.I.

STA. 36+31
 CONTOUR MAP
 ARKANSAS RIVER BRIDGE NEAR DERBY
 WER-3 & FAS-190A(1) SEDGWICK CO.
 FINNEY & TURNIPSEED
 CONSULTING ENGINEERS
 TOPEKA, KANSAS

PLAN
 SHEET NO. 10
 DATE 7-23-22
 CHECKED BY
 DRAWN BY

PROFILE
 SHEET NO. 10
 DATE 7-23-22
 CHECKED BY
 DRAWN BY

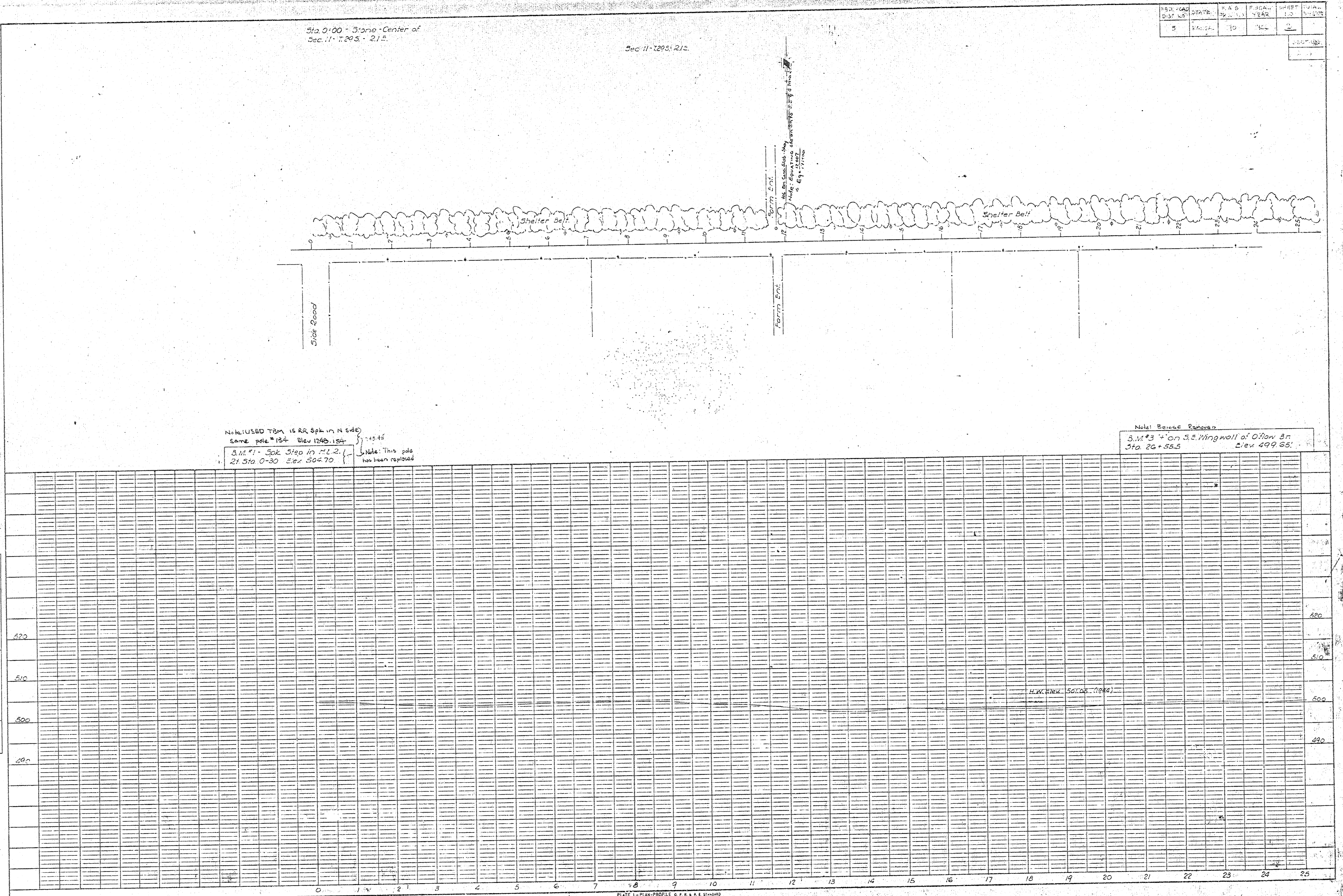

Note: USED TBM IS RR Spt in N 540 same pole #184 Elev 1240.154
 3.11' 1" Spt Sta 0+11.2 Elev 502.70
 21 Sta 0+30 Elev 502.70
 Note: This pole has been replaced

Note: Revised Elevation
 3.11' 3" on S.E. Wing wall of Otton Cr. Sta 26+55.5 Elev 499.65

| PER. NO. | DATE | BY | REVISION |
|----------|----------|------|----------|
| 5 | 10-27-20 | W.C. | |

| PROJ. NO. | DIST. NO. | STATE | V.E.R. | F.A.S. | FISCAL YEAR | SHEET NO. | TOTAL SHEETS |
|-----------|-----------|--------|--------|--------|-------------|-----------|--------------|
| 5 | | KANSAS | 5 | 190A0 | 1944 | 3 | 10 |

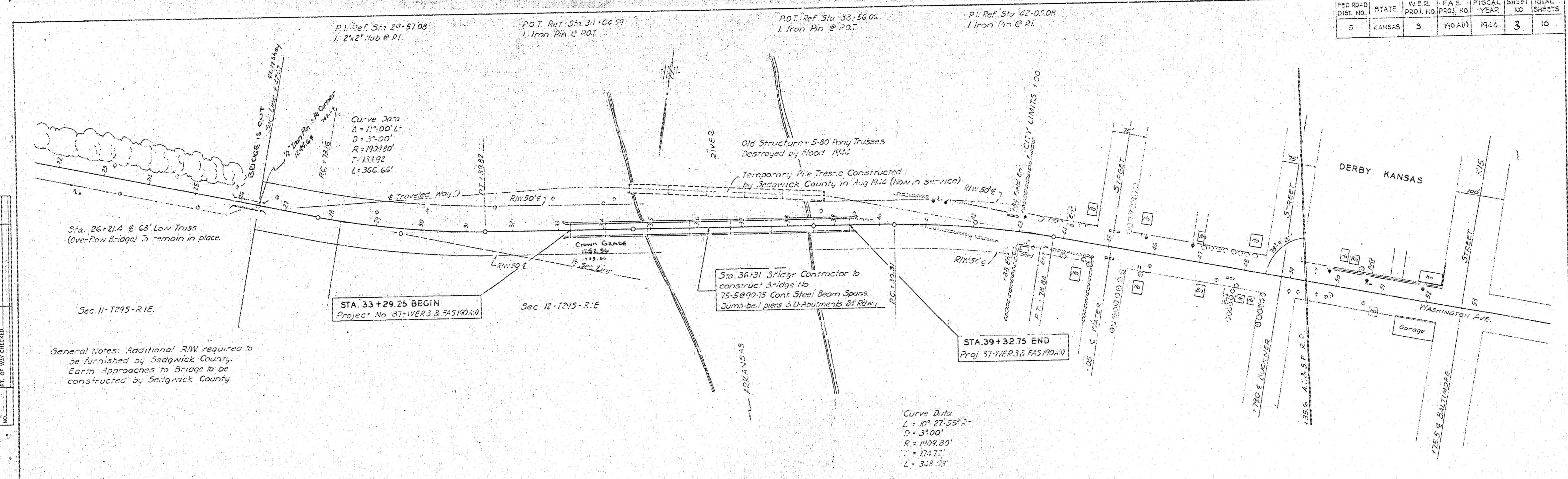

PLAN
 DATE
 DRAWN BY
 CHECKED BY
 IN CHARGE
 NO.

General Notes: Additional R/W required to be furnished by Sedgwick County. Earth Approaches to Bridge to be constructed by Sedgwick County.

PROFILE
 DATE
 DRAWN BY
 CHECKED BY
 IN CHARGE
 NO.

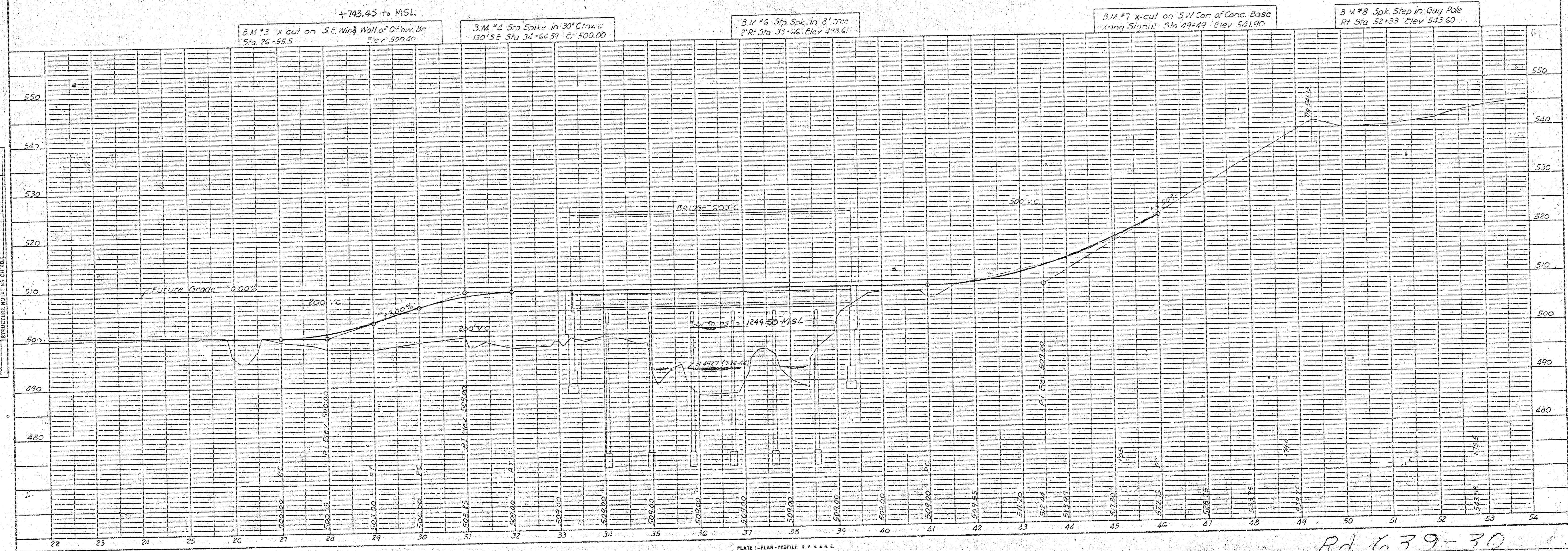
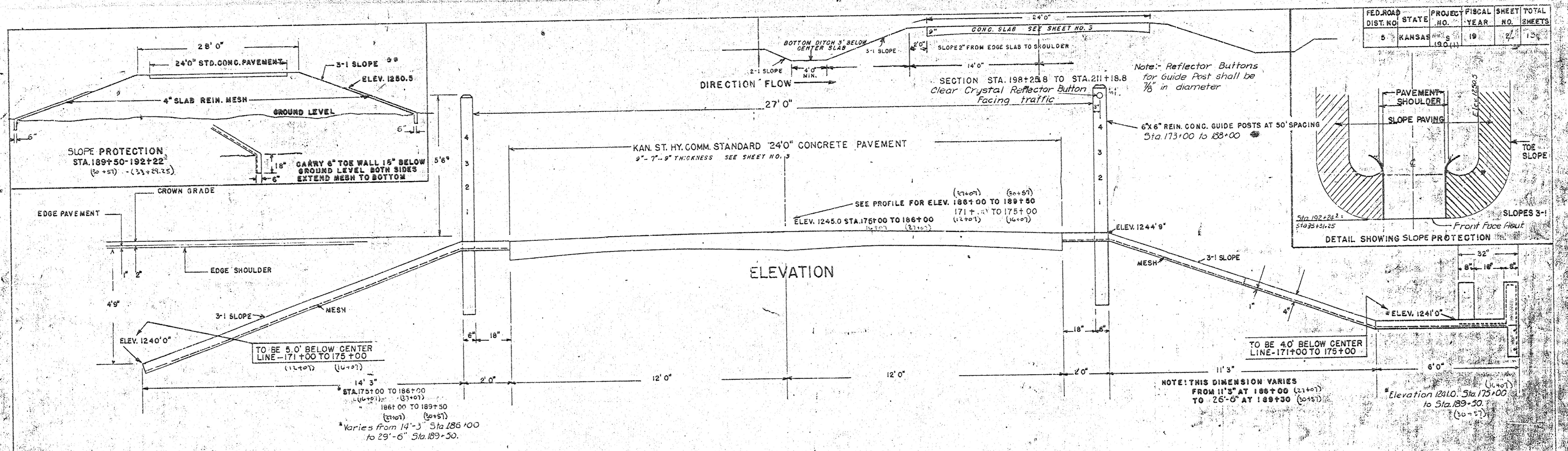
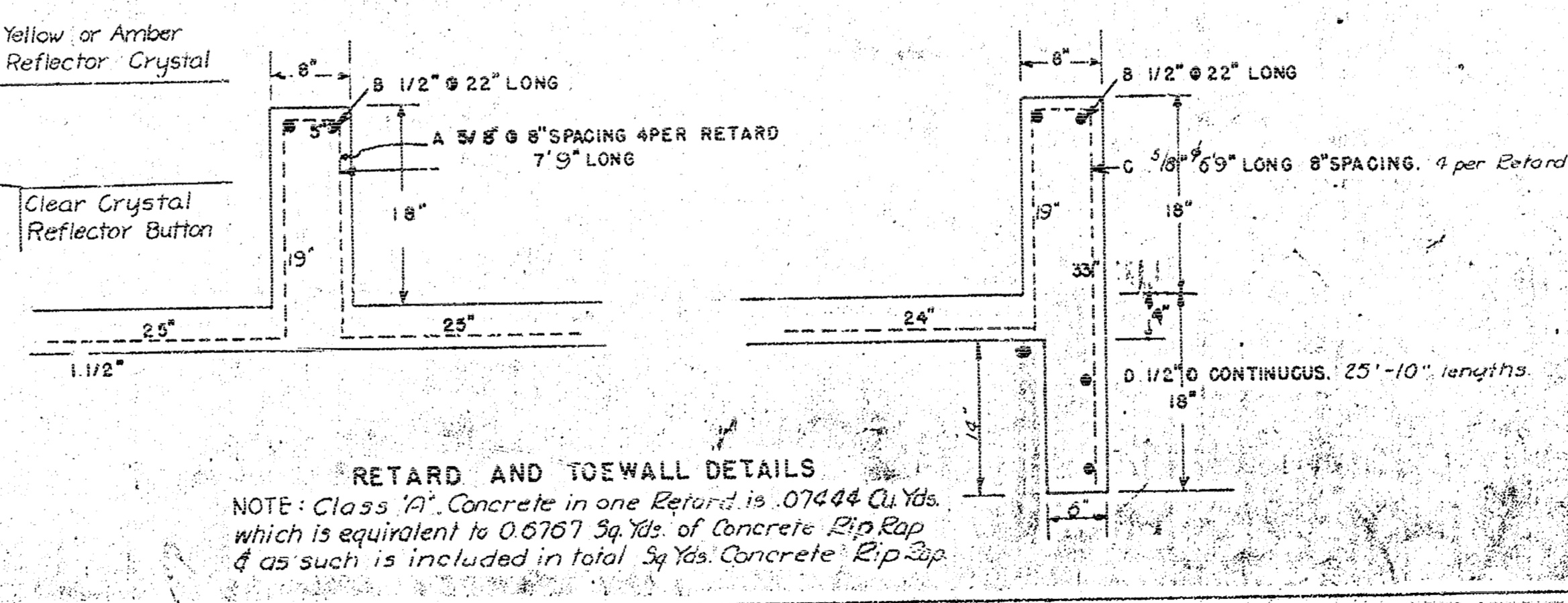
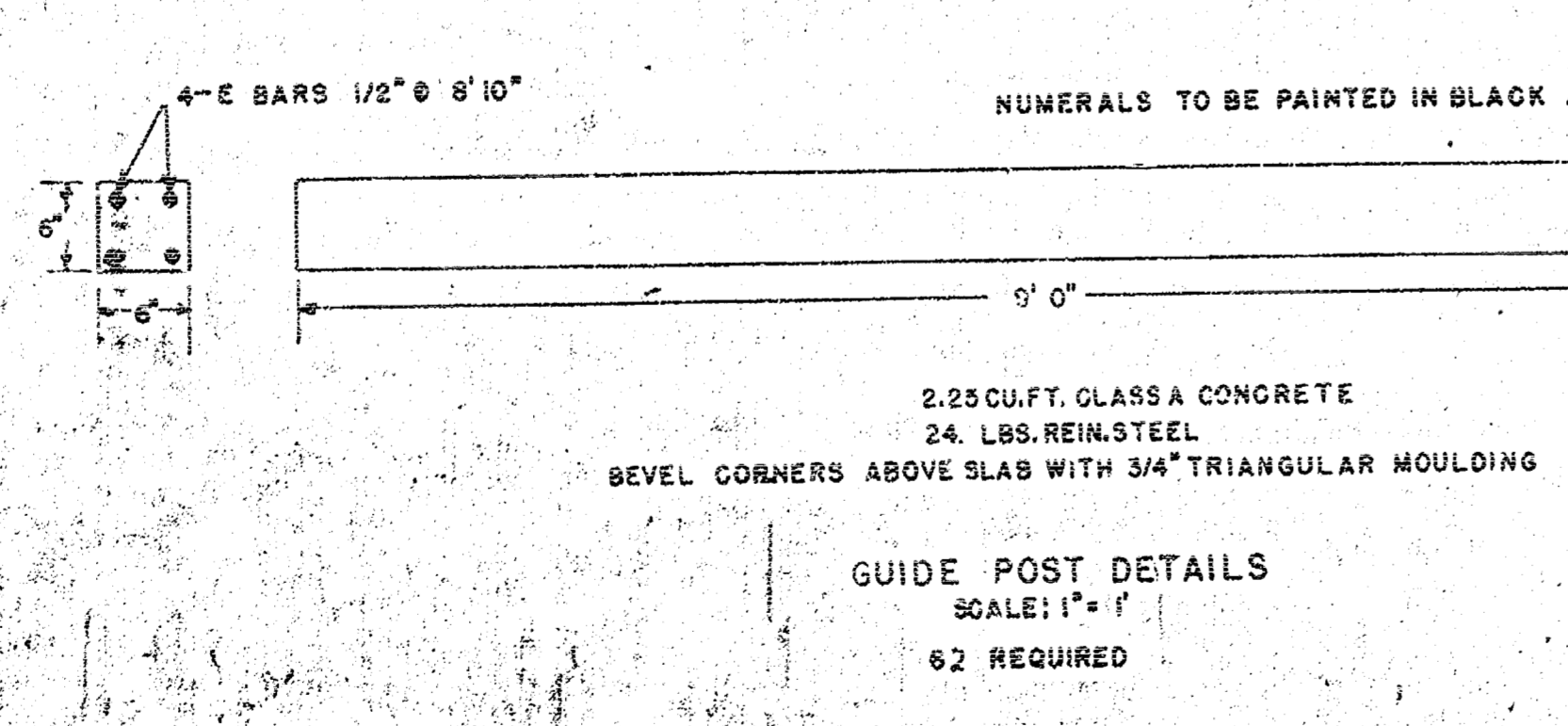
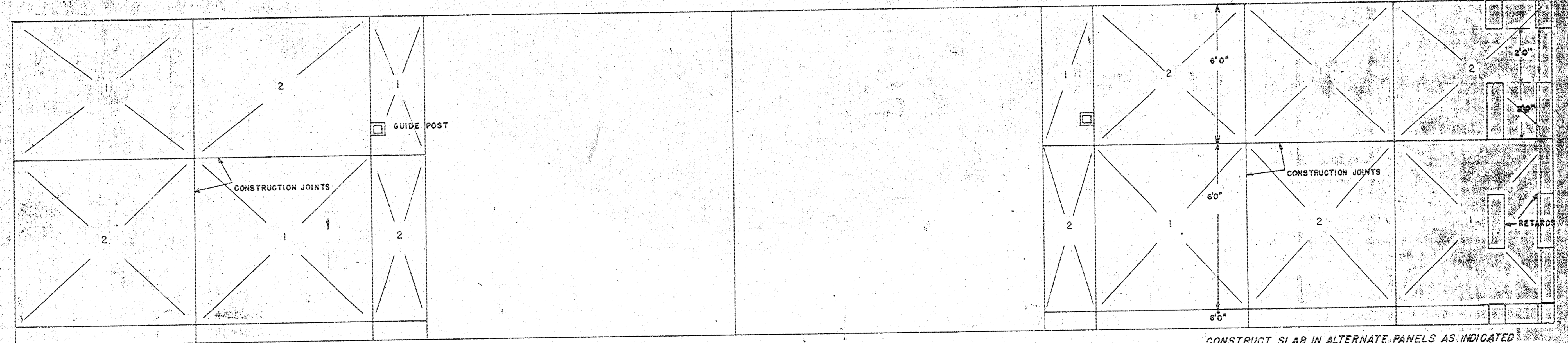

PLATE 1-PLAN-PROFILE OF P. & R. E.
 CHARLES HENNING COMPANY, INC.

Rd 639-30



| FED. ROAD DIST. NO. | STATE | PROJECT NO. | FISCAL YEAR | SHEET NO. | TOTAL SHEETS |
|---------------------|--------|-------------|-------------|-----------|--------------|
| 5 | KANSAS | 1961 | 19 | 10 | 10 |



CONSTRUCT SLAB IN ALTERNATE PANELS AS INDICATED

USE WIRE MESH NO. 4 GAUGE WIRES 12" LONG, 6" TRANS. SPACING

WIRE MESH SHALL BE CARRIED ACROSS CONTRACTION JOINTS.

LBS. REIN. BARS PER LIN. FT. 10.4 (FOR LEVEL SEC.)

SQ. FT. MESH 37.0

CU. YDS. CLASS A CONCRETE 0.5

QUANTITIES STA. 171+00 - 192+22³ (ROAD PAVEMENT NOT INCL.)

LBS. REIN. BARS 3,490

SQ. YDS. MESH 11,510

39,172 LB. TOTAL STEEL

59,172 Cu. Yds. Concrete Rip Rip

SPILLWAY PAVEMENT SECTION

STA. 171+00 TO STA. 189+50

| FED. ROAD DIST. NO. | STATE | H. E. R. PROJ. NO. | F. A. S. PROJ. NO. | FISCAL YEAR | SHEET NO. | TOTAL SHEETS |
|---------------------|--------|--------------------|--------------------|-------------|-----------|--------------|
| 5 | KANSAS | 3 | (190 A1) | 1944 | 5 | 10 |

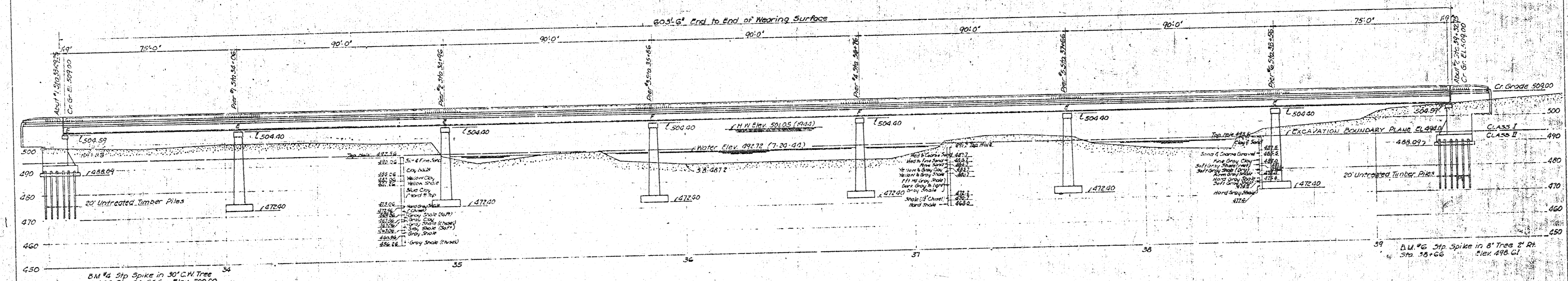

ELEVATION
75-5090-75 CONTINUOUS BEAM SPANS
DUMB-BELL PIERS & ABUTMENTS
24 FT. ROADWAY

GENERAL NOTES

DESIGN: A.A.S.T.O. Specs. 1941. H-15 Loading.
Structural Steel 18000 lbs. per sq. in.
Reinforcing Steel 20000 lbs. per sq. in.
Concrete 1200 lbs. per sq. in.

EXCAVATION: Elev. 494.00 shall designate the excavation boundary plane. Class I above the plane, Class II below. See "Bridge Excavation" sheet for limits of pay excavation.

REINFORCING STEEL: All reinforcing steel shall be billet steel, intermediate grade.

TEST PILES: Two untreated timber test piles shall be driven at the locations shown on the plans or as directed by the Engineer. Test piles shall be cut off two feet below ground level or removed at the option of the Contractor.

UNTREATED TIMBER PILES: All piles shall be driven to a minimum computed bearing value of 18 tons per pile. All piling shall be driven to a penetration into shale unless in the opinion of the Engineer, such penetration cannot be secured without injury to the pile.

SOUNDINGS: The soundings shown on these plans are taken from notes obtained in the field and represent the best information available to Sedgwick County.

TEMPORARY STRUCTURE: The existing temporary structure shall be removed by Sedgwick County after completion of new bridge.

SUMMARY OF QUANTITIES

| LOCATION | EXCAVATION | | CONCRETE | | STEEL | | BEARINGS | UNTREATED TIMBER PILES LIN. FT. | METAL PILE POINTS SQ. FT. |
|----------------|------------|----------|----------|--------|---------|---------|----------|---------------------------------------|---------------------------------|
| | CLASS I | CLASS II | CLASS A | REINF. | STRUCT. | DEVICES | | | |
| | Cu. Yds. | Cu. Yds. | Cu. Yds. | Lbs. | Lbs. | Lbs. | | | |
| Abut. #1 | 70 | 75 | 93.0 | 10080 | | | | 720 | 36 |
| Pier #1 | 80 | 272 | 63.5 | 10240 | | | | | |
| Pier #2 | 20 | 272 | 63.5 | 10240 | | | | | |
| Pier #3 | | 272 | 63.5 | 10240 | | | | | |
| Pier #4 | | 272 | 63.5 | 10240 | | | | | |
| Pier #5 | | 272 | 63.5 | 10240 | | | | | |
| Pier #6 | 40 | 272 | 63.5 | 10240 | | | | 720 | 36 |
| Abut. #2 | 185 | 75 | 93.0 | 10080 | | | | | |
| Superstructure | | | 451.7 | 60250 | 545270 | 8920 | | | |
| Test Piles | | | | | | | | 1440 | 72 |
| TOTALS | 395 | 1782 | 1018.7 | 141810 | 545270 | 8920 | | | |

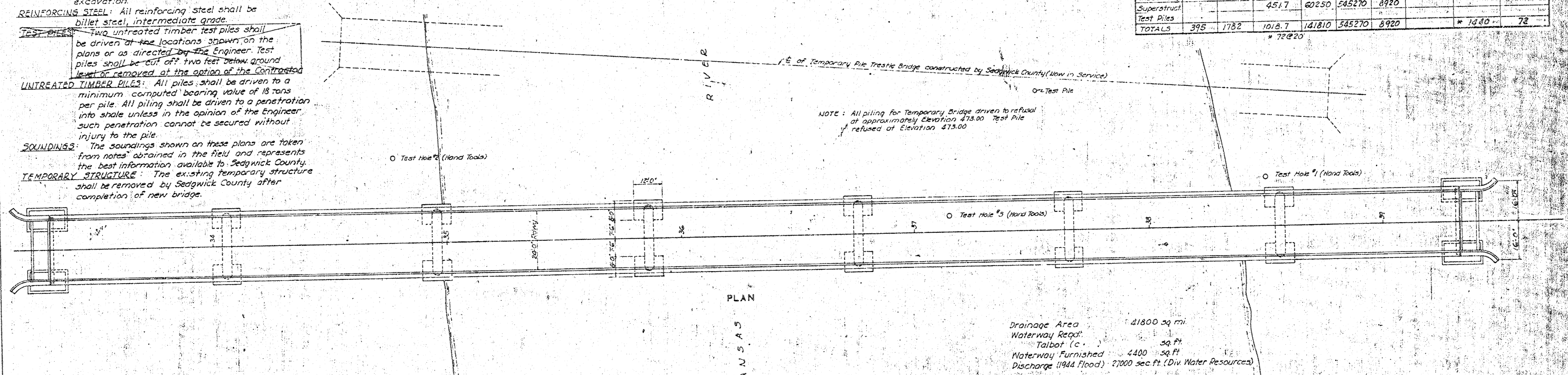

PLAN

Drainage Area 21800 sq. mi.
Waterway Road Talbot (c) 54 ft.
Waterway Furnished 4400 sq. ft.
Discharge (1944 Flood) 27000 sec. ft. (Div. Water Resources)

STA. 36+31
CONSTRUCTION LAYOUT
ARKANSAS RIVER BRIDGE NEAR DERBY
WER-3 & FAS-190 A (1) SEDGWICK CO.
FINNEY & TURNIPSEED
CONSULTING ENGINEERS
TOPEKA, KANSAS