

ARKANSAS RIVER

ARKANSAS RIVER

NOTE: ALL EXISTING AND PROPOSED UTILITIES SHOWN ARE BASED ON RECORD DRAWINGS AND FIELD SURVEY. THE ENGINEER HAS CONDUCTED VISUAL INSPECTIONS AND GENERAL VERIFICATION OF THE LOCATION AND DEPTH OF UTILITIES. THE USER OF THIS DRAWING SHALL BE RESPONSIBLE FOR OBTAINING NECESSARY PERMITS AND FOR VERIFYING THE LOCATION AND DEPTH OF UTILITIES PRIOR TO CONSTRUCTION.

SITE PLAN - EXISTING UTILITIES

40' 0"

WATER

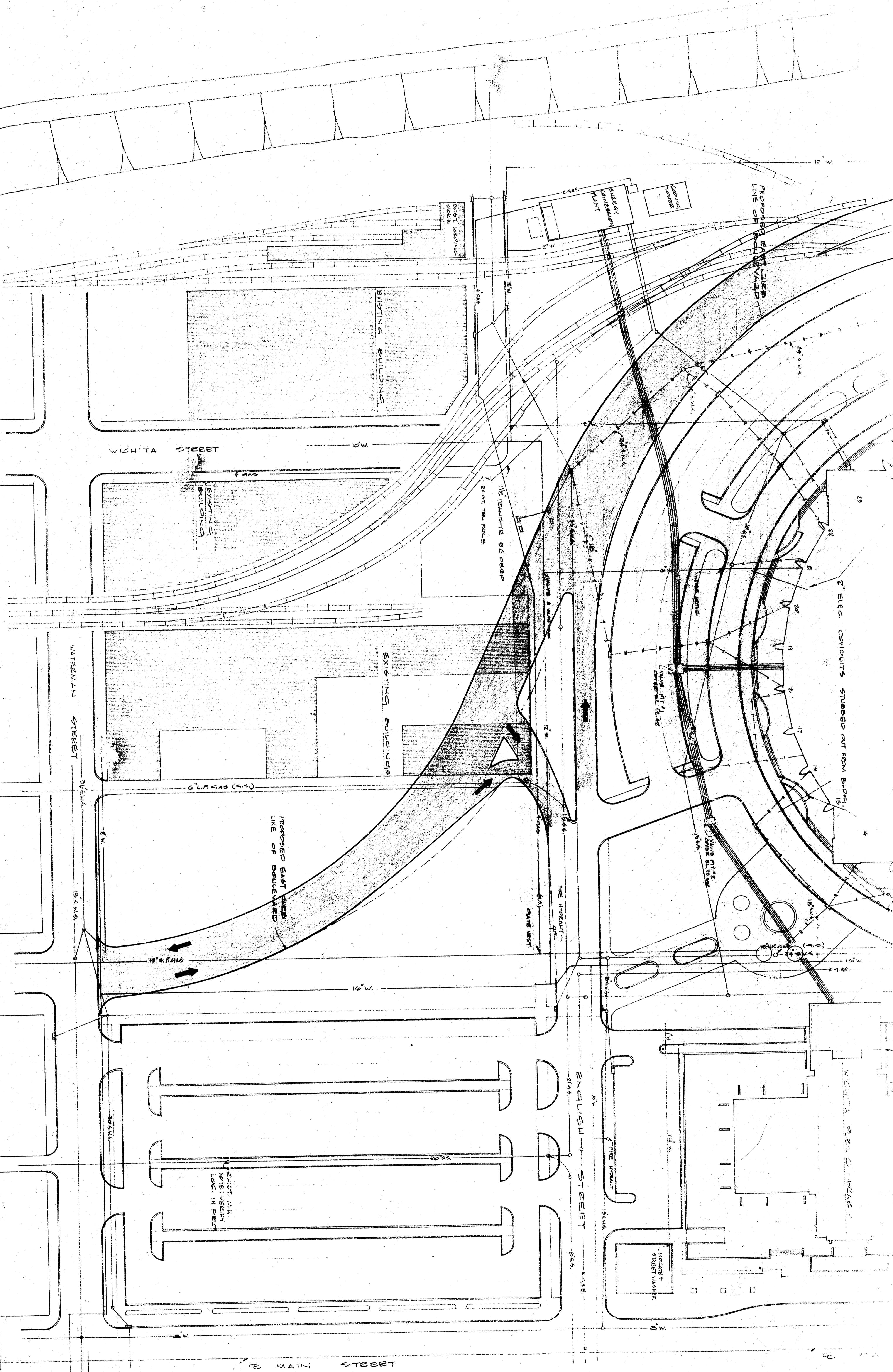

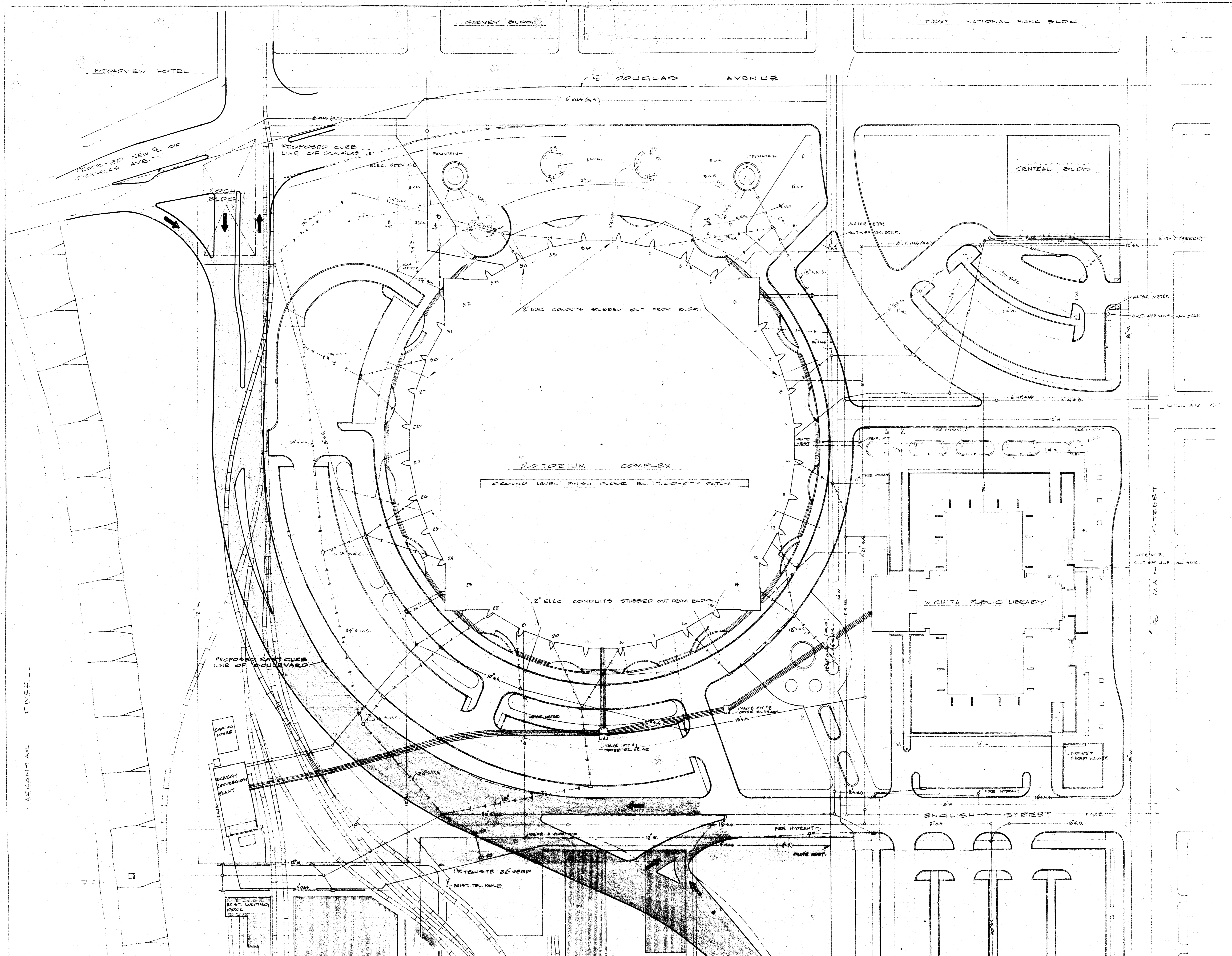

CIVIC CULTURAL CENTER
 CITY OF WICHITA, KANSAS

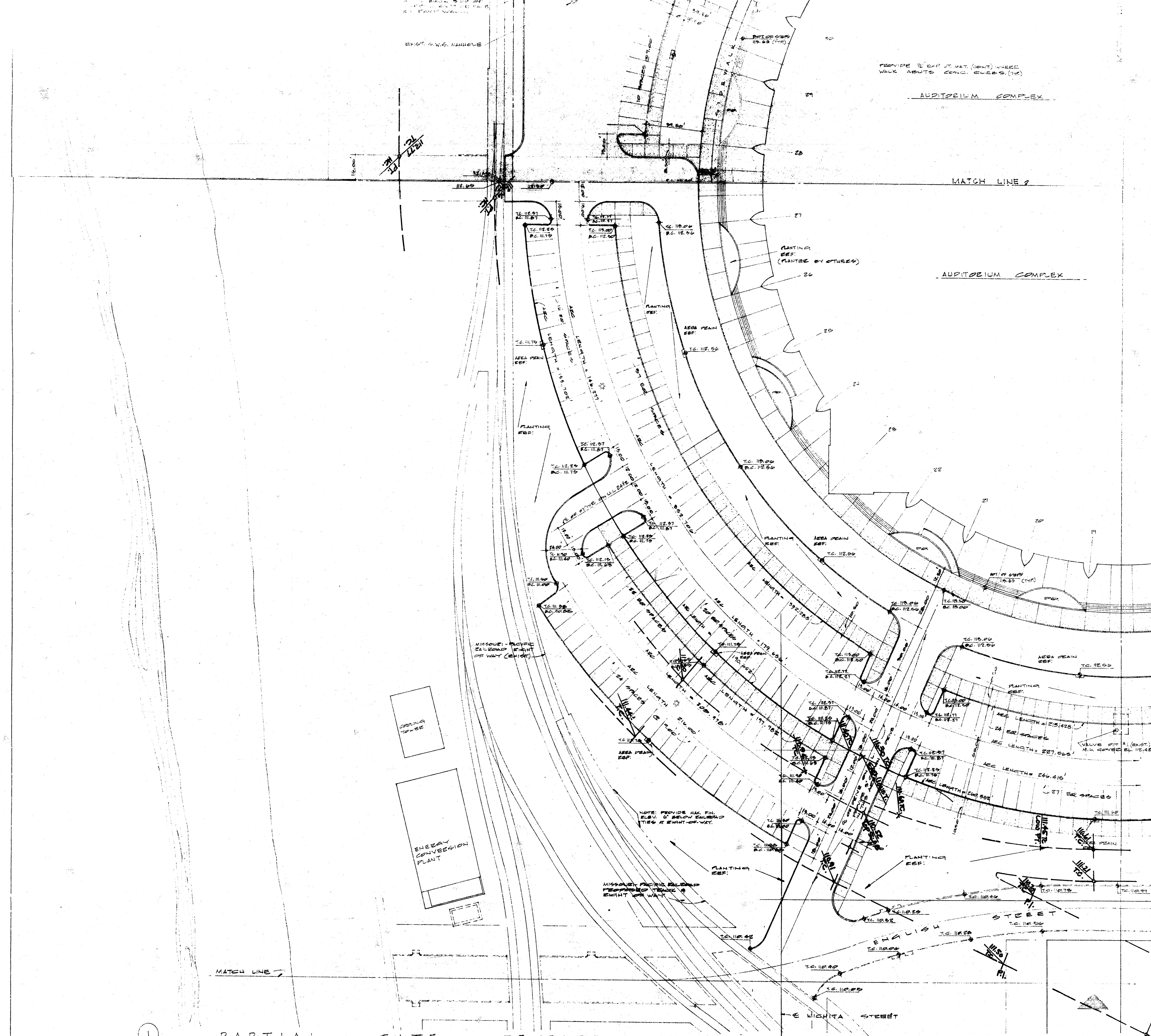

PROVIDE 1/2" EXP. UT. MAT. (CONT.) WHERE WALK ABOUTS CONC. SLABS (HP)

MATCH LINE 1

AUDITORIUM COMPLEX

AUDITORIUM COMPLEX

MATCH LINE 2

PARTIAL

COOLING TOWER

ENERGY CONVERSION PLANT

MISSOURI PACIFIC RAILROAD RIGHT OF WAY (EXIST)

MISSOURI PACIFIC RAILROAD PROPOSED TRACK & RIGHT OF WAY

NOTE: PROVIDE MAX. FIN. ELEV. 5' BELOW EXISTING TYP. AT RIGHT-OF-WAY

ENGLISH STREET

E WICHITA STREET

STREET



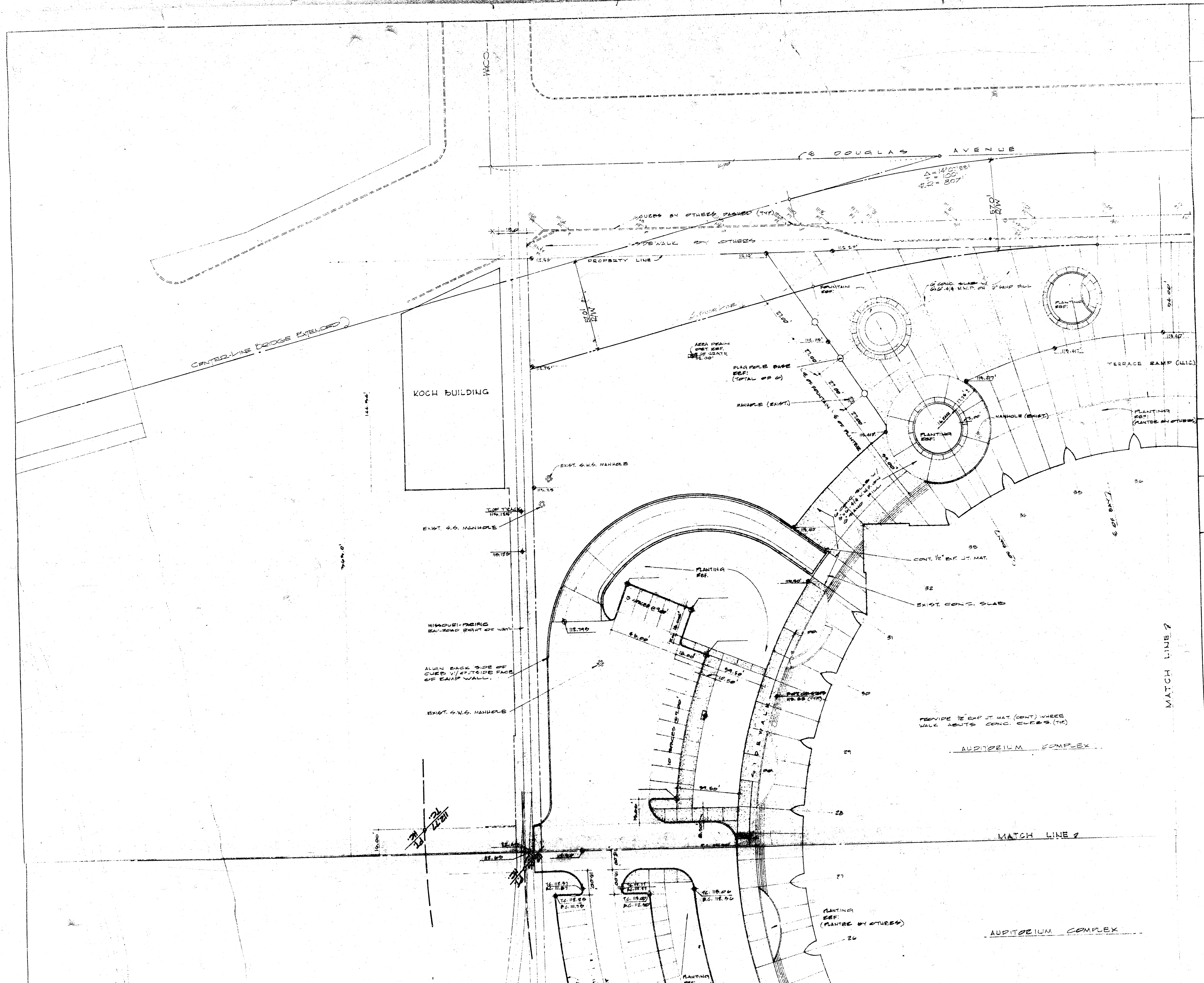

CENTERLINE BRIDGE EXTENDED

KOCH BUILDING

DOUGLAS AVENUE

WACO

PROPERTY LINE

EXIST. S.W.S. MANHOLE

EXIST. S.W.S. MANHOLE

MISSOURI PACIFIC RAILROAD RIGHT OF WAY

ALIGN BACK SIDE OF CURB WITH OUTSIDE FACE OF EAMP WALL

EXIST. S.W.S. MANHOLE

$$\Delta = 1420' \text{ EES}$$

$$T = 100'$$

$$E2 = 807'$$

AREA DRAIN (BY REF. SEE OF GRATE 11.00)

PLASTER BASE REF. (TOTAL OF 2)

MANHOLE (EXIST.)

CONC. SLAB ON SAND FILL

PLANTING REF.

MANHOLE (EXIST.)

PLANTING REF. (PLANTED BY OTHERS)

TERRACE RAMP (LLIC)

PLANTING REF.

CONT. 1/2" EXP. JT. MAT.

EXIST. CONC. SLAB

PROVIDE 1/2" EXP. JT. MAT. (CONT.) WHERE WALK ABUTS CONC. CURB (TH)

AUDITORIUM COMPLEX

MATCH LINE 2

AUDITORIUM COMPLEX

MATCH LINE 1

PROJECT ARCHITECT

DEVELOPER
CIVIC CULTURAL CENTER
CITY OF WICHITA, KANSAS

PROJECT