

12'x8'x150' R.C.B.C.
BROADWAY - 80' NORTH ϕ 55th ST. SO.

CITY OF WICHITA, KANSAS
D. SELLERS CITY ENGINEER

PROJECT NO. 468 76 245 80583 000 000 004

DATE:

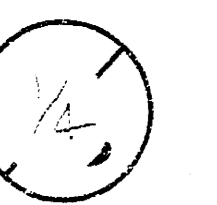
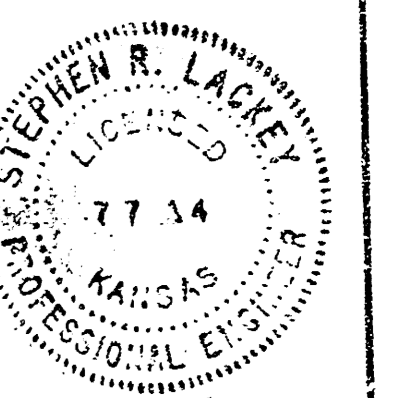
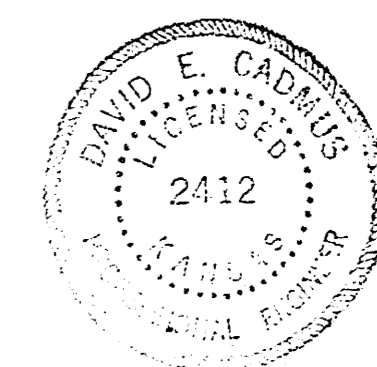
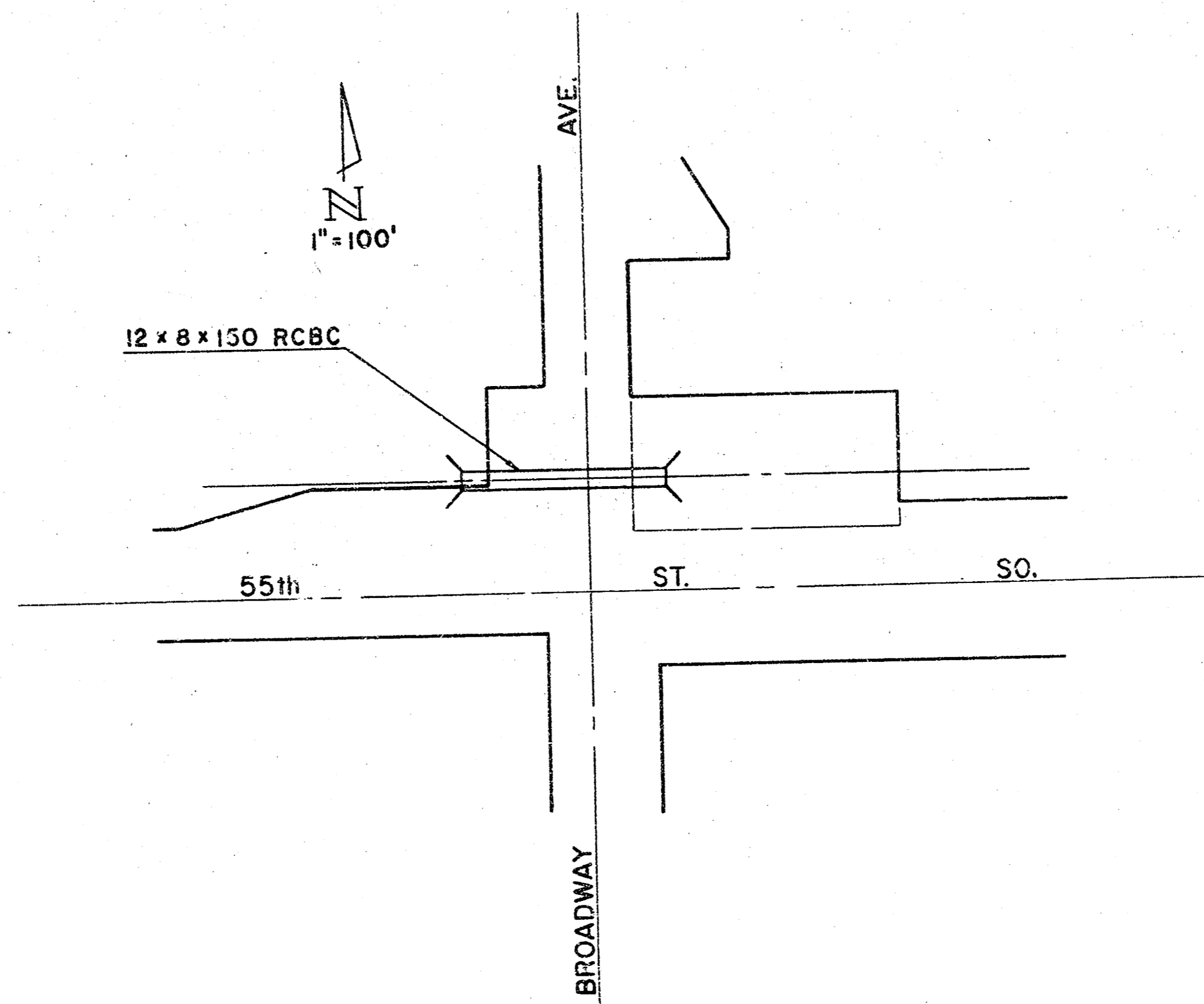

B.M. 82.58 C&G Sta. 0+00, 41.2' E of E. Broadway + 55th St. 30

NOTE: Construct 2" plank bulkheads and install over ends of pipe stubouts. 4 req'd. Pipe stubouts and bulkheads to be considered incidental to cost of R.C.B.C. construction.

Remove existing pavement for box construction. Replace with 8" Asph. Conc. Pav. (2" Surface, 6" Base)

Service Station Bldg, Conc. Pyl, Pumps, Tanks to be removed by Others. Before excavating for R.C.B.C. and channel, area is to be cross sectioned.

Inlet 3 pipe by Others. Sta. 220+3.87, State Hwy. Plans. Stub out 4 L.F. 36" R.C.P. from R.C.B.C. See Sht. # 4 for box opening detail. Fla. out Inlet 16.50. Fla. In R.C.B.C. 16.00.

Inlet 1 pipe by Others. Sta. 20+8.12, State Hwy. Plans. Stub out 2 L.F. 36" R.C.P. from R.C.B.C. See Sht. # 4 for box opening detail. Fla. out Inlet 16.50. Fla. In R.C.B.C. 16.00.

Inlet 1 pipe by Others. Sta. 47+0.44, State Hwy. Plans. Stub out 4 L.F. 36" R.C.P. from R.C.B.C. See Sht. # 4 for box opening detail. Fla. out Inlet 16.50. Fla. In R.C.B.C. 16.00.

Inlet 4 pipe by Others. Sta. 50+49.44, State Hwy. Plans. Stub out 4 L.F. 36" R.C.P. from R.C.B.C. See Sht. # 4 for box opening detail. Fla. out Inlet 16.00. Fla. In R.C.B.C. 16.35.

Extend width of exist. Pav. with 8" Asph. mat for detour. Provide barricades for channeling traffic.

Construct West Three 30' Sections of R.C.B.C. (90 L.F.)

Construct East Two 30' Sections of R.C.B.C. (60 L.F.)

Fill over completed section of R.C.B.C. and place 8" Asph. mat for detour around barricades for channeling traffic.

Note: Subgrade compaction in connection with paving the detour shall be considered incidental to cost of 8" Asph. Conc. (Base). Compaction over completed R.C.B.C. and 2" each side shall be paid for as C.V. compacted fill determined by the cross-sections.

2/6

12'x8' R.C.B.C.
BROADWAY - 80' NORTH
of 55th ST. SO.
CITY OF WICHITA, KANSAS
R.W. LINN - CITY ENGINEER
DATE
PROJ. NO. 468 76 345 80583 000 000 004

CONSTRUCTION SEQUENCE

1. THE 12' x 8' x 150' R.C.B.C. IS DESIGNED WITH FOUR KEYED JOINTS IN WALLS AND SLABS MAKING FIVE SECTIONS 30 FT. LONG. AS NOTED ON THE PLAN, THE CONTRACTOR, AT HIS OPTION, MAY SUBSTITUTE NO. 4 STEEL REINFORCING BARS FOR THE KEYED JOINTS (SEE NOTE SHEET NO. 3).
2. THE R.C.B.C. CONSTRUCTION SEQUENCE DETAIL (1), THIS SHEET, SHOWS THE EAST 60 L.F. (2-30' SECTIONS) OF THE R.C.B.C. IS TO BE CONSTRUCTED FIRST WHILE THE TRAFFIC IS DIVERTED BY DETOUR AROUND THE WEST END OF THE CONSTRUCTION AREA. THE NEW PAVEMENT FOR DETOUR SHALL BE 8" ASPHALTIC CONCRETE (BASE MATERIAL).
3. THE R.C.B.C. CONSTRUCTION SEQUENCE DETAIL (2), THIS SHEET, SHOWS THE WEST 90 L.F. (3-30' SECTIONS) OF THE R.C.B.C. IS TO BE CONSTRUCTED WHILE TRAFFIC IS DIVERTED BY DETOUR AROUND THE EAST END OF THE CONSTRUCTION AREA OVER THE COMPLETED 60 L.F. OF R.C.B.C. THE NEW PAVEMENT FOR DETOUR SHALL BE 8" ASPHALTIC CONCRETE (BASE MATERIAL).
4. TRAFFIC ENGINEERING SHALL POST THE SPEED LIMIT SIGNS OF 20 M.P.H., AND WILL PROVIDE TEMPORARY MARKINGS AS REQUIRED.
5. THE CONTRACTOR SHALL FURNISH AND MAINTAIN PROPER BARRICADES WITH FLASHERS FOR CHANNELING TRAFFIC SAFELY THROUGH THE DETOURS.
6. PRIOR TO PLACING THE 8" ASPHALTIC CONCRETE FOR DETOURS AND FOR REPLACING EXISTING PAVEMENT REMOVED, THE SUBGRADE SHALL BE COMPACTED TO CITY SPECIFICATIONS.
7. AFTER CONSTRUCTION IS COMPLETE, REMOVE ALL ASPHALT MAT USED FOR TEMPORARY DETOURS, AND FILL AND LEVEL GROUND.
8. ANY SPOIL NOT NEEDED FOR CONSTRUCTION MAY BE DISPOSED OF BY CALLING W. DALE COOPER OF ROBBINS REALTY AT 522-1587.

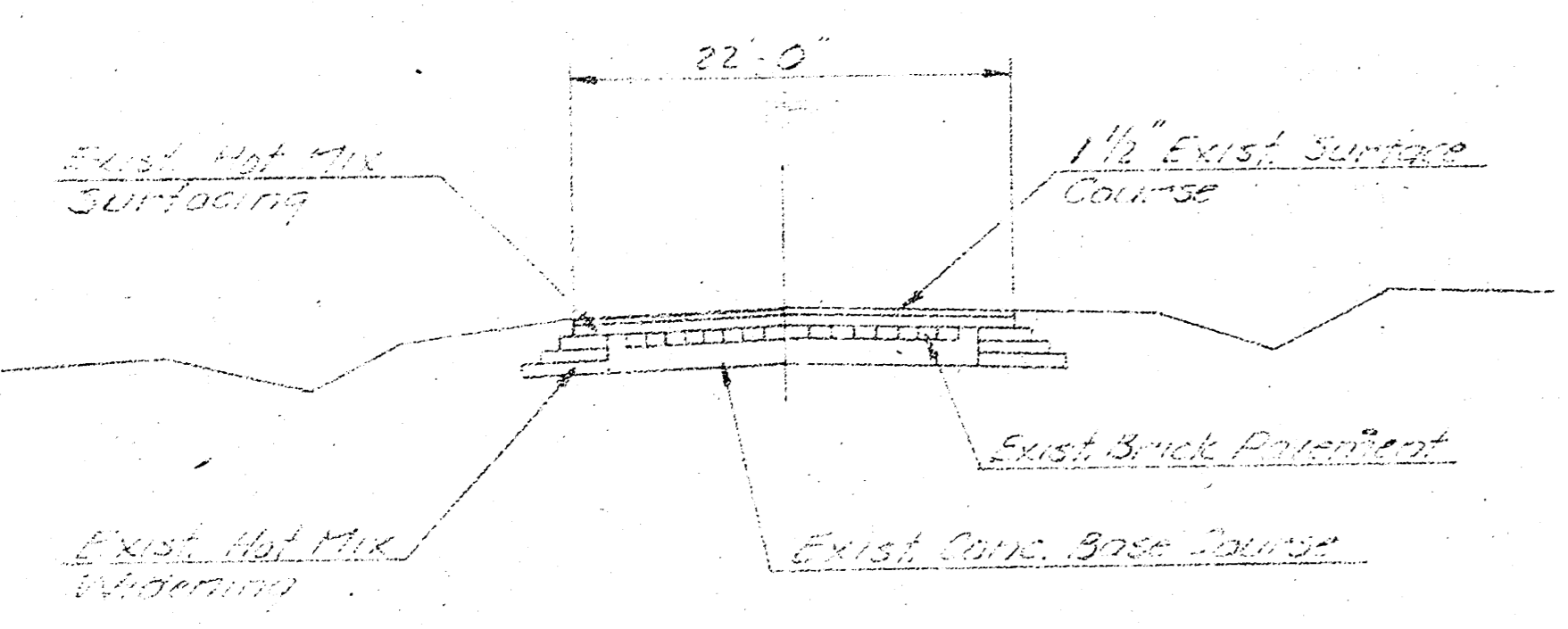

TYPICAL SECTION EXIST. ROADWAY

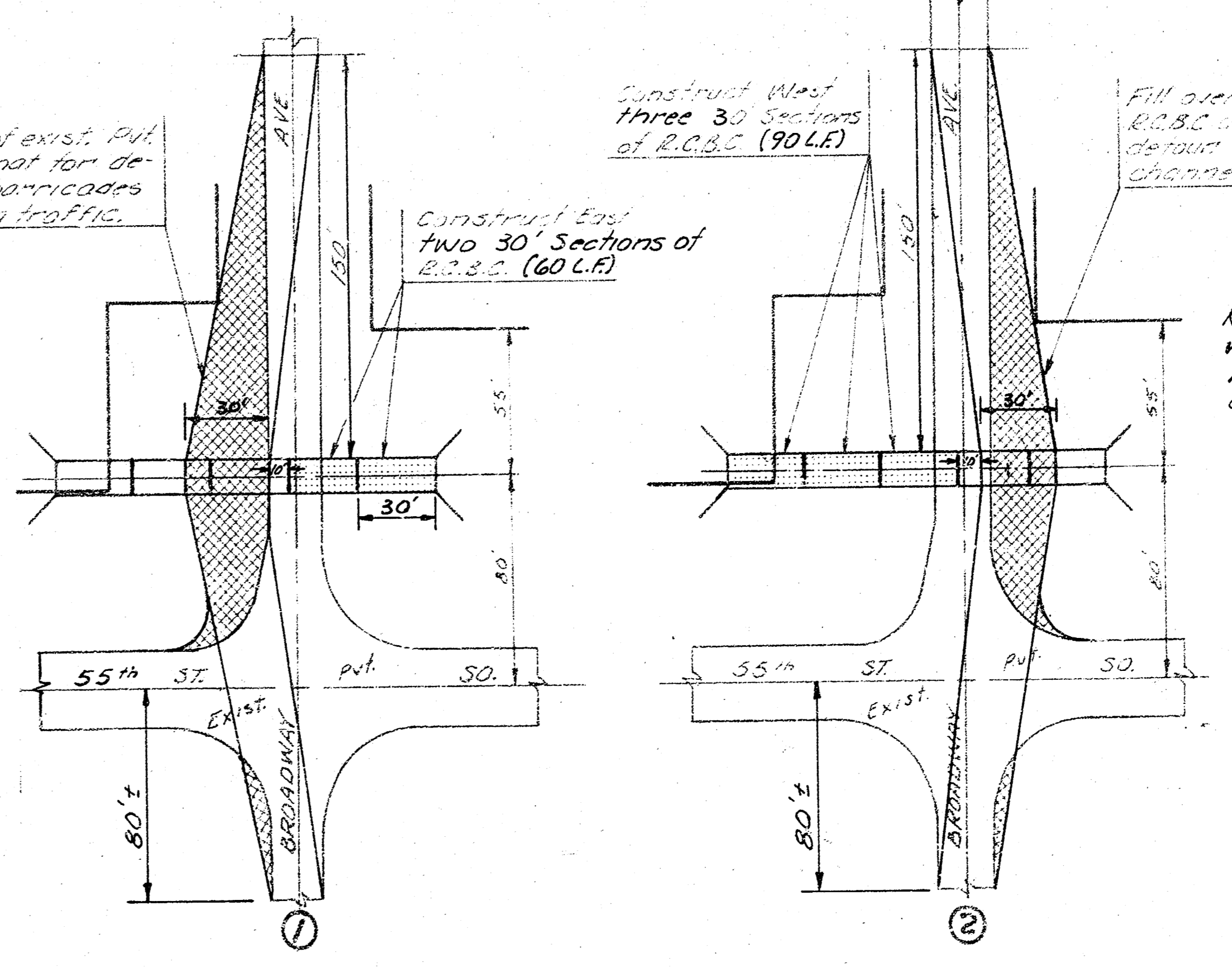

CONSTRUCTION SEQUENCE

