

# KELLOGG STREET (U.S. 54 HIGHWAY)

W.L. CHAUTAUQUA TO E.L. EDGE MOOR DRIVE AT  
INTERSECTIONS OF YALE, CLIFTON, BROADVIEW  
AND CRESTWAY.

LEFT TURN BAYS AND MEDIAL CUTS

PROJECT NO.-C10-52

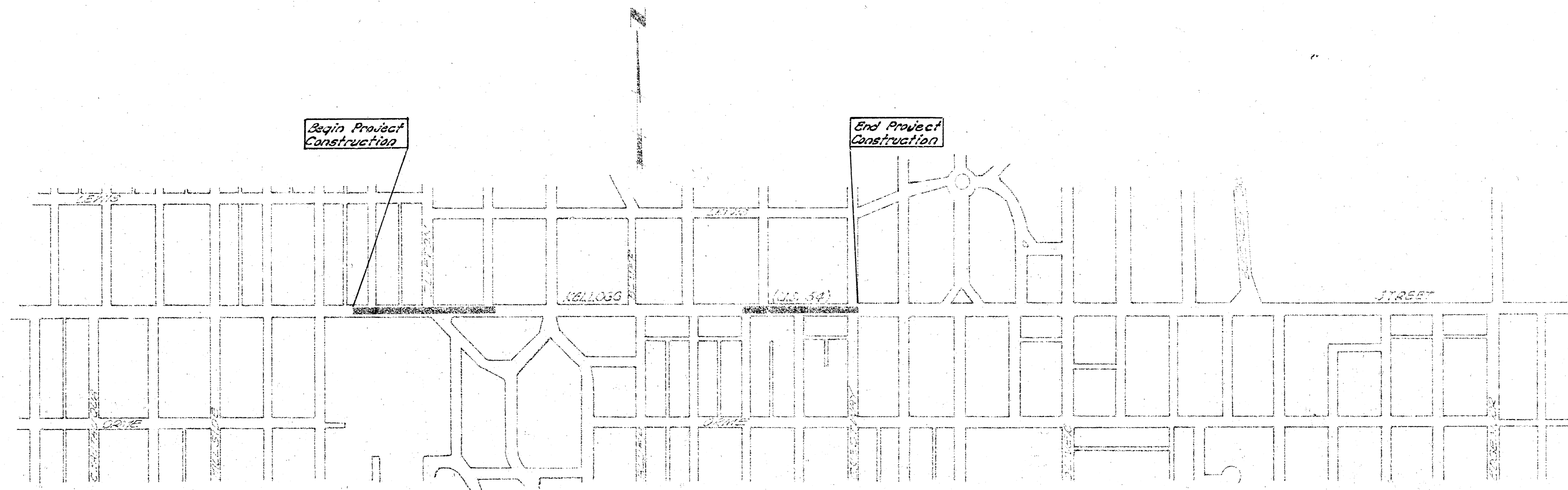

3

DATE: 10/1/52  
DRAWN BY: [illegible]  
CHECKED BY: [illegible]

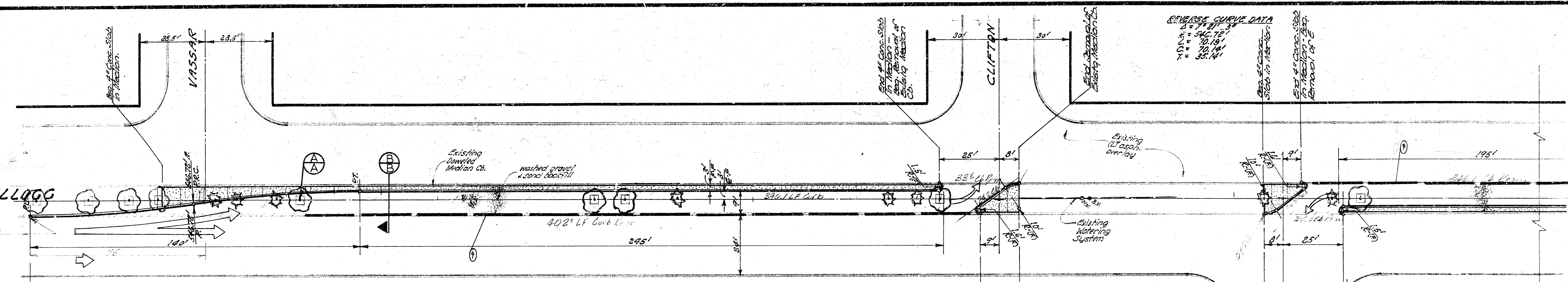

**REVERSE CURVE DATA**  
 $A = 79.21'$   
 $R = 546.72'$   
 $L = 70.19'$   
 $X = 35.14'$

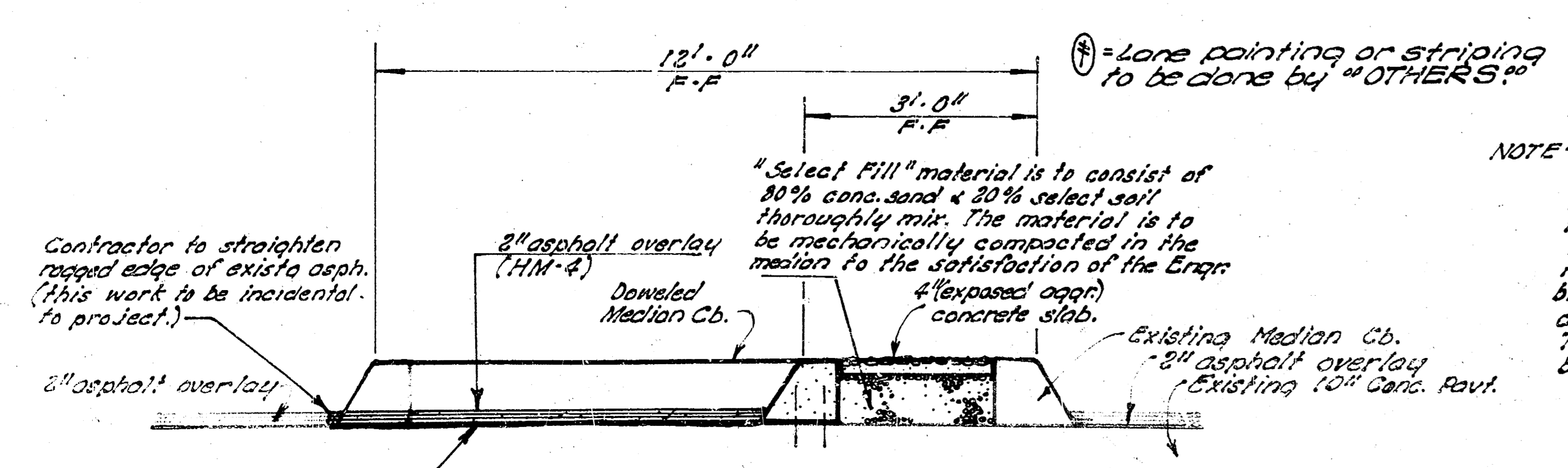

**NOTE** - Loose concrete, loose asphalt patches & all other loose material is to be removed prior to lock coat application. The cost of removing loose material & surface cleaning to be incidental to project.  
 Lock coat shall consist of from five-one hundredths (0.05) to one tenth (0.10) gallons per sq. yd. of the type & grade of bituminous material specified as (55-1H) the lock coat is incidental to the bit. item of base asphalt conc.  
 Traffic is to be maintained at all times thru construction by use of signs & flagmen.

**Asphalt Mix (MM-4)**  
 #4 Sieve 0%  
 #10 " 15-20%  
 #30 " 35-55%  
 #60 " 54-70%  
 #100 " 66-90%  
 #200 " 80-90%  
 #300 " 85-98%  
 P.I. not more than (.3)  
 Moisture in final mix (max) 0.35%

**TYPICAL SECTION B LEFT TURN UNIT**

▨ = Area to be asphalted

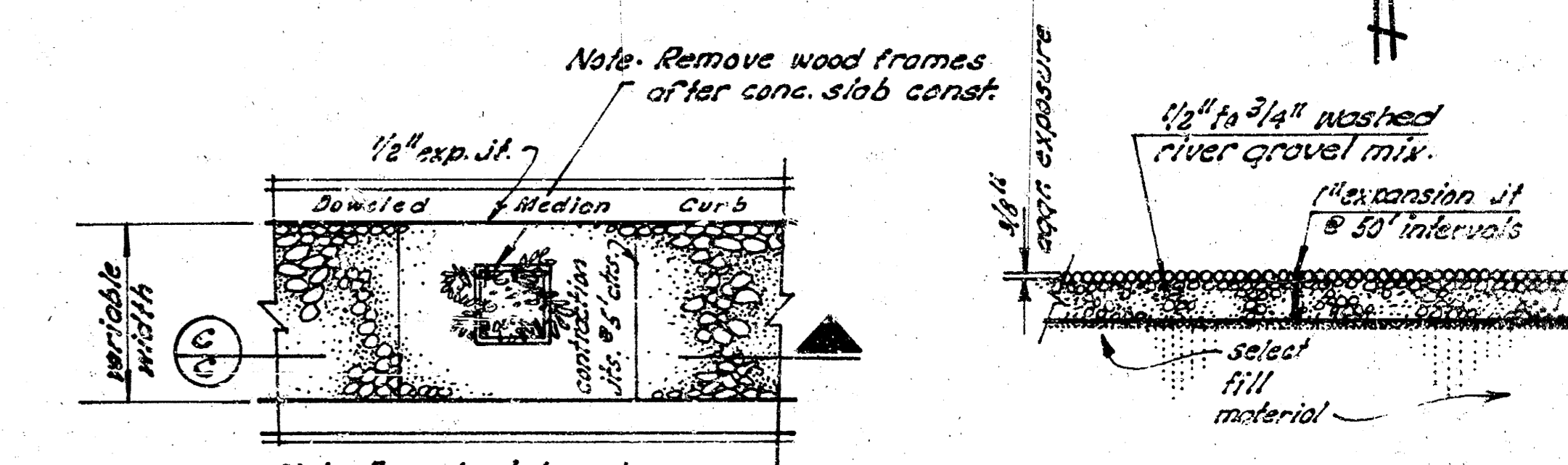
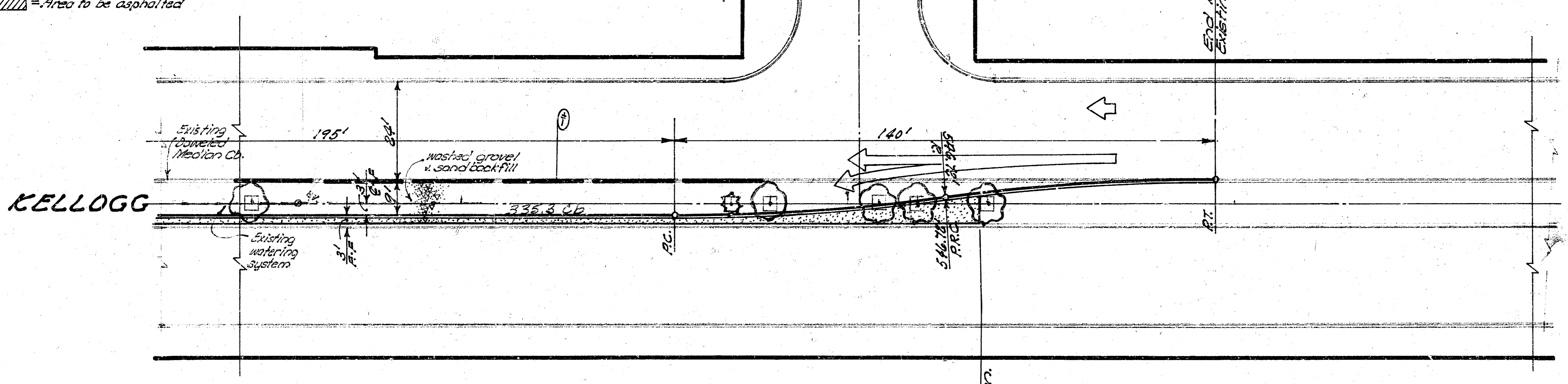

**4\"/>
 EXPOSED AGGREGATE CONCRETE SLAB DETAIL**

**Mix**  
 $o/a = 1940$   
 $f/a = 1322$   
 $c = 517$   
 $3779$   
 $air = 50 \text{ cc./cy.}$   
 $3/4\"/>
 washed gravel 2.5 to 3.4 p.m.$   
 (Dolese Bros. Design Mix)

**NOTE TO CONTRACTOR & ENGR.** - Watering Systems to remain in place where ever possible by re-location of bucket valves, plugging existing lines or meter pit locations to outside limits of proj. Work to be done by 'OTHERS'.

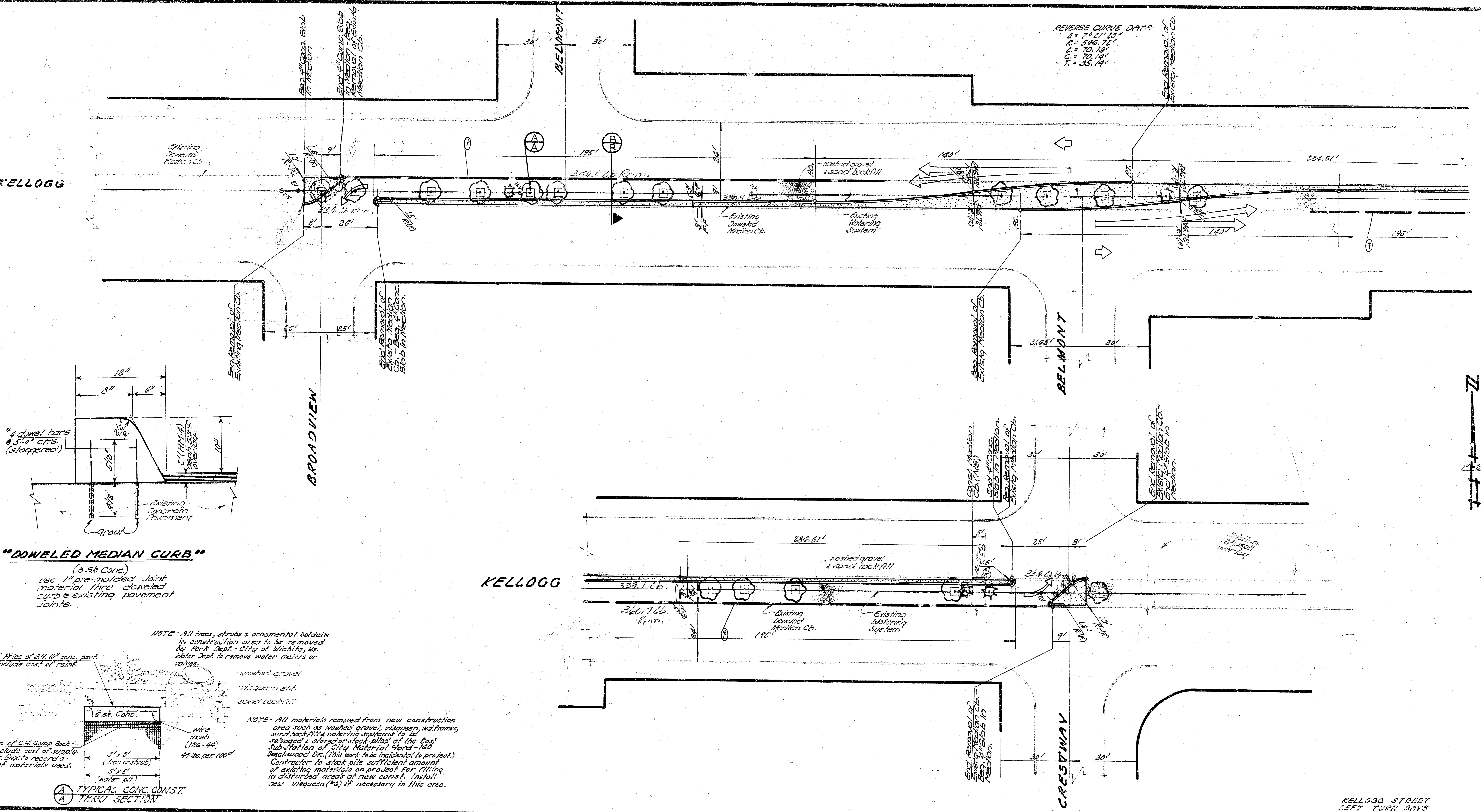

REVERSE CURVE DATA

L	= 70.23'
R	= 596.75'
L	= 70.19'
L	= 70.19'
T	= 35.14'

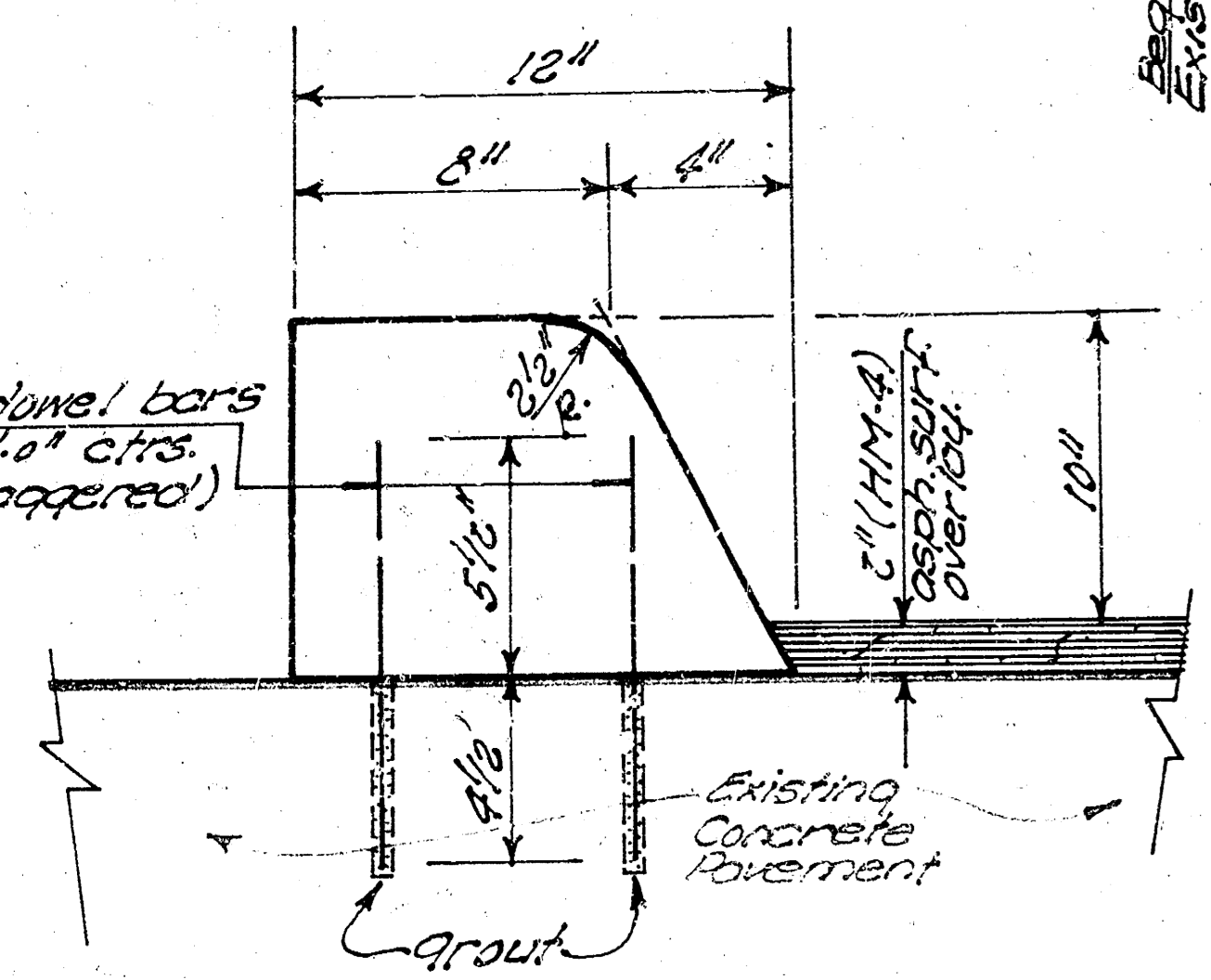

**"DOWELED MEDIAN CURB"**  
 (3.5k Conc.)  
 use 1/4" pre-molded joint material thru doweled curb @ existing pavement joints.

NOTE - All trees, shrubs & ornamental holders in construction area to be removed by Park Dept. - City of Wichita, Kas. Water Dept. to remove water meters or valves.

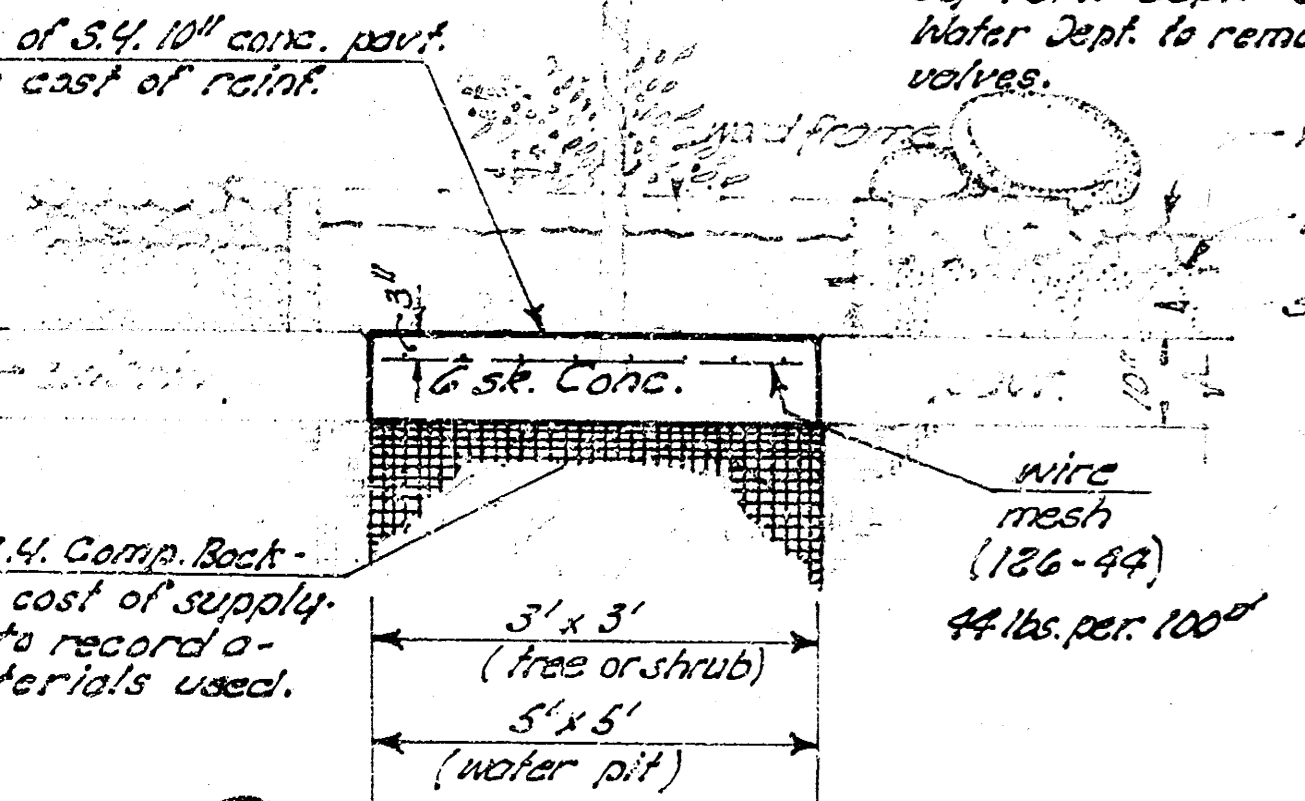

NOTE - All materials removed from new construction area such as washed gravel, visqueen, wd frames, sand backfill & watering systems to be salvaged & stored or stock-piled at the East Sub-Station of City Material Yard - 160 Beachwood Dr. (This work to be incidental to project.) Contractor to stock pile sufficient amount of existing materials on project for filling in disturbed areas of new const. Install new visqueen (1/2") if necessary in this area.

KELLOGG STREET LEFT TURN BAYS