

BENCH MARK: Top of Iron at S.W. Corner Lot 1,
Kinkaid Park 5th Addition,
Elev. 98.20 City Datum

1"=5' VERT
1"=10' HORIZ

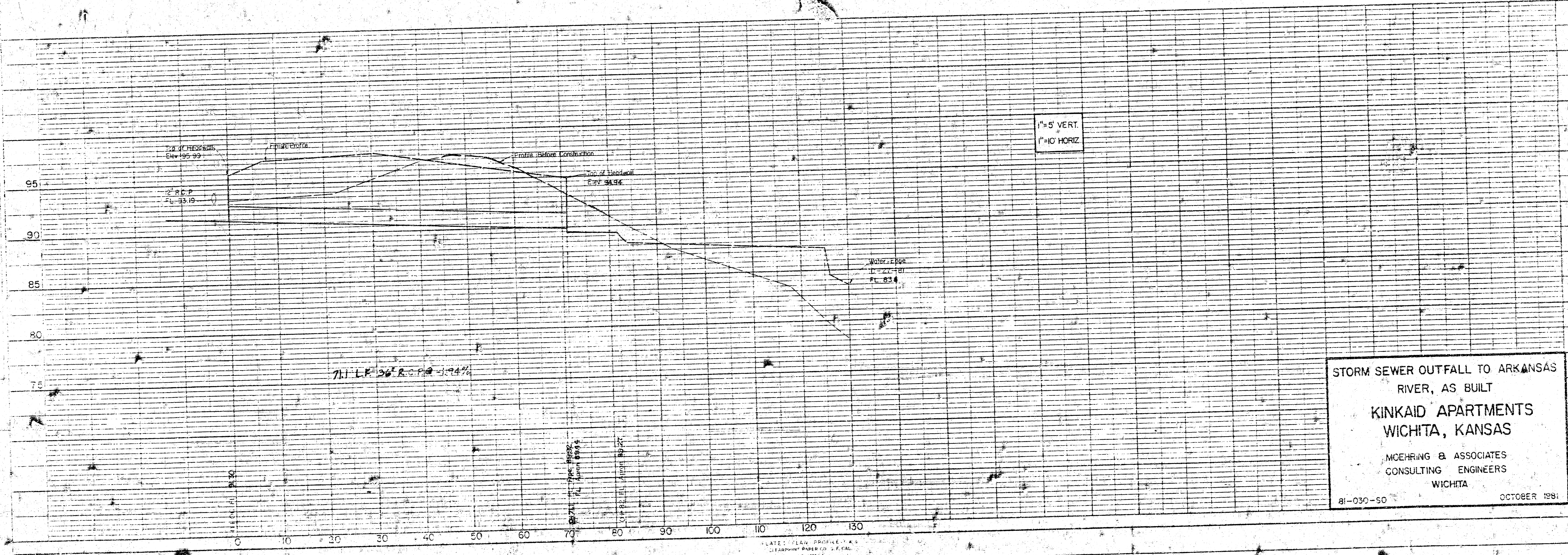

STORM SEWER OUTFALL TO ARKANSAS
RIVER, AS BUILT
KINKAID APARTMENTS
WICHITA, KANSAS
MCEHRING & ASSOCIATES
CONSULTING ENGINEERS
WICHITA
81-030-50 OCTOBER 1981

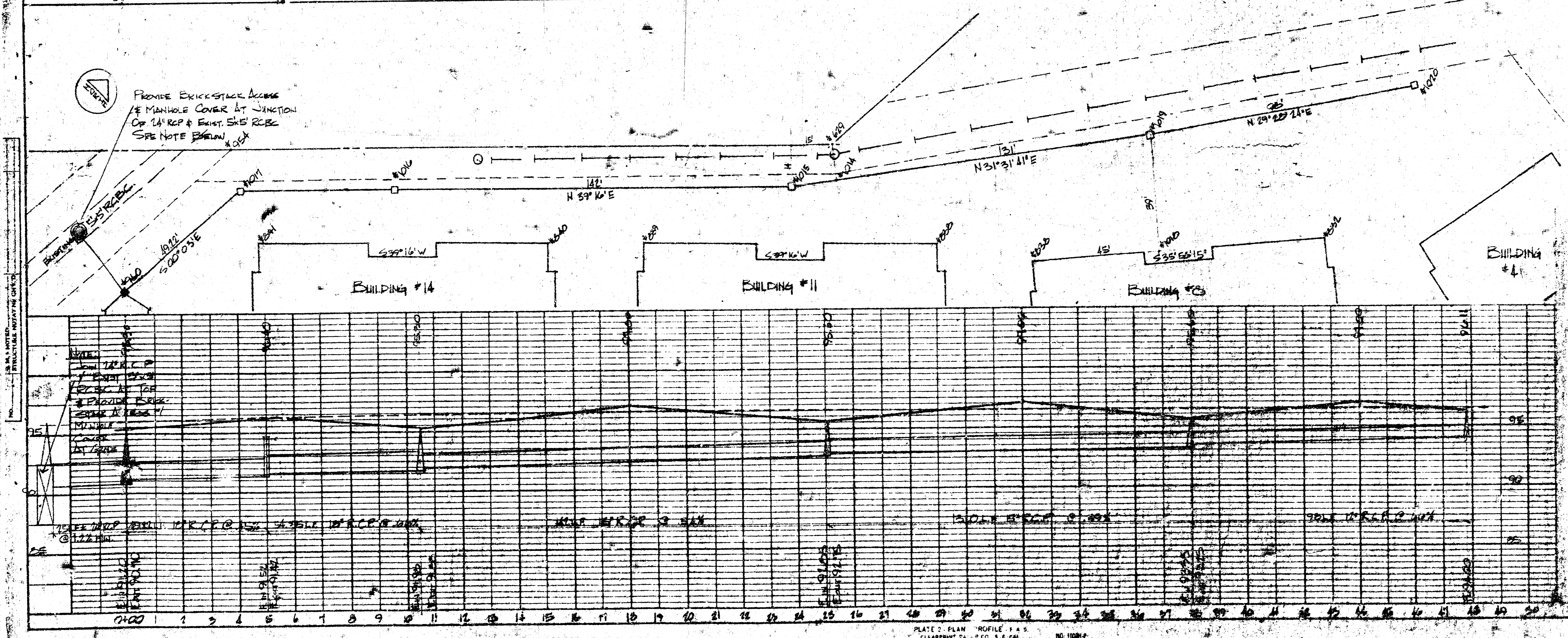
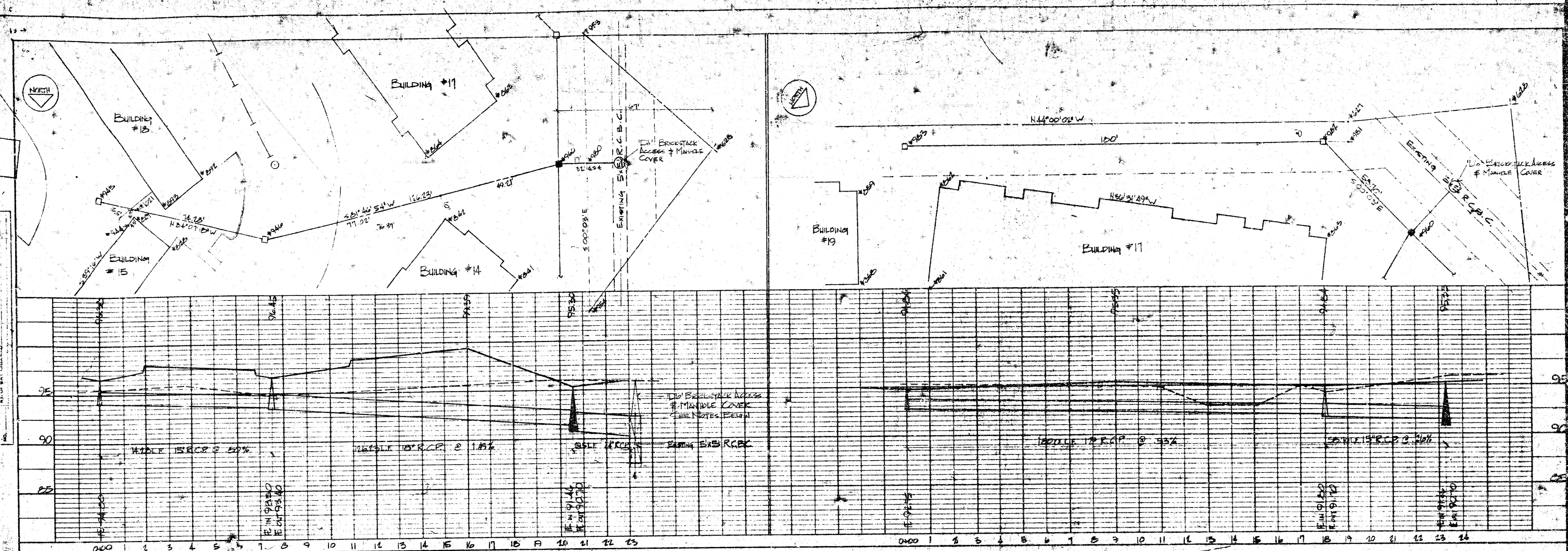

SITE LOCATION COORDINATES

Design Coordinates (G.D.)
 +9620 @ North Main
 +9620 @ South Main

NOTE: Refer to Kinkaid Park Apts. #1 for details of adjacent buildings.

LINE	COORDINATE	DESCRIPTION
1	9620.00	North Main
2	9620.00	North Main
3	9620.00	North Main
4	9620.00	North Main
5	9620.00	North Main
6	9620.00	North Main
7	9620.00	North Main
8	9620.00	North Main
9	9620.00	North Main
10	9620.00	North Main
11	9620.00	North Main
12	9620.00	North Main
13	9620.00	North Main
14	9620.00	North Main
15	9620.00	North Main
16	9620.00	North Main
17	9620.00	North Main
18	9620.00	North Main
19	9620.00	North Main
20	9620.00	North Main
21	9620.00	North Main
22	9620.00	North Main
23	9620.00	North Main
24	9620.00	North Main
25	9620.00	North Main
26	9620.00	North Main
27	9620.00	North Main
28	9620.00	North Main
29	9620.00	North Main
30	9620.00	North Main
31	9620.00	North Main
32	9620.00	North Main
33	9620.00	North Main
34	9620.00	North Main
35	9620.00	North Main
36	9620.00	North Main
37	9620.00	North Main
38	9620.00	North Main
39	9620.00	North Main
40	9620.00	North Main
41	9620.00	North Main
42	9620.00	North Main
43	9620.00	North Main
44	9620.00	North Main
45	9620.00	North Main
46	9620.00	North Main
47	9620.00	North Main
48	9620.00	North Main
49	9620.00	North Main
50	9620.00	North Main

LAWRENCE E. WELLS
 ARCHITECT
 254 LAURA, SUITE 205
 WICHITA, KANSAS 67211

KINKAID PARK APPTS.
 FOR
 KINKAID, INC.
 WICHITA, KANSAS
 MARION and SOUTH TOPEKA
 PLAN NO. C-3E2 PROJECT 545

SHEET 7 OF 7
 3/3