

14' X 75' TEMPORARY STREET TURN AROUND EASEMENT (THIS EASEMENT WILL BE VOID AT THE TIME EDMORE DRIVE IS EXTENDED NORTH)

HEDGE ROW

10' UTILITY EASEMENT

EMERGENCY OVERFLOW SWALE TO EXIST' GRADE (OFF)

THE DEVELOPER AGREES TO PAY FOR RELOCATION OF THE 24" RCP FROM M.H. 140 TO STA. 2+48 IF NECESSARY DUE TO IMPROVING THE DRAINAGE OUCH TO THE NORTH.

LOCATE OUTSIDE OF M.H. MIN. OF 5' FROM EACH EASEMENT PHASE II PHASE III

ST. 5+45 24" X 12" FLARED END SECTION

24" X 12" JUMPED CURVED TYPED III

FL. 54.22 TREE

ST. 2+08 EXIST' M.H. PL. 57.50

ST. 2+48 CONCT. M.H. FL. 58.41 (4) FL. 58.75 (OUT)

ST. 2+48 EXIST' M.H. PL. 57.50

ST. 2+48 EXIST' M.H. PL. 57.50

ST. 2+48 EXIST' M.H. PL. 57.50

ST. 2+48 EXIST' M.H. PL. 57.50

ST. 2+48 EXIST' M.H. PL. 57.50

ST. 2+48 EXIST' M.H. PL. 57.50

ST. 2+48 EXIST' M.H. PL. 57.50

ST. 2+48 EXIST' M.H. PL. 57.50

ST. 2+48 EXIST' M.H. PL. 57.50

ST. 2+48 EXIST' M.H. PL. 57.50

ST. 2+48 EXIST' M.H. PL. 57.50

ST. 2+48 EXIST' M.H. PL. 57.50

ST. 2+48 EXIST' M.H. PL. 57.50

ST. 2+48 EXIST' M.H. PL. 57.50

ST. 2+48 EXIST' M.H. PL. 57.50

ST. 2+48 EXIST' M.H. PL. 57.50

ST. 2+48 EXIST' M.H. PL. 57.50

ST. 2+48 EXIST' M.H. PL. 57.50

ST. 2+48 EXIST' M.H. PL. 57.50

ST. 2+48 EXIST' M.H. PL. 57.50

ST. 2+48 EXIST' M.H. PL. 57.50

ST. 2+48 EXIST' M.H. PL. 57.50

ST. 2+48 EXIST' M.H. PL. 57.50

ST. 2+48 EXIST' M.H. PL. 57.50

ST. 2+48 EXIST' M.H. PL. 57.50

ST. 2+48 EXIST' M.H. PL. 57.50

ST. 2+48 EXIST' M.H. PL. 57.50

ST. 2+48 EXIST' M.H. PL. 57.50

ST. 2+48 EXIST' M.H. PL. 57.50

ST. 2+48 EXIST' M.H. PL. 57.50

ST. 2+48 EXIST' M.H. PL. 57.50

ST. 2+48 EXIST' M.H. PL. 57.50

ST. 2+48 EXIST' M.H. PL. 57.50

ST. 2+48 EXIST' M.H. PL. 57.50

ST. 2+48 EXIST' M.H. PL. 57.50

ST. 2+48 EXIST' M.H. PL. 57.50

ST. 2+48 EXIST' M.H. PL. 57.50

ST. 2+48 EXIST' M.H. PL. 57.50

ST. 2+48 EXIST' M.H. PL. 57.50

ST. 2+48 EXIST' M.H. PL. 57.50

ST. 2+48 EXIST' M.H. PL. 57.50

ST. 2+48 EXIST' M.H. PL. 57.50

ST. 2+48 EXIST' M.H. PL. 57.50

ST. 2+48 EXIST' M.H. PL. 57.50

ST. 2+48 EXIST' M.H. PL. 57.50

ST. 2+48 EXIST' M.H. PL. 57.50

ST. 2+48 EXIST' M.H. PL. 57.50

ST. 2+48 EXIST' M.H. PL. 57.50

ST. 2+48 EXIST' M.H. PL. 57.50

ST. 2+48 EXIST' M.H. PL. 57.50

ST. 2+48 EXIST' M.H. PL. 57.50

ST. 2+48 EXIST' M.H. PL. 57.50

ST. 2+48 EXIST' M.H. PL. 57.50

ST. 2+48 EXIST' M.H. PL. 57.50

ST. 2+48 EXIST' M.H. PL. 57.50

ST. 2+48 EXIST' M.H. PL. 57.50

ST. 2+48 EXIST' M.H. PL. 57.50

ST. 2+48 EXIST' M.H. PL. 57.50

ST. 2+48 EXIST' M.H. PL. 57.50

ST. 2+48 EXIST' M.H. PL. 57.50

ST. 2+48 EXIST' M.H. PL. 57.50

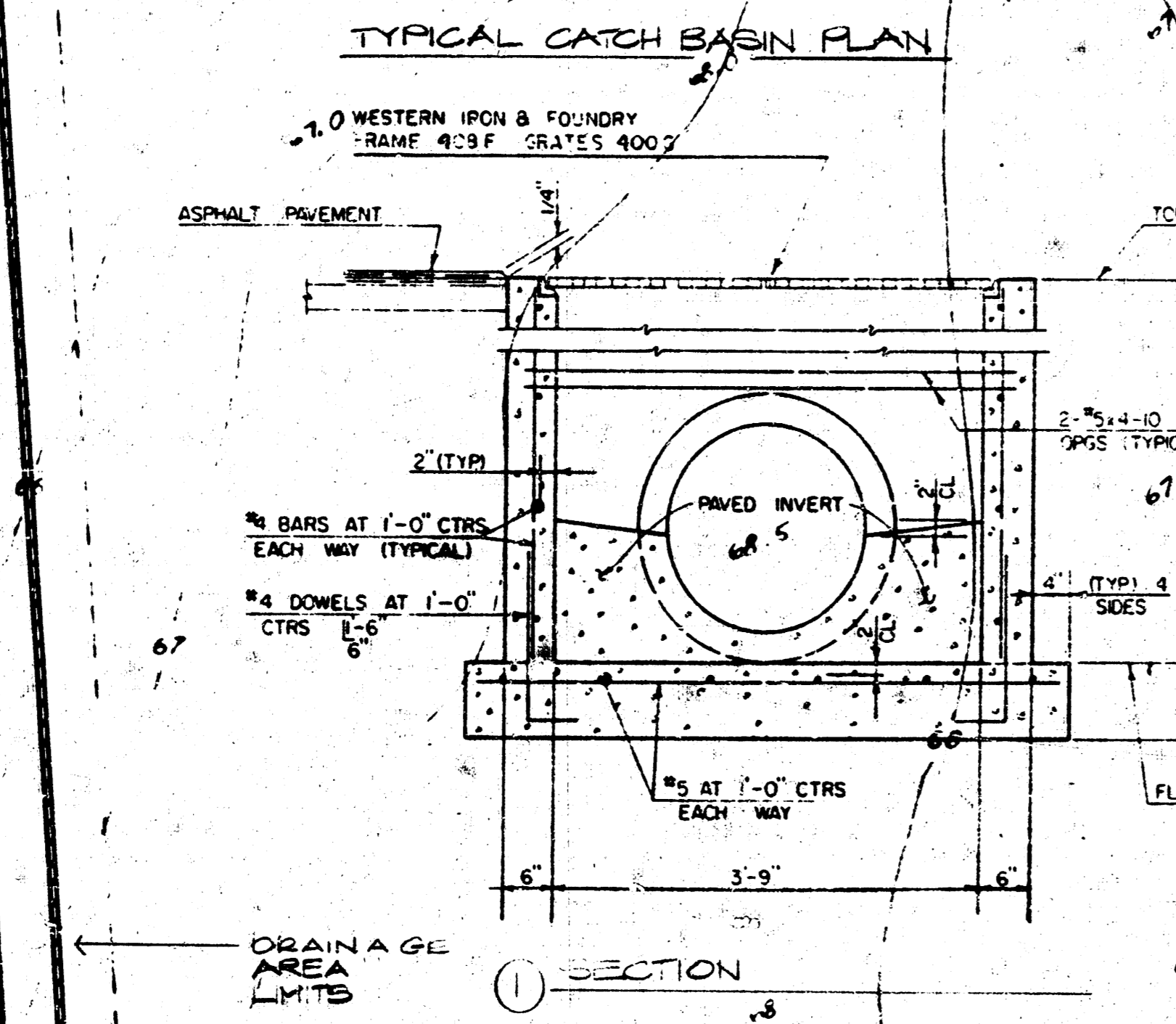
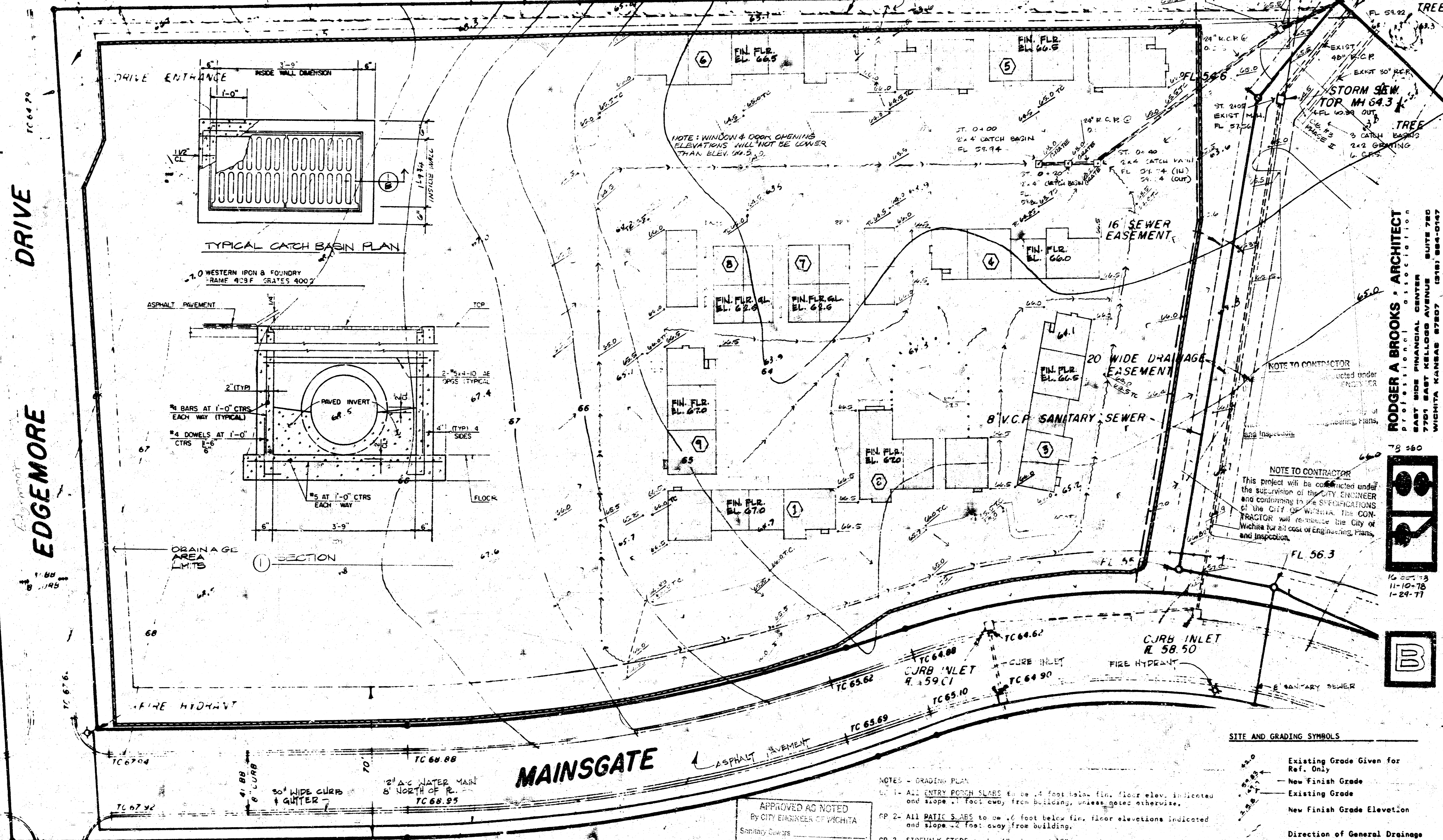

**RODGER A BROOKS ARCHITECT**  
 PROFESSIONAL ARCHITECT  
 EAST SIDE FINANCIAL CENTER SUITE 720  
 WICHITA, KANSAS 67202 (913) 261-0100



APPROVED AS NOTED  
 BY CITY ENGINEER OF WICHITA  
 Sanitary Sewers  
 Storm Sewers  
 Driveway Approaches

**SITE PLAN - GRADING**  
 1" = 30'-0"

- NOTES - GRADING PLAN
1. ALL ENTRY PITCH SLABS shall be 1/2" foot below fin. floor elev. indicated and slope 1/4" foot run, from building, unless noted otherwise.
  2. ALL PATIO SLABS to be 1/2" foot below fin. floor elevations indicated and slope 1/4" foot run, from building.
  3. SIDEWALK STEPS to be 6" rise and 12" run unless noted otherwise.
  4. SIDEWALKS AT PROPERTY LINE shall be 4" wide and set at city established elevations.
  5. SIDEWALKS BOARDING PARKING areas shall be 4" wide with 4" x 12" min. thickened slab edge parking side only, reinforced with one #4 rebar continuous at top edge.
  6. EXISTING TREES as selected by Owner shall be translocated to an Owner designated location. Verify with Owner, and identify those trees to be relocated.

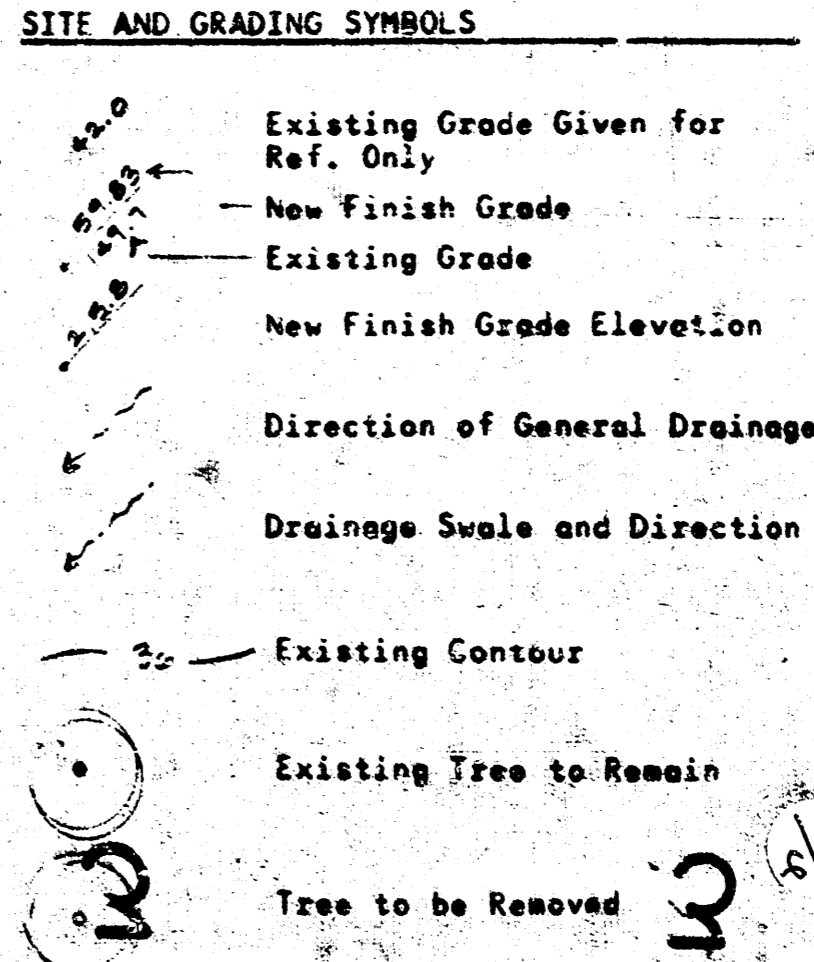

FILMED FROM THE BEST AVAILABLE COPY

The Storm Sewer Contractor Shall Contact City Maintenance Division so that They May Provide an Inspector to Approve This Construction

See Attached "Site Plan-Grading" for Plan View

