

**NOTE:**  
 Earthwork ( ) shall be paid for as Lump Sum bid for "Earthwork".  
 All disturbed areas as directed by Engineer shall be seeded in accordance with Kansas State Highway 1986 Standard Specifications using mixed native grass seed and prairie hay mulch. Seed shall be applied at 80 lbs per acre and fertilizer at 300 lbs per acre. Fertilizer shall contain 12% Nitrogen, 12% Phosphate and 12% Potassium. Cost for seeding, mulching and other appurtenant work to be paid for as Lump sum bid for "Seeding".

A dry bore method shall be used to install pipes where noted using equipment that encases the hole as earth is removed. No water shall be used in this method. Pipe installed by dry bore method shall be paid for by per foot bid for such work and includes pipe, work to set-up, weld joints, remove equipment and sheeting and appurtenant work to install pipe complete and in place.

Finalization of project cannot be considered until after the total work site on Kansas Turnpike Authority right-of-way is properly cleaned-up with all equipment and debris removed and any construction scars eradicated.

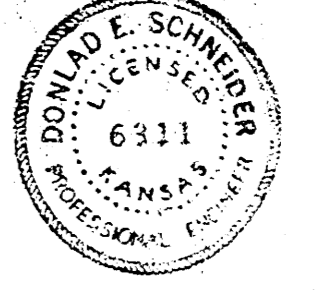
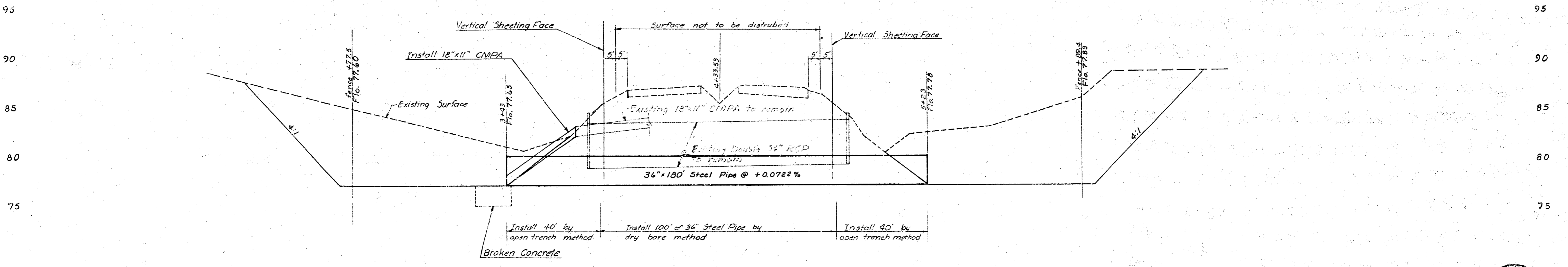
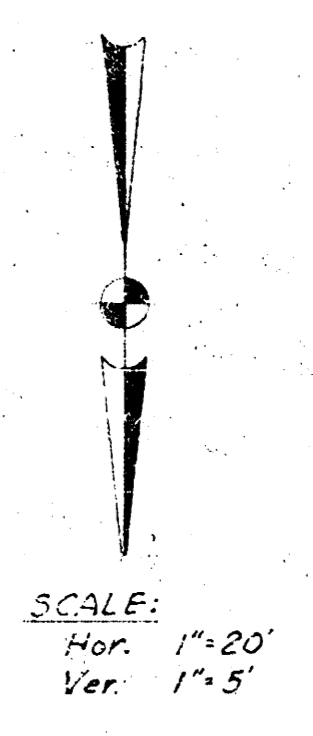
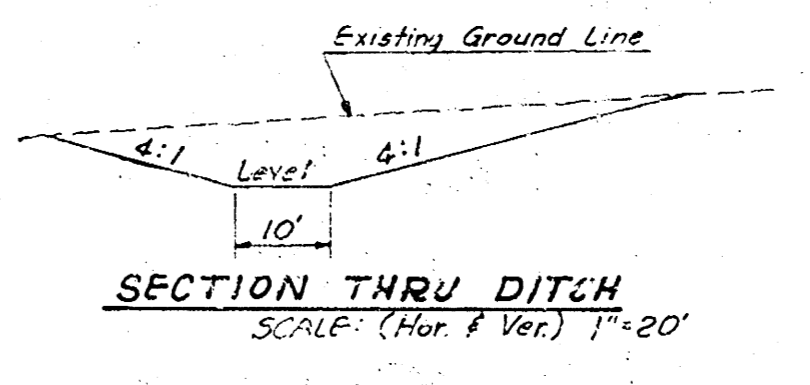
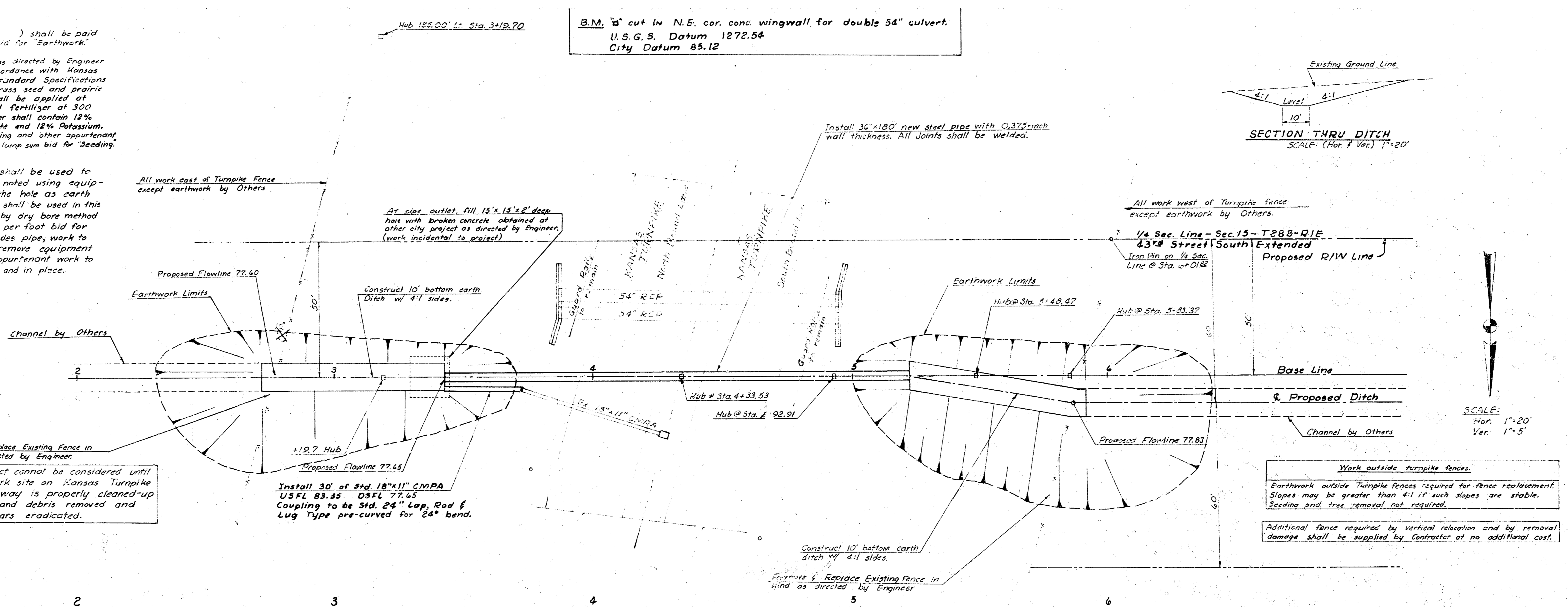

Rev. 8-15-72  
**KANSAS TURNPIKE AUTHORITY & 43<sup>RD</sup> STREET SOUTH DRAINAGE PROJECT**  
 R.W. Linn - City Engineer  
 City of Wichita  
 Date: July, 1972  
 Project No. BHR 50102a