

FIRST STREET
EL. WASHINGTON-W.L. HYDRAULIC

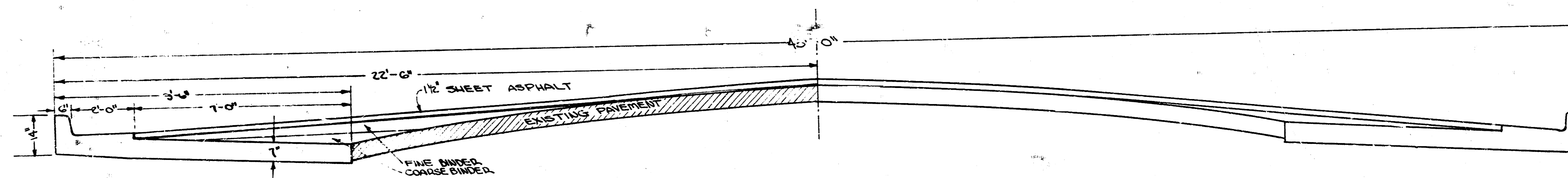

TYPICAL CROSS-SECTION
NO SCALE

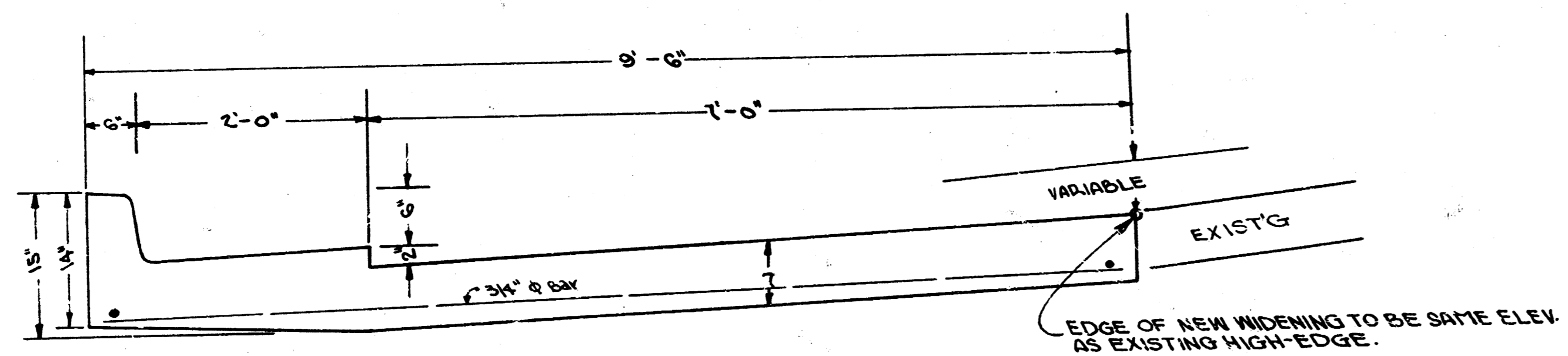

TYPICAL WIDENING SECTION
SCALE 1\"/>

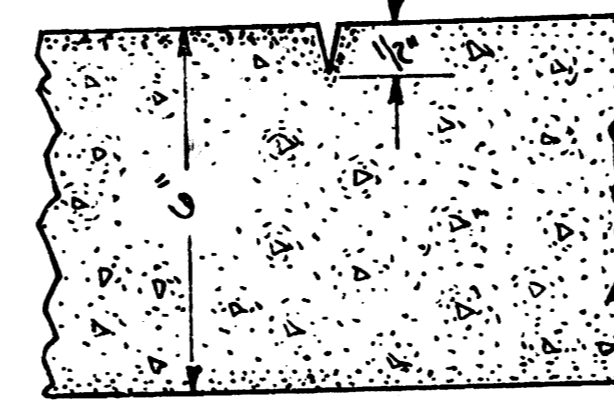

PLANE OF WEAKNESS
 PLANE OF WEAKNESS TO BE CUT WITH DOUBLE-EDGE GROOVED TO DEPTH AS SHOWN EVERY 20'

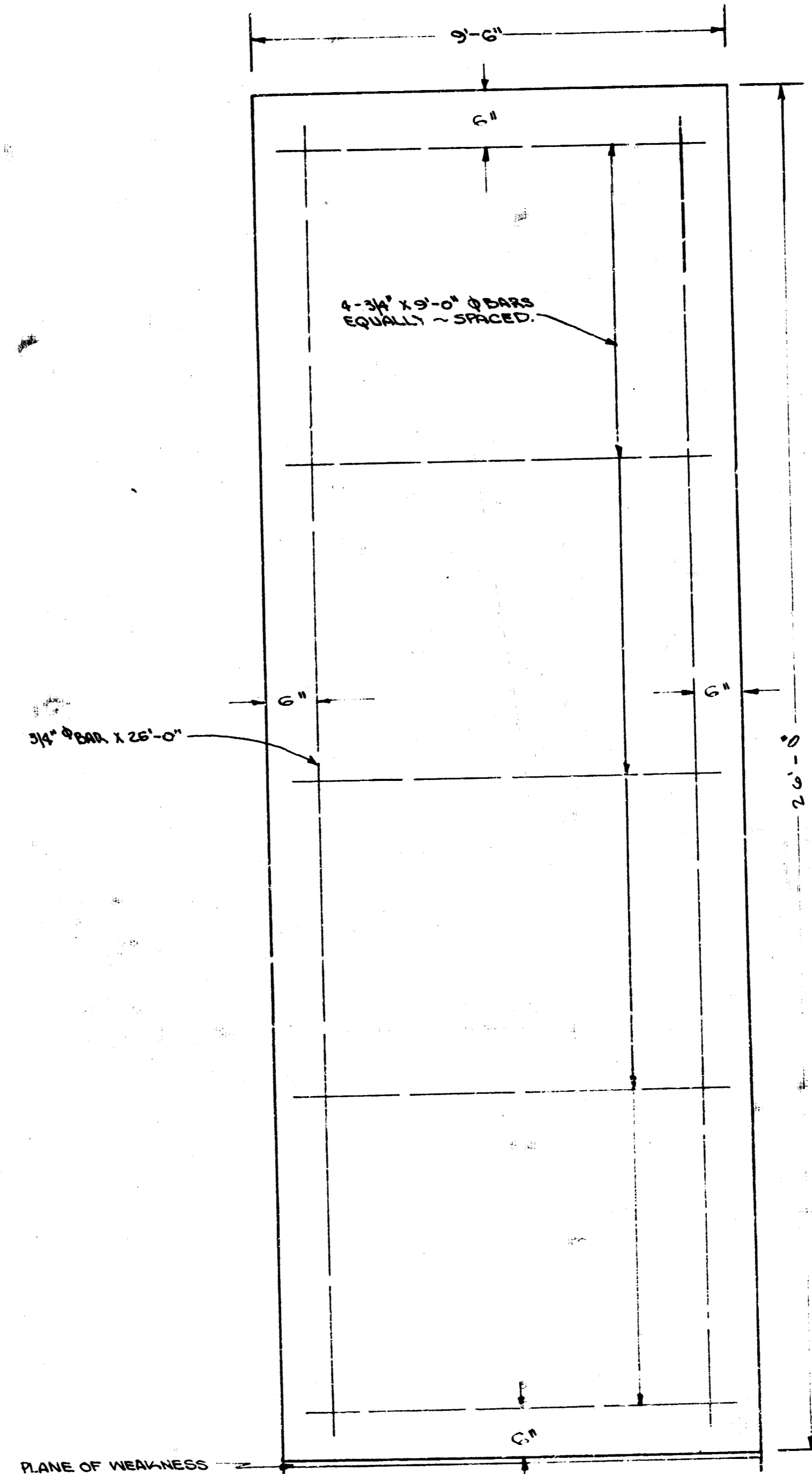

STEEL PATTERN

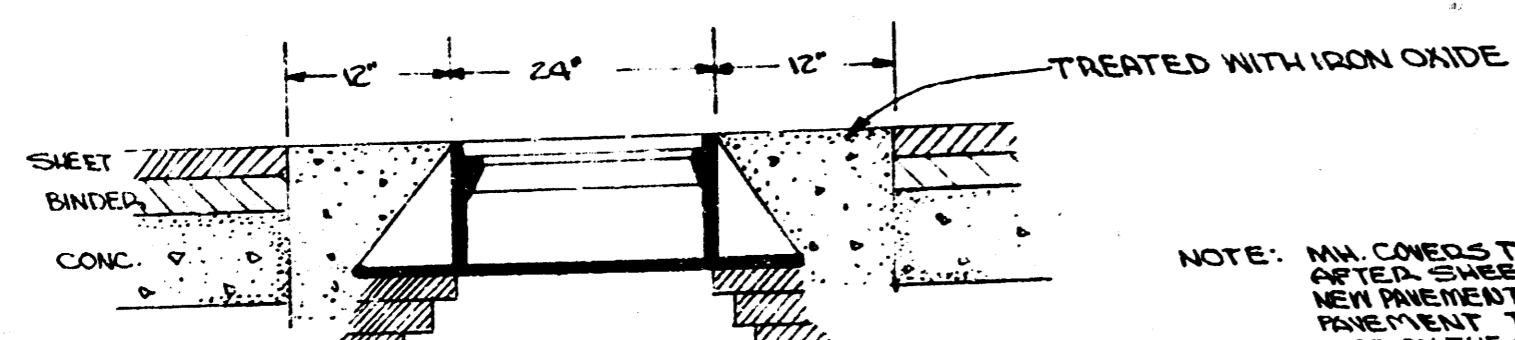

DETAIL OF PAVT. AROUND
MANHOLE AFTER ADJUSTMENT.

NOTE: MAN COVERS TO BE ADJUSTED TO NEW GRADE AFTER SHEET PILING HAS BEEN PLACED. NEW PAVEMENT AROUND MAN SHALL BE 1\"/>

B.M. 105.92 IRON IN THIN 1/2 SEC. LINE IN WASH & 1ST

B.M. 105.22 "X" ON CB. BK. W.C. NE. COR. 1ST & WABASH

B.M. 105.15 SE COR. LOWER CONC. STEP PRESBYTERIAN CHURCH

WASHINGT

WASHINGT

WASHINGT

WASHINGT

OHIO MI

Note Field Engineer: NO WALKS to be removed at any driveway, unless desired by Property Owner.

Note: Elevations across Centerline of Wabash are Actual top of Asphalt (finished).

Remove downspout to Church back. No downspout.

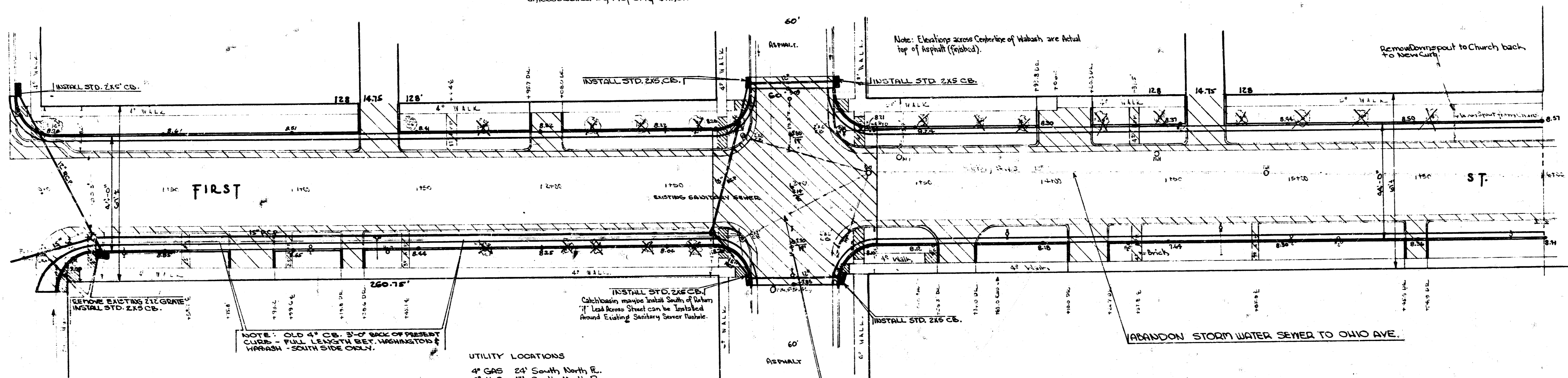

NOTE: OLD 4\"/>

UTILITY LOCATIONS
 4\"/>

CROSS-HATCHED AREA TO BE REMOVED.

Trees to be Removed

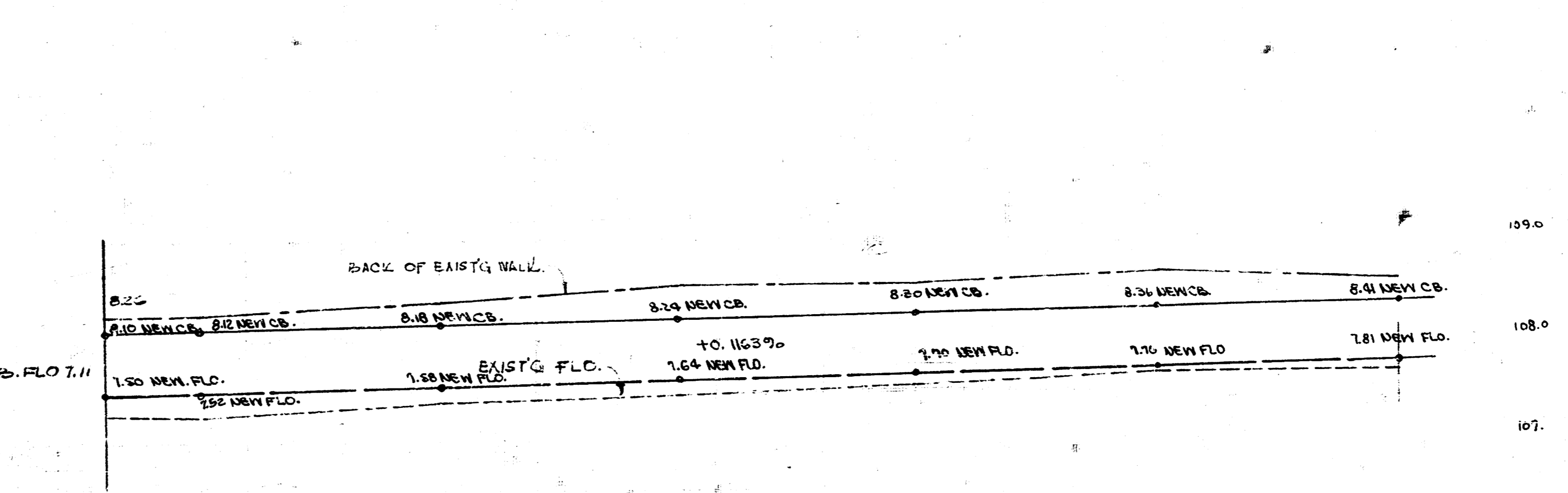
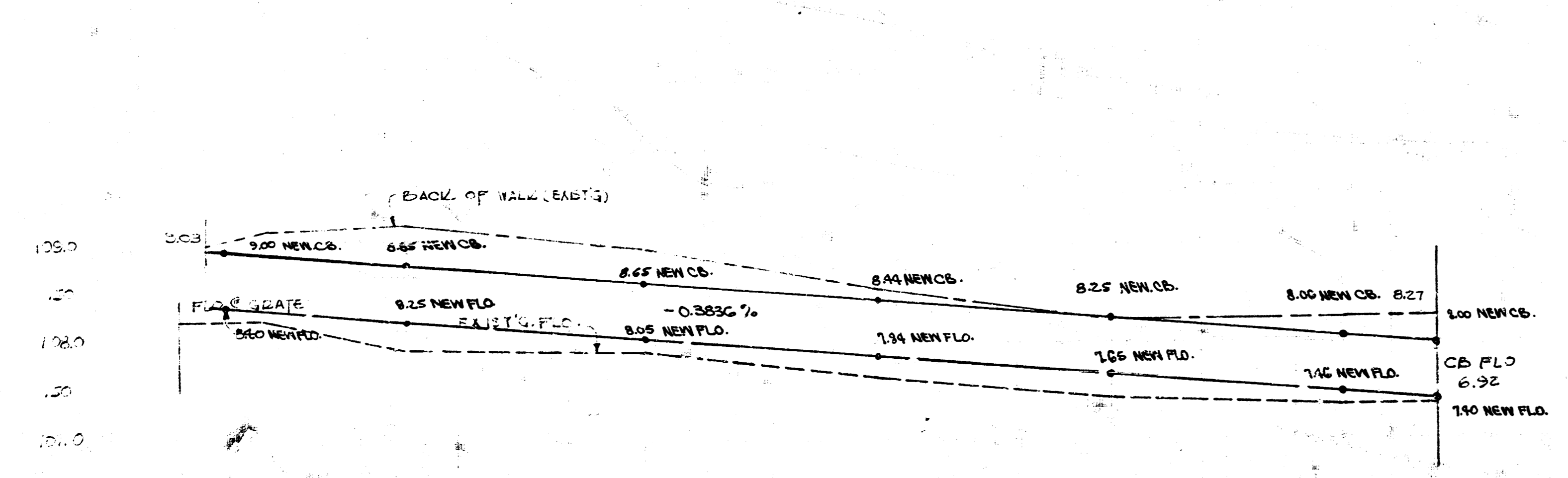
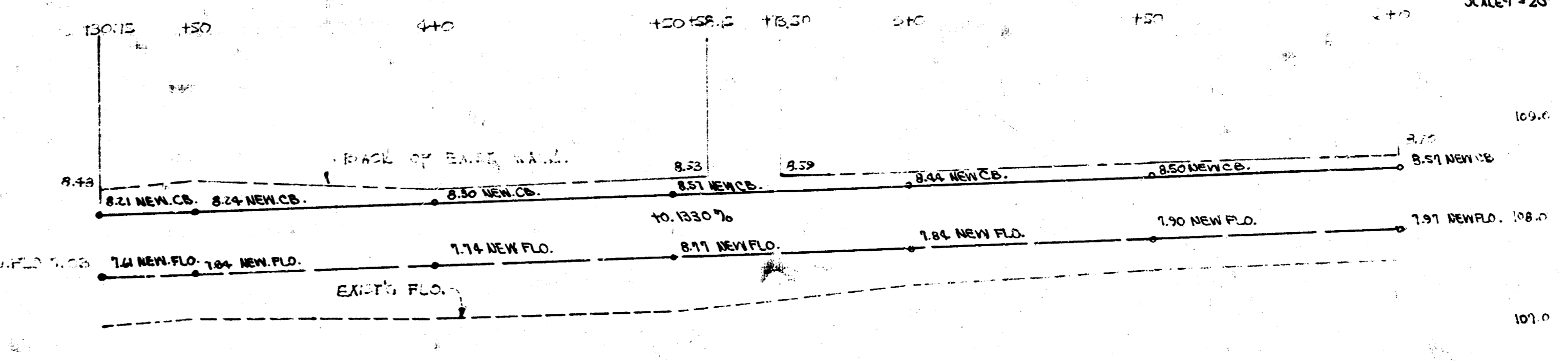
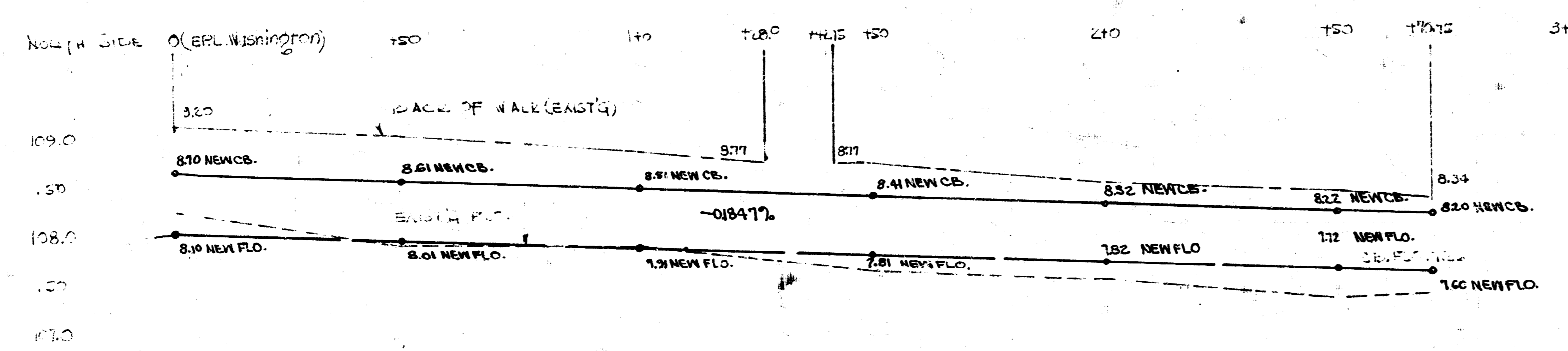
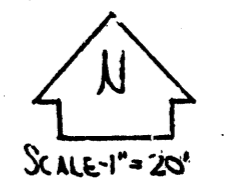

0+00 0+10 0+20 0+30 0+40 0+50 0+60 0+70 0+80 0+90 1+00 1+10 1+20 1+27.5 1+30 1+40 1+50 1+60 1+70 1+77.5

B.M. 109.95 S.E. COR. OLD CONC. SIGN BASE S.W. COR. CLEVELAND ST

B.M. 112.09 HIGH POINT ON CONC. COR. BLOCK COPING N.E. COR. 1ST ST NATHANSON

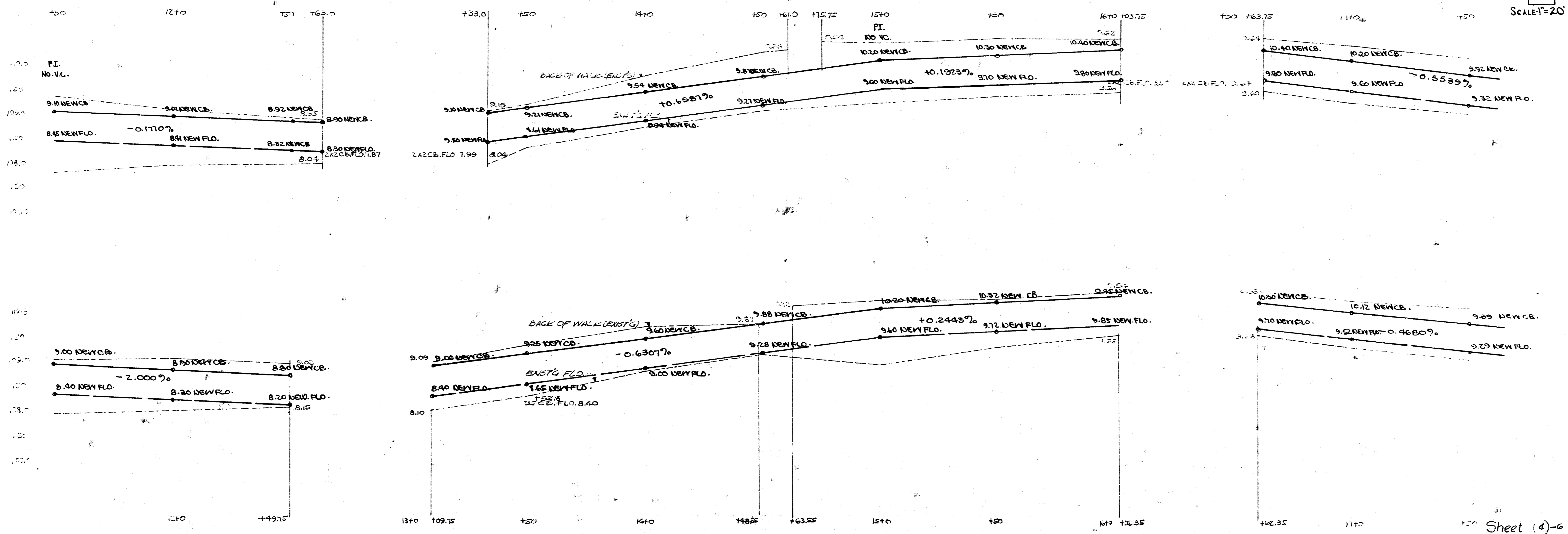
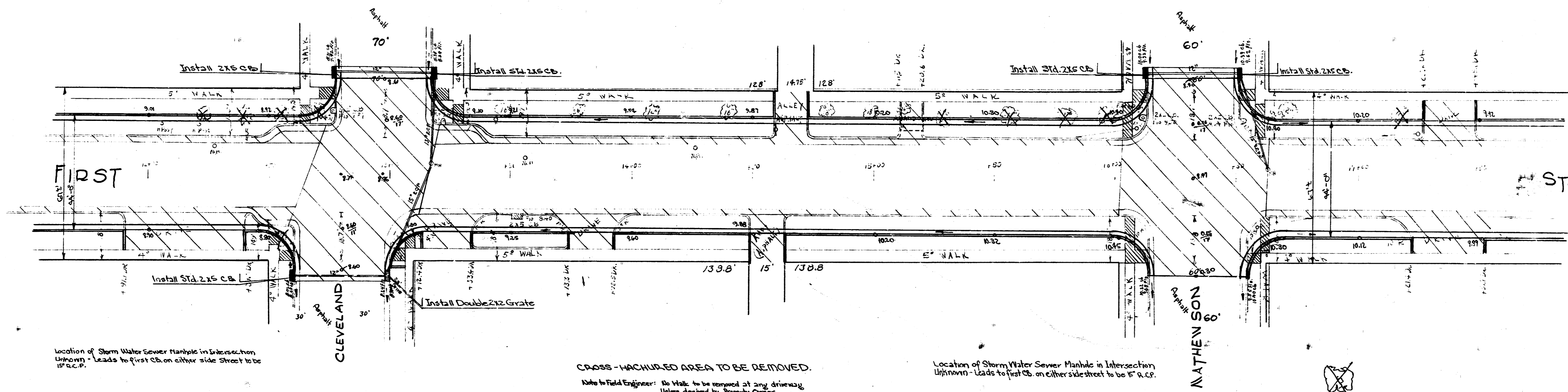

SCALE=20

5/1. 100.35 "C" IN M' CUBE CITY, W.L. 4' E OF EAST CB. I.E. COB. 1ST. PENNSYLVANIA

5/1. 10.05 "L" IN KENSER E.SIDE INT. SQ. IN. COL. 1ST. HYDRAULIC.

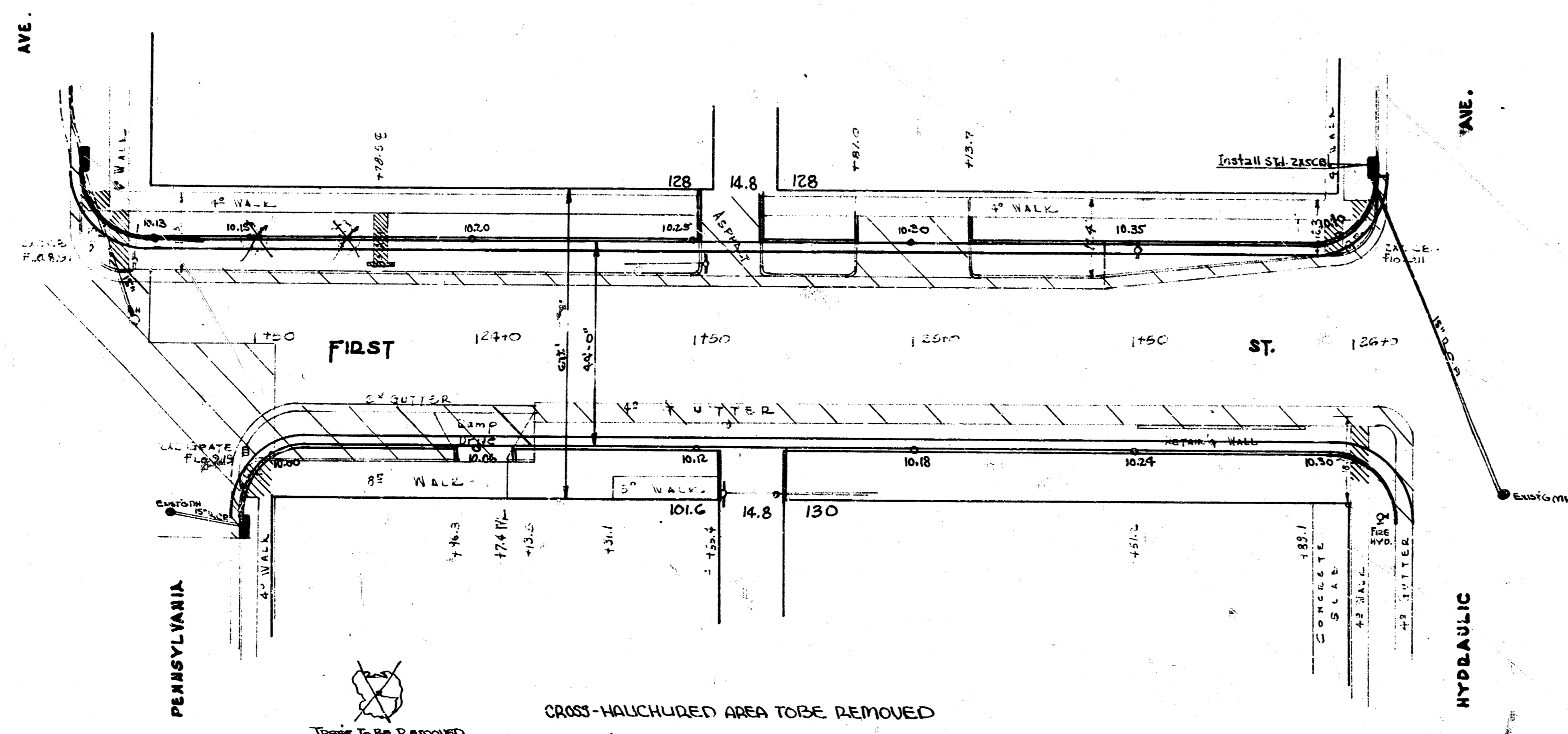

NOTE:
TYPE 'K' PAVEMENT WILL BE FND FOR IN EQUIVALENT FOOT
BASED FROM STA. 24+45 TO END OF PROJECT (WATER SIDE ONLY)

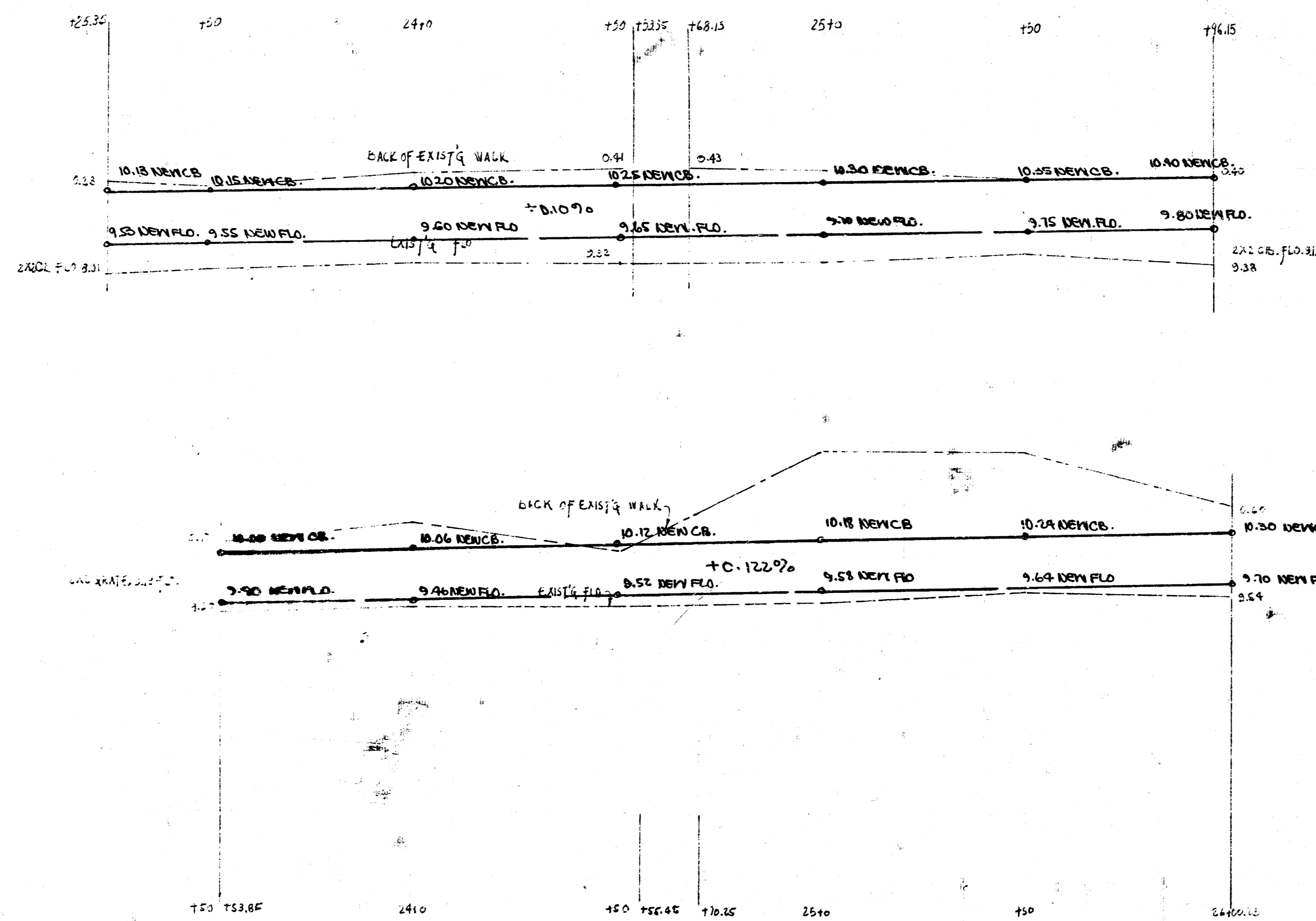

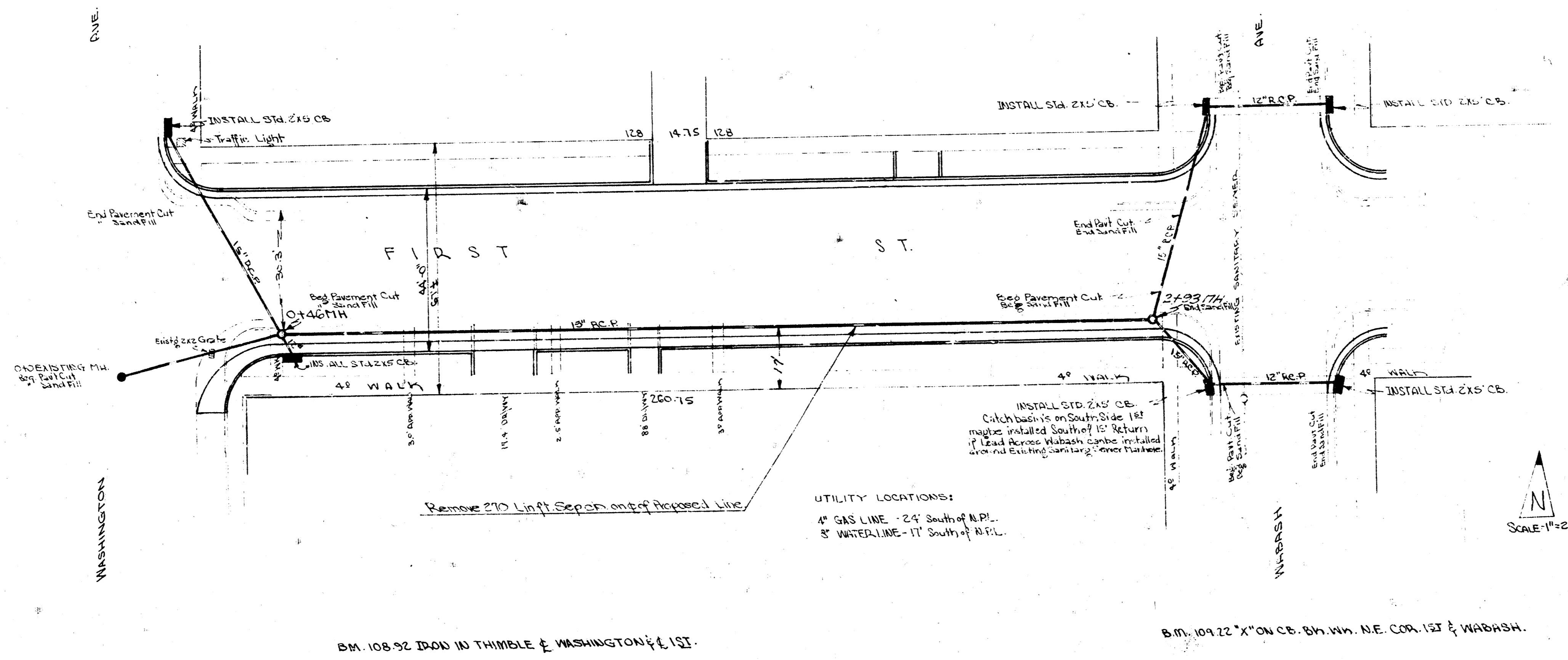

UTILITY LOCATIONS:
 4" GAS LINE - 24" South of R.P.L.
 8" WATERLINE - 17" South of R.P.L.

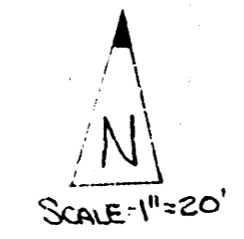

BM. 108.52 10\"/>

BM. 109.22 10\"/>

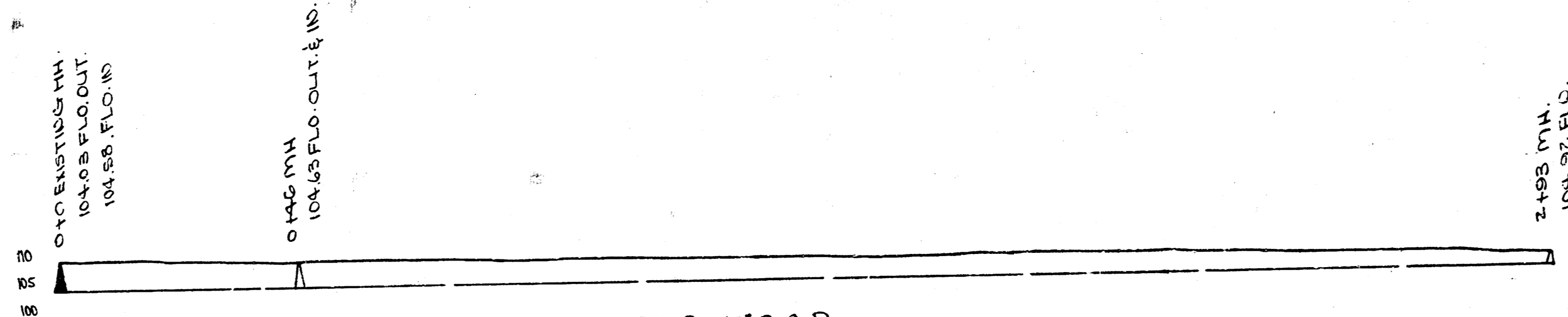

NOTE CONTRACTOR AND FIELD ENGINEER:
 SEWER PROFILE IS EXAGGERATED HORIZONTALLY

INCIDENTAL DRAINAGE TO 181 ST.
 EL. WASHINGTON - WL. HYDRAULIC
 CITY OF WICHITA, KANSAS
 L.K. WHITE
 DATE 4-28-50
 CITY ENGINEER

