

2nd STREET

W-L Woodchuck To W-L Brownthrus To & Hecox Addition

472-76-245-80868-000-000-001

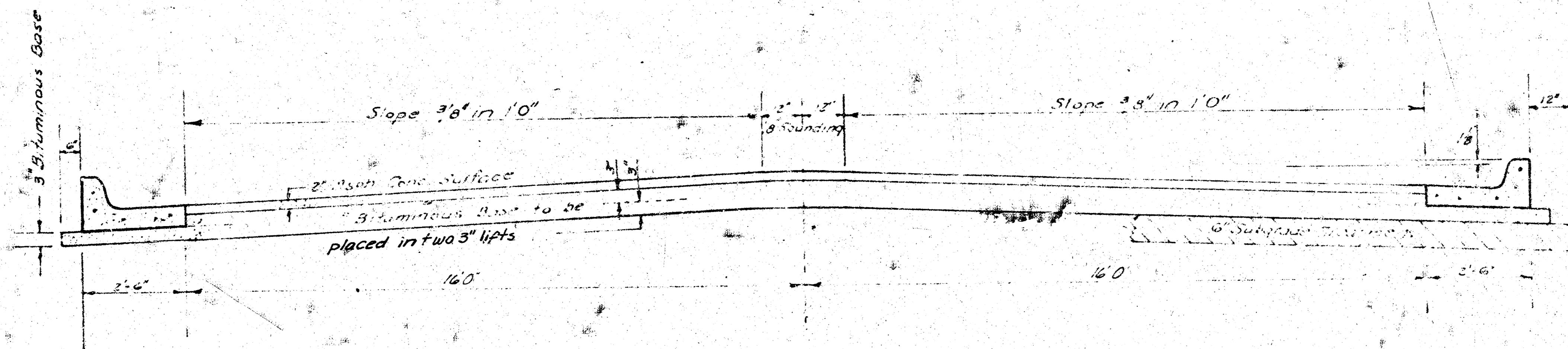

TYPICAL SECTION

37' ASPHALTIC CONCRETE PAVEMENT WITH BITUMINOUS BASE

A TACK COAT OF EMULSIFIED ASPHALT (SS-1H) SHALL BE APPLIED AT AN APPROXIMATE RATE 0.05 GALLONS PER SQ. YD. BETWEEN LIFTS OF ASPHALTIC MATERIALS WHEN ORDERED BY THE ENGINEER. TACK COAT WILL NOT BE PAID FOR DIRECTLY AND SHALL BE CONSIDERED AS SUBSIDIARY TO PRICE BID FOR ASPHALTIC PAVEMENT. BITUMINOUS BASE AND ASPHALTIC CONCRETE WEARING SURFACE SHALL BE PLACED WITH A LAYDOWN MACHINE HAVING AUTOMATIC CONTROLS FOR CROWN AND GRADE. CONSTRUCTION JOINTS IN EACH LIFT SHALL BE STAGGERED A MINIMUM DISTANCE OF 10' WITH JOINTS IN PRECEDING LIFTS AND PLACED SUCH THAT A JOINT WILL BE CONSTRUCTED ON THE CENTERLINE IN THE TOP LIFT.

The 4.0 Pavement between the curb curb & gutter shall be paid as 3.0" Bituminous Base. The Bituminous base under the curb curb & gutter shall be paid as 3.0" Bituminous Base.

COMBINED CURB & GUTTER

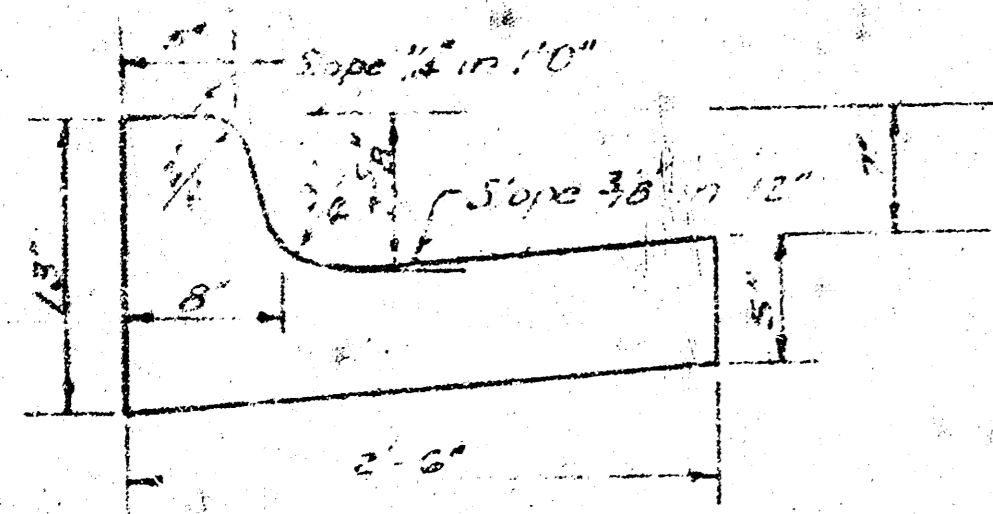

ROLL TYPE CURB & GUTTER

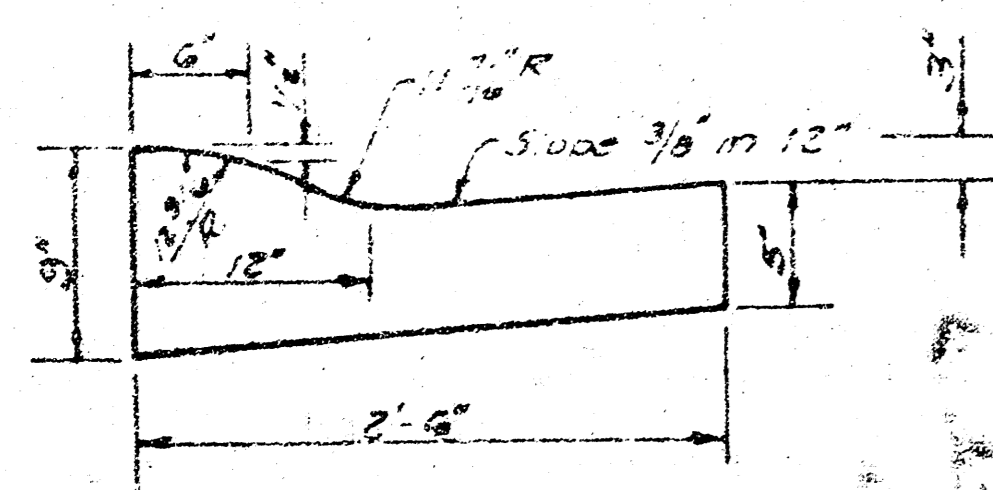

DETAIL OF TRANSVERSE CONSTRUCTION JOINTS

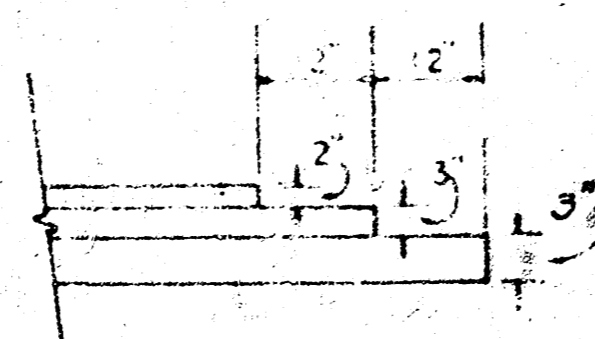

TRANSVERSE CONSTRUCTION JOINTS SHALL BE CONSTRUCTED IN FLEXIBLE BASE PAVEMENTS AT LOCATIONS WHERE PAVEMENT TEMPORARILY ENDS TO FACILITATE FUTURE PAVEMENT CONSTRUCTION AS SHOWN BY DETAIL. THE COST OF CONSTRUCTING THE TRANSVERSE CONSTRUCTION JOINTS SHALL NOT BE MEASURED OR PAID FOR DIRECTLY BUT SHALL BE INCLUDED IN THE BID PRICE FOR SQUARE YARDS OF ASPHALTIC CONCRETE PAVEMENT.

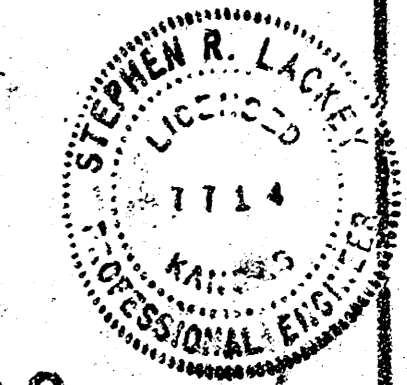

CITY OF WICHITA KANSAS

DEPARTMENT of PUBLIC WORKS - Engineering
Division

CITY ENGINEER

DATE _____ Proj. No. 472-76-245-80868-000-000-001

B.M. = 151.58 R.R. Spk N. Face H.L.P. 25' N. & 176' E. of ζ
 Sec. 21-27-1

B.M. = 146.47 "□" Top N-Cb 2nd ST. at E.L. Brownthrus

Baseline 15' N. of ζ 2nd ST. Based on Stone 21-27-1 & an Iron
 at N.E. Cor. Brownthrus & 2nd ST. At Sta. 10+00 Baseline
 Moves N-16' Being 31' N. of ζ . At Sta. 17+50 Baseline Moves S-
 31' Being ζ 2nd. As Projected from W.

NO More Than 8-20' Driveways Approaches Or The
 Equivalent To Be Constructed

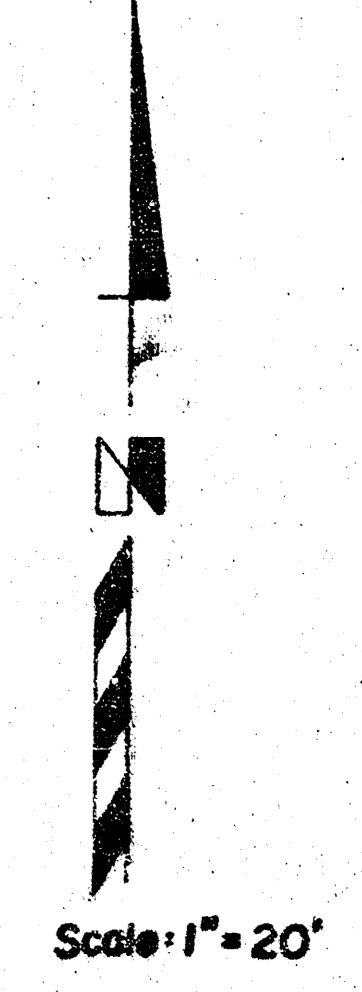
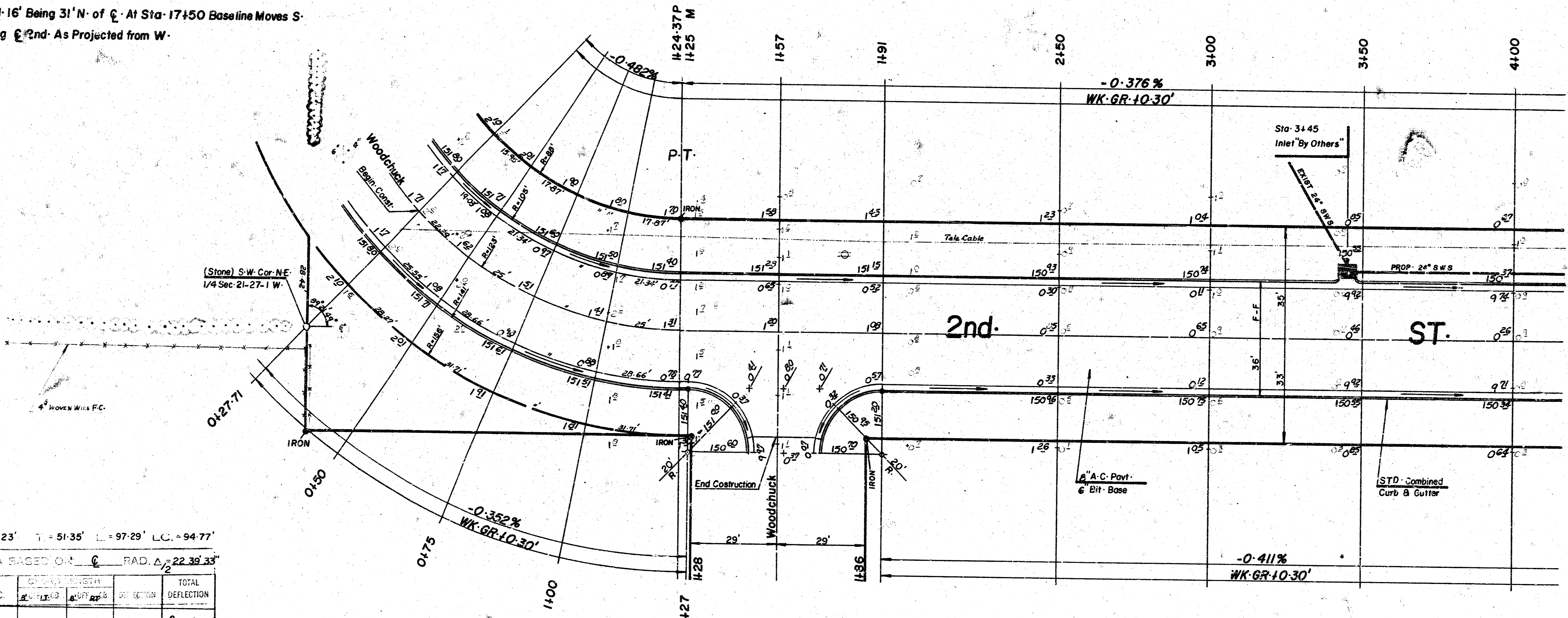

DDD-483
 Survey King
 1000 S. 10th St.
 Lawrence, KS 66044

$\Delta = 45^{\circ}19'05''$ R. = 123' T. = 51'35" L. = 97'29" L.C. = 94'77"

CURVE DATA BASED ON ζ RAD. $\Delta = 22^{\circ}39'33''$

STA.	ARC	CHORD	CHORD BEHIND	CHORD AHEAD	DEFLECTION	TOTAL DEFLECTION
0+27.71						0° 00' 00"
0+50	22.29	17.55	28.77	5° 11' 30"	5° 11' 30"	5° 11' 30"
0+75	25.00	19.68	32.26	5° 49' 21"	11° 00' 51"	11° 00' 51"
1+00	"	"	"	"	"	16° 50' 12"
1+25	25.00	19.68	32.26	5° 49' 21"	22° 39' 33"	22° 39' 33"

$Dipl. 1/4" = 1" 97458 Min.$

	Prop.	City
Excavation	6249.90 cy	672.60 cy
+ 10%	6249.99 cy	672.66 cy
TOTAL	6874.89 cy	739.86 cy
Comp. Fill	0	0
Manipulation	7189.32 cy	1163.38 cy

- GENERAL NOTES
- HEDGE ROW AND TREE REMOVAL MARKED \times . ALL TREES, WHICH IN OPINION OF THE FIELD ENGINEER CAN BE SAVED, SHALL BE SAVED.
 - FIELD ENGINEER TO TAKE TIPS TO ALL IRONS, ANY TRUCKS REMOVED OR DESTROYED DUE TO CONSTRUCTION SHALL BE REPLACED.
 - PAVEMENT REMOVAL \square

CAUTION
 UNDERGROUND UTILITIES
 Please check with K.G.U. or Southwestern Bell Telephone Co. for Location

SUB-GRADE
 TYPE OF SUB-GRADE TREATMENT SHALL BE DETERMINED BY THE FIELD ENGINEER. SUB-GRADE TREATMENT MAY CONSIST OF LIME TREATMENT, CEMENT TREATMENT, SUB-GRADE MODIFICATION, OR ANY COMBINATION OF THESE.

2nd ST.

W-L: Woodchuck To W-L: Brown-thrus To & W-L: Hecox Addition
 36" F-F A-C Pavt. / Comb. Curb & Gutter

City of Wichita, Ks.

R-W BRUGGEMAN City Engineer

Proj. NO. 472-76-245-80868-000-000-001

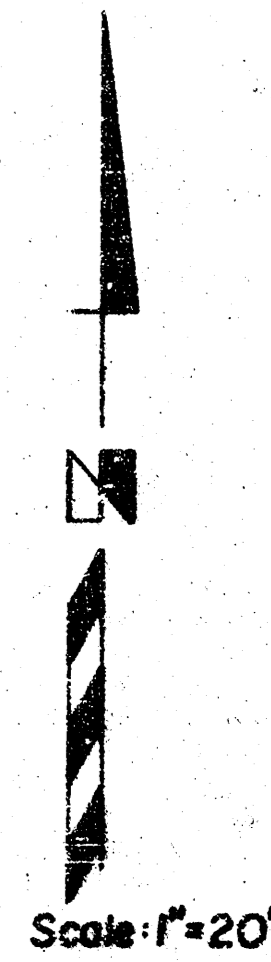
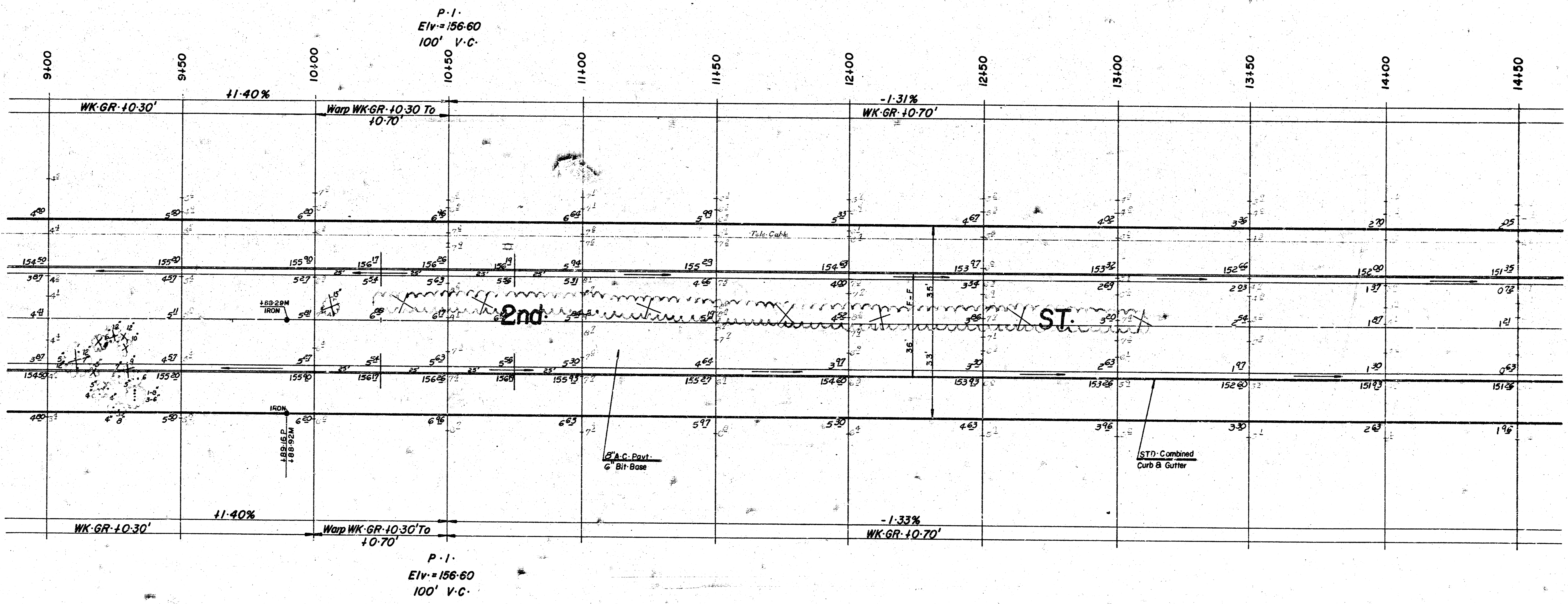

2nd · ST ·

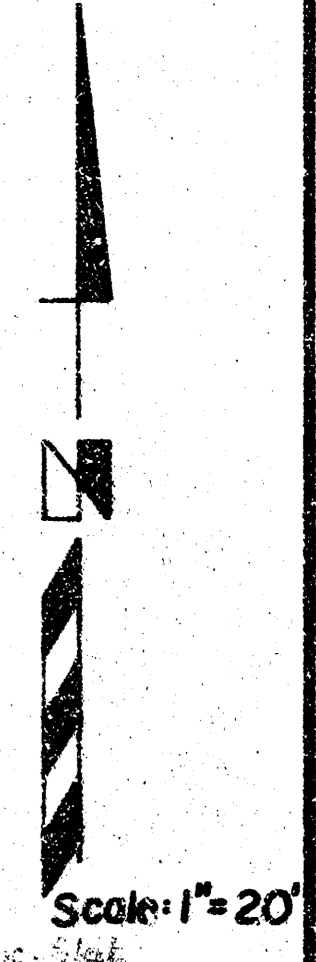
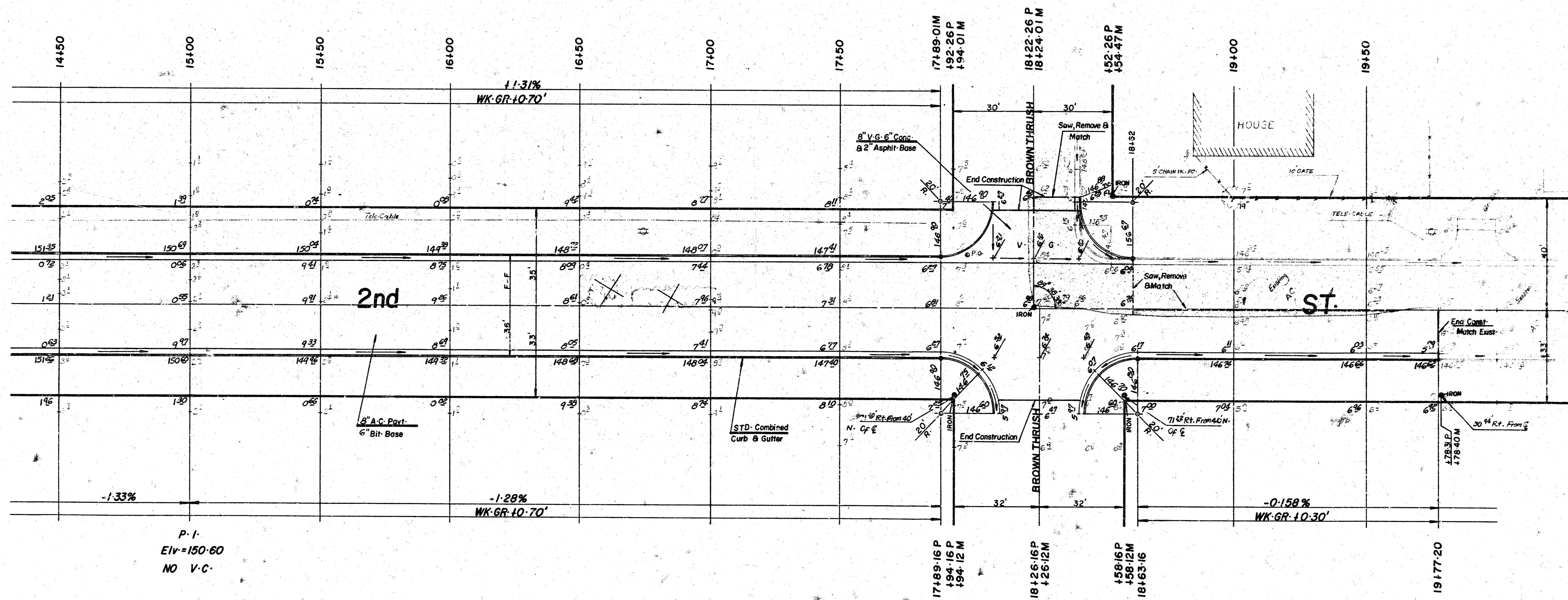

P-1
 Elev = 150.60
 NO V-C.

2nd ST.

5/5