

BM. 172-41 5" IN GLOBE W. Ch. Edgmore St. End  
 111.00 Top Iron W.L. Brookside St. Rockwood Rd.

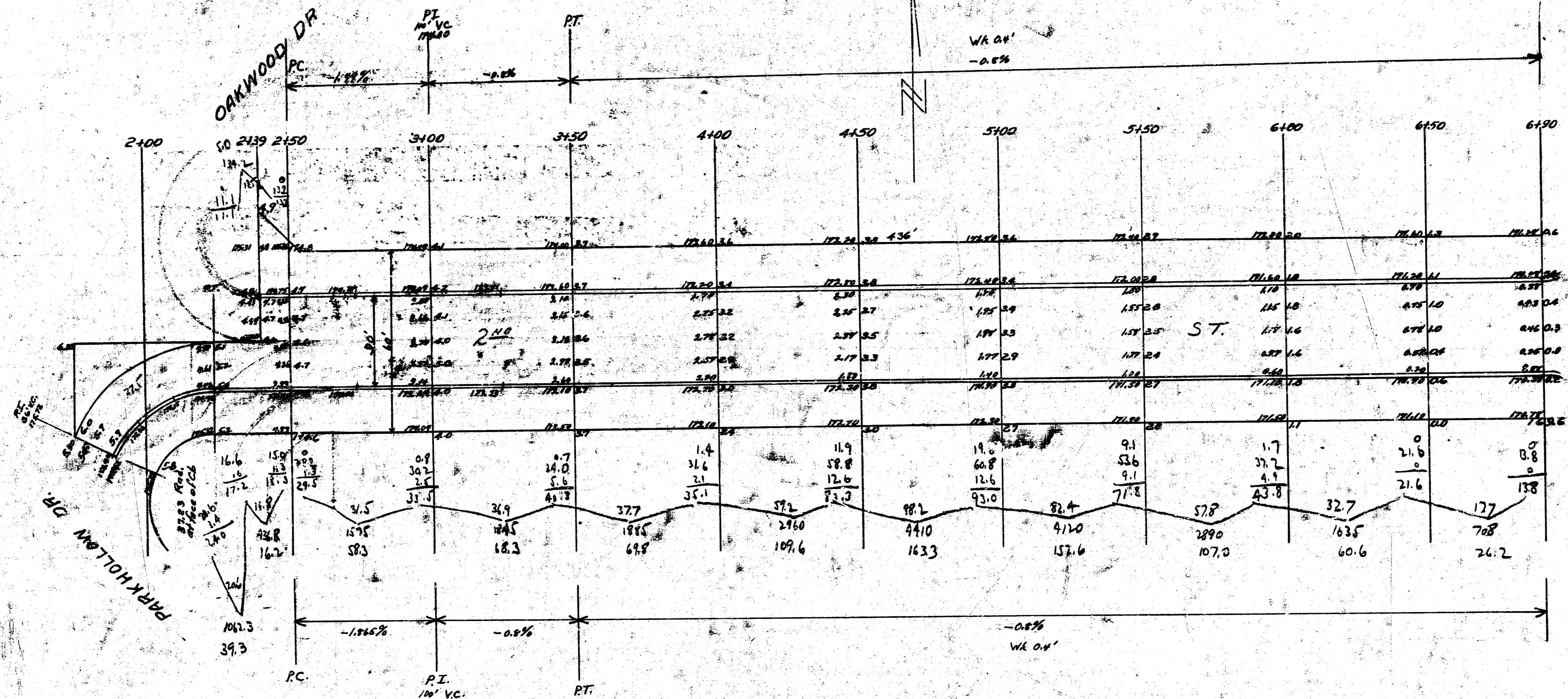

Total
5.0
34.3
16.2
58.3
68.3
61.8
109.6
163.3
151.6
107.0
60.6
24.2
876.2
4.1%
87.5
963.8

DR.

BROOKSIDE

SECOND 5  
 EL. OAKWOOD - W.L.  
 30' Conc. Paving  
 City of Wichita  
 L.A. WHITE City E  
 2-40 C 18-K

17 lanes