

3. M. 11.02 8 in BARTER on N.E. E. of S.E. cor. St. Francis & 3rd (RELOCATE)

Stationing on E

NOTE TO CONTRACTOR & FIELD ENGINEER PERTAINING TO HOOL UP AT ST. FRANCIS & 3RD:
 Install Sheet Asphalt & Binder if necessary, in intersection to meet new concrete.
 Remove 6" of old separate curb & gutter on the N.E. ends of proposed returns, E. curb of St. Francis & replace warped sections to match NEW GRADE & EXISTING F.L.O.

Use E.I. 1177 H.E. and warp 6" section of curb & gutter to match present curb & gutter 6' N. of return

NOTE TO FIELD ENGINEER:
 Reference TIES to THIMBLE, Sta. 0+00 on E, before construction of this project

Radius to be constructed to miss Power Pole

Use E.I. 1177 H.E. and warp 6" section of curb & gutter to match present curb & gutter 10' S. of return

SOUTH ALLEY DETAIL
 Scale 1/4" = 1'-0"

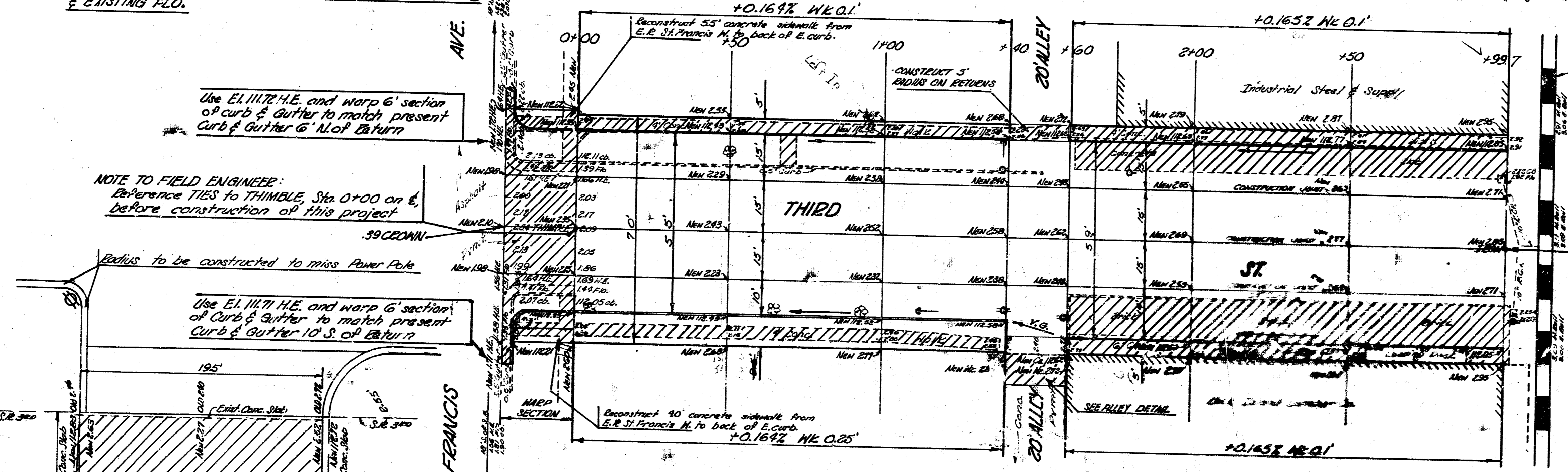

City	Presently
11.2	52.9
11.1	42.6
Total 72.3	Total 578.6

NOTE TO FIELD ENGINEER:
 Remove 2' x 2' Catch Basins, Stations 0+90.5, 0+91.5, 0+92.5, 0+93.5, 0+94.5, 0+95.5, 0+96.5, 0+97.5, 0+98.5, 0+99.5, 1+00.0, 1+00.5, 1+01.0, 1+01.5, 1+02.0, 1+02.5, 1+03.0, 1+03.5, 1+04.0, 1+04.5, 1+05.0, 1+05.5, 1+06.0, 1+06.5, 1+07.0, 1+07.5, 1+08.0, 1+08.5, 1+09.0, 1+09.5, 1+10.0, 1+10.5, 1+11.0, 1+11.5, 1+12.0, 1+12.5, 1+13.0, 1+13.5, 1+14.0, 1+14.5, 1+15.0, 1+15.5, 1+16.0, 1+16.5, 1+17.0, 1+17.5, 1+18.0, 1+18.5, 1+19.0, 1+19.5, 1+20.0, 1+20.5, 1+21.0, 1+21.5, 1+22.0, 1+22.5, 1+23.0, 1+23.5, 1+24.0, 1+24.5, 1+25.0, 1+25.5, 1+26.0, 1+26.5, 1+27.0, 1+27.5, 1+28.0, 1+28.5, 1+29.0, 1+29.5, 1+30.0, 1+30.5, 1+31.0, 1+31.5, 1+32.0, 1+32.5, 1+33.0, 1+33.5, 1+34.0, 1+34.5, 1+35.0, 1+35.5, 1+36.0, 1+36.5, 1+37.0, 1+37.5, 1+38.0, 1+38.5, 1+39.0, 1+39.5, 1+40.0, 1+40.5, 1+41.0, 1+41.5, 1+42.0, 1+42.5, 1+43.0, 1+43.5, 1+44.0, 1+44.5, 1+45.0, 1+45.5, 1+46.0, 1+46.5, 1+47.0, 1+47.5, 1+48.0, 1+48.5, 1+49.0, 1+49.5, 1+50.0, 1+50.5, 1+51.0, 1+51.5, 1+52.0, 1+52.5, 1+53.0, 1+53.5, 1+54.0, 1+54.5, 1+55.0, 1+55.5, 1+56.0, 1+56.5, 1+57.0, 1+57.5, 1+58.0, 1+58.5, 1+59.0, 1+59.5, 1+60.0, 1+60.5, 1+61.0, 1+61.5, 1+62.0, 1+62.5, 1+63.0, 1+63.5, 1+64.0, 1+64.5, 1+65.0, 1+65.5, 1+66.0, 1+66.5, 1+67.0, 1+67.5, 1+68.0, 1+68.5, 1+69.0, 1+69.5, 1+70.0, 1+70.5, 1+71.0, 1+71.5, 1+72.0, 1+72.5, 1+73.0, 1+73.5, 1+74.0, 1+74.5, 1+75.0, 1+75.5, 1+76.0, 1+76.5, 1+77.0, 1+77.5, 1+78.0, 1+78.5, 1+79.0, 1+79.5, 1+80.0, 1+80.5, 1+81.0, 1+81.5, 1+82.0, 1+82.5, 1+83.0, 1+83.5, 1+84.0, 1+84.5, 1+85.0, 1+85.5, 1+86.0, 1+86.5, 1+87.0, 1+87.5, 1+88.0, 1+88.5, 1+89.0, 1+89.5, 1+90.0, 1+90.5, 1+91.0, 1+91.5, 1+92.0, 1+92.5, 1+93.0, 1+93.5, 1+94.0, 1+94.5, 1+95.0, 1+95.5, 1+96.0, 1+96.5, 1+97.0, 1+97.5, 1+98.0, 1+98.5, 1+99.0, 1+99.5, 1+100.0, 1+100.5, 1+101.0, 1+101.5, 1+102.0, 1+102.5, 1+103.0, 1+103.5, 1+104.0, 1+104.5, 1+105.0, 1+105.5, 1+106.0, 1+106.5, 1+107.0, 1+107.5, 1+108.0, 1+108.5, 1+109.0, 1+109.5, 1+110.0, 1+110.5, 1+111.0, 1+111.5, 1+112.0, 1+112.5, 1+113.0, 1+113.5, 1+114.0, 1+114.5, 1+115.0, 1+115.5, 1+116.0, 1+116.5, 1+117.0, 1+117.5, 1+118.0, 1+118.5, 1+119.0, 1+119.5, 1+120.0, 1+120.5, 1+121.0, 1+121.5, 1+122.0, 1+122.5, 1+123.0, 1+123.5, 1+124.0, 1+124.5, 1+125.0, 1+125.5, 1+126.0, 1+126.5, 1+127.0, 1+127.5, 1+128.0, 1+128.5, 1+129.0, 1+129.5, 1+130.0, 1+130.5, 1+131.0, 1+131.5, 1+132.0, 1+132.5, 1+133.0, 1+133.5, 1+134.0, 1+134.5, 1+135.0, 1+135.5, 1+136.0, 1+136.5, 1+137.0, 1+137.5, 1+138.0, 1+138.5, 1+139.0, 1+139.5, 1+140.0, 1+140.5, 1+141.0, 1+141.5, 1+142.0, 1+142.5, 1+143.0, 1+143.5, 1+144.0, 1+144.5, 1+145.0, 1+145.5, 1+146.0, 1+146.5, 1+147.0, 1+147.5, 1+148.0, 1+148.5, 1+149.0, 1+149.5, 1+150.0, 1+150.5, 1+151.0, 1+151.5, 1+152.0, 1+152.5, 1+153.0, 1+153.5, 1+154.0, 1+154.5, 1+155.0, 1+155.5, 1+156.0, 1+156.5, 1+157.0, 1+157.5, 1+158.0, 1+158.5, 1+159.0, 1+159.5, 1+160.0, 1+160.5, 1+161.0, 1+161.5, 1+162.0, 1+162.5, 1+163.0, 1+163.5, 1+164.0, 1+164.5, 1+165.0, 1+165.5, 1+166.0, 1+166.5, 1+167.0, 1+167.5, 1+168.0, 1+168.5, 1+169.0, 1+169.5, 1+170.0, 1+170.5, 1+171.0, 1+171.5, 1+172.0, 1+172.5, 1+173.0, 1+173.5, 1+174.0, 1+174.5, 1+175.0, 1+175.5, 1+176.0, 1+176.5, 1+177.0, 1+177.5, 1+178.0, 1+178.5, 1+179.0, 1+179.5, 1+180.0, 1+180.5, 1+181.0, 1+181.5, 1+182.0, 1+182.5, 1+183.0, 1+183.5, 1+184.0, 1+184.5, 1+185.0, 1+185.5, 1+186.0, 1+186.5, 1+187.0, 1+187.5, 1+188.0, 1+188.5, 1+189.0, 1+189.5, 1+190.0, 1+190.5, 1+191.0, 1+191.5, 1+192.0, 1+192.5, 1+193.0, 1+193.5, 1+194.0, 1+194.5, 1+195.0, 1+195.5, 1+196.0, 1+196.5, 1+197.0, 1+197.5, 1+198.0, 1+198.5, 1+199.0, 1+199.5, 1+200.0, 1+200.5, 1+201.0, 1+201.5, 1+202.0, 1+202.5, 1+203.0, 1+203.5, 1+204.0, 1+204.5, 1+205.0, 1+205.5, 1+206.0, 1+206.5, 1+207.0, 1+207.5, 1+208.0, 1+208.5, 1+209.0, 1+209.5, 1+210.0, 1+210.5, 1+211.0, 1+211.5, 1+212.0, 1+212.5, 1+213.0, 1+213.5, 1+214.0, 1+214.5, 1+215.0, 1+215.5, 1+216.0, 1+216.5, 1+217.0, 1+217.5, 1+218.0, 1+218.5, 1+219.0, 1+219.5, 1+220.0, 1+220.5, 1+221.0, 1+221.5, 1+222.0, 1+222.5, 1+223.0, 1+223.5, 1+224.0, 1+224.5, 1+225.0, 1+225.5, 1+226.0, 1+226.5, 1+227.0, 1+227.5, 1+228.0, 1+228.5, 1+229.0, 1+229.5, 1+230.0, 1+230.5, 1+231.0, 1+231.5, 1+232.0, 1+232.5, 1+233.0, 1+233.5, 1+234.0, 1+234.5, 1+235.0, 1+235.5, 1+236.0, 1+236.5, 1+237.0, 1+237.5, 1+238.0, 1+238.5, 1+239.0, 1+239.5, 1+240.0, 1+240.5, 1+241.0, 1+241.5, 1+242.0, 1+242.5, 1+243.0, 1+243.5, 1+244.0, 1+244.5, 1+245.0, 1+245.5, 1+246.0, 1+246.5, 1+247.0, 1+247.5, 1+248.0, 1+248.5, 1+249.0, 1+249.5, 1+250.0, 1+250.5, 1+251.0, 1+251.5, 1+252.0, 1+252.5, 1+253.0, 1+253.5, 1+254.0, 1+254.5, 1+255.0, 1+255.5, 1+256.0, 1+256.5, 1+257.0, 1+257.5, 1+258.0, 1+258.5, 1+259.0, 1+259.5, 1+260.0, 1+260.5, 1+261.0, 1+261.5, 1+262.0, 1+262.5, 1+263.0, 1+263.5, 1+264.0, 1+264.5, 1+265.0, 1+265.5, 1+266.0, 1+266.5, 1+267.0, 1+267.5, 1+268.0, 1+268.5, 1+269.0, 1+269.5, 1+270.0, 1+270.5, 1+271.0, 1+271.5, 1+272.0, 1+272.5, 1+273.0, 1+273.5, 1+274.0, 1+274.5, 1+275.0, 1+275.5, 1+276.0, 1+276.5, 1+277.0, 1+277.5, 1+278.0, 1+278.5, 1+279.0, 1+279.5, 1+280.0, 1+280.5, 1+281.0, 1+281.5, 1+282.0, 1+282.5, 1+283.0, 1+283.5, 1+284.0, 1+284.5, 1+285.0, 1+285.5, 1+286.0, 1+286.5, 1+287.0, 1+287.5, 1+288.0, 1+288.5, 1+289.0, 1+289.5, 1+290.0, 1+290.5, 1+291.0, 1+291.5, 1+292.0, 1+292.5, 1+293.0, 1+293.5, 1+294.0, 1+294.5, 1+295.0, 1+295.5, 1+296.0, 1+296.5, 1+297.0, 1+297.5, 1+298.0, 1+298.5, 1+299.0, 1+299.5, 1+300.0, 1+300.5, 1+301.0, 1+301.5, 1+302.0, 1+302.5, 1+303.0, 1+303.5, 1+304.0, 1+304.5, 1+305.0, 1+305.5, 1+306.0, 1+306.5, 1+307.0, 1+307.5, 1+308.0, 1+308.5, 1+309.0, 1+309.5, 1+310.0, 1+310.5, 1+311.0, 1+311.5, 1+312.0, 1+312.5, 1+313.0, 1+313.5, 1+314.0, 1+314.5, 1+315.0, 1+315.5, 1+316.0, 1+316.5, 1+317.0, 1+317.5, 1+318.0, 1+318.5, 1+319.0, 1+319.5, 1+320.0, 1+320.5, 1+321.0, 1+321.5, 1+322.0, 1+322.5, 1+323.0, 1+323.5, 1+324.0, 1+324.5, 1+325.0, 1+325.5, 1+326.0, 1+326.5, 1+327.0, 1+327.5, 1+328.0, 1+328.5, 1+329.0, 1+329.5, 1+330.0, 1+330.5, 1+331.0, 1+331.5, 1+332.0, 1+332.5, 1+333.0, 1+333.5, 1+334.0, 1+334.5, 1+335.0, 1+335.5, 1+336.0, 1+336.5, 1+337.0, 1+337.5, 1+338.0, 1+338.5, 1+339.0, 1+339.5, 1+340.0, 1+340.5, 1+341.0, 1+341.5, 1+342.0, 1+342.5, 1+343.0, 1+343.5, 1+344.0, 1+344.5, 1+345.0, 1+345.5, 1+346.0, 1+346.5, 1+347.0, 1+347.5, 1+348.0, 1+348.5, 1+349.0, 1+349.5, 1+350.0, 1+350.5, 1+351.0, 1+351.5, 1+352.0, 1+352.5, 1+353.0, 1+353.5, 1+354.0, 1+354.5, 1+355.0, 1+355.5, 1+356.0, 1+356.5, 1+357.0, 1+357.5, 1+358.0, 1+358.5, 1+359.0, 1+359.5, 1+360.0, 1+360.5, 1+361.0, 1+361.5, 1+362.0, 1+362.5, 1+363.0, 1+363.5, 1+364.0, 1+364.5, 1+365.0, 1+365.5, 1+366.0, 1+366.5, 1+367.0, 1+367.5, 1+368.0, 1+368.5, 1+369.0, 1+369.5, 1+370.0, 1+370.5, 1+371.0, 1+371.5, 1+372.0, 1+372.5, 1+373.0, 1+373.5, 1+374.0, 1+374.5, 1+375.0, 1+375.5, 1+376.0, 1+376.5, 1+377.0, 1+377.5, 1+378.0, 1+378.5, 1+379.0, 1+379.5, 1+380.0, 1+380.5, 1+381.0, 1+381.5, 1+382.0, 1+382.5, 1+383.0, 1+383.5, 1+384.0, 1+384.5, 1+385.0, 1+385.5, 1+386.0, 1+386.5, 1+387.0, 1+387.5, 1+388.0, 1+388.5, 1+389.0, 1+389.5, 1+390.0, 1+390.5, 1+391.0, 1+391.5, 1+392.0, 1+392.5, 1+393.0, 1+393.5, 1+394.0, 1+394.5, 1+395.0, 1+395.5, 1+396.0, 1+396.5, 1+397.0, 1+397.5, 1+398.0, 1+398.5, 1+399.0, 1+399.5, 1+400.0, 1+400.5, 1+401.0, 1+401.5, 1+402.0, 1+402.5, 1+403.0, 1+403.5, 1+404.0, 1+404.5, 1+405.0, 1+405.5, 1+406.0, 1+406.5, 1+407.0, 1+407.5, 1+408.0, 1+408.5, 1+409.0, 1+409.5, 1+410.0, 1+410.5, 1+411.0, 1+411.5, 1+412.0, 1+412.5, 1+413.0, 1+413.5, 1+414.0, 1+414.5, 1+415.0, 1+415.5, 1+416.0, 1+416.5, 1+417.0, 1+417.5, 1+418.0, 1+418.5, 1+419.0, 1+419.5, 1+420.0, 1+420.5, 1+421.0, 1+421.5, 1+422.0, 1+422.5, 1+423.0, 1+423.5, 1+424.0, 1+424.5, 1+425.0, 1+425.5, 1+426.0, 1+426.5, 1+427.0, 1+427.5, 1+428.0, 1+428.5, 1+429.0, 1+429.5, 1+430.0, 1+430.5, 1+431.0, 1+431.5, 1+432.0, 1+432.5, 1+433.0, 1+433.5, 1+434.0, 1+434.5, 1+435.0, 1+435.5, 1+436.0, 1+436.5, 1+437.0, 1+437.5, 1+438.0, 1+438.5, 1+439.0, 1+439.5, 1+440.0, 1+440.5, 1+441.0, 1+441.5, 1+442.0, 1+442.5, 1+443.0, 1+443.5, 1+444.0, 1+444.5, 1+445.0, 1+445.5, 1+446.0, 1+446.5, 1+447.0, 1+447.5, 1+448.0, 1+448.5, 1+449.0, 1+449.5, 1+450.0, 1+450.5, 1+451.0, 1+451.5, 1+452.0, 1+452.5, 1+453.0, 1+453.5, 1+454.0, 1+454.5, 1+455.0, 1+455.5, 1+456.0, 1+456.5, 1+457.0, 1+457.5, 1+458.0, 1+458.5, 1+459.0, 1+459.5, 1+460.0, 1+460.5, 1+461.0, 1+461.5, 1+462.0, 1+462.5, 1+463.0, 1+463.5, 1+464.0, 1+464.5, 1+465.0, 1+465.5, 1+466.0, 1+466.5, 1+467.0, 1+467.5, 1+468.0, 1+468.5, 1+469.0, 1+469.5, 1+470.0, 1+470.5, 1+471.0, 1+471.5, 1+472.0, 1+472.5, 1+473.0, 1+473.5, 1+474.0, 1+474.5, 1+475.0, 1+475.5, 1+476.0, 1+476.5, 1+477.0, 1+477.5, 1+478.0, 1+478.5, 1+479.0, 1+479.5, 1+480.0, 1+480.5, 1+481.0, 1+481.5, 1+482.0, 1+482.5, 1+483.0, 1+483.5, 1+484.0, 1+484.5, 1+485.0, 1+485.5, 1+486.0, 1+486.5, 1+487.0, 1+487.5, 1+488.0, 1+488.5, 1+489.0, 1+489.5, 1+490.0, 1+490.5, 1+491.0, 1+491.5, 1+492.0, 1+492.5, 1+493.0, 1+493.5, 1+494.0, 1+494.5, 1+495.0, 1+495.5, 1+496.0, 1+496.5, 1+497.0, 1+497.5, 1+498.0, 1+498.5, 1+499.0, 1+499.5, 1+500.0, 1+500.5, 1+501.0, 1+501.5, 1+502.0, 1+502.5, 1+503.0, 1+503.5, 1+504.0, 1+504.5, 1+505.0, 1+505.5, 1+506.0, 1+506.5, 1+507.0, 1+507.5, 1+508.0, 1+508.5, 1+509.0, 1+509.5, 1+510.0, 1+510.5, 1+511.0, 1+511.5, 1+512.0, 1+512.5, 1+513.0, 1+513.5, 1+514.0, 1+514.5, 1+515.0, 1+515.5, 1+516.0, 1+516.5, 1+517.0, 1+517.5, 1+518.0, 1+518.5, 1+519.0, 1+519.5, 1+520.0, 1+520.5, 1+521.0, 1+521.5, 1+522.0, 1+522.5, 1+523.0, 1+523.5, 1+524.0, 1+524.5, 1+525.0, 1+525.5, 1+526.0, 1+526.5, 1+527.0, 1+527.5, 1+528.0, 1+528.5, 1+529.0, 1+529.5, 1+530.0, 1+530.5, 1+531.0, 1+531.5, 1+532.0, 1+532.5, 1+533.0, 1+533.5, 1+534.0, 1+534.5, 1+535.0, 1+535.5, 1+536.0, 1+536.5, 1+537.0, 1+537.5, 1+538.0, 1+538.5, 1+539.0, 1+539.5, 1+540.0, 1+540.5, 1+541.0, 1+541.5, 1+542.0, 1+542.5, 1+543.0, 1+543.5, 1+544.0, 1+544.5, 1+545.0, 1+545.5, 1+546.0, 1+546.5, 1+547.0, 1+547.5, 1+548.0, 1+548.5, 1+549.0, 1+549.5, 1+550.0, 1+550.5, 1+551.0, 1+551.5, 1+552.0, 1+552.5, 1+553.0, 1+553.5, 1+554.0, 1+554.5, 1+555.0, 1+555.5, 1+556.0, 1+556.5, 1+557.0, 1+557.5, 1+558.0, 1+558.5, 1+559.0, 1+559.5, 1+560.0, 1+560.5, 1+561.0, 1+561.5, 1+562.0, 1+562.5, 1+563.0, 1+563.5, 1+564.0, 1+564.5, 1+565.0, 1+565.5, 1+566.0, 1+566.5, 1+567.0, 1+567.5, 1+568.0, 1+568.5, 1+569.0, 1+569.5, 1+570.0, 1+570.5, 1+571.0, 1+571.5, 1+572.0, 1+572.5, 1+573.0, 1+573.5, 1+574.0, 1+574.5, 1+575.0, 1+575.5, 1+576.0, 1+576.5, 1+577.0, 1+577.5, 1+578.0, 1+578.5, 1+579.0, 1+579.5, 1+580.0, 1+580.5, 1+581.0, 1+581.5, 1+582.0, 1+582.5, 1+583.0, 1+583.5, 1+584.0, 1+584.5, 1+585.0, 1+585.5, 1+586.0, 1+586.5, 1+587.0, 1+587.5, 1+588.0, 1+588.5, 1+589.0, 1+589.5, 1+590.0, 1+590.5, 1+591.0, 1+591.5, 1+592.0, 1+592.5, 1+593.0, 1+593.5, 1+594.0, 1+594.5, 1+595.0, 1+595.5, 1+596.0, 1+596.5, 1+597.0, 1+597.5, 1+598.0, 1+598.5, 1+599.0, 1+599.5, 1+600.0, 1+600.5, 1+601.0, 1+601.5, 1+602.0, 1+602.5, 1+603.0, 1+603.5, 1+604.0, 1+604.5, 1+605.0, 1+605.5, 1+606.0, 1+606.5, 1+607.0, 1+607.5, 1+608.0, 1+608.5, 1+609.0, 1+609.5, 1+610.0, 1+610.5, 1+611.0, 1+611.5, 1+612.0, 1+612.5, 1+613.0, 1+613.5, 1+614.0, 1+614.5, 1+615.0, 1+615.5, 1+616.0, 1+616.5, 1+617.0, 1+617.5, 1+618.0, 1+618.5, 1+619.0, 1+619.5, 1+620.0, 1+620.5, 1+621.0, 1+621.5, 1+622.0, 1+622.5, 1+623.0, 1+623.5, 1+624.0, 1+624.5, 1+625.0, 1+625.5, 1+626.0, 1+626.5, 1+627.0, 1+627.5, 1+628.0, 1+628.5, 1+629.0, 1+629.5, 1+630.0, 1+630.5, 1+631.0, 1+631.5, 1+632.0, 1+632.5, 1+633.0,