

185.20
 B.M. 158.20 2" TOP E. CB. BROADVIEW 2'S. OF S. END RADIUS
 AT SE. COR. 8TH & BROADVIEW

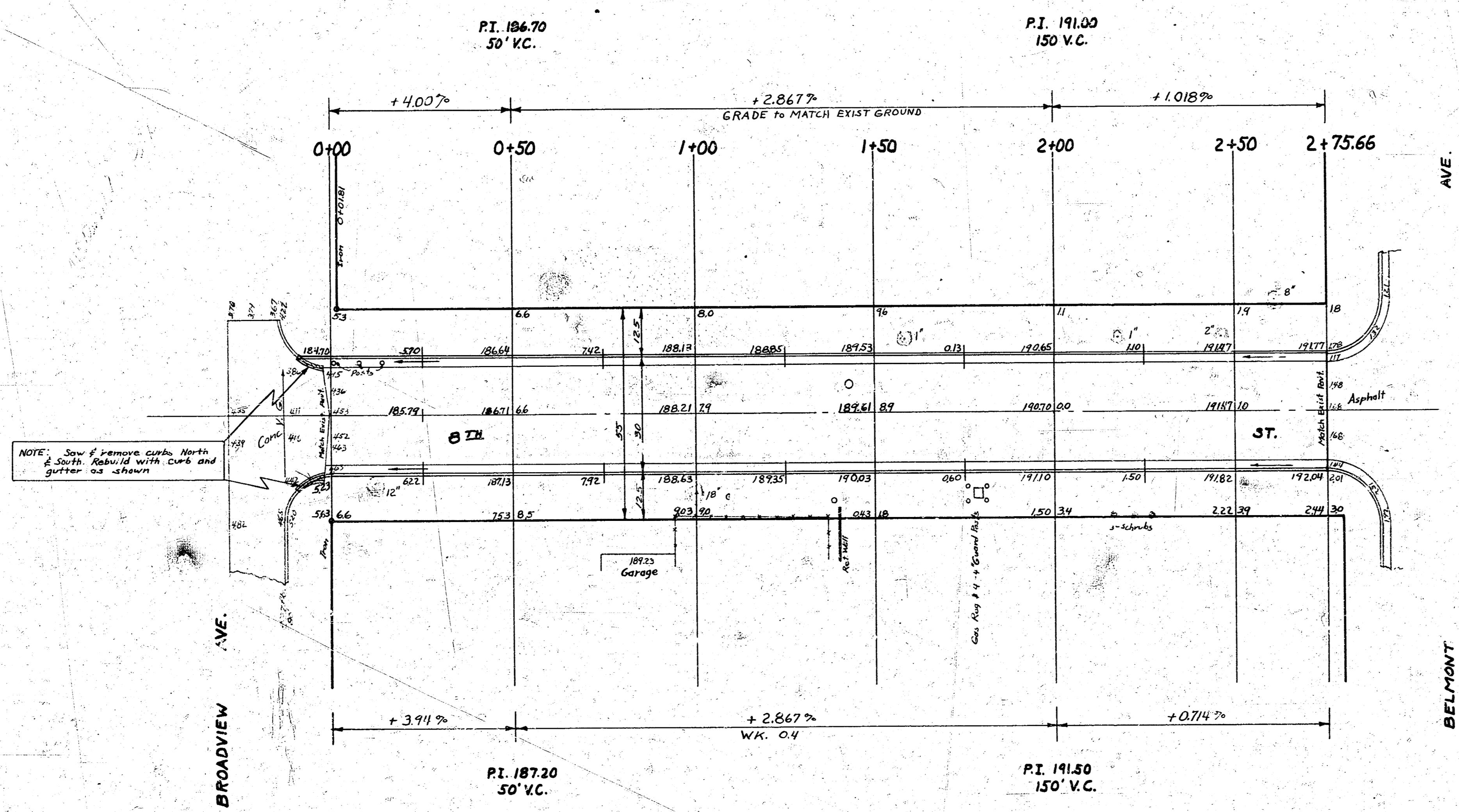

NOTE: See if removal curb, North & South, Abolish with curb and gutter as shown

Cut	Fill
Prop. 158.9	Prop. 22.9
174.8 Cu.Yd.	25.2 Cu.Yd.

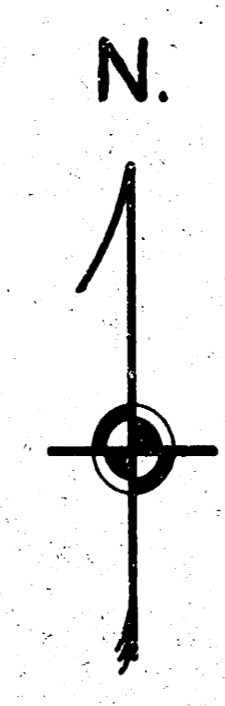

Surveyed by BK 173
 Plan ready
 Checked

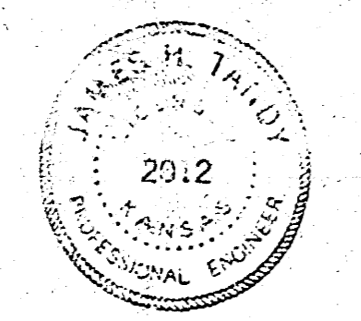

1/2

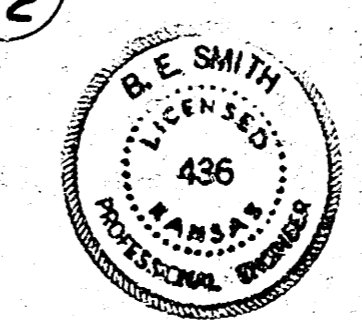

8TH STREET
 EL. BROADVIEW AVE. to WL. BELMONT AVE.
 26-2-30 A.C.
 CITY of WICHITA, KANSAS
 B.E. SMITH CITY ENGINEER
 Date: Sept. 1961 Proj. No. C11-16