

B.M. 121.655 15th Stake for 1st. City @ N.L. 9th Street
 B.M. 124.70 11th Cor. Concrete Parap. Man on C.E. Cor. 9th & 8th
 B.M. 124.70 City Stake on 11th Cor. 9th & 8th
 B.M. 125.055 11th Stake on 11th Cor. 9th & 8th
 B.M. 125.055 11th Stake on 11th Cor. 9th & 8th
 B.M. 125.055 11th Stake on 11th Cor. 9th & 8th
 B.M. 125.055 11th Stake on 11th Cor. 9th & 8th

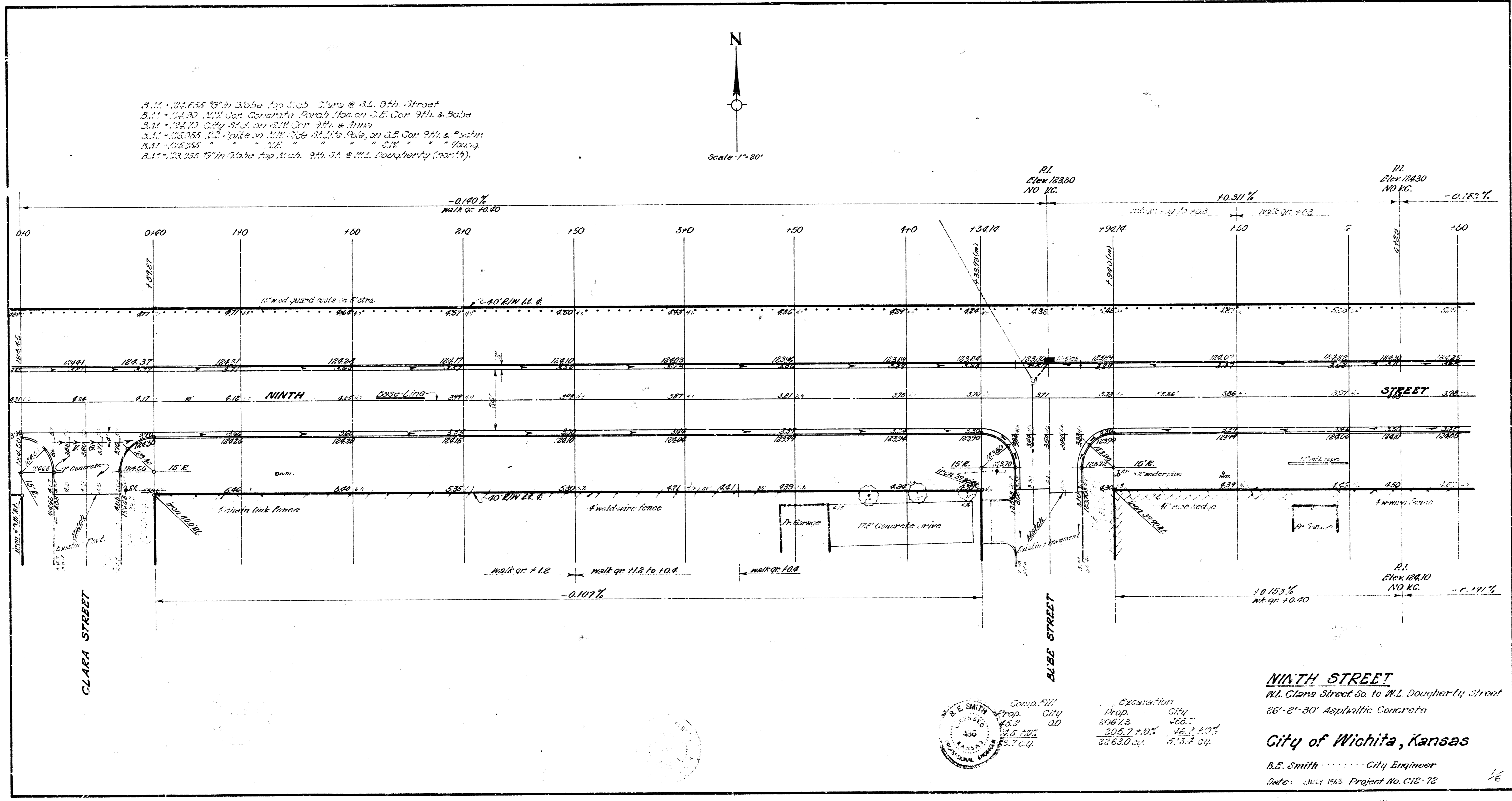

5' x 9' 1/2"

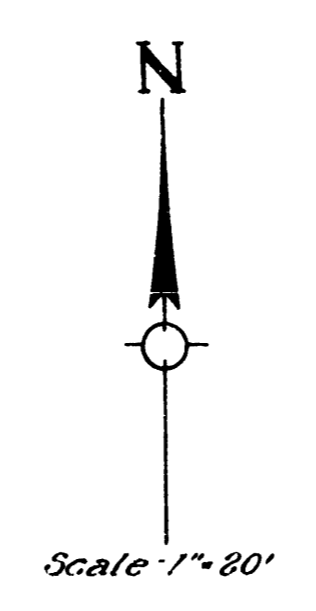
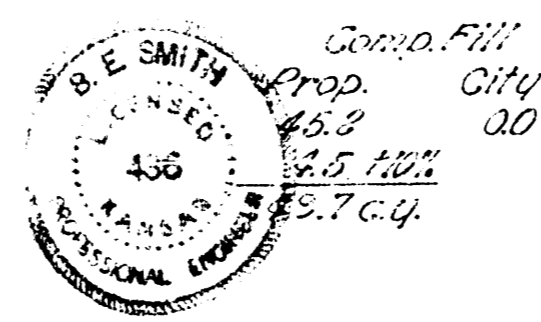

Executed this
 20th day of
 July 1968
 at the City of
 Wichita, Kansas

NINTH STREET
 N.L. Clara Street So. to M.L. Dougherty Street
 66'-81'-30" Asphaltic Concrete
City of Wichita, Kansas
 B.S. Smith City Engineer
 Date: JULY 1968 Project No. C12-72

