

9th ST
E.L. West ST. to W.L. ZOO BLVD.

Proj NO. 472-76-245-80829-000-000-001

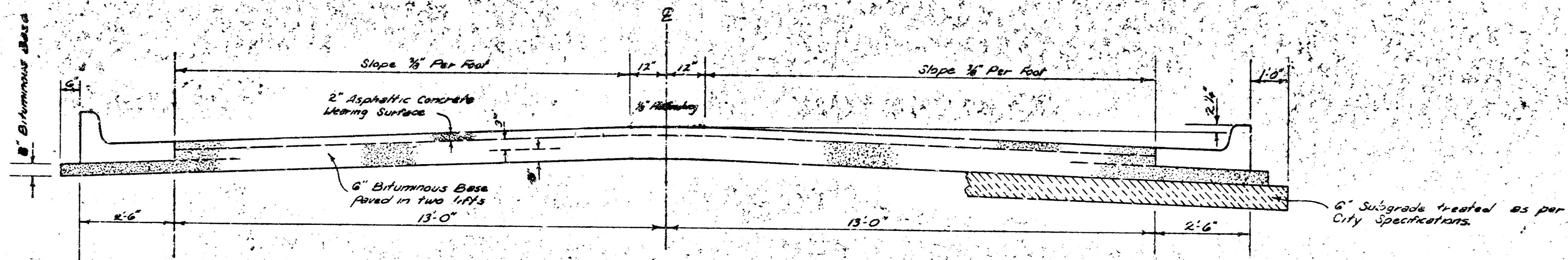

TYPICAL SECTION

3\"/>

The A.C. pavement between the Comb. Curb & Gutter shall be paid as 3\"/>

A TACK COAT OF EMULSIFIED ASPHALT (SS-1H) SHALL BE APPLIED AT AN APPROXIMATE RATE OF 0.05 GALLONS PER SQ. YD. BETWEEN LIFTS OF ASPHALTIC MATERIALS WHEN ORDERED BY THE ENGINEER. TACK COAT WILL NOT BE PAID FOR DIRECTLY AND SHALL BE CONSIDERED AS SUBSIDIARY TO PRICE BID FOR ASPHALTIC PAVEMENT.
 BITUMINOUS BASE AND ASPHALTIC CONCRETE WEARING SURFACE SHALL BE PLACED WITH A LAYDOWN MACHINE, HAVING AUTOMATIC ELECTRONIC CONTROLS FOR CROWN AND GRADE. CONSTRUCTION JOINTS IN EACH LIFT SHALL BE STAGGERED A MINIMUM DISTANCE OF 1' WITH JOINTS IN PRECEDING LIFTS AND SUCH THAT A JOINT WILL BE CONSTRUCTED ON THE PAVEMENT CENTERLINE IN THE TOP LIFT.

DETAIL OF TRANSVERSE CONSTRUCTION JOINTS

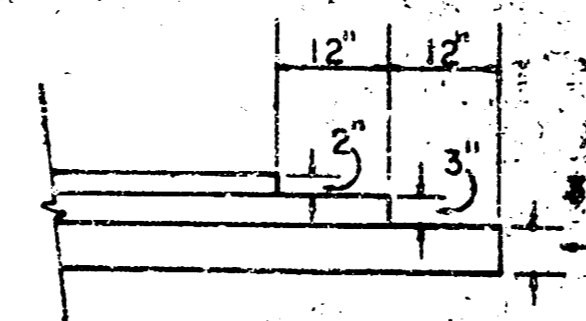

TRANSVERSE CONSTRUCTION JOINTS SHALL BE CONSTRUCTED IN FLEXIBLE BASE PAVEMENTS AT LOCATIONS WHERE PAVEMENT TEMPORARILY ENDS TO FACILITATE FUTURE PAVEMENT CONSTRUCTION AS SHOWN BY DETAIL. THE COST OF CONSTRUCTING THE TRANSVERSE CONSTRUCTION JOINTS SHALL NOT BE MEASURED OR PAID FOR DIRECTLY BUT SHALL BE INCLUDED IN THE BID PRICE FOR SQUARE YARDS OF ASPHALTIC CONCRETE PAVEMENT.

COMBINED CURB & GUTTER

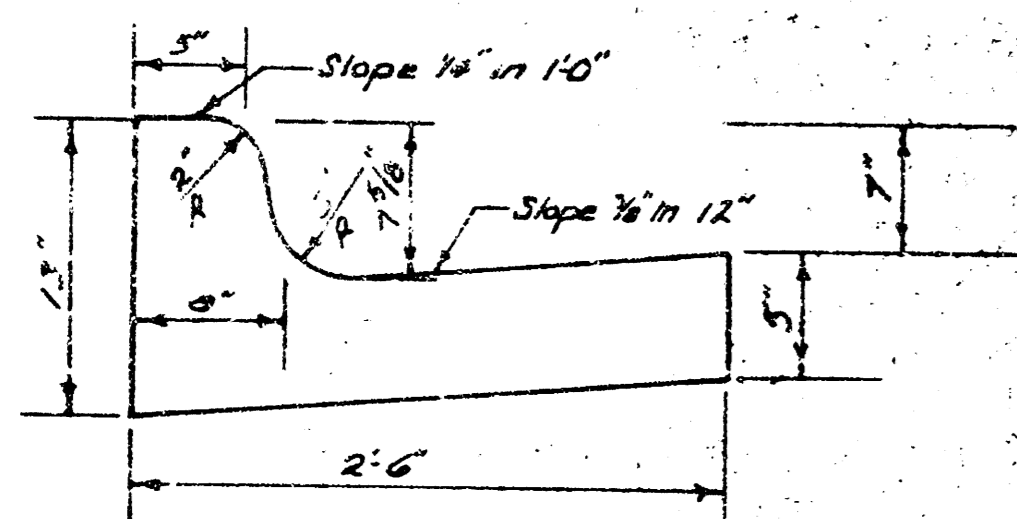

ROLL TYPE CURB & GUTTER

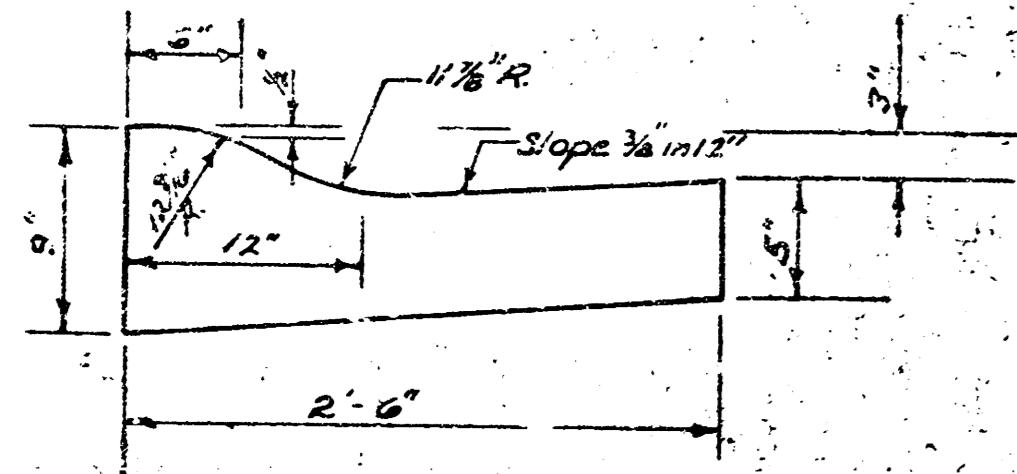

CITY OF WICHITA, KANSAS

DEPARTMENT OF PUBLIC WORKS -- ENGINEERING

DEAN SELLERS Acting CITY ENGINEER

DATE: _____ PROJ. NO. 472-76-245-80829-000-000-001

1/5

B.M. = 121.89 City ST. SW Cor 9th & West - 24' S & 52' W @ both
 B.M. = 123.70 SE Cor Porch Ho = 38' 6" West 9th ST. N
 B.M. = 125.25 @ Ctr 4' WK E Adj to E. Ch ZOO at N Line 9th ST.
 Base Line is Ctr of 9th ST.

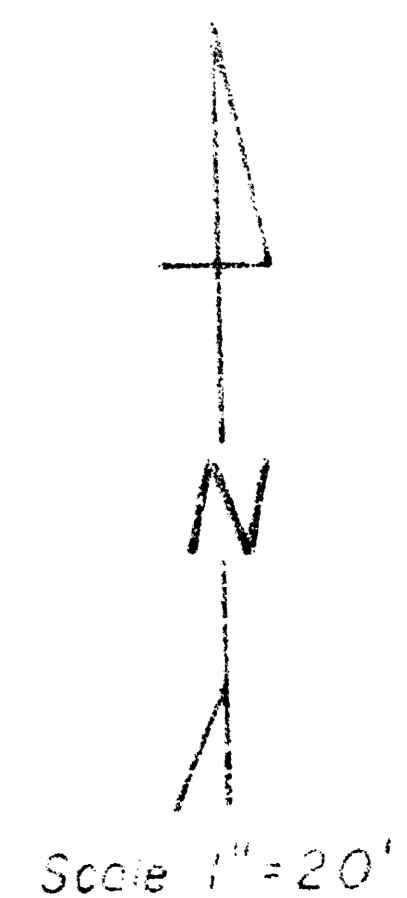
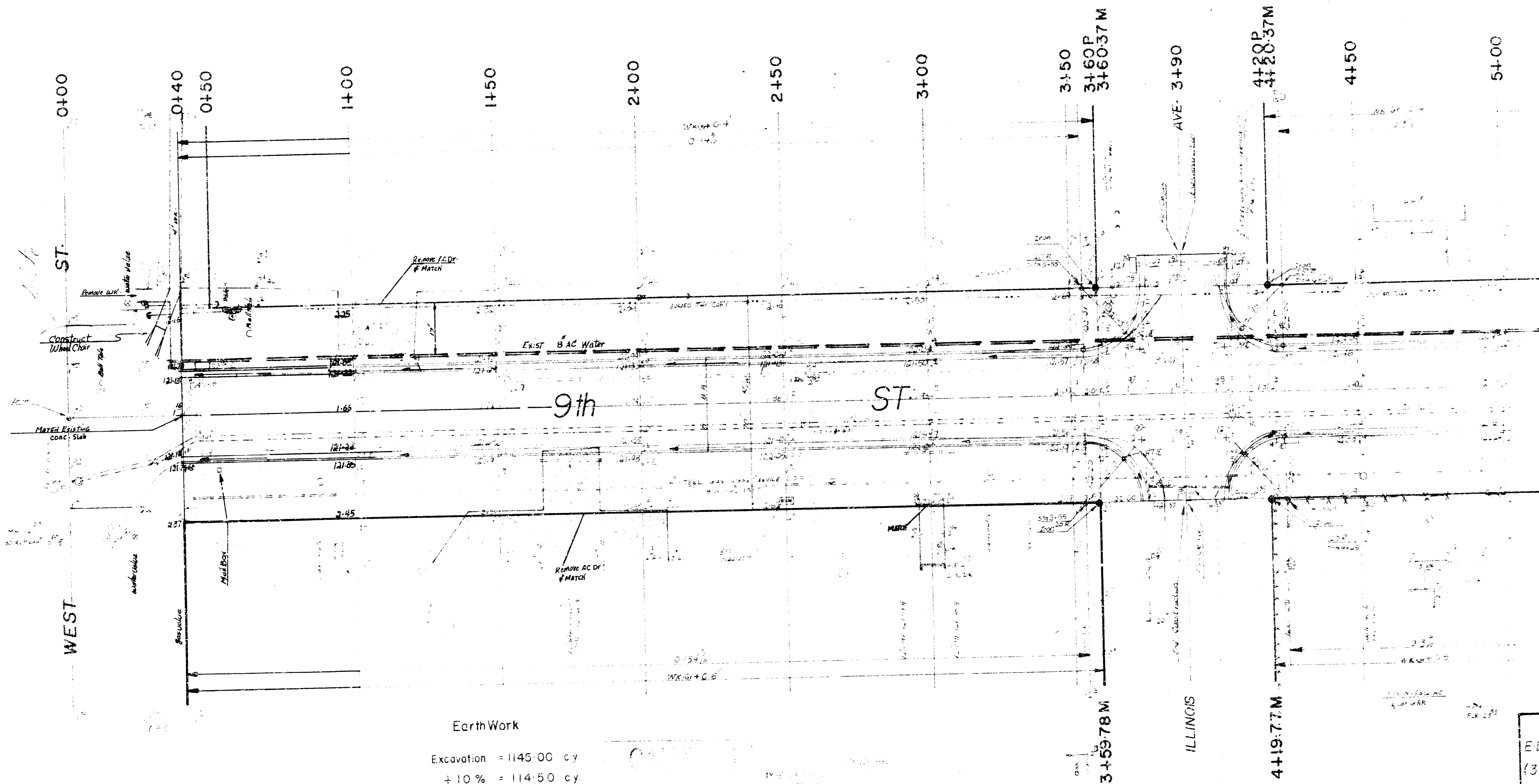

EarthWork

Excavation	= 1145.00 cy
+ 10%	= 114.50 cy
total	= 1259.50 cy
Comp Fill	= 2.57 cy
+ 10%	= 2.55 cy
total	= 28.12 cy
Manipulation	= 2876.00 s.y

NOTE: NO LINE of cement Treatment.

9th ST.
 EL West ST. TO W.L. ZOO BLVD
 (31' B-B A.C. Pavt/Comp Cb-B Gutter.)
CITY of WICHITA, KANSAS
 Dean Sellers Acting City Engineer
 proj NO
 472-76-245-80929-000-000-001
 Date

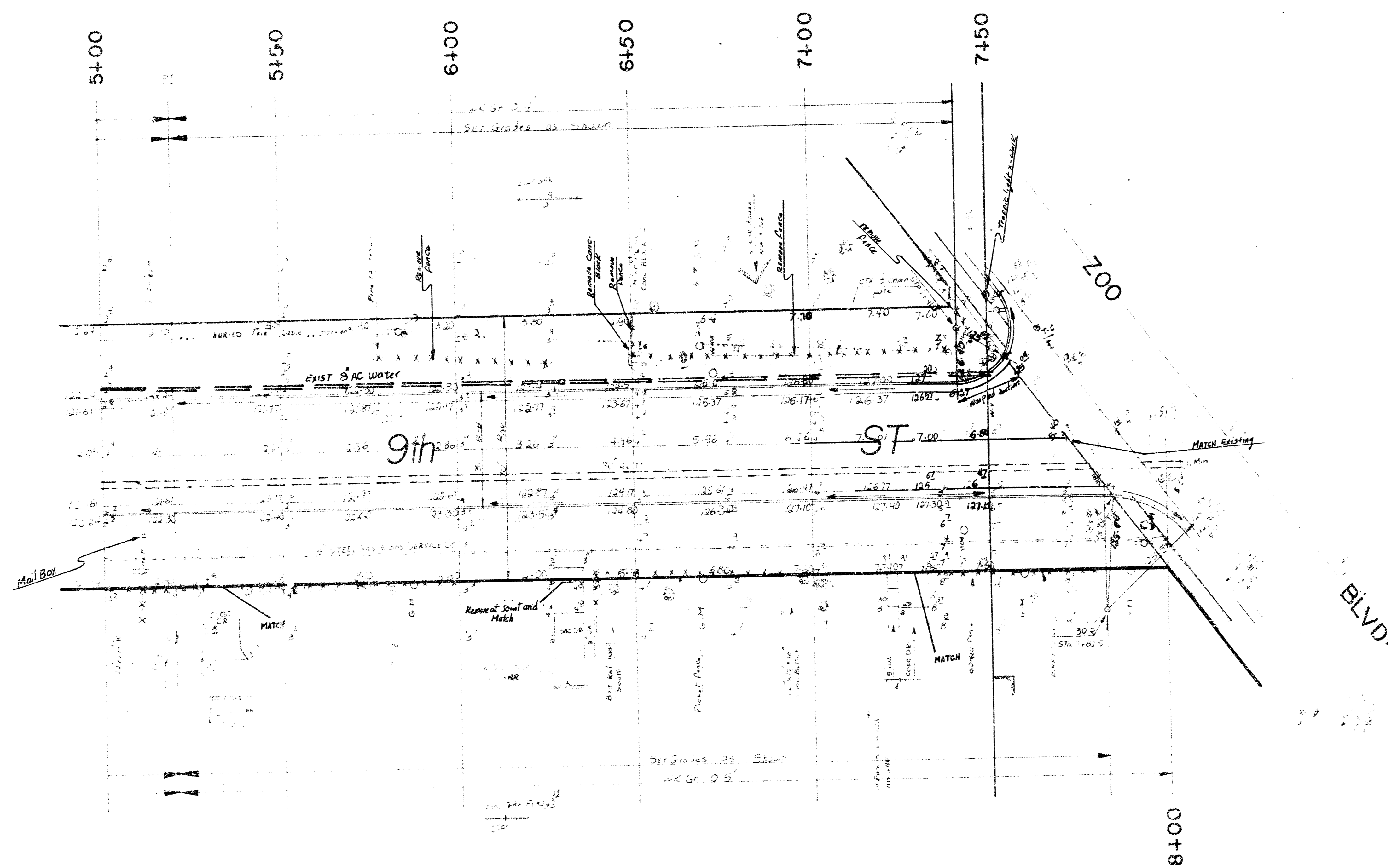

N
 Scale 1" = 20'

9th ST
 E-L West ST. to W-L Zoo BLVD
 472-76-245-80829-000-000-001

3/3

FILMED FROM THE BEST AVAILABLE COPY