

B.M. 18610 Top of Coping near Hand Rail S.E. Cor. Bridge - Battin & 9th

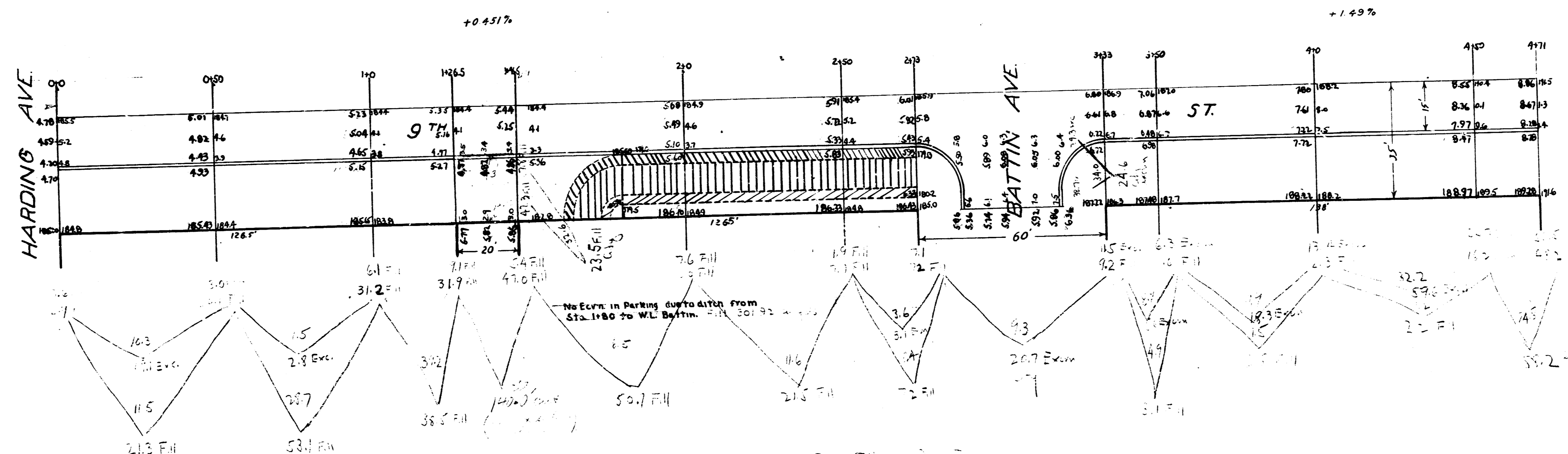

City Fill	City Excav	Prop. Fill	Prop. Excav
23.5	20.7	2.3	4.4
23.7	24.6	19.2	3.1
	70.2	22.7	4.5
	11.3	21.2	1.5
		1.1	1.1
		1.8	16.7
		21.7	1.1
		201.3	1.1

9th ST.
SOUTH HALF
E.L. HARDING TO E. HIGHLANDS N. ADD.
15' CONCRETE & CB.
CITY OF WICHITA, KANSAS
L.K. WHITE CITY ENGINEER
JULY 1946

B.M. 186.48 E. Co. BATTIN S.L. 9TH
 B.M. 184.75 N.E. Cor. PARCH J.W. CO. PINECREST & 9TH

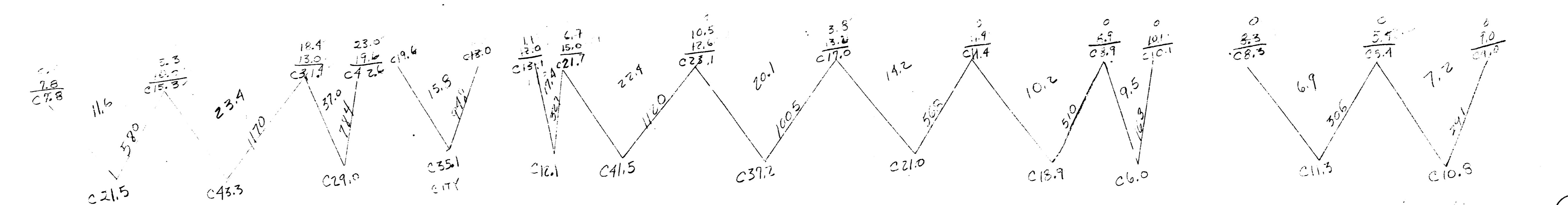
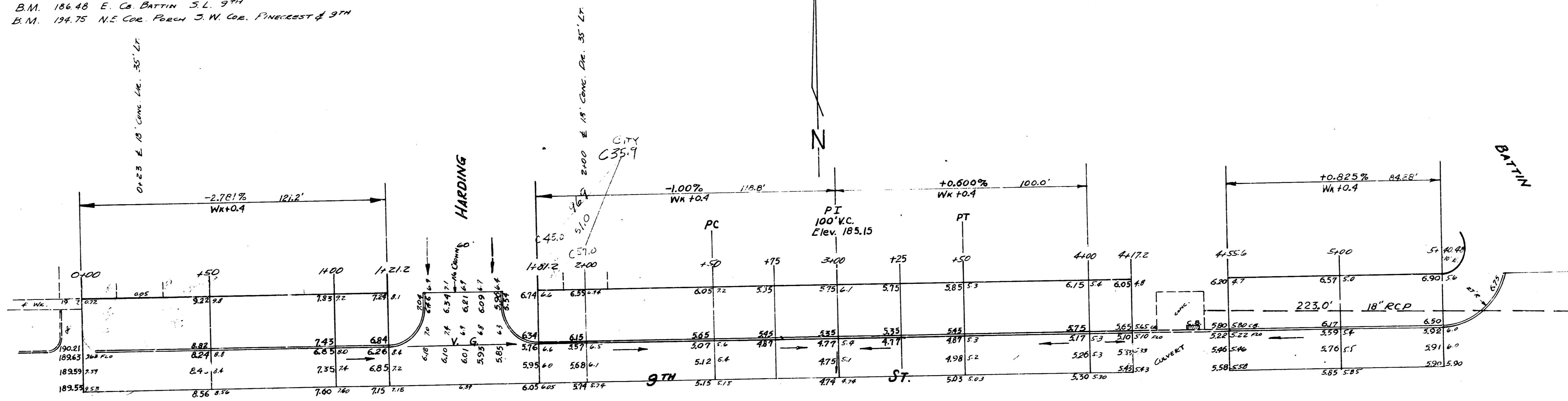

CITY		PROPERTY	
C	F	C	F
21.5	5.9	252.6	6.6
35.9	5.9	309.9	6.6
35.1		557.5	10.2
71.0		1090	7.3
		613.3	

N 1/2 9TH ST.
 363' E. OF OLIVER TO W.L. PINECREST
 15' CONC. & CO.
 CITY OF WICHITA, KANSAS
 L. K. WHITE CITY ENGINEER
 JAN. 1952 PROJ. C11-131



B.M. 186.48 E. Co. BATTIN S.L. 97th
 B.M. 139.75 N.E. Cor. Peach S.W. Cor. Pinecrest & 97th

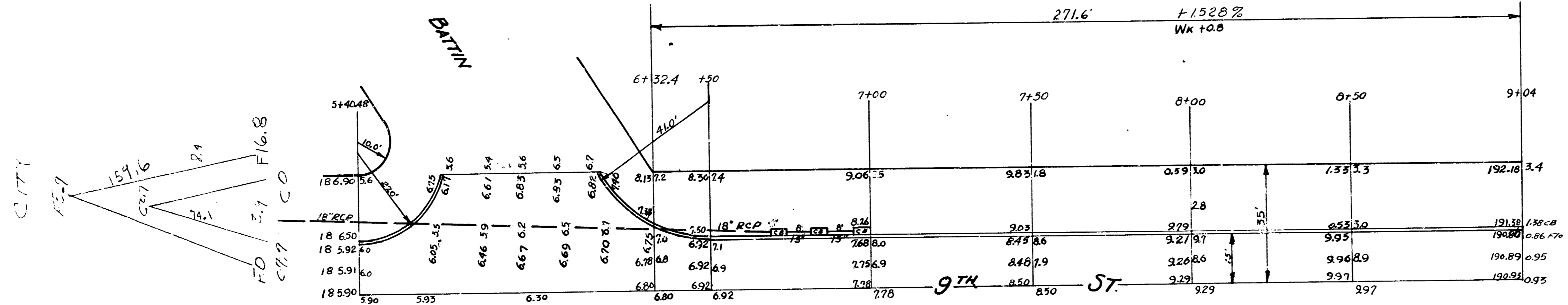

CITY	PROPERTY
C	C
31.2	5.7
337	59
	38
	301.5
	7.7
	6.6

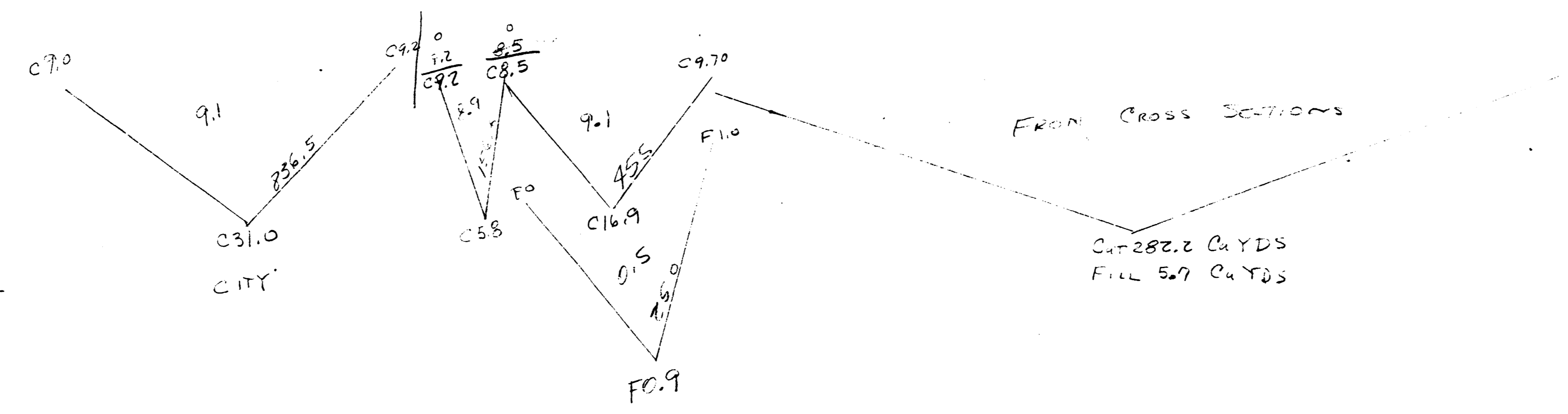

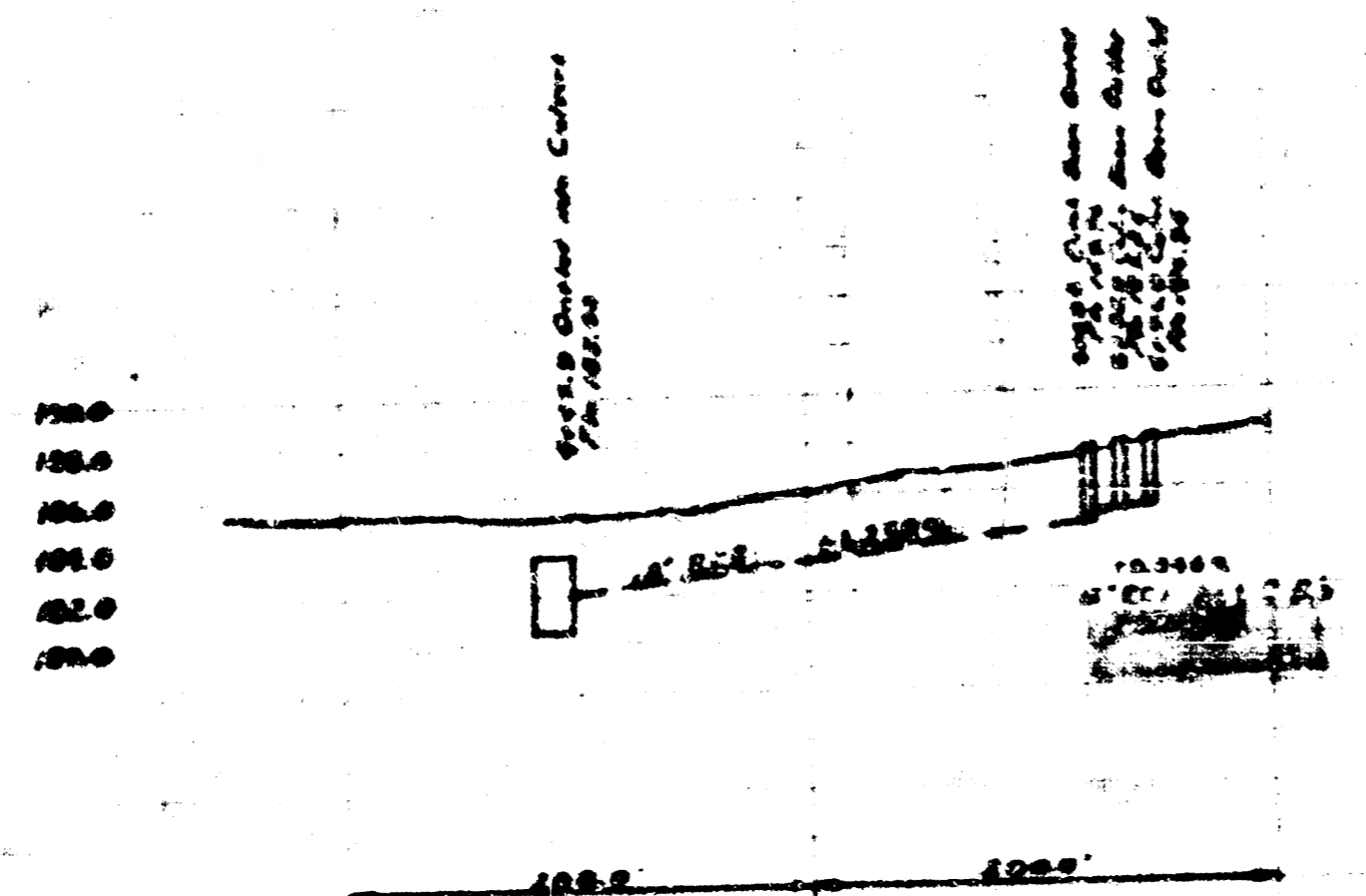
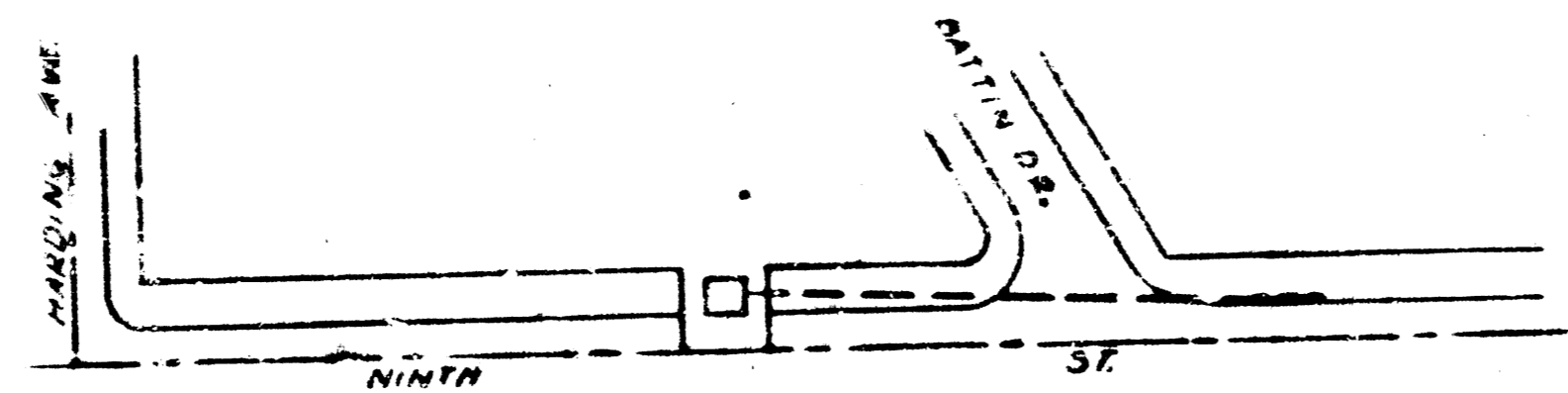

CITY OF WICHITA, KANSAS
 ENGINEERING DIVISION
 L. K. WHITE - CITY ENGINEER
 STORM WATER SEWER
 SCALE 1"=80' MARCH 1952
 INCIDENTAL DRAINAGE PAVING NO. 924
 363' E. OLIVER TO PINECREST

