

BM: - 197.50 Standard 9'S # 1'W of NW cor. 9th & Woodlawn
Chaining E on S R.

BM: - 187.965 "R" in Ritchie E of Mission & SL 9th

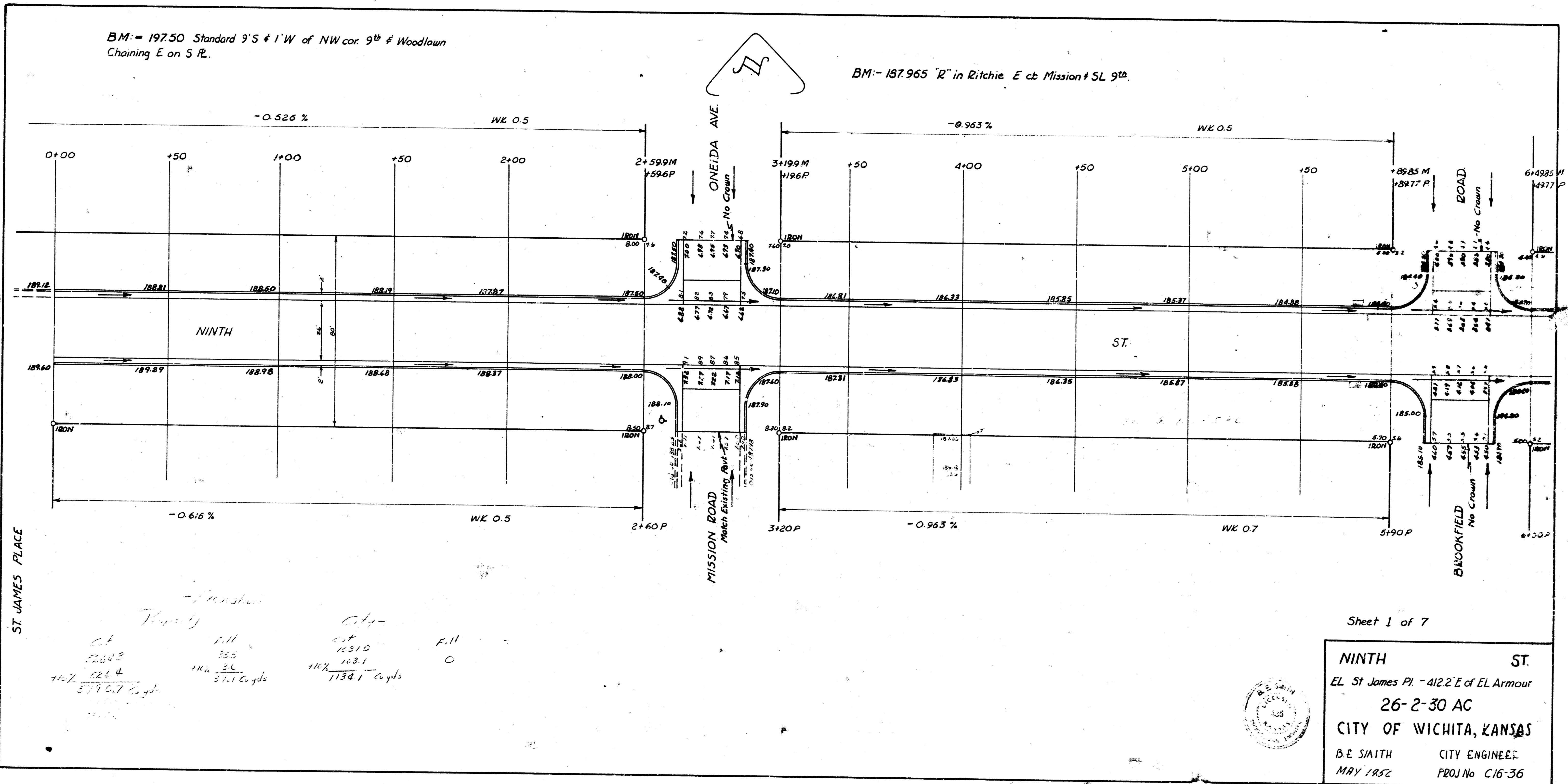

Checked by: [Signature]
 Drawn by: [Signature]

1st 280.3
 2nd 124.4
 3rd 577.67 cu yds

1st 355
 2nd 36
 3rd 37.1 cu yds

1st 1631.0
 2nd 1631
 3rd 1134.1 cu yds

F.II
O

Sheet 1 of 7

NINTH ST.
 EL. St James Pl. - 412.2' E of EL Armour
 26-2-30 AC
 CITY OF WICHITA, KANSAS
 B.E. SMITH CITY ENGINEER
 MAY 1952 PROJ No C16-36



BM = 177.98 Standard SW cor

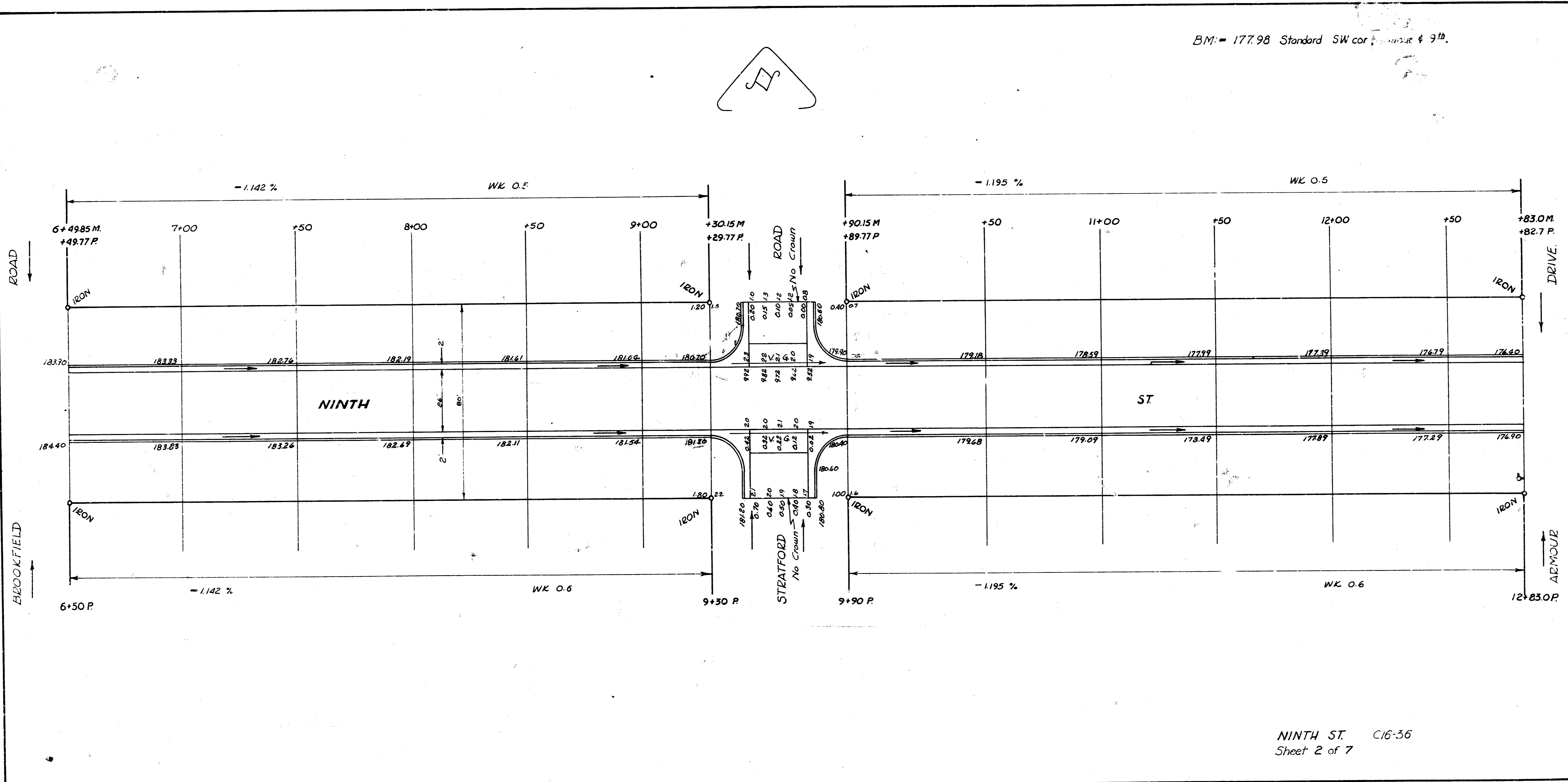

NINTH ST. C16-56
Sheet 2 of 7

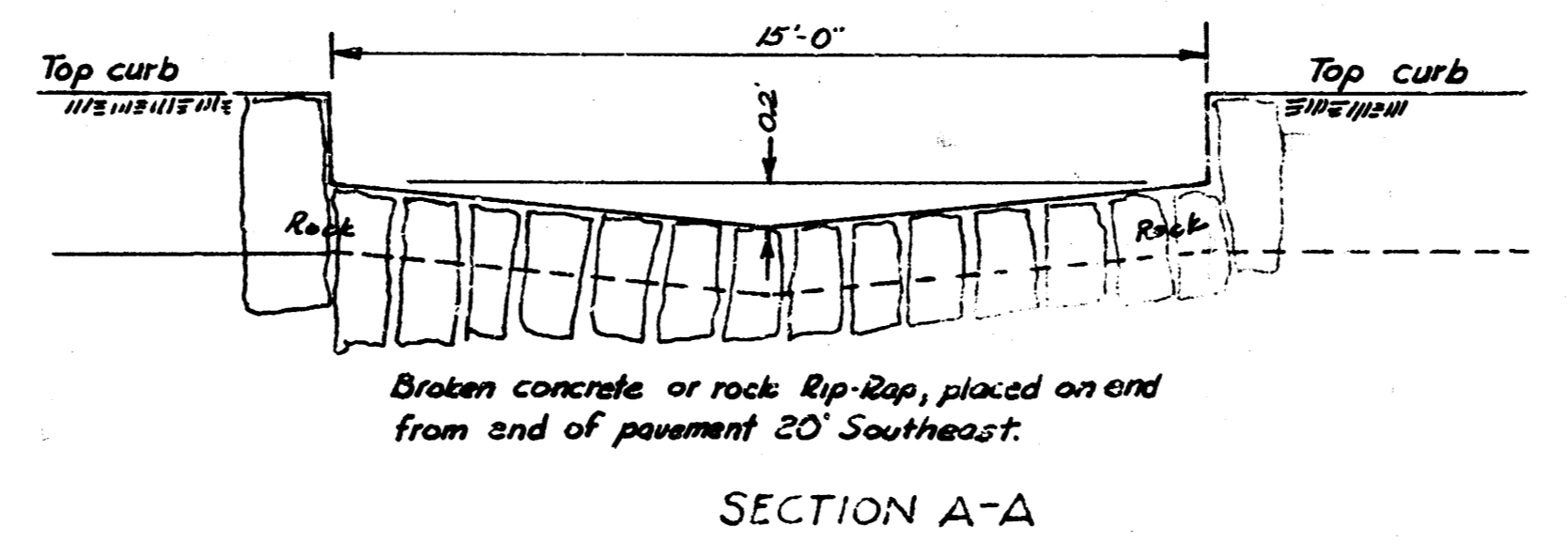
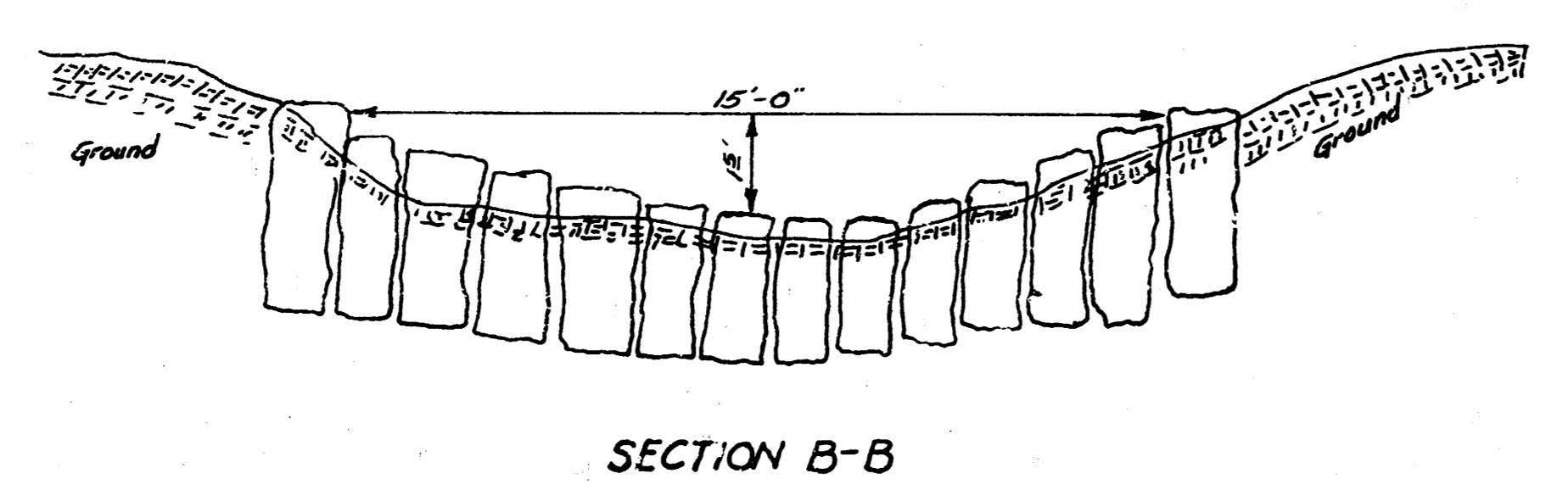
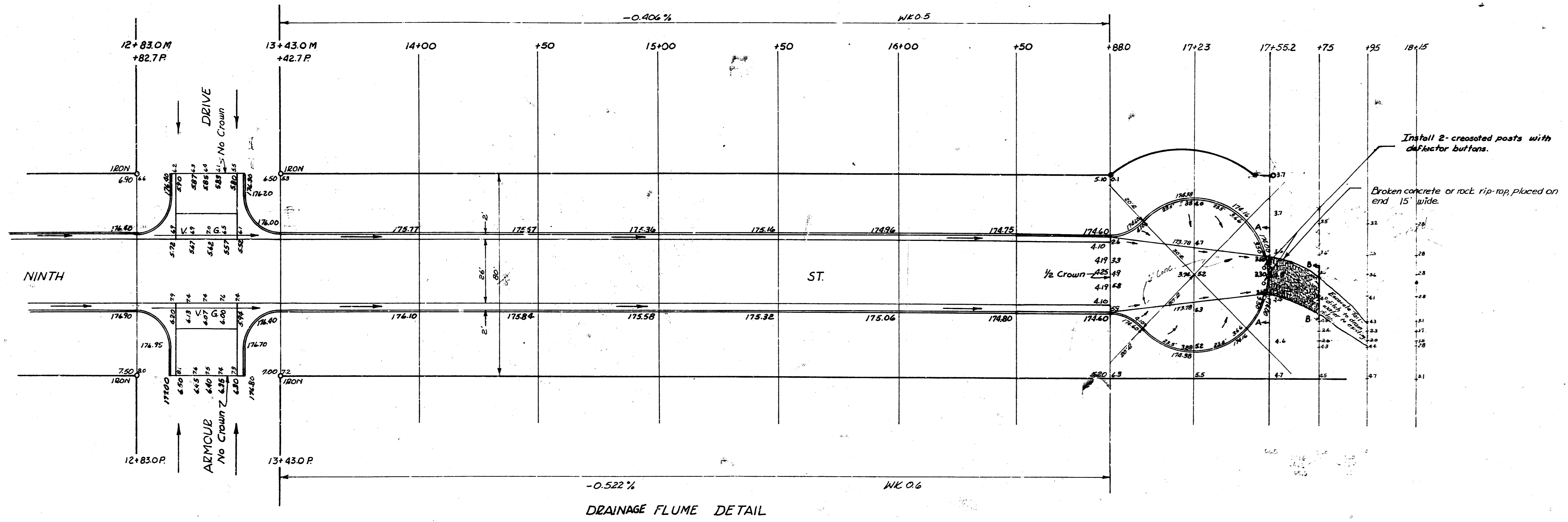
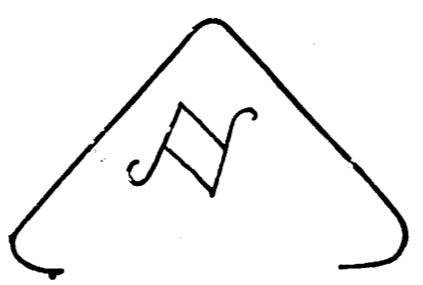

NINTH ST. C16-36
Sheet 3 of 7