

B.M. 126.42 3" Top Conc. Coping NE. Cor. 20<sup>th</sup> & Woodrow  
 B.M. 124.25 5" In Glube Top Ca. N.S. 20<sup>th</sup> - E.L. Porter  
 Stationing on E

**NOTICE TO CONTRACTOR.**  
 Extreme caution must be exercised during excavation  
 and construction between Sta 4+50 and Sta 5+80 as you  
 are crossing the Main Water Lines feeding the City.

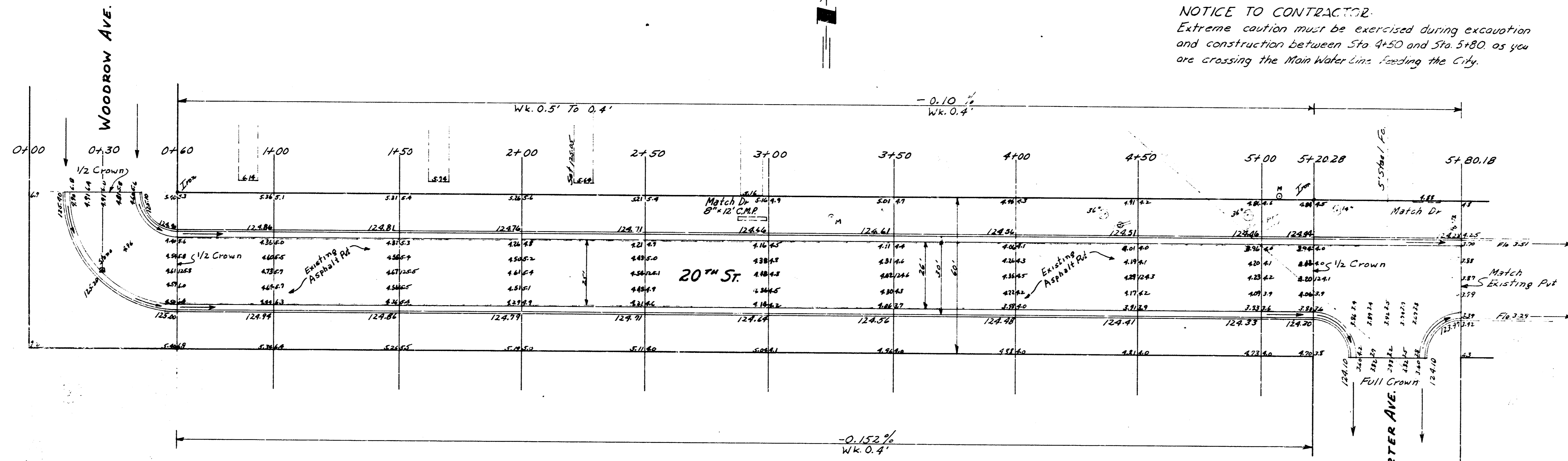

**20<sup>TH</sup> ST.**  
 W.L. Woodrow To E.L. Porter  
 26-2-30-(2" AC-6" CONC. BASE)  
 CITY OF WICHITA KAN.  
 BE SMITH CITY ENGINEER  
 JULY 1954 Proj. No. C15-56