

PAVING PLAN-----1945.  
**SEVENTEENTH STREET** W.L. VASSAR  
 W.L. YALE  
 CONCRETE: WIDEN TO 40', & CURB  
 7" curb.

B.M. EL:196.42 - Top of Thumb, @ Yale & Seventeenth

5-123  
 946.S  
 2-218  
 1  
 5-123  
 946.S

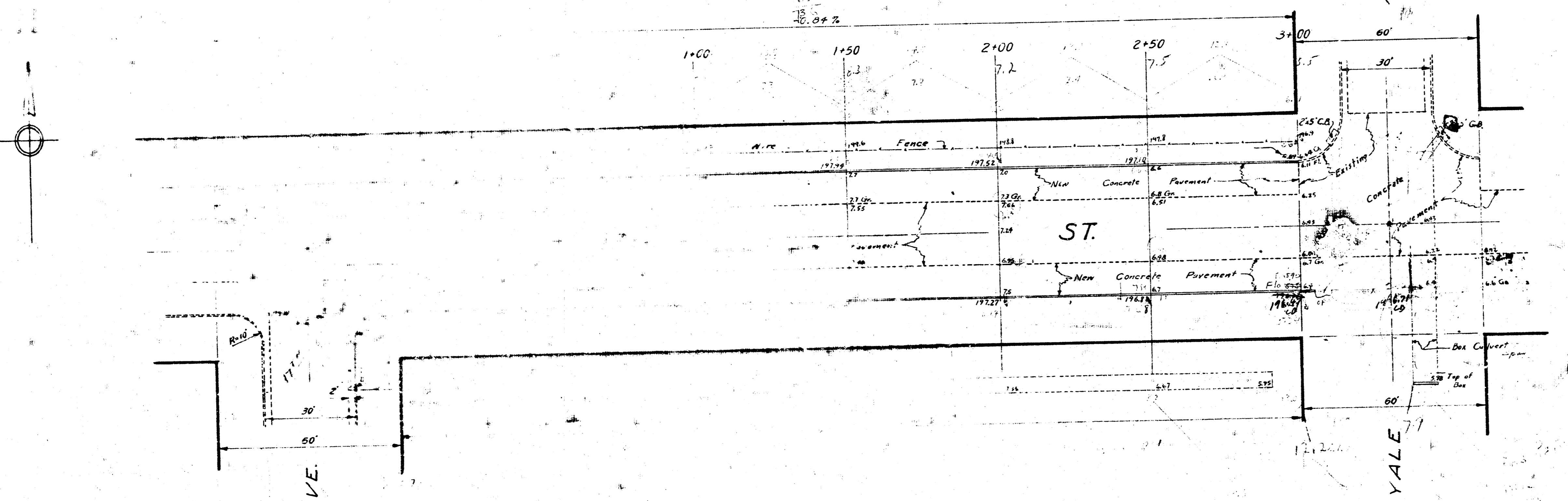

SUMMARY

CITY	
NO.	
DATE	
APPROVED	
BY	
FOR	
TOTAL	

DATE: 5-22-45  
 BY: W.L. VASSAR  
 W.L. YALE