

B.M. 122.75 "M" in Mueller, Fire Hydrant S.E. Cor. 11th & St. Paul.  
 B.M. 122.99 N.W. Cor. Conc. Porch, House #1212 Edwards.

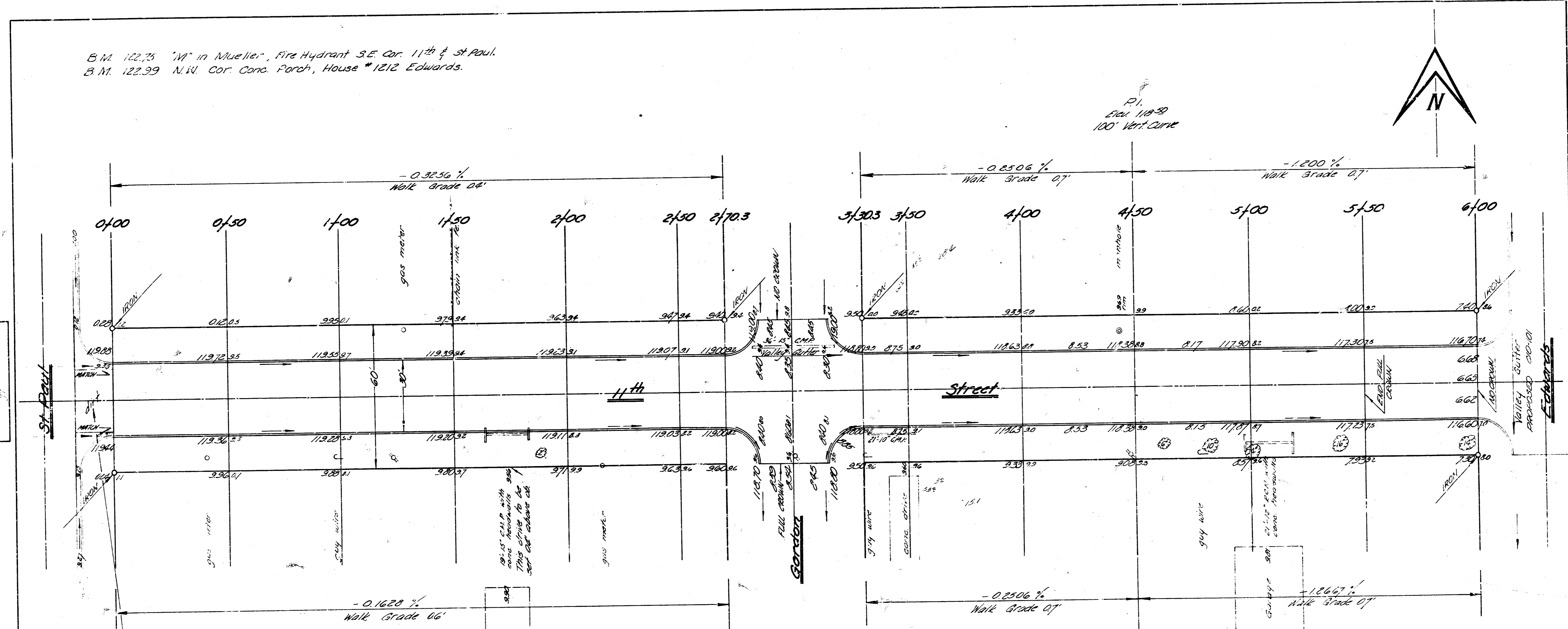
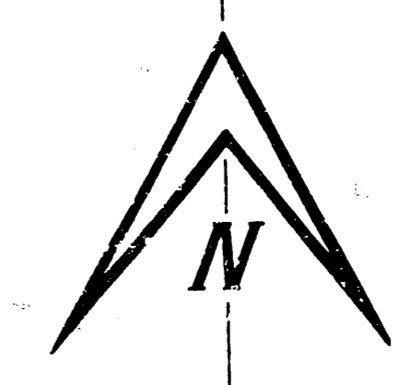

ASSESS TO BE IN JONES 3-3-24

**Note to Contractor**  
 Const asphaltic concrete hook-up (4" thickness)  
 between existing A.C. mat, sta 0-17, & new pavement.  
 Hook-up to match existing concrete curb & gutter as  
 indicated on plan.

EXCAVATION	
Property	CITY
862.3	118.3
86.2	11.0
948.5	130.1

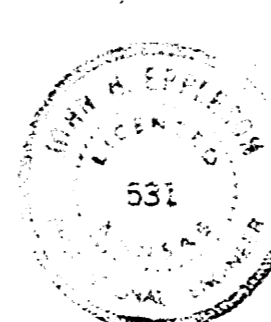

**11th Street**  
 E.L. St. Paul to W. Edwards  
**30' Conc. & Cb**  
 City of Michig. **EDWARDS**  
 B.E. Smith City Engineer  
 Date: May 1921 Proj. No. 10-152