

BM 115-69 "K" John K. Ball C. W. S. W. L. Mathewson & N. L. 11th

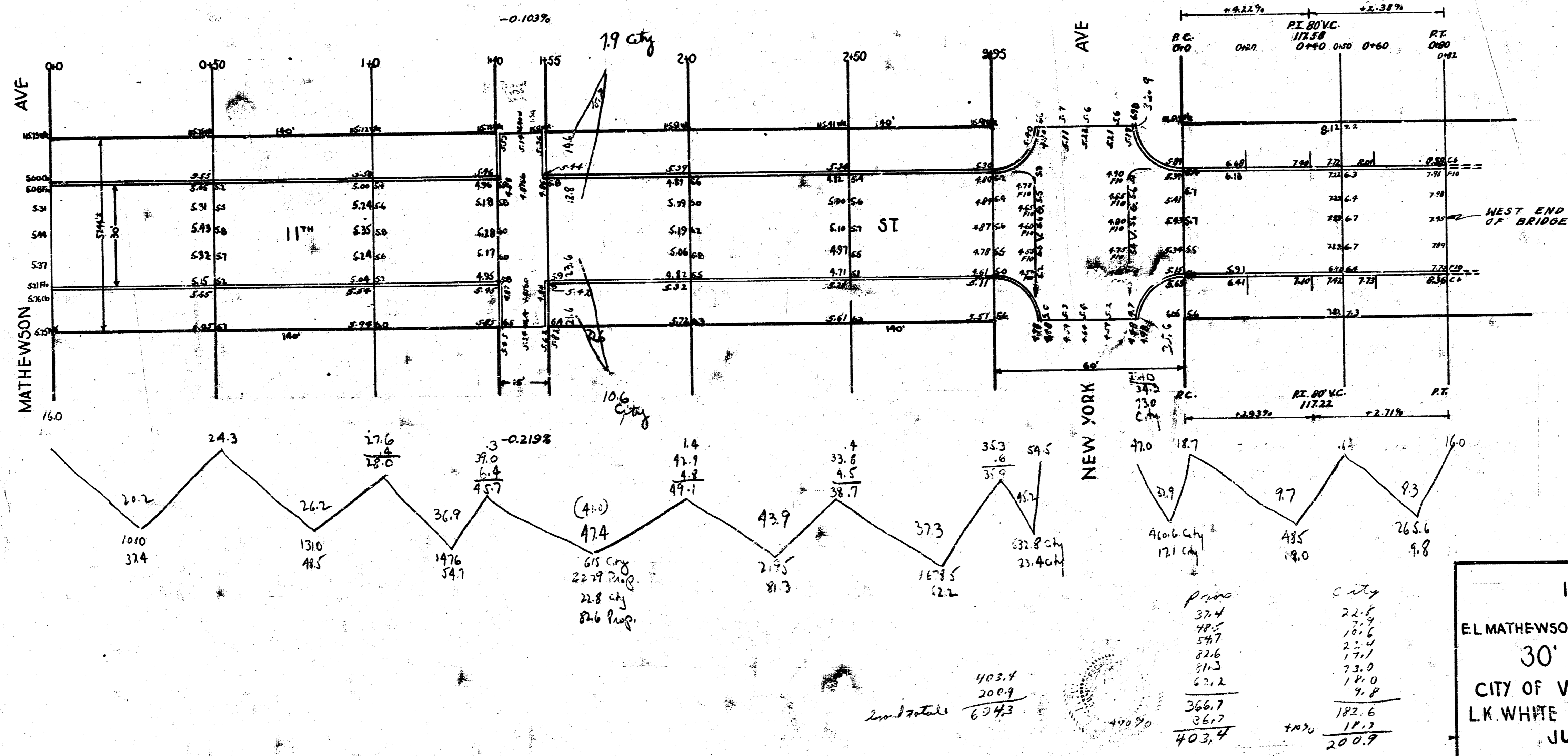

11th ST
 EL MATHEWSON TO EL NEW YORK
 30' CONCRETE & CB.
 CITY OF WICHITA, KANSAS
 L. K. WHITE CITY ENGINEER
 JUNE 1946

403.4
 200.9
 604.3

403.4
 200.9
 604.3

403.4
 200.9
 604.3

4351