

Sta Or. &
 B.M. 115.08 "G" In Globe W Cb Minneapolis N.L. 12th St.

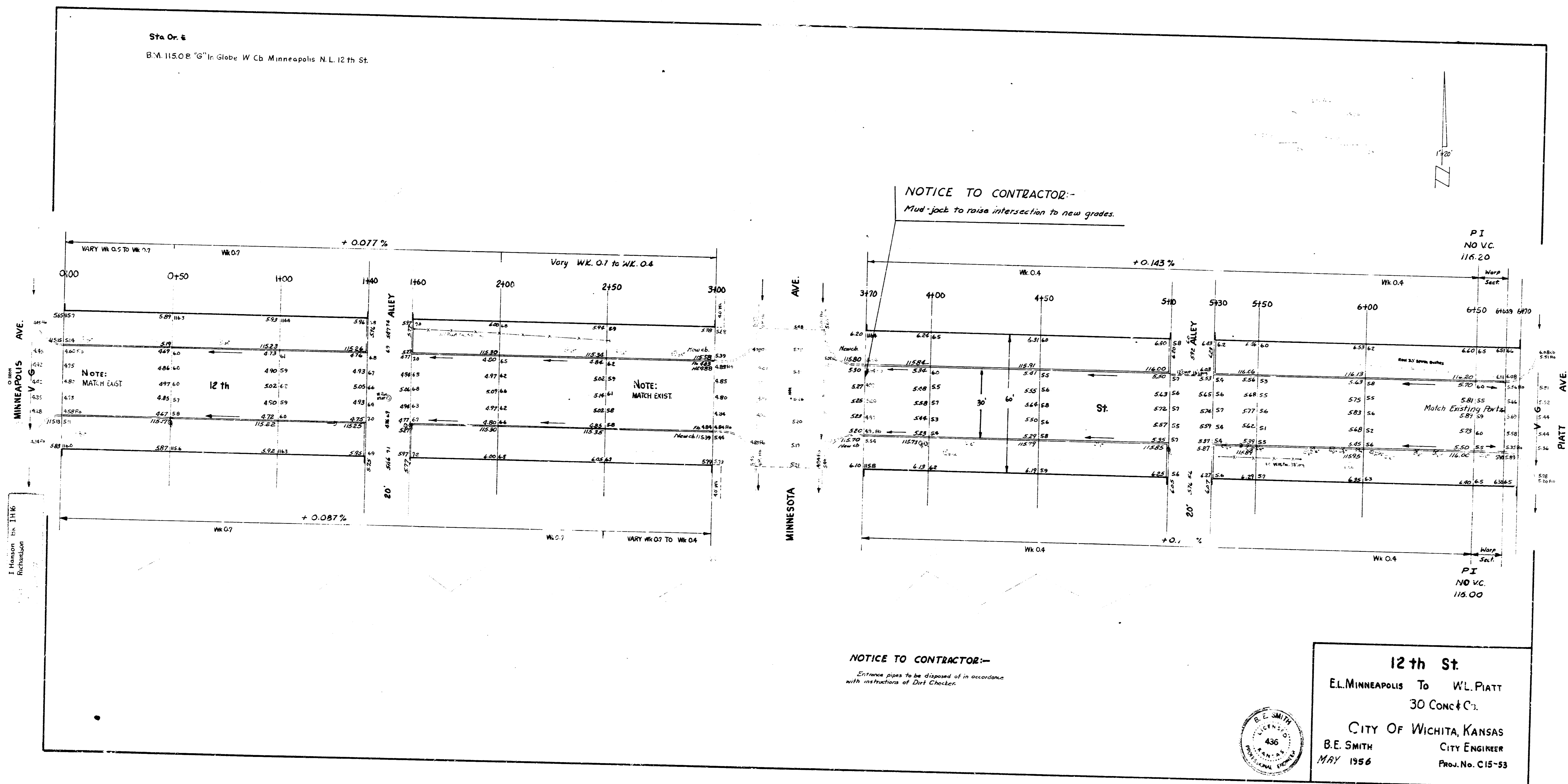

NOTICE TO CONTRACTOR:-
 Must jack to raise intersection to new grades.

NOTICE TO CONTRACTOR:-
 Entrance pipes to be disposed of in accordance with instructions of Dirt Checker.

12th St
 E.L. MINNEAPOLIS To W.L. PIATT
 30 Conc & C.
 CITY OF WICHITA, KANSAS
 B.E. SMITH CITY ENGINEER
 MAY 1956 Proj. No. C15-53

