

BM - "G" IN GLOBE W END RAD. NW COR. 12TH & ESTELLE EL 129.60
 STATIONING ON CENTERLINE 127'

BM. N.E. COR. CONC. PORCH 1405.8' 1287 N. VOLUTSIA EL 14139

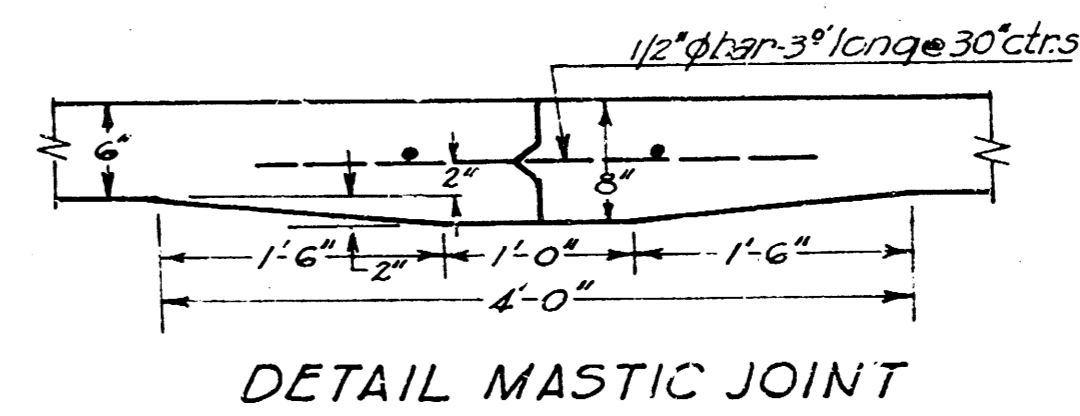
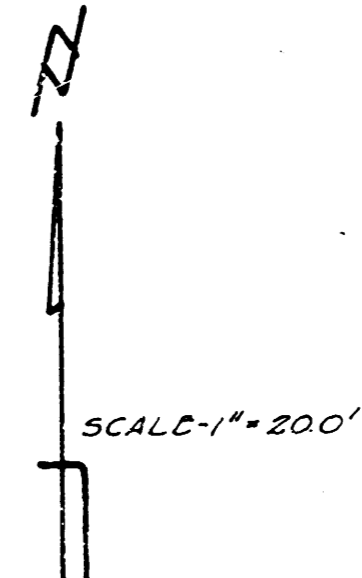
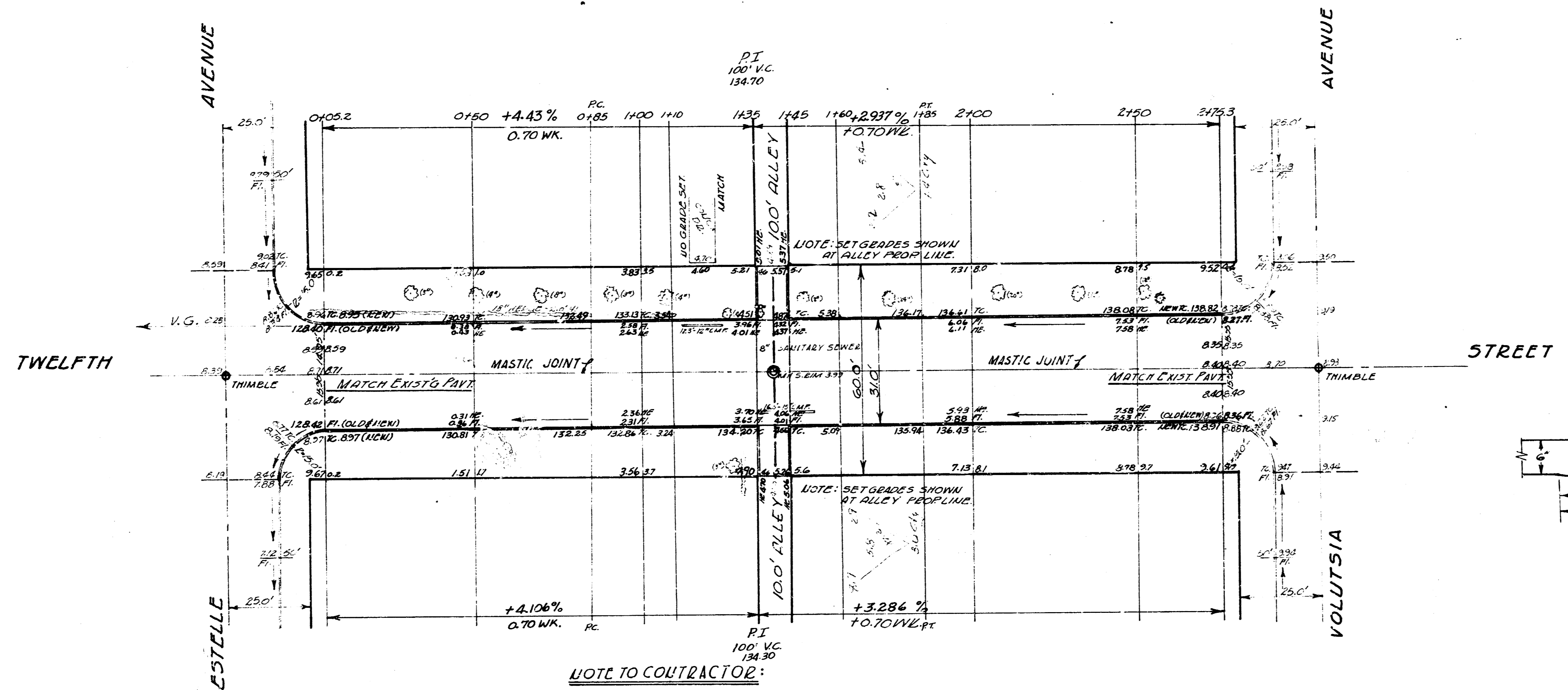

NOTE TO CONTRACTOR:
 CUTDRAIN PIPES TO BE DISPOSED OF IN ACCORDANCE WITH INSTRUCTION OF DIST. CHECKER.

EXCAVATION TOTALS

	EXCAV.	FILL
PROP	160.0	27.4
	+10% 18.0	+10% 3.0
TOTAL	234.0	30.4
CITY	187.5	12.9

TWELFTH STREET
 EL. ESTELLE WL. VOLUTSIA
 300' CONC. & C.B.
 CITY OF WICHITA, KANSAS
 B.E. SMITH CITY ENGINEER
 MARCH 1956 P20; No. C19272



127' STATIONING ON CENTERLINE
 TWELFTH STREET