

C.N.P. 15461 - From 11th St. to 12th St. & Chouteau Ave.  
 C.N.P. 15462 - From 11th St. to 12th St. & Chouteau Ave.  
 C.N.P. 15463 - From 11th St. to 12th St. & Chouteau Ave.

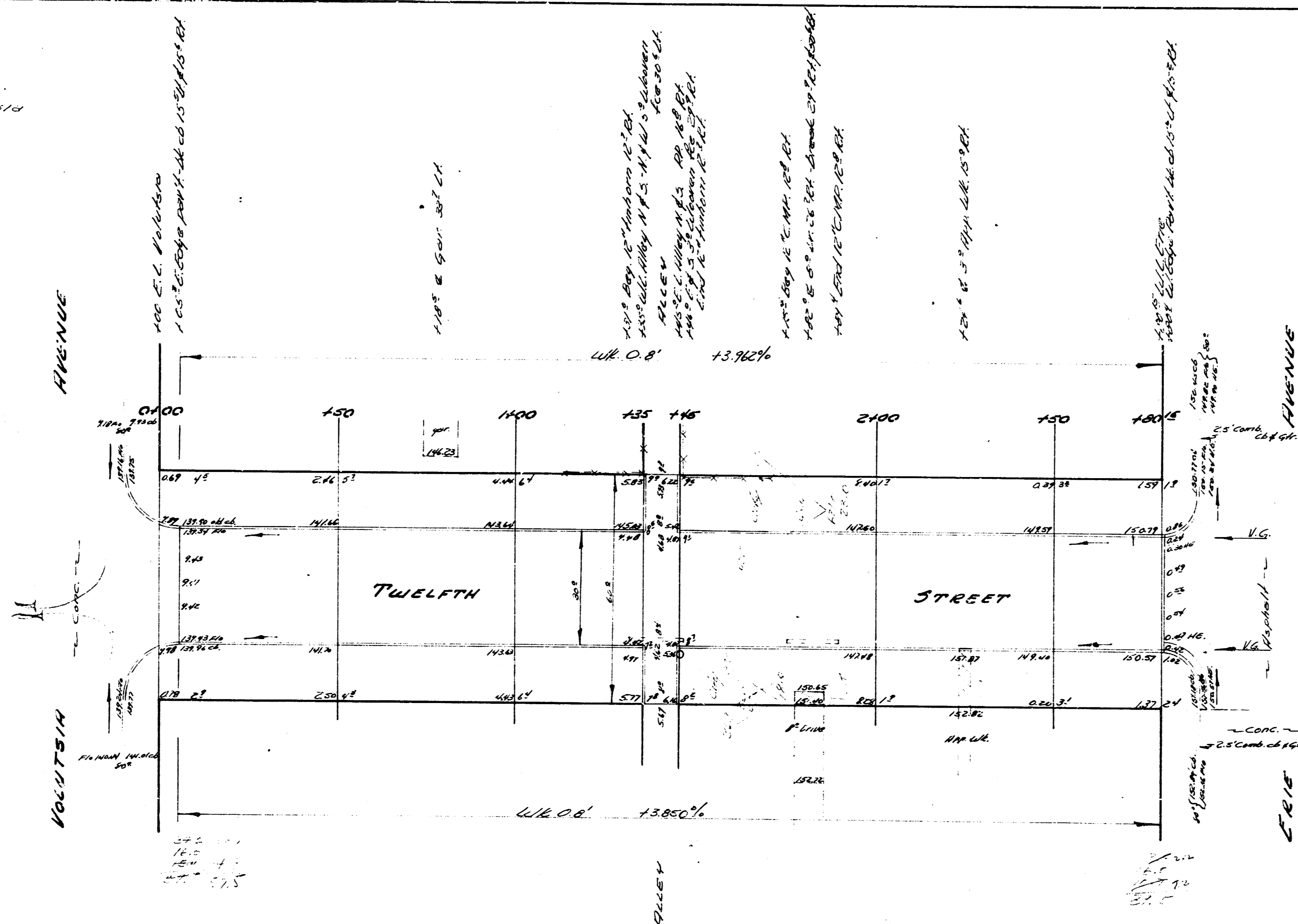

Survey of Ground BE 1-1-27  
 in City of  
 Cherokee

NOTE - Stationing on E  
 X-Sec's run from 21.80 to 0100

Total Excav.

City	214
207	16+0.3
83	12+0.2
4+0.1	77.7 20.3

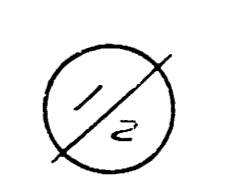

12th STREET  
 E.L. VOLUTSKY TO W.L. CRIE  
 30' CONC. & CB.  
 City of Wichita, Kansas  
 B.E. Smith City Engineer  
 July 1953 Proj. No. C-15116