

B.M. 130.45 S.E. cor. conc. porch ho. #1653 Sabiu.
 B.M. 133.47 Top NW cor. rock handrail on porch 2nd house So. 17th on E. side Sabiu.
 B.M. 130.80 N.E. cor. 1st step ho. #1461 Lyndhurst.
 B.M. 130.59 Standard S.E. cor. 17th & West.
 B.M. 131.62 N.W. cor. 1st step ho. #4007 W. 16th St.

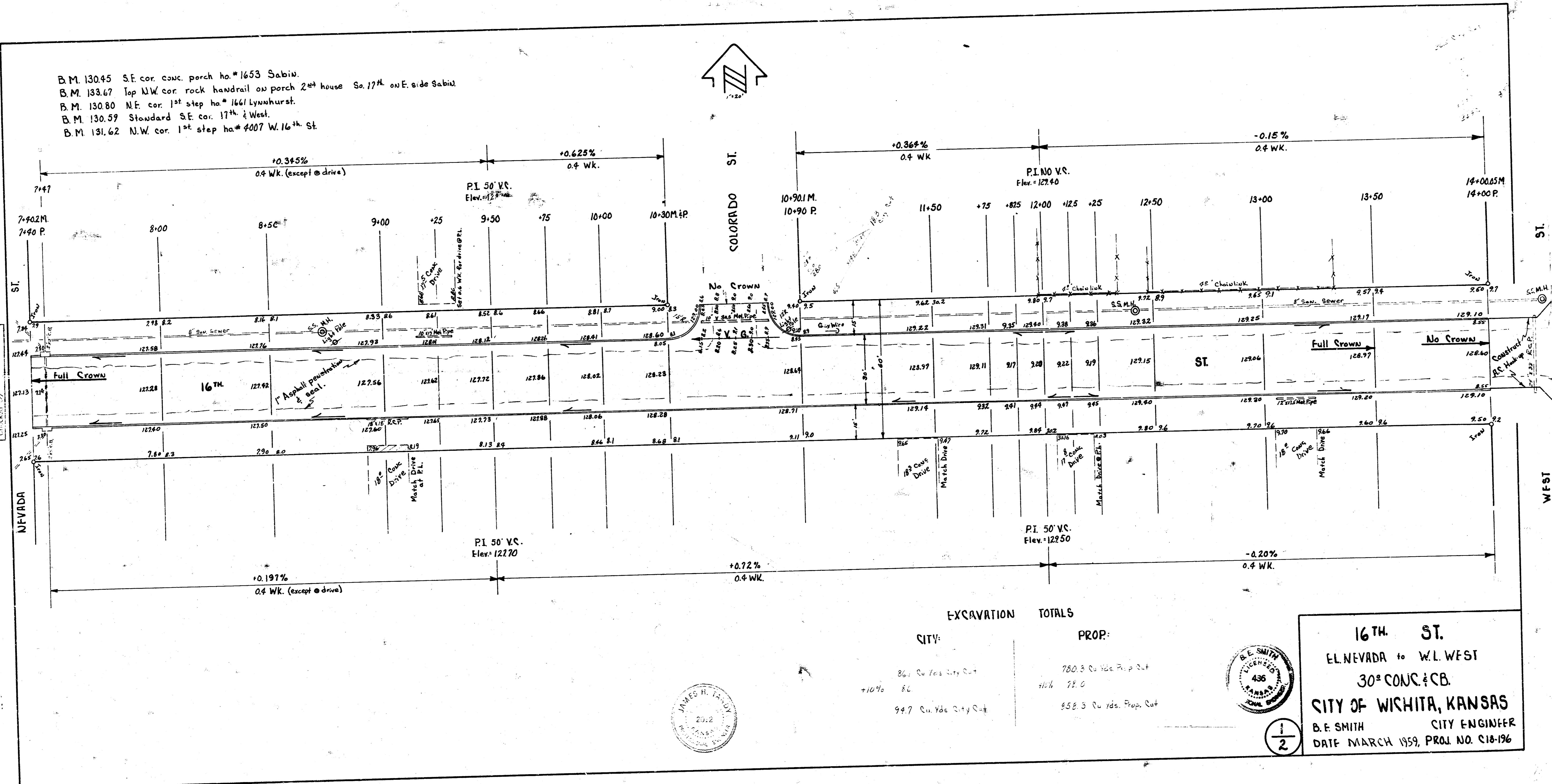

EXCAVATION	TOTALS
CITY:	PROP:
26.0 Cu Yds City Cut	780.5 Cu Yds Prop. Cut
+10% 8.0	16.0 72.0
94.7 Cu Yds City Cut	558.5 Cu Yds Prop. Cut

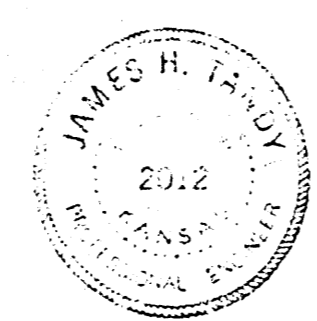

16TH ST.
 EL NEVADA to W.L. WEST
 30" CONC. & CB.
CITY OF WICHITA, KANSAS
 D.E. SMITH
 CITY ENGINEER
 DATE MARCH 1959, PROJ. NO. C18-196

1/2