

B.M. 117.97 R.R. SPIKE IN N. FACE H.L.P.
S.W. COR. MATHEWSON & 16TH.
B.M. 118.82 S.E. COR. CONC. PD. HOUSE
1703 N. PENNSYLVANIA

NOTE:
Entrance Pipes to be disposed of
accordance to City Dirt Checker.

EXCAVATION		FILL	
PROP	454.8	CITY	14.1
PLUS 10%	45.5	PLUS 10%	1.9
TOTAL	500.3	TOTAL	21.0

EXCAVATION		FILL	
PROP	454.8	CITY	14.1
PLUS 10%	45.5	PLUS 10%	1.9
TOTAL	500.3	TOTAL	21.0

EXCAVATION		FILL	
PROP	454.8	CITY	14.1
PLUS 10%	45.5	PLUS 10%	1.9
TOTAL	500.3	TOTAL	21.0

FIELD ENGR. TO RESET IRON
TIES TO IRON & 16TH 113.84 C. E.L. MATHEWSON
87.69 S.E. to c/c rail of 3' rails S.W. P. H.P.
50.16 N.W. to S.W. cor. foundation House #1508 16th.
63.88 S.W. to S.E. cor. drive House on S.E. Cor. 16th & Mathewson

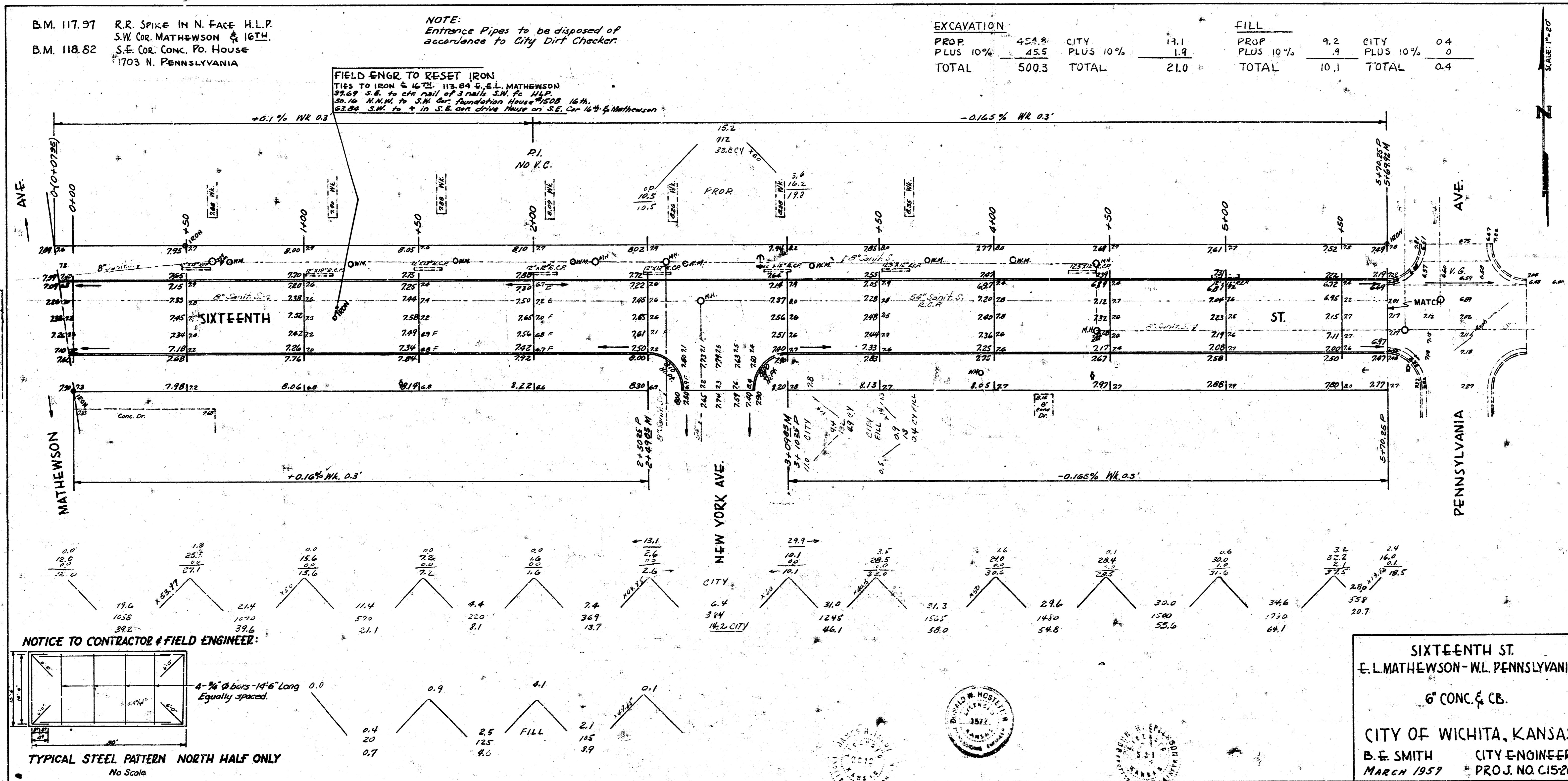

Survey: KRANS, BRJAKOV
Plan: HOFSTETTER
Checked: 1/7

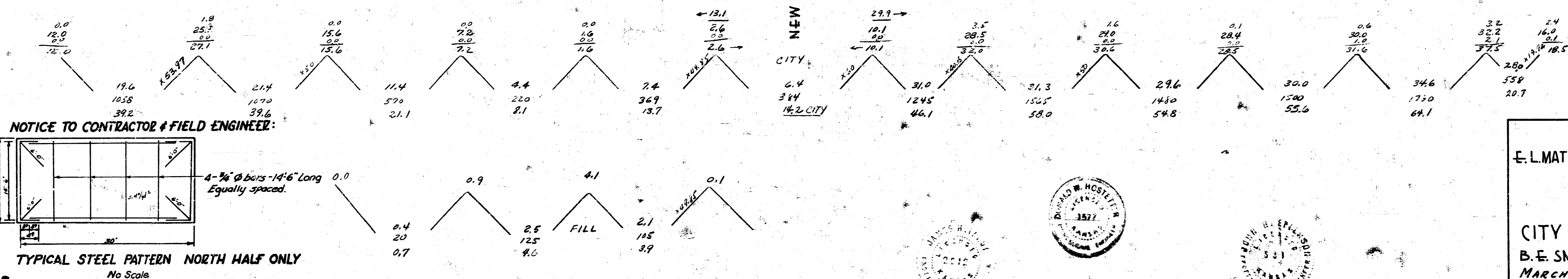

NOTICE TO CONTRACTOR & FIELD ENGINEER:

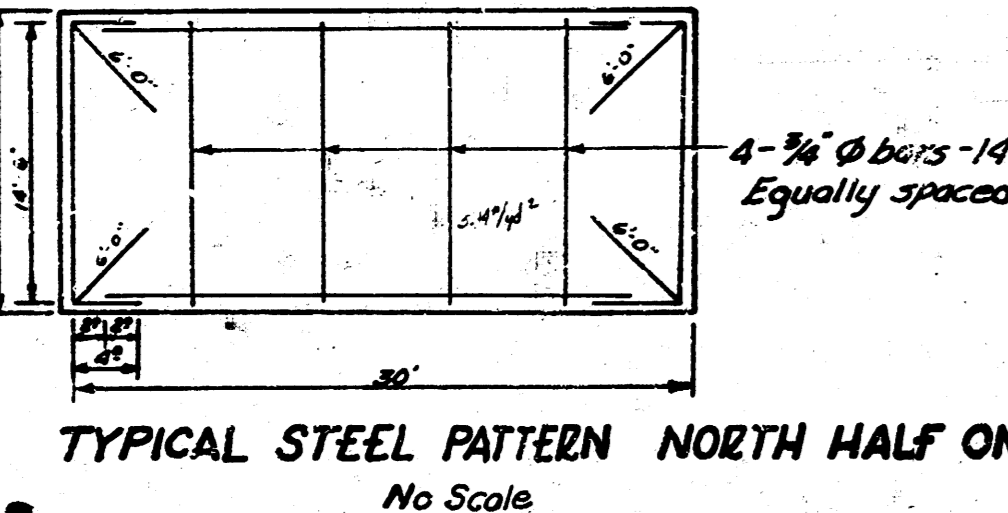

SIXTEENTH ST.
E. L. MATHEWSON - W. PENNSYLVANIA
6" CONC. & CB.
CITY OF WICHITA, KANSAS.
B. E. SMITH CITY ENGINEER
MARCH 1957 PROJ. NO. C15268

