

B.M. 125.35 2" IN RITCHIE E. CO. POPLAR N.L. 16TH ST.

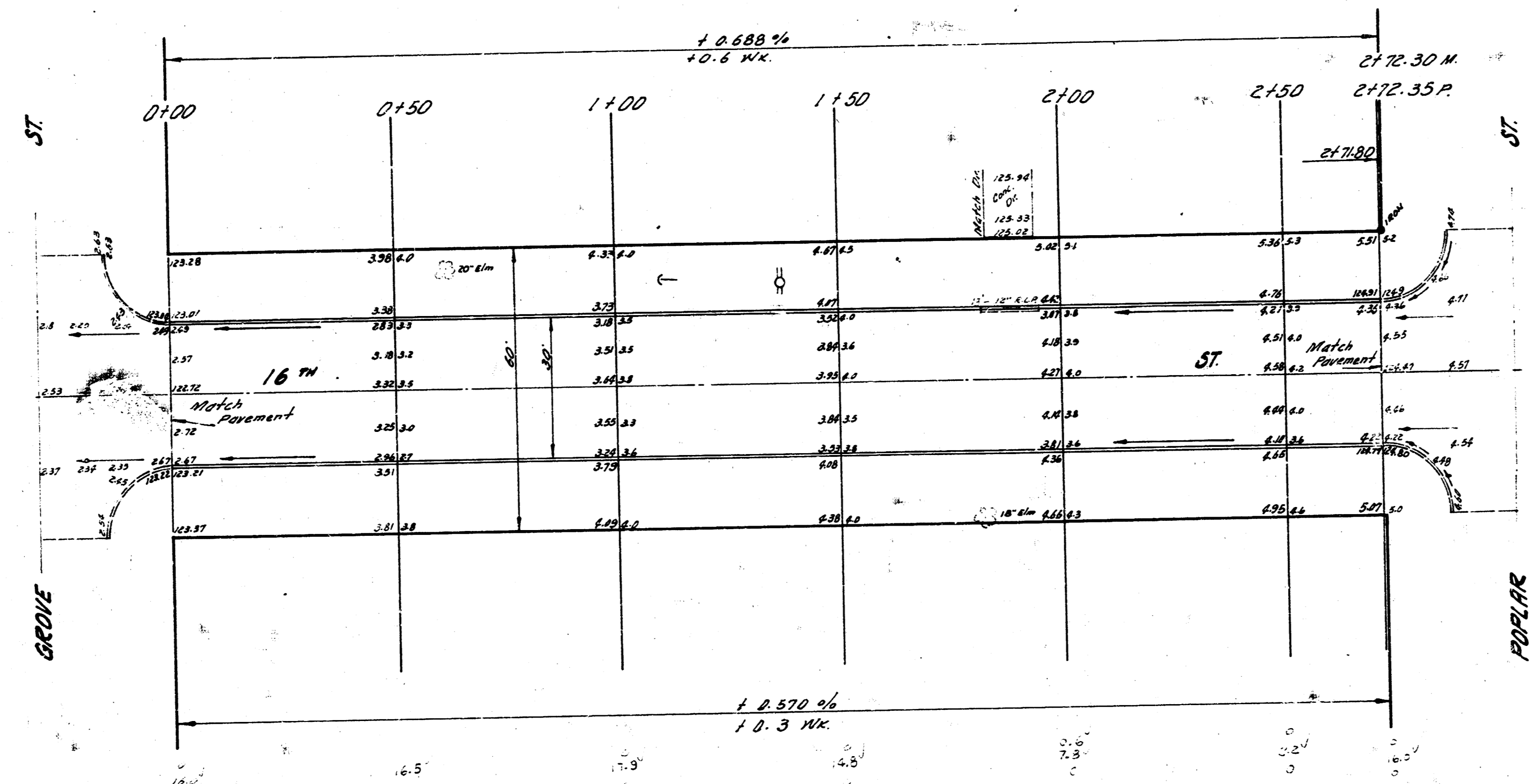

Survey conducted by
 W. E. Smith
 City Engineer
 October 1938

16.3
 33.2 ft
 16.5
 31.9 ft
 16.9
 32.2 ft
 17.3
 31.5 ft
 17.6
 31.2 ft
 18.0
 30.8 ft
 18.3
 30.5 ft

Section 11
 1841 G.P. 100P
 1841 G.P. 100P
 1841 G.P. 100P

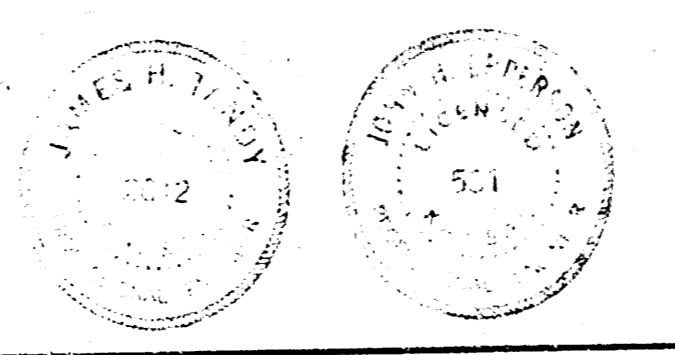

16TH ST.
 EL. GROVE TO W.L. POPLAR
 30' CONC. & C.B.
 CITY OF WICHITA, KANSAS
 W. E. SMITH CITY ENGINEER
 OCT. 1938 FROM NO. C18-132