

BM 147.85 6" IN GLOBE E END RADIUS SE CORNER ERIE & 16TH
 BM 153.40 "T" IN TROY TOP FIRE HYD. SW. COR. 16TH & CHAUTAUQUA
 BASELINE & STATIONING ON N.L. OF 16TH

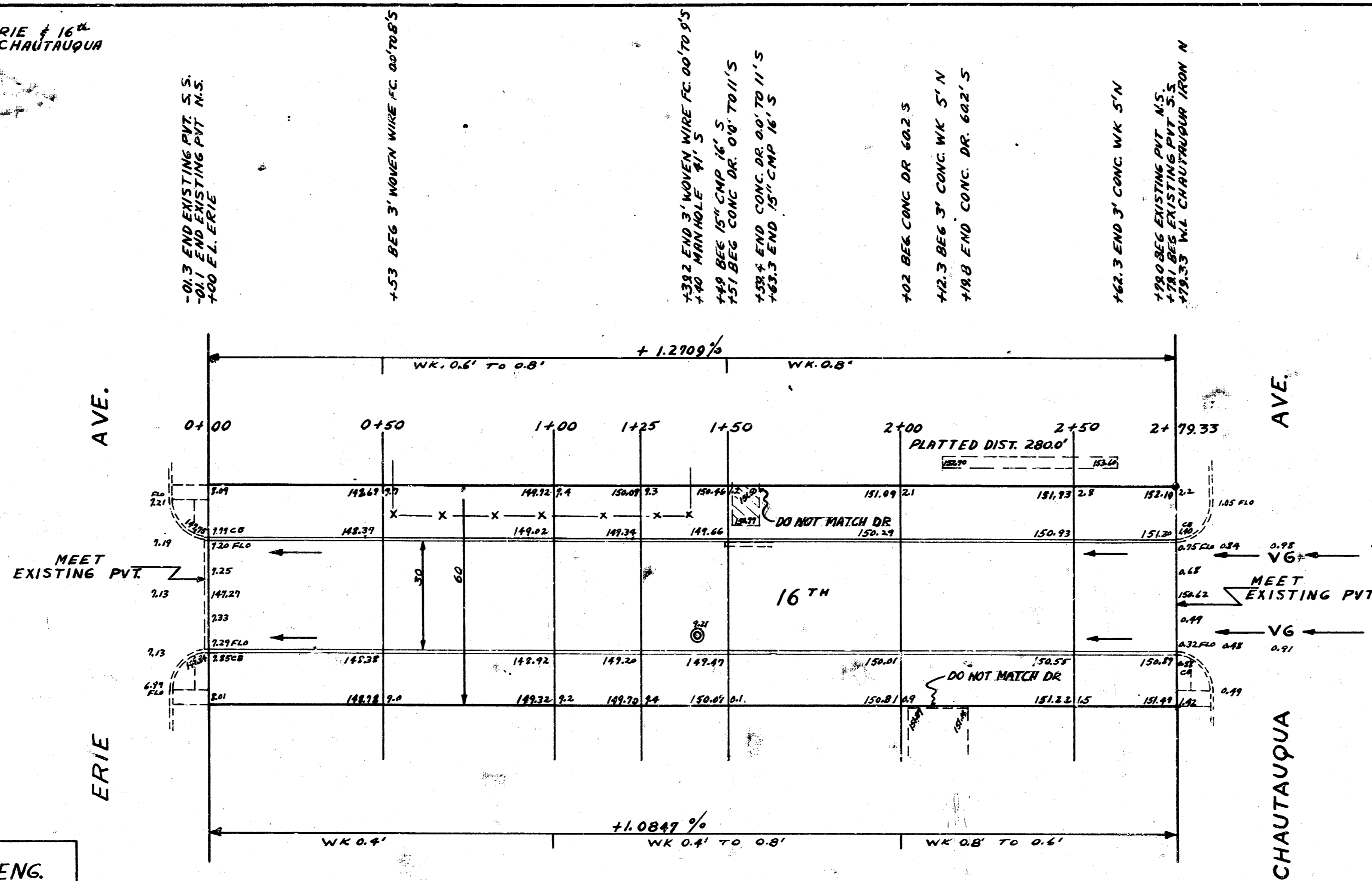

NOTE: TO CONTRACTOR & FIELD ENG.
 ENTRANCE PIPE WILL BE DISPOSED OF IN
 ACCORDANCE WITH INSTRUCTION OF DIRT
 CHECKER.

Surveyed by B.E. Smith
 Plan Checked by E.E.
 Checked by E.E.

16TH
 EL. ERIE TO WL. CHAUTAUQUA
 30" CONC & CB
 CITY OF WICHITA
 B.E. SMITH CITY ENGINEER
 MARCH 1954 PROJ. NO. C13-255



1/2