

B.M. = 125.57 R.R. SPIKE N. SIDE P. POLE ON S.W. COR. 21ST & WOODROW
 B.M. = 127.42 N. COR. OF UPPER PART CONC. M.H. OVER WATER MAIN S. SIDE 21ST, BETWEEN AMIDON & WOODROW.

NOTE: Sidewalk shown on plan is to be constructed by private contract.

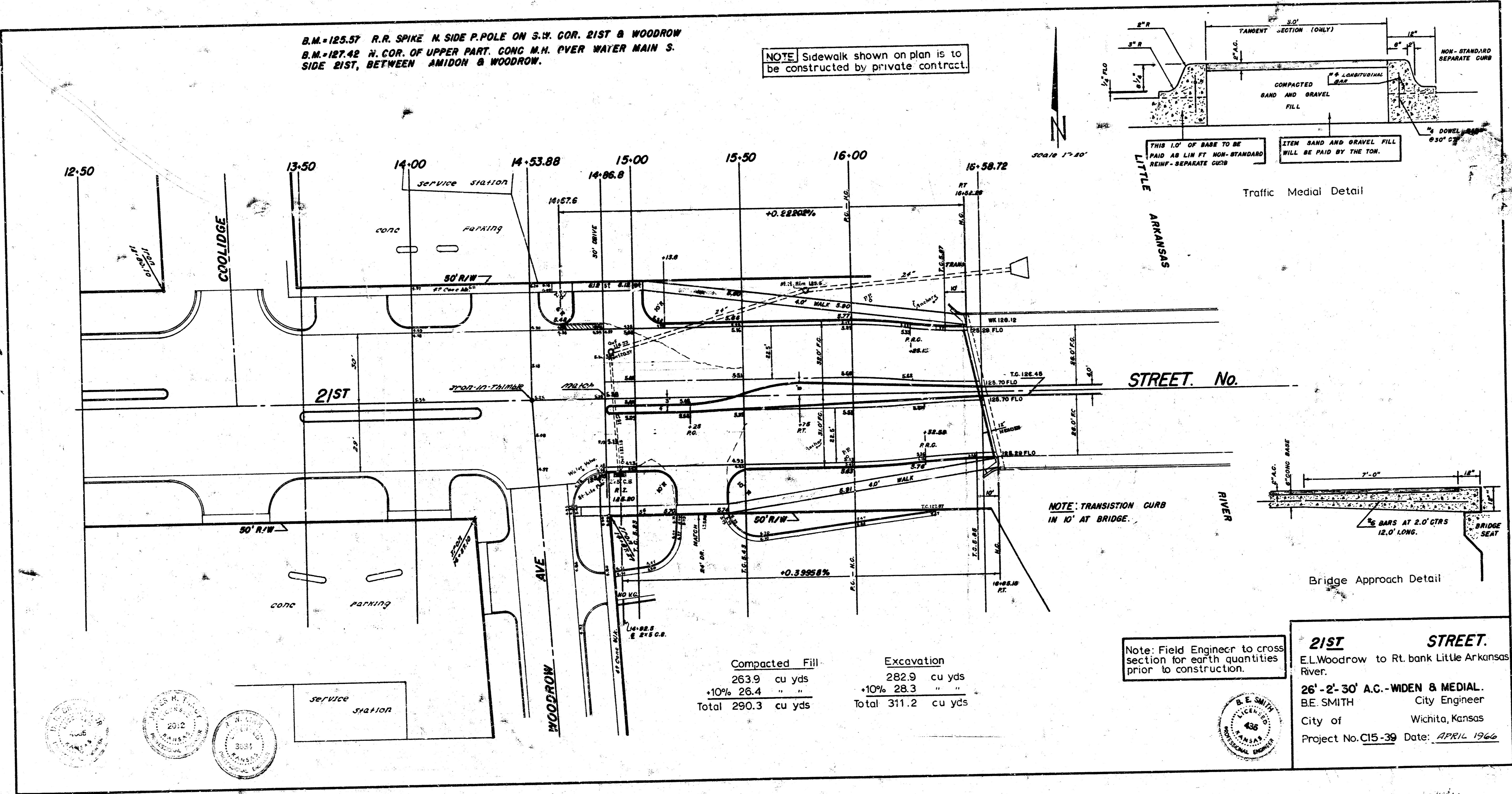
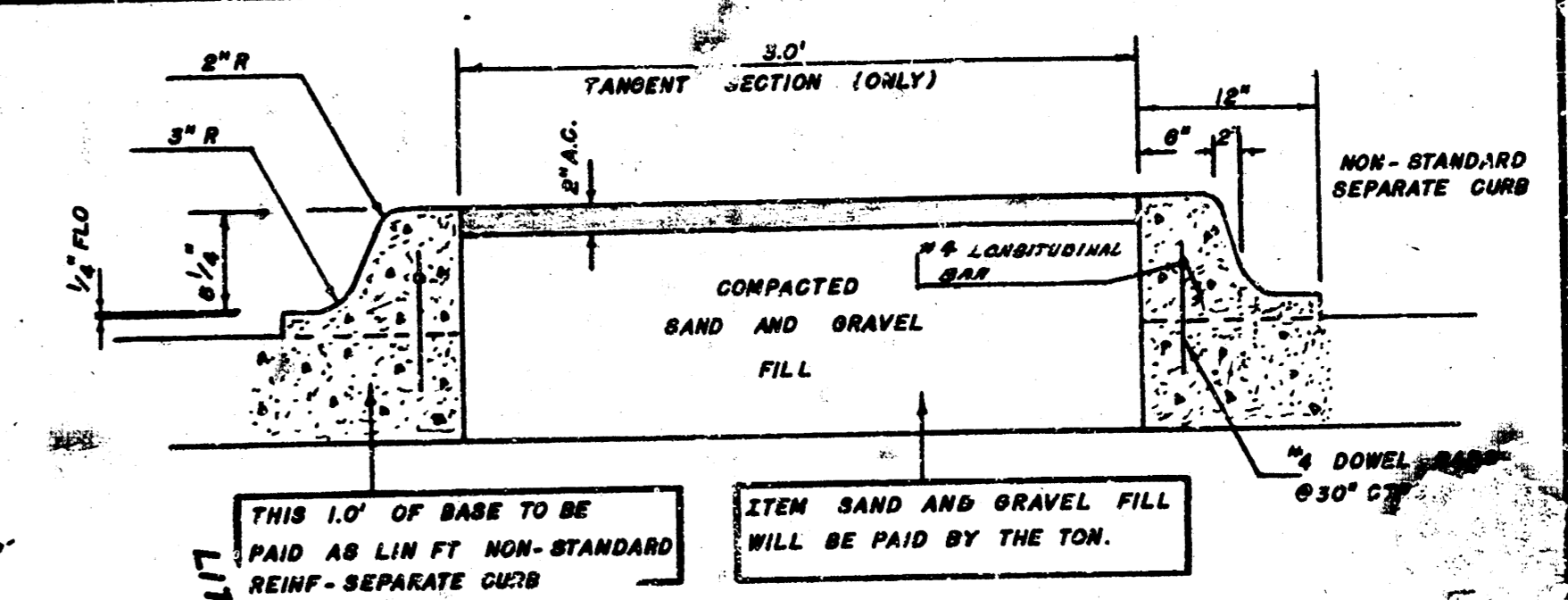

Compacted Fill		Excavation	
	263.9 cu yds		282.9 cu yds
+10%	26.4 " "	+10%	28.3 " "
Total	290.3 cu yds	Total	311.2 cu yds

Note: Field Engineer to cross section for earth quantities prior to construction.

21ST STREET.
 E.L. Woodrow to Rt. bank Little Arkansas River.
26'-2"-30' A.C. - WIDEN & MEDIAL.
 B.E. SMITH City Engineer
 City of Wichita, Kansas
 Project No. C15-39 Date: APRIL 1966

CHECKED BY: B. E. SMITH
 DRAWN BY: B. E. SMITH
 PROJECT NO. C15-39

