

2. M. 1762 5' in Eads. P.H. W.L. S. S. W. Millville E 15th
 2. M. 1376 5' in Eads. S. S. W. Lawrence E 15th
 2. M. 1374 5' in Eads. S. S. W. Lawrence E 15th
 2. M. 1374 5' in Eads. S. S. W. Lawrence E 15th
 2. M. 1374 5' in Eads. S. S. W. Lawrence E 15th



NOTE -
Remove C&G where
necessary & rebuild to grade

NOTE -
Remove C&G where
necessary & rebuild to grade

NOTE - Stationing S. R.

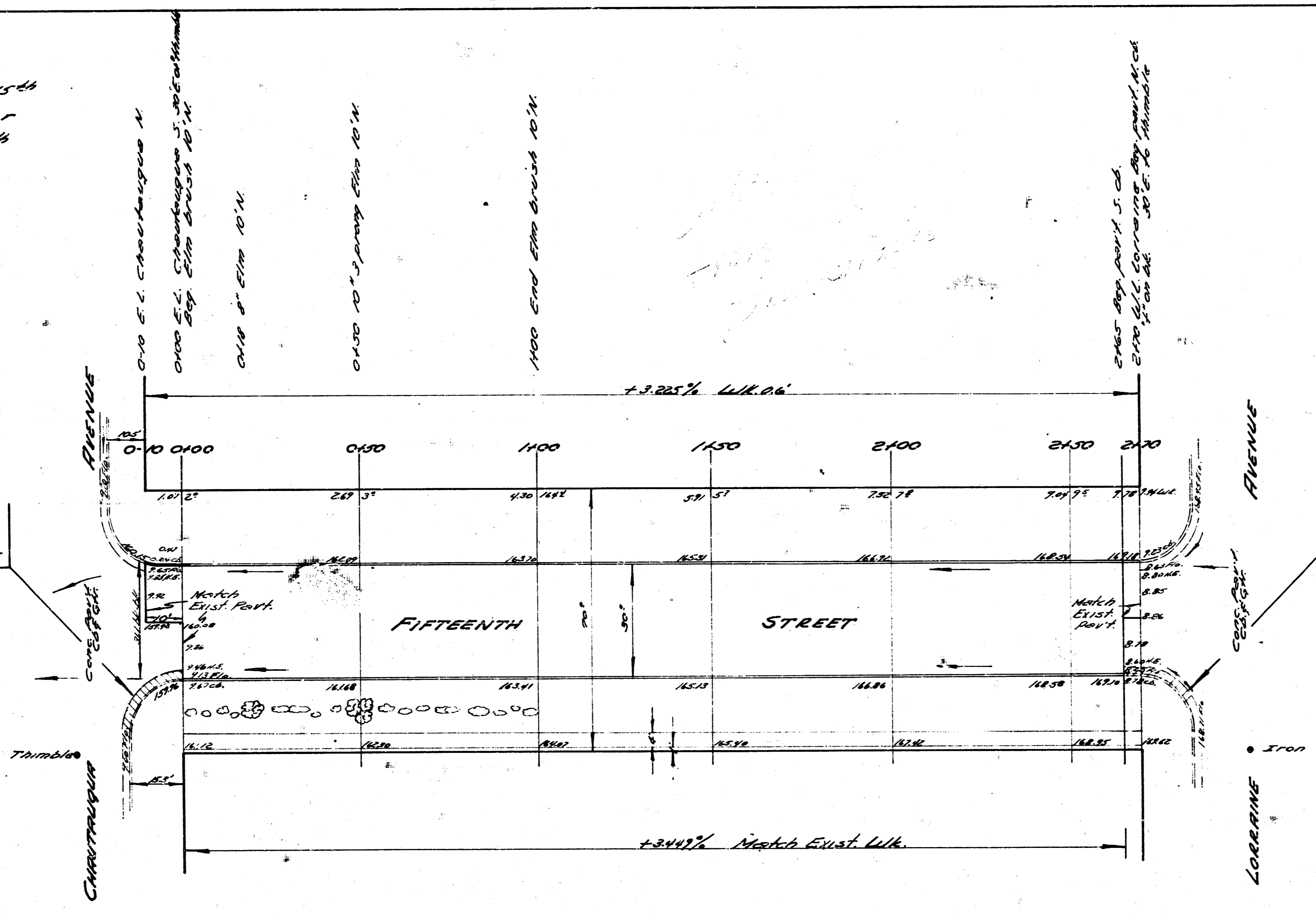

S.W. CAMP
 B. E. SMITH
 City Engineer
 Checked 5/7

Total Earthwork

CITY	PROJ.	
	Cut	Fill
None	71.6	113.8
+10%	92	113.8
	100.8 cu yds.	113.8 cu yds.



FIFTEENTH STREET
 E. L. Charlemagne to W. L. Lorraine
 30' Conc. f' Cb.
 City of Wichita, Kansas
 B. E. Smith City Engineer
 Aug. 1953 Proj. No. C.17-180