

# 11TH STREET

FROM THE W.L. DENNEY LANE TO THE E.L. BLOCK I, WESTLINK LAKES ESTATE ADDITION

PROJECT NUMBER: 472-78-245-80785-000-000

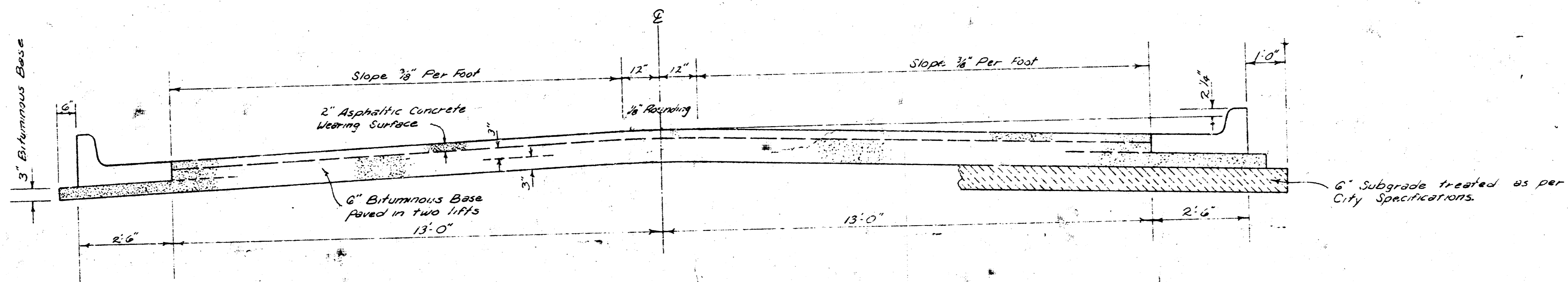

## TYPICAL SECTION

3' ASPHALTIC CONCRETE PAVEMENT WITH BITUMINOUS BASE

A TACK COAT OF EMULSIFIED ASPHALT (SS-1H) SHALL BE APPLIED AT AN APPROXIMATE RATE OF 0.05 GALLONS PER SQ. YD. BETWEEN LIFTS OF ASPHALTIC MATERIALS WHEN ORDERED BY THE ENGINEER. TACK COAT WILL NOT BE PAID FOR DIRECTLY AND SHALL BE CONSIDERED AS SUBSIDIARY TO PRICE BID FOR ASPHALTIC PAVEMENT. BITUMINOUS BASE AND ASPHALTIC CONCRETE WEARING SURFACE SHALL BE PLACED WITH A LAYDOWN MACHINE HAVING AUTOMATIC ELECTRONIC CONTROLS FOR CROWN AND GRADE. CONSTRUCTION JOINTS IN EACH LIFT SHALL BE STAGGERED A MINIMUM DISTANCE OF 1' WITH JOINTS IN PRECEDING LIFTS AND SUCH THAT A JOINT WILL BE CONSTRUCTED ON THE PAVEMENT CENTERLINE IN THE TOP LIFT.

*The A.C. pavement between the Comb. Curb & Gutter shall be paid as Sq. Yds. 5" A.C. Pavement (6 Bituminous Base). The Bituminous Base under the Comb. Curb & gutter shall be paid as Sq. Yds. 3" Bituminous Base.*

COMBINED CURB & GUTTER

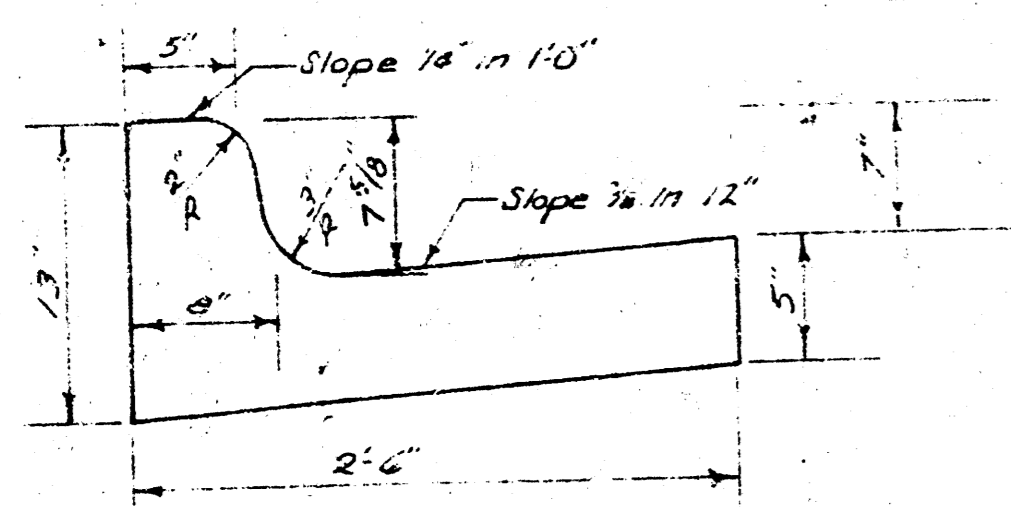

ROLL TYPE CURB & GUTTER

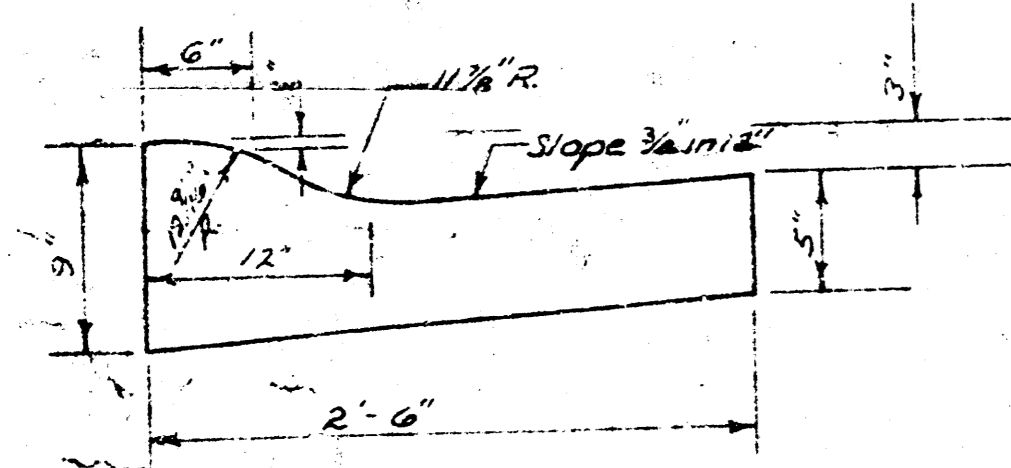

## DETAIL OF TRANSVERSE CONSTRUCTION JOINTS

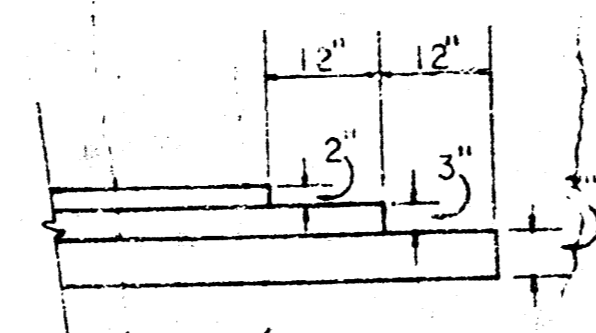

TRANSVERSE CONSTRUCTION JOINTS SHALL BE CONSTRUCTED IN FLEXIBLE BASE PAVEMENTS AT LOCATIONS WHERE PAVEMENT TEMPORARILY ENDS TO FACILITATE FUTURE PAVEMENT CONSTRUCTION AS SHOWN BY DETAIL. THE COST OF CONSTRUCTING THE TRANSVERSE CONSTRUCTION JOINTS SHALL NOT BE MEASURED OR PAID FOR DIRECTLY BUT SHALL BE INCLUDED IN THE BID PRICE FOR SQUARE YARDS OF ASPHALTIC CONCRETE PAVEMENT.

CITY OF WICHITA, KANSAS

DEPARTMENT OF PUBLIC WORKS — ENGINEERING

R. W. LINN CITY ENGINEER

DATE \_\_\_\_\_ PROJ. NO. \_\_\_\_\_

B.M. EL. 151.86 RR SPIKE NE-FACE PP S-SIDE 11TH ST. 1/2 BLK. W. OF CRESTLINE  
 BASELINE IS CENTERLINE 11TH STREET

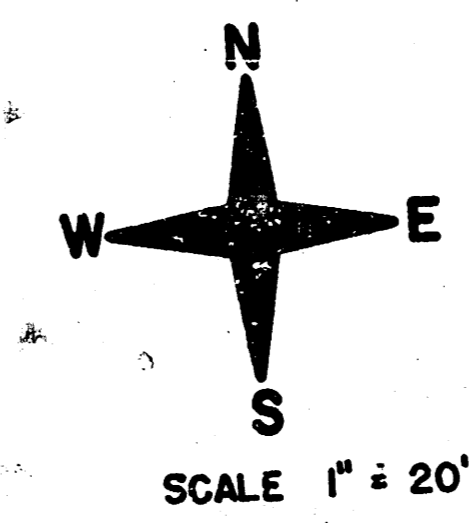

**SUB-GRADE**  
 TYPE OF SUB-GRADE TREATMENT SHALL BE DETERMINED BY THE FIELD ENGINEER. SUB-GRADE TREATMENT MAY CONSIST OF LIME TREATMENT, CEMENT TREATMENT, SUB-GRADE MODIFICATION, OR ANY COMBINATION OF THESE.

**CAUTION**  
**UNDERGROUND UTILITIES**  
 Please do not dig or disturb any utilities without the permission of the City Engineer.

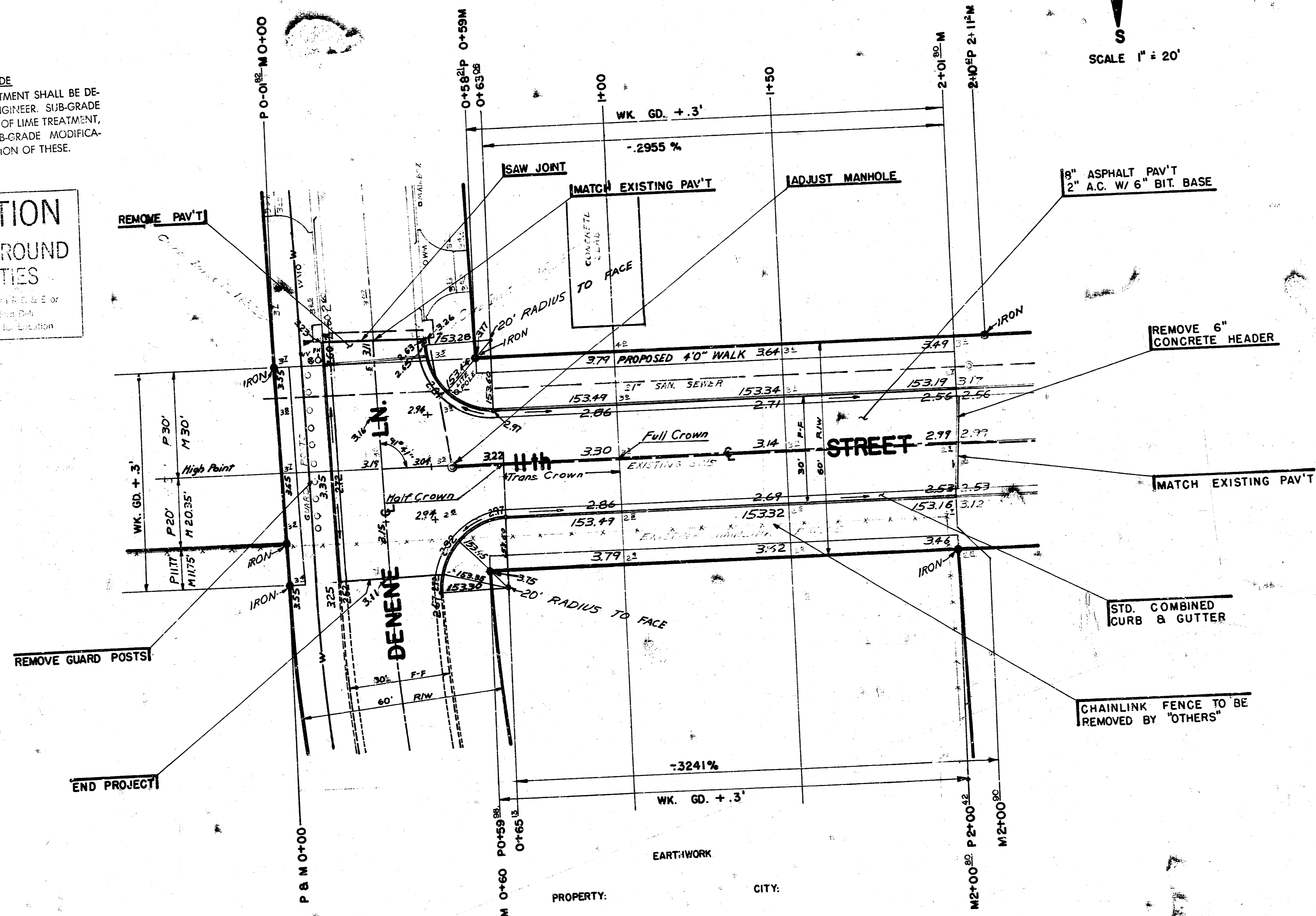

**GENERAL NOTES:**

1. FIELD ENGINEER SHALL TAKE TIES TO ALL IRONS AND THIMBLES WHICH MAY BE DESTROYED AND REPLACE ALL IRONS AND THIMBLES THAT ARE DESTROYED.
2. CONTRACTOR SHALL COORDINATE WORK WITH UTILITY COMPANIES AND OTHER AGENCIES RELATED TO THE PROJECT SITE DEVELOPMENT.
3. CONTRACTOR SHALL, IF NECESSARY, CONTACT CHUCK BRODIE (TELEPHONE NO. 262-0031) REGARDING REMOVAL OF CHAINLINK FENCE.

PROPERTY:	CITY:
134.2 C.Y.	83.3 C.Y.
+10% 13.4 C.Y.	+10% 8.3 C.Y.
141.6 C.Y. EXCAVATION	91.6 C.Y. EXCAVATION
522 S.Y. MANIPULATION	301 S.Y. MANIPULATION

Survey C. Wise 1/654  
 Plan RAH  
 Exc  
 Checked

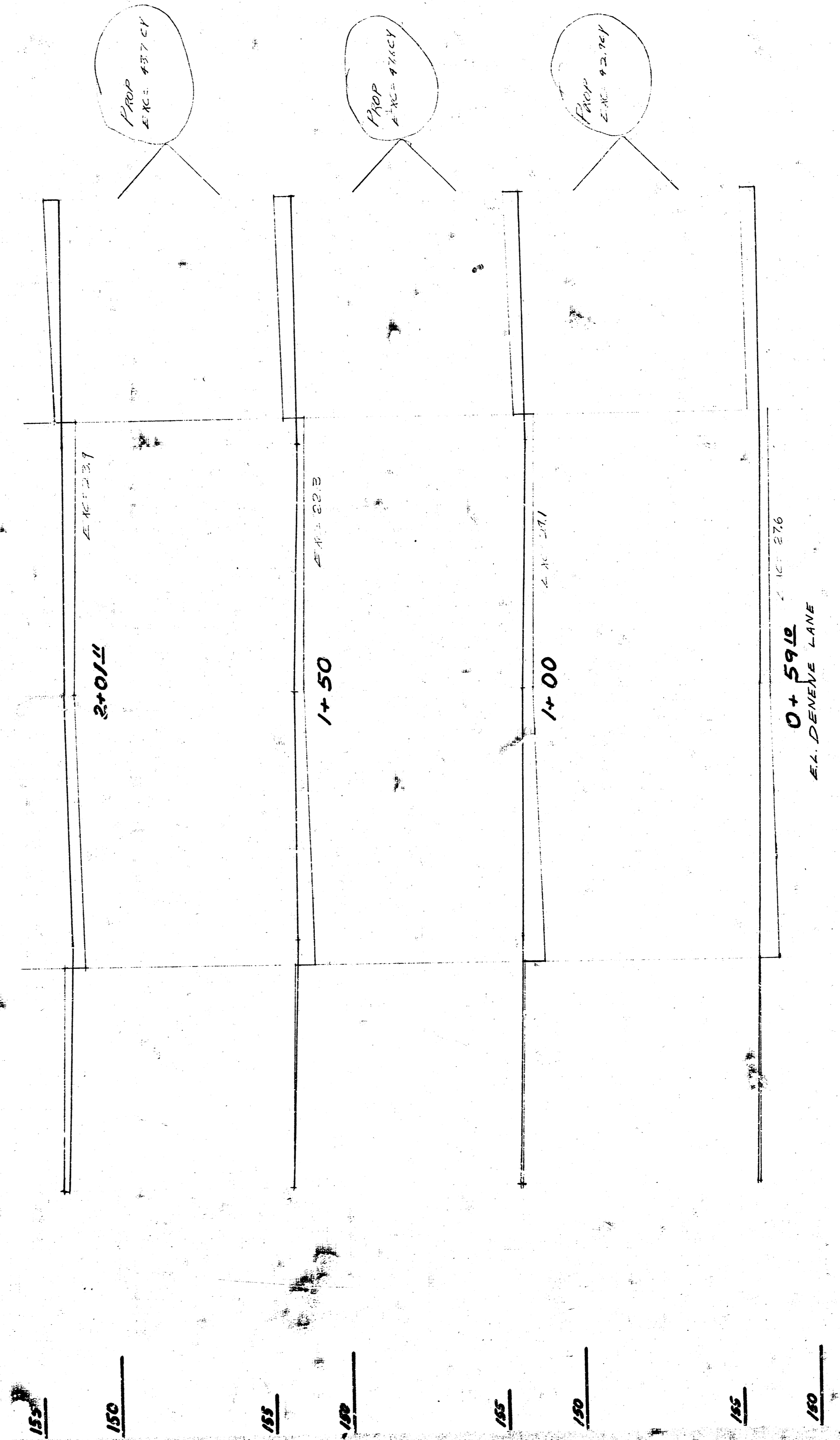

PROP  
ZONING 437 CY

PROP  
ZONING 437 CY

PROP  
ZONING 437 CY

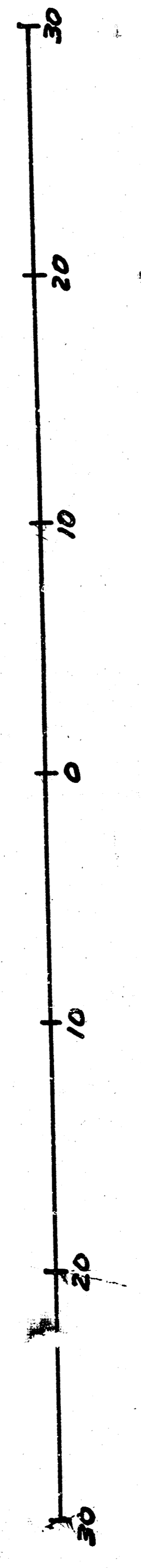

BASELINE IS @  
1120 STREET

11TH STREET PROJECT - LANDMARK TOTALS  
 2.4K APPROX. 134.2 CY  
 (FOR CITY ENG TOTALS SEE  
 PREVIOUS SHEET)

ALL DISTANCES  
 MEASURED FROM  
 TO THE 1120 STREET  
 CENTERLINE

