

B.M. 189.62 R to Ritchie S.L. 10TH @ W. ab. Whitfield.
 B.M. 184.00 R to Ritchie N.L. 11TH @ W. ab. Stratford
 B.M. 193.96 N.W. cor. park (A) and park) Ho # 1360 Stratford
 B.M. 181.1116 R to Ritchie S.L. 10TH @ W. ab. Armour

Baseline & Stationing On North Property Line.

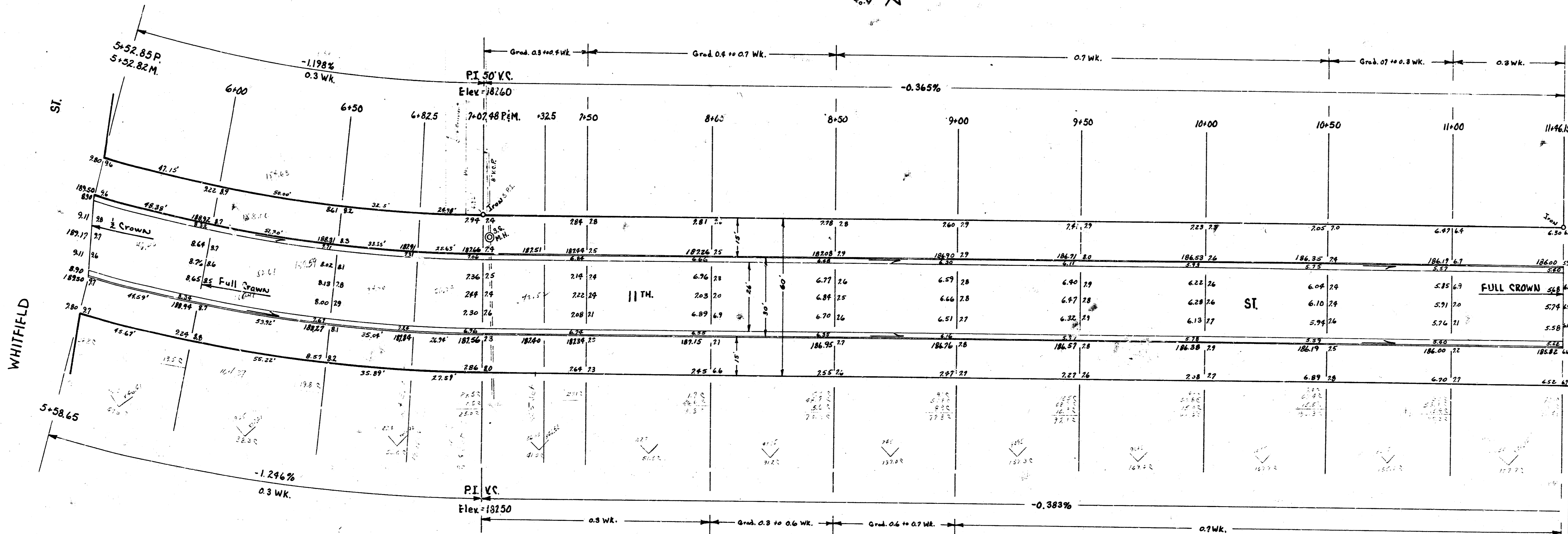

EARTHWORK TOTALS

CITY:	PROP.:
9.0 Cu Yds. Exc.	73.9 Cu Yds. Cut
112.6 Cu Yds. Fill	31.2 Cu Yds. Cut to Remainder Level Fill
94.3 Cu Yds. Fill	122.2 Cu Yds. Cut
	96.1 Cu Yds. Fill
	1438.2 Cu Yds. Cut
	96.1 Cu Yds. Extra Cut to Remainder Level Fill
	50.7 Cu Yds. Fill
	1852.7 Cu Yds. Cut

CURVE DATA BASED ON N.A. P.L.

R = 572.57 (NA P.L.)
 Δ = 35° 13'
 Δ/2 = 17° 36' 30"
 L = 353.16 (NA P.L.)

STATION	DEFL. Δ	TOTAL DEFL. Δ	CHORD OFF. INCS.	CHORD OFF. FEET	ARC ON N.A. P.L.
3+58.32 P.C.					
4+00	2° 16' 39"	2° 16' 39"	94.22	49.88	49.48
4+50	2° 29' 35"	4° 46' 14"	50.59	34.60	5
4+92.01	2° 09' 41"	6° 51' 58"	42.71	45.88	42.01
5+03.70	0° 34' 58"	7° 26' 58"	11.83	12.77	11.69
5+52.85	2° 27' 02"	9° 53' 55"	49.75	53.67	49.75
5+58.65	0° 11' 21"	10° 05' 16"	5.87	6.33	5.80
END PROJECT C18-125					
BEGIN PROJECT C18-125					
6+00	2° 03' 42"	12° 08' 58"	41.84	45.15	41.35
6+50	2° 29' 35"	14° 38' 33"	58.59	54.60	58.00
6+82.5	1° 09' 13"	15° 47' 46"	32.89	35.99	32.40
7+07.48 P.T.	1° 14' 44"	17° 02' 30"	25.28	27.28	24.98

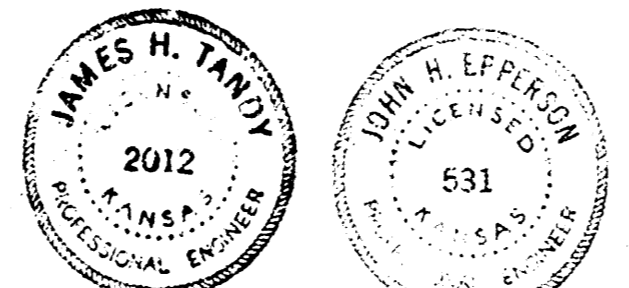

11TH ST.
 EL. WHITFIELD-WL. ARMOUR
 26-2-30 A.C.
CITY OF WICHITA, KANSAS
 BE SMITH CITY ENGINEER
 DATE: MAR. 1959, PROJ. NO. C18-125

1/2

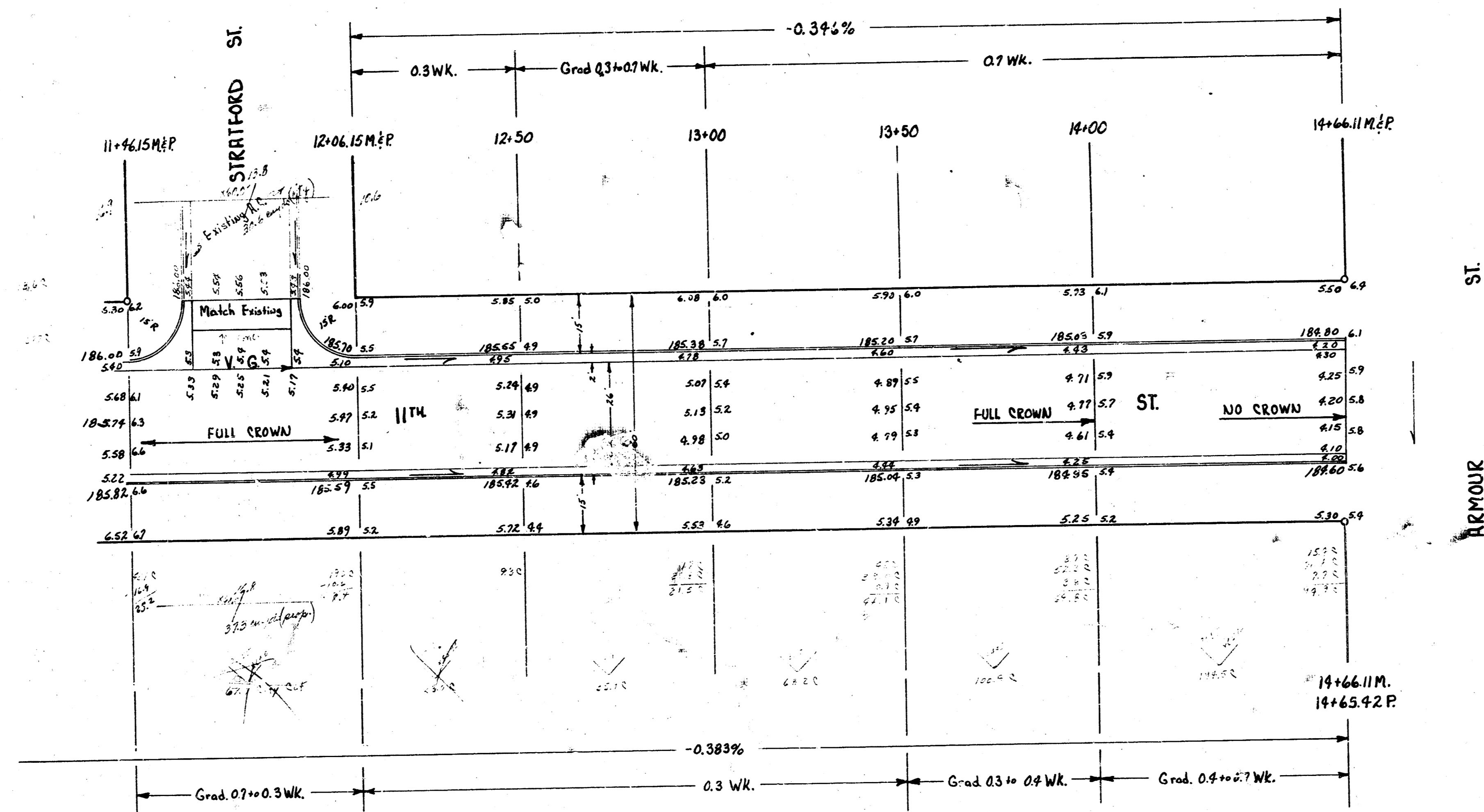

NOTE TO FIELD ENGINEER:
Re-crossections to be taken where
loose fill is removed and
replaced by compaction.
(Sta. 11+46+ to Sta. 13+50)

11TH ST.
E.L. WHITFIELD-W.L. ARMOUR
SIB-125

2/2

10 2 5 913