

1942
 TWELFTH ST. EL. CRESTWAY AV. TO WL. OLIVER ST.
 26-2-30-S.A.B.B.

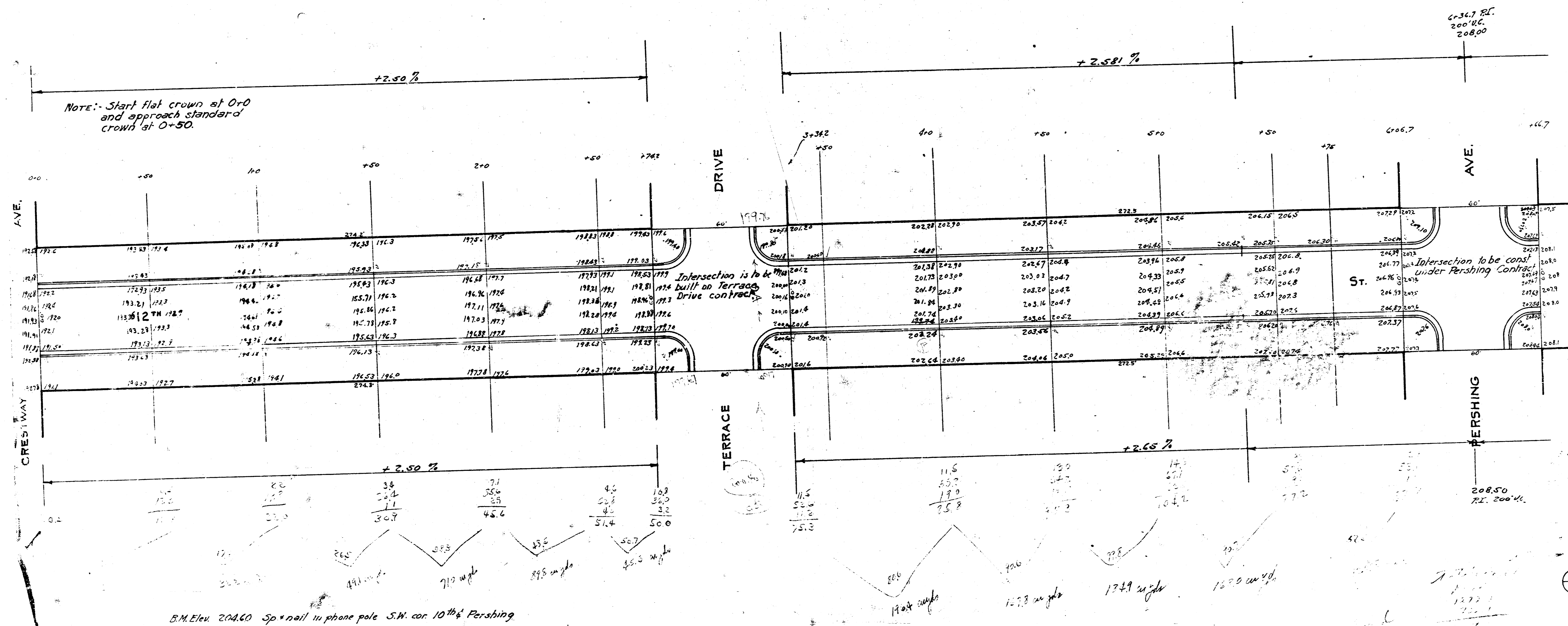

B.M. Elev. 204.40 Sp. nail in phone pole S.W. cor. 10th & Pershing

1/2

PAVING PLAN
1942
12TH ST.
E. CRESTWAY
W. OLIVER

6136.7
PL. 20046

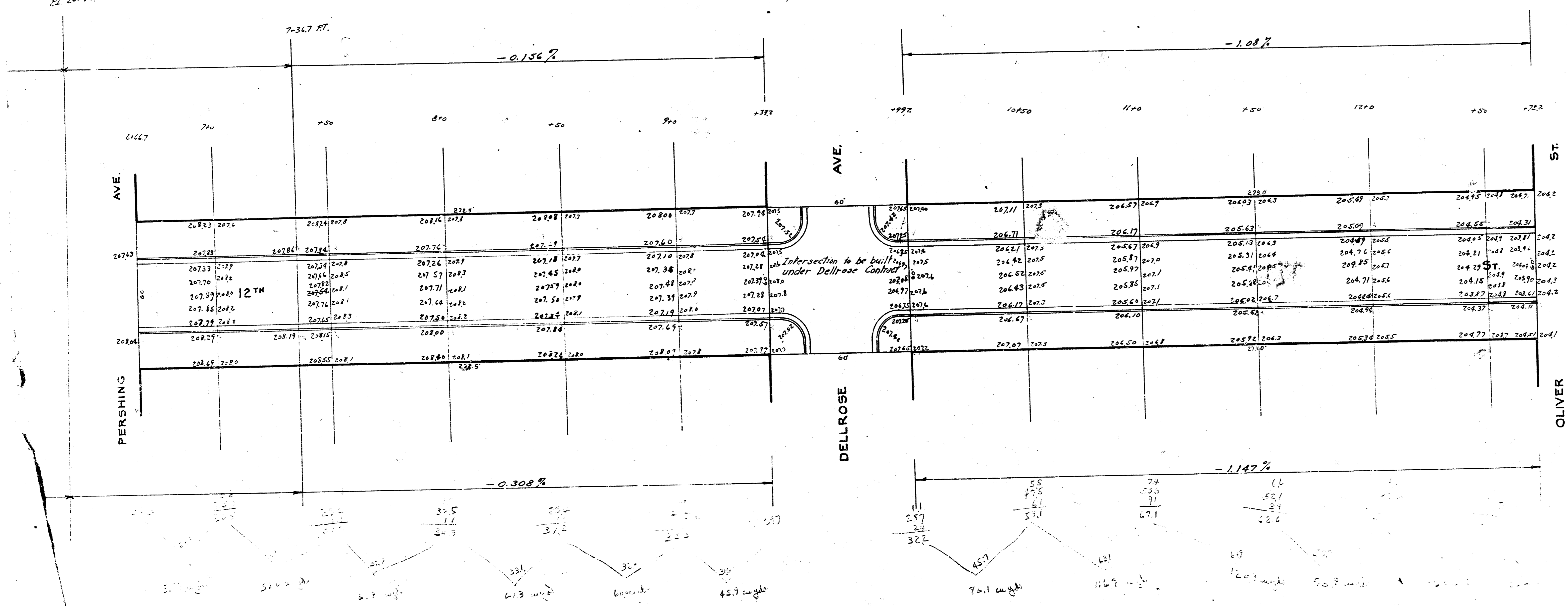

7