

13th STREET

W.L. E1/2, Lot 5, R.A. Morris Tracts To W.L. Zoo Blvd.

GENERAL NOTES

1. CONTRACTOR SHALL COORDINATE WORK WITH STORM SEWER CONTRACTOR AND CONTACT RELEVANT UTILITY COMPANIES AND OTHER AGENCIES INVOLVED WITH THIS PROJECT.
2. TREES AND HEDGE ROW TO BE REMOVED ARE MARKED  ALL TREES WHICH IN THE OPINION OF THE FIELD ENGINEER CAN BE SAVED, SHALL BE SAVED.
3. STRUCTURES OF INLETS "BY OTHERS".
4. COST OF REGRADING OF DITCHES AND GRAVEL ROADS (INCLUDING 13TH AND SMITH, ANNA, BAKER) SHALL BE CONSIDERED INCIDENTAL TO EXCAVATION.
5. COST OF REMOVAL OF STONES AND CONCRETE BLOCKS AROUND PIPES SHALL BE CONSIDERED INCIDENTAL TO L.F. PIPE REMOVAL.
6. CONTRACTOR SHOULD CONSTRUCT DRIVES TO P.L. (FOR CONSTRUCTION OF DRIVES BEHIND THE PROPERTY LINE, CONTRACTOR SHOULD CONTACT PROPERTY OWNERS).
7. PAVEMENT REMOVAL.
8. NO MORE THAN 6-10', 1-18', 13-20', 1-23', 1-24', 1-27' AND 1-30' DRIVEWAY APPROACHES OR THE EQUIVALENT TO BE CONSTRUCTED.
9. REMOVE AND REPLACE ALL MAILBOXES IN THIS PROJECT.

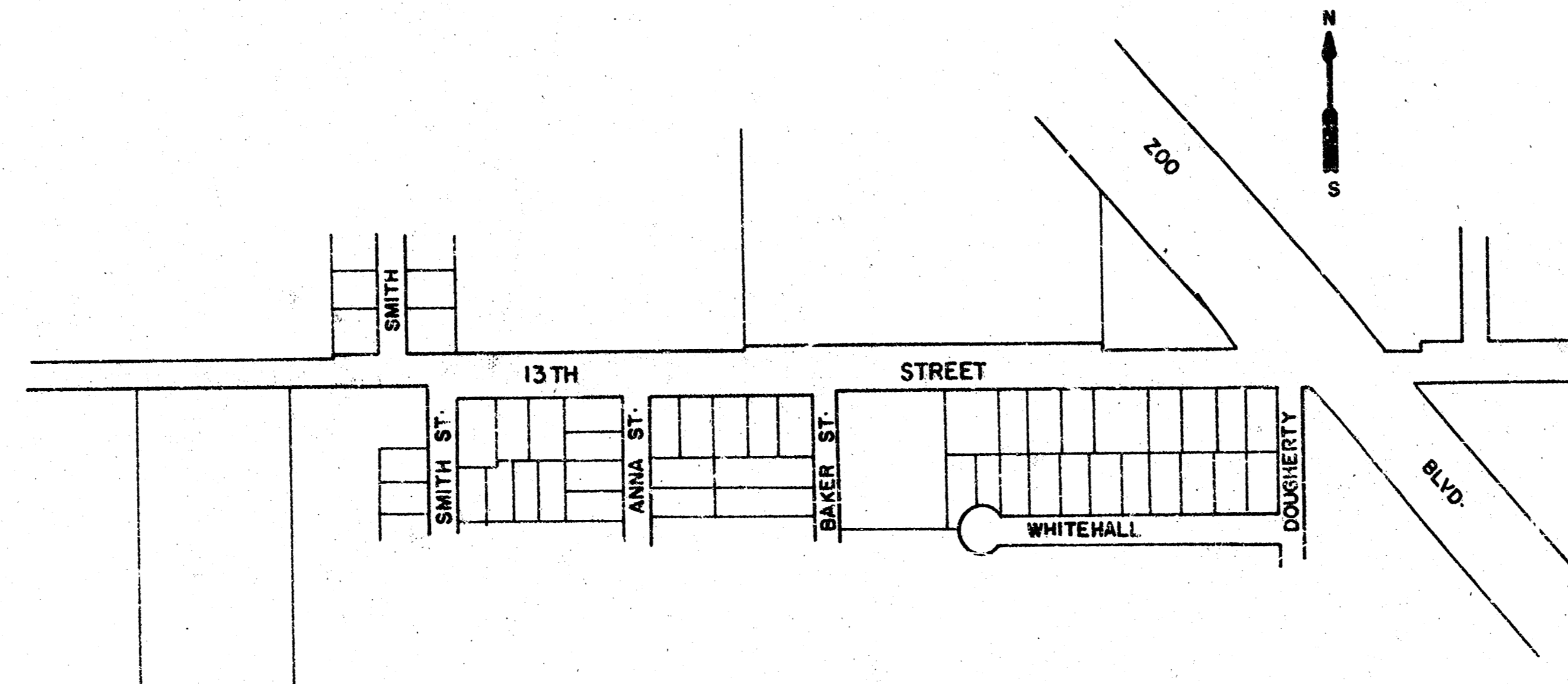

City Of Wichita, KS.

R. W. Bruggeman Director Of Engineering/City Engineer

Proj. No. 472-76-245-80458-000-000-001

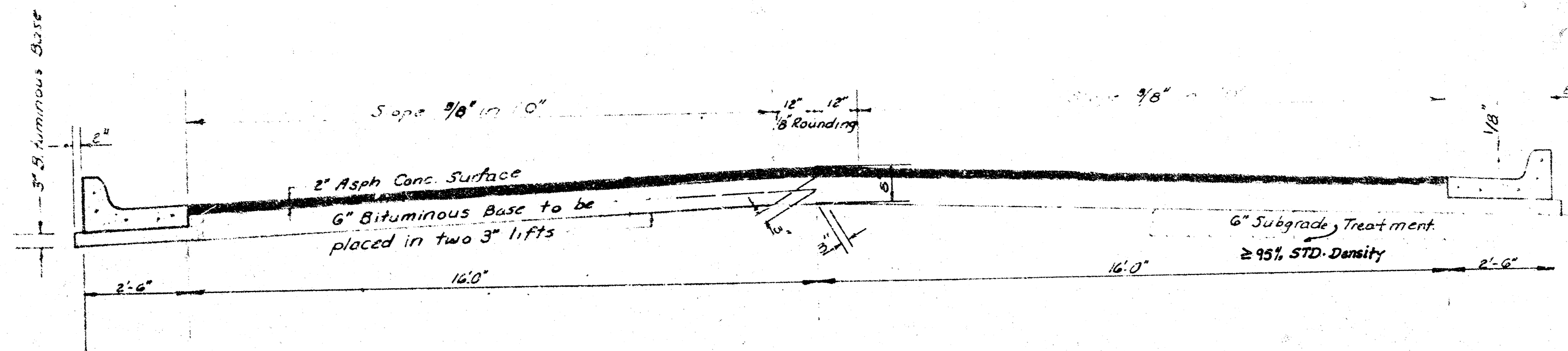

TYPICAL SECTION

37' ASPHALTIC CONCRETE PAVEMENT WITH BITUMINOUS BASE

A TACK COAT OF EMULSIFIED ASPHALT (SS-1H) SHALL BE APPLIED AT AN APPROXIMATE RATE 0.05 GALLONS PER SQ YD BETWEEN LIFTS OF ASPHALTIC MATERIALS WHEN ORDERED BY THE ENGINEER. TACK COAT WILL NOT BE PAID FOR DIRECTLY AND SHALL BE CONSIDERED AS SUBSIDIARY TO PRICE BID FOR ASPHALTIC PAVEMENT.

BITUMINOUS BASE AND ASPHALTIC CONCRETE WEARING SURFACE SHALL BE PLACED WITH A LAYDOWN MACHINE HAVING AUTOMATIC CONTROLS FOR CROWN AND GRADE. CONSTRUCTION JOINTS IN EACH LIFT SHALL BE STAGGERED A MINIMUM DISTANCE OF 1' WITH JOINTS IN PRECEDING LIFTS AND PLACED SUCH THAT A JOINT WILL BE CONSTRUCTED ON THE CENTERLINE IN THE TOP LIFT.

DETAIL OF TRANSVERSE CONSTRUCTION JOINTS

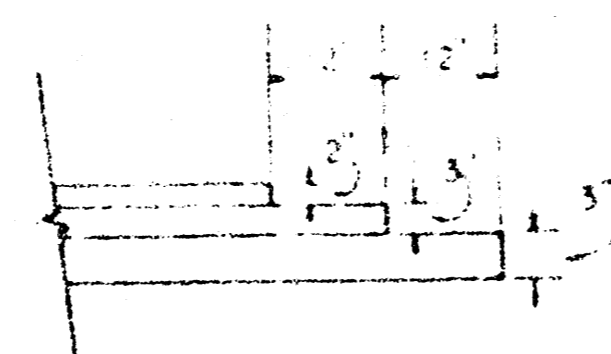

TRANSVERSE CONSTRUCTION JOINTS SHALL BE CONSTRUCTED IN FLEXIBLE BASE PAVEMENTS AT LOCATIONS WHERE PAVEMENT TEMPORARILY ENDS TO FACILITATE FUTURE PAVEMENT CONSTRUCTION AS SHOWN BY DETAIL. THE COST OF CONSTRUCTING THE TRANSVERSE CONSTRUCTION JOINTS SHALL NOT BE MEASURED OR PAID FOR DIRECTLY BUT SHALL BE INCLUDED IN THE BID PRICE FOR SQUARE YARDS OF ASPHALTIC CONCRETE PAVEMENT.

COMBINED CURB & GUTTER

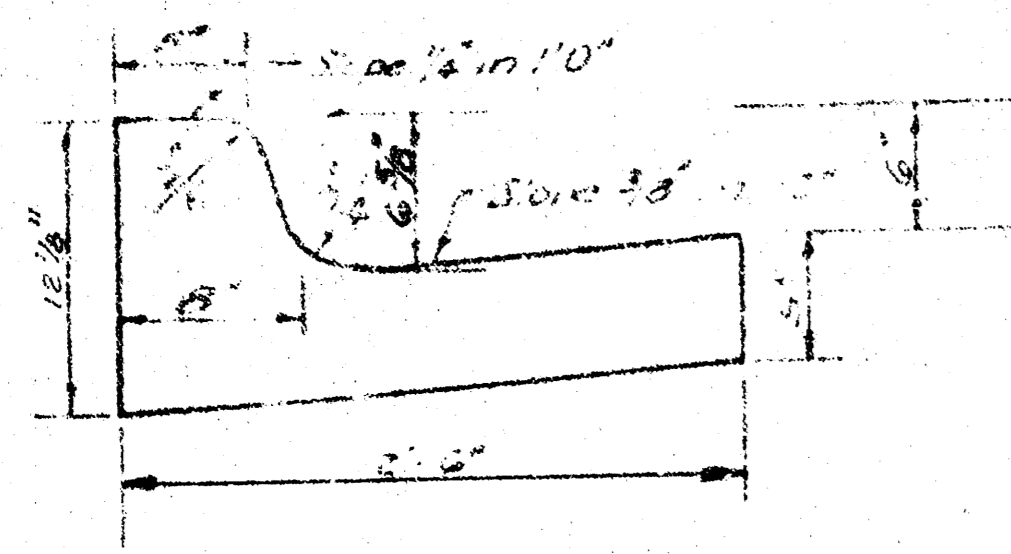

ROLL TYPE CURB & GUTTER

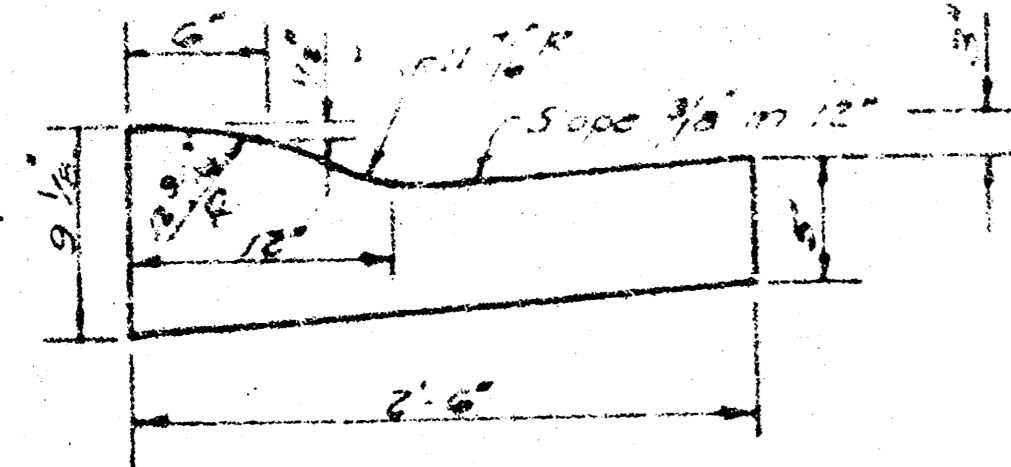

The 12" x 12" rounding shall be constructed in the centerline of the pavement. The 6" bituminous base shall be placed in two 3" lifts. The 2" curb shall be constructed on the right side of the pavement. The 2" gutter shall be constructed on the left side of the pavement.

CITY OF WICHITA KANSAS
DEPARTMENT OF ENGINEERING

R. W. BRUGGEMAN
DIRECTOR OF ENGINEERING/CITY ENGINEER

DATE _____ Proj No. _____

6/15/1

B.M.=126-934 Baker & 13th ST-N- City Of Wichita B.M. Disc., 26'
E. & 32' S. of Both



Scale: 1" = 20'

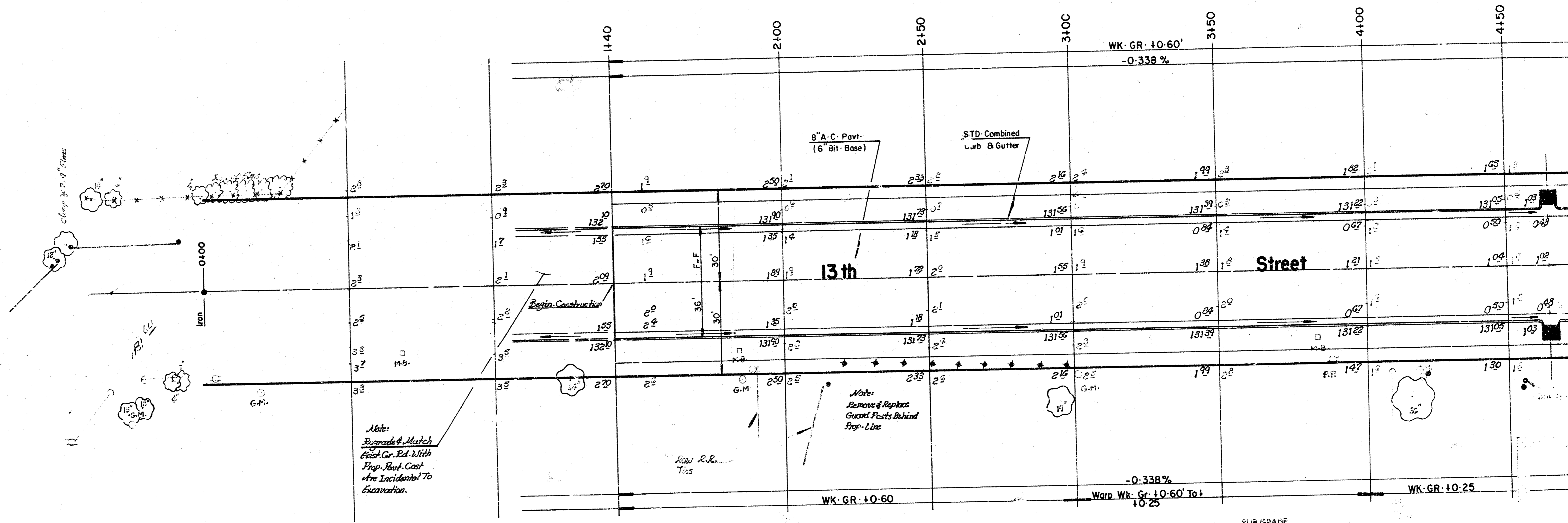

Survey Data
Plan and Elevation
Checked

EXCAVATION	4907-90 c.y.
410%	490-79 c.y.
TOTAL	5398-69 c.y.
Comp. Fill (wk.)	191-40 c.y.
410%	19-14 c.y.
TOTAL	210-54 c.y.
Manipulation	11987-20 s.y.

THE CONTRACTOR SHALL BE RESPONSIBLE FOR PRESERVING PROPERTY IRONS. THE CONTRACTOR SHALL BE REQUIRED TO RE-ESTABLISH ANY PROPERTY IRONS WHICH ARE DAMAGED OR DESTROYED BY HIS CONSTRUCTION OPERATIONS. SUCH IRONS SHALL BE RE-ESTABLISHED BY A LICENSED LAND SURVEYOR OR A LICENSED PROFESSIONAL ENGINEER IN ACCORDANCE WITH STATE LAWS.

SUB-GRADE
TYPE OF SUB-GRADE TREATMENT SHALL BE DETERMINED BY THE FIELD ENGINEER. SUB-GRADE TREATMENT MAY CONSIST OF LIME TREATMENT, CEMENT TREATMENT, SUB-GRADE MODIFICATION, OR ANY COMBINATION OF THESE.

CAUTION
UNDERGROUND UTILITIES
Please check with K & E or Southwestern Bell Telephone Co. for Location

13th Street

2/15

INTERSECTION QUANTITIES

40.0	S.Y. Pavement Removed (Inc. Curb & Gutter)
188.6	S.Y. 8" Asphaltic Conc. Pavement (6" Bituminous Base)
12.2	S.Y. 3" Bituminous Base
52.2	L.F. Combined Curb & Gutter
49.0	L.F. Pipe Removed
97.4	S.F. 4" Wheelchair Ramp
88.0	S.F. 4" Walk
---	C.Y. Excavation
12.3	C.Y. Compacted Fill
35.5	L.F. Saw Joint
207.7	S.Y. Manipulation
2.6	Tons Lime or Cement
---	S.Y. V.G. Concrete & Asphaltic Concrete Base

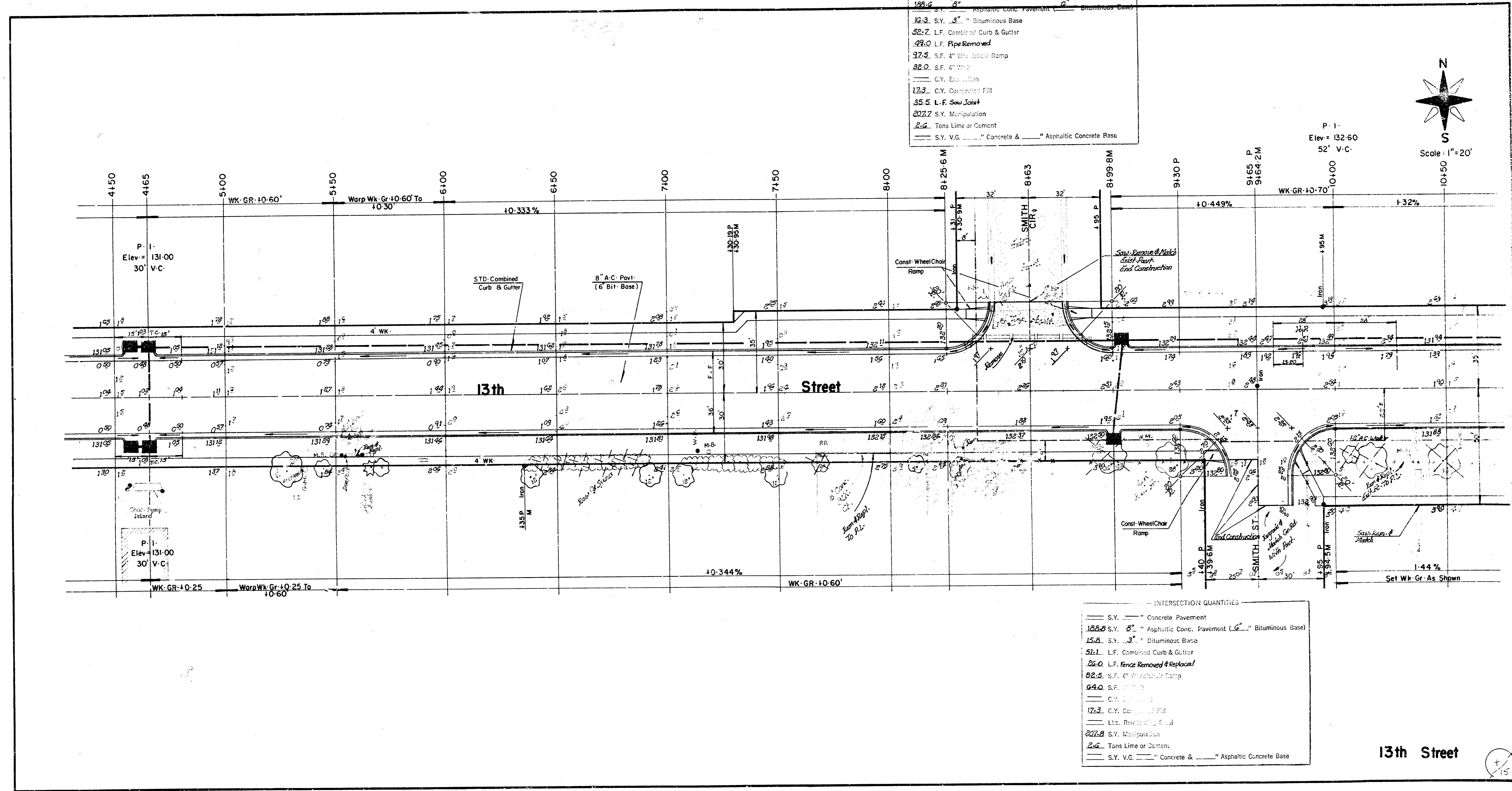

INTERSECTION QUANTITIES

---	S.Y. Concrete Pavement
188.6	S.Y. 8" Asphaltic Conc. Pavement (6" Bituminous Base)
15.4	S.Y. 3" Bituminous Base
51.1	L.F. Combined Curb & Gutter
26.0	L.F. Fence Removed & Replaced
92.5	S.F. 4" Wheelchair Ramp
64.0	S.F. 4" Walk
---	C.Y. Excavation
17.2	C.Y. Compacted Fill
---	Lbs. Reinforcing Steel
207.8	S.Y. Manipulation
2.6	Tons Lime or Cement
---	S.Y. V.G. Concrete & Asphaltic Concrete Base

13th Street

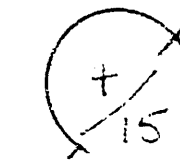

INTERSECTION QUANTITIES

---	S.Y.	---	" Concrete Pavement
---	202.0	S.Y.	" Asphaltic Conc. Pavement (6" Bituminous Base)
---	19.2	S.Y.	" Bituminous Base
---	46.2	L.F.	Combined Curb & Gutter
---	---	L.F.	Integral Curb
---	---	S.F.	4" Wheelchair Ramp
---	---	S.F.	4" Walk
---	---	C.Y.	Excavation
---	18.6	C.Y.	Compacted Fill
---	---	Lbs.	Reinforcing Steel
---	223.1	S.Y.	Municipalities
---	2.8	Tons	Line of Cement
---	S.Y.	V.G.	Concrete & " Asphaltic Concrete Base

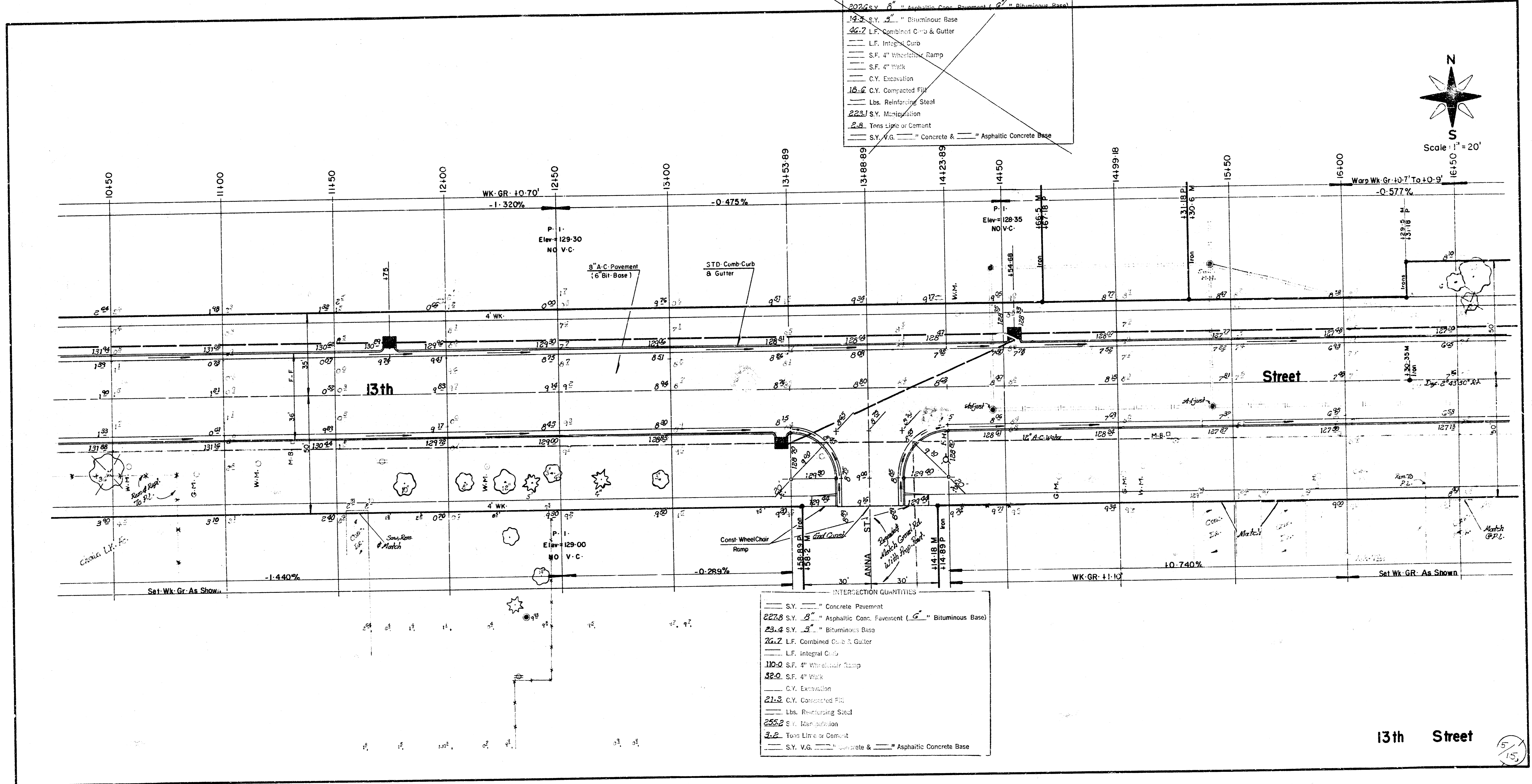

INTERSECTION QUANTITIES

---	S.Y.	---	" Concrete Pavement
---	227.8	S.Y.	" Asphaltic Conc. Pavement (6" Bituminous Base)
---	23.4	S.Y.	" Bituminous Base
---	26.2	L.F.	Combined Curb & Gutter
---	---	L.F.	Integral Curb
---	110.0	S.F.	4" Wheelchair Ramp
---	32.0	S.F.	4" Walk
---	---	C.Y.	Excavation
---	21.3	C.Y.	Compacted Fill
---	---	Lbs.	Reinforcing Steel
---	252.2	S.Y.	Municipalities
---	3.2	Tons	Line of Cement
---	S.Y.	V.G.	Concrete & " Asphaltic Concrete Base

13th Street

5/15

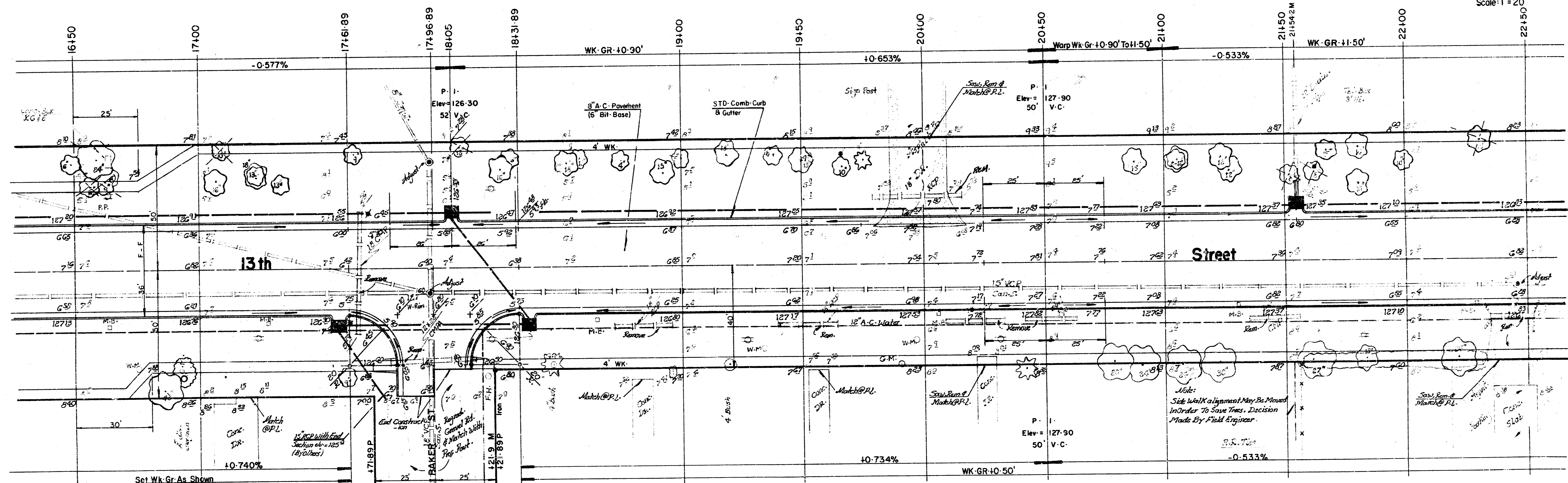
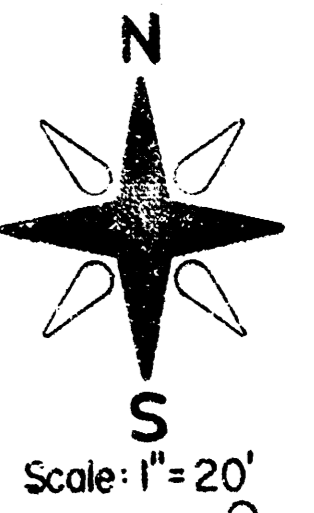

INTERSECTION QUANTITIES

192.1	S.Y.	4"	Concrete Pavement
192.1	S.Y.	8"	Asphaltic Conc. Pavement (6" Bituminous Base)
172	S.Y.	3"	Bituminous Base
55.9	L.F.		Combined Curb & Gutter
35.5	L.F.		Pipe Removed
35.0	S.F.		4" Wheelchair Ramp
1			Man Hole Adjusted
			C.Y. Excavation
18.1	C.Y.		Compacted Fill
			Lbs. Reinforcing Steel
212.8	S.Y.		Manipulation
2.7			Tons Lime or Cement
			S.Y. V.G. Concrete & Asphaltic Concrete Base

Note:
Site Walk Alignment May Be Moved
In Order To Save Time. Decision
Made By Field Engineer.

13th Street

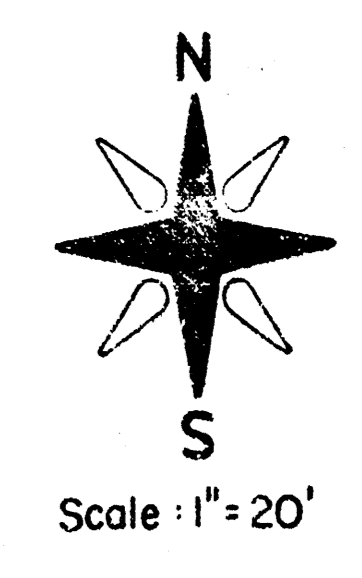

Note: Regrade Ditch (100') Cost Of Regrading Is Incidental To C.F. Pipe

48.5' L. Sta 27+17 Const. Double 24" Drop Inlet, T=126.0 Install 62" RCP USFL=123.4 DSFL=122.7 Connect Pipe To Existing M.H. (See Detail Pg. 15)

Const. 18" RCP Pipe

Const. Wheelchair Ramp

Const. 18" RCP Pavt.

Const. Wheelchair Ramp

Const. Wheelchair Ramp

Const. Wheelchair Ramp

Const. Wheelchair Ramp

Const. Wheelchair Ramp

Const. Wheelchair Ramp

Const. Wheelchair Ramp

Const. Wheelchair Ramp

Const. Wheelchair Ramp

Const. Wheelchair Ramp

Const. Wheelchair Ramp

Const. Wheelchair Ramp

Const. Wheelchair Ramp

Const. Wheelchair Ramp

Const. Wheelchair Ramp

Const. Wheelchair Ramp

Const. Wheelchair Ramp

Const. Wheelchair Ramp

Const. Wheelchair Ramp

Const. Wheelchair Ramp

Const. Wheelchair Ramp

Const. Wheelchair Ramp

Const. Wheelchair Ramp

Const. Wheelchair Ramp

Const. Wheelchair Ramp

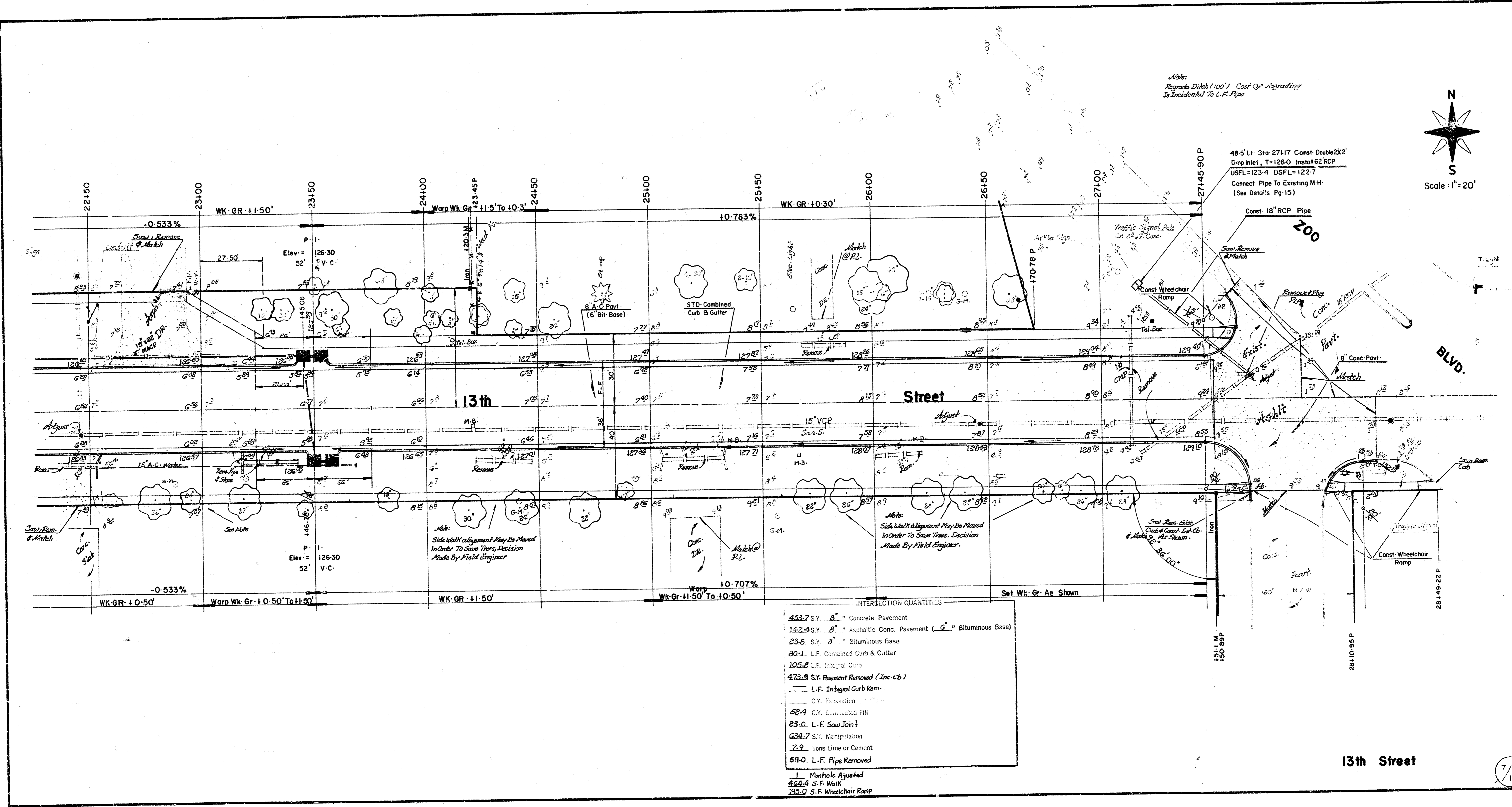

INTERSECTION QUANTITIES

453.7	S.Y.	8"	Concrete Pavement
142.4	S.Y.	8"	Asphaltic Conc. Pavement (6" Bituminous Base)
23.6	S.Y.	8"	Bituminous Base
80.1	L.F.		Combined Curb & Gutter
105.8	L.F.		Integral Curb
473.9	S.Y.		Pavement Removed (Inc. Cb.)
			L.F. Integral Curb Rem.
			C.Y. Excavation
52.9	C.Y.		Connected FIR
23.0	L.F.		Saw Joint
634.7	S.Y.		Municipal
2.9	Tons		Lime or Cement
64.0	L.F.		Pipe Removed
			Manhole Adjusted
44.0	S.F.		Walk
33.0	S.F.		Wheelchair Ramp

13th Street

7/15

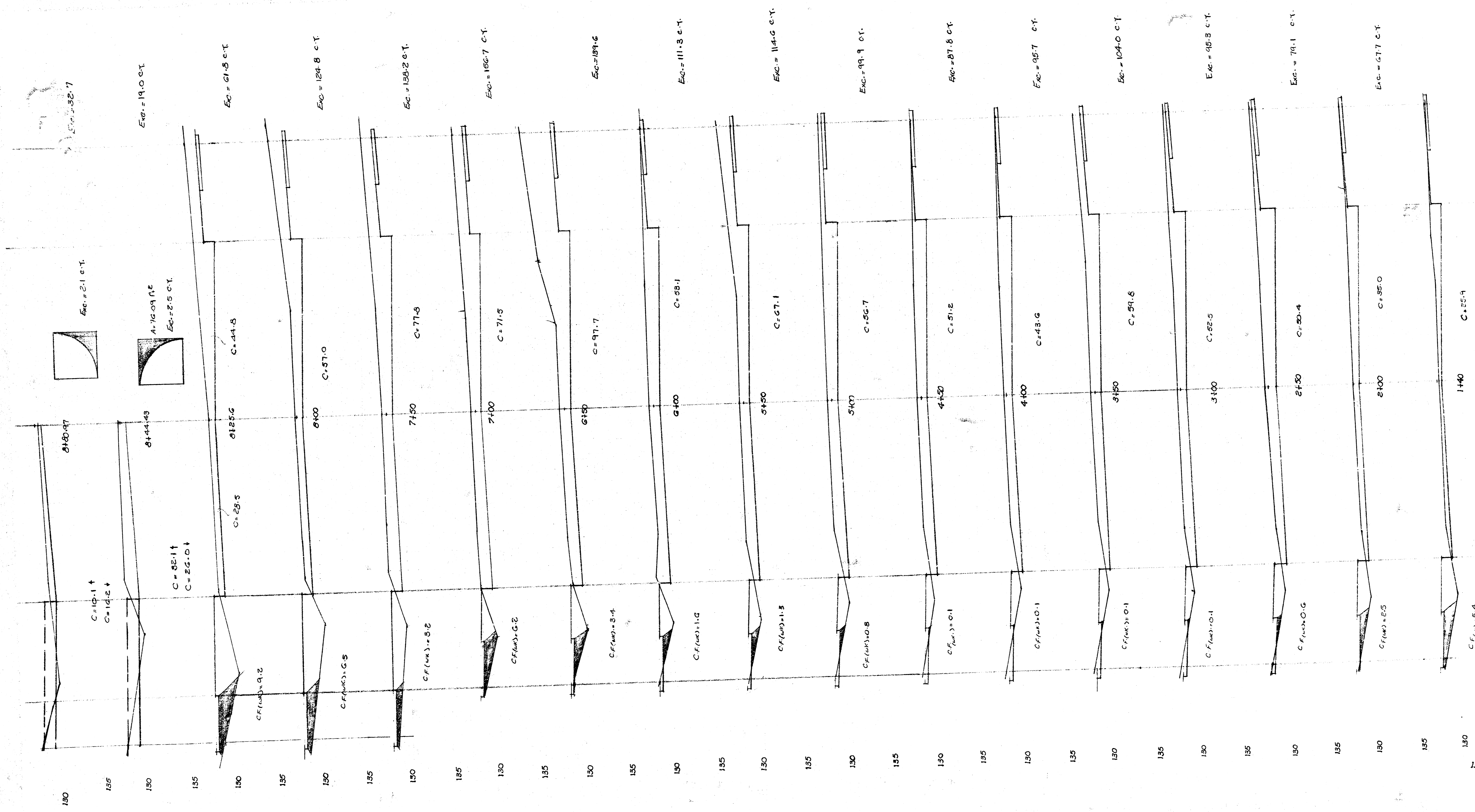

Exc. = 32.7

Exc. = 19.0 c.Y.

Exc. = 61.8 c.Y.

Exc. = 124.8 c.Y.

Exc. = 130.2 c.Y.

Exc. = 156.7 c.Y.

Exc. = 189.6

Exc. = 111.3 c.Y.

Exc. = 114.6 c.Y.

Exc. = 99.9 c.Y.

Exc. = 87.8 c.Y.

Exc. = 92.7 c.Y.

Exc. = 104.0 c.Y.

Exc. = 95.3 c.Y.

Exc. = 79.1 c.Y.

Exc. = 67.7 c.Y.

Exc. Total = 4907.4 c.Y.

8+30.97

8+44.43

8+55.6

8+60

7+50

7+00

6+50

6+00

5+50

5+00

4+50

4+00

3+50

3+00

2+50

2+00

1+40

C = 102.1 ↑
C = 114.2 ↓

C = 52.1 ↑
C = 26.0 ↓

CF (CG) = 9.2

CF (CG) = 6.5

CF (CG) = 3.2

CF (CG) = 0.2

CF (CG) = 3.4

CF (CG) = 1.4

CF (CG) = 1.3

CF (CG) = 0.8

CF (CG) = 0.1

CF (CG) = 0.1

CF (CG) = 0.1

CF (CG) = 0.1

CF (CG) = 0.6

CF (CG) = 2.5

CF (CG) = 5.4

130

135

130

135

130

135

130

135

130

135

130

135

130

135

130

135

130

13 Th Street

Total CF (CG) = 191.4 c.Y.

15/15

135
130
135
130
135
130
135
130
135
130
135
130
135
130

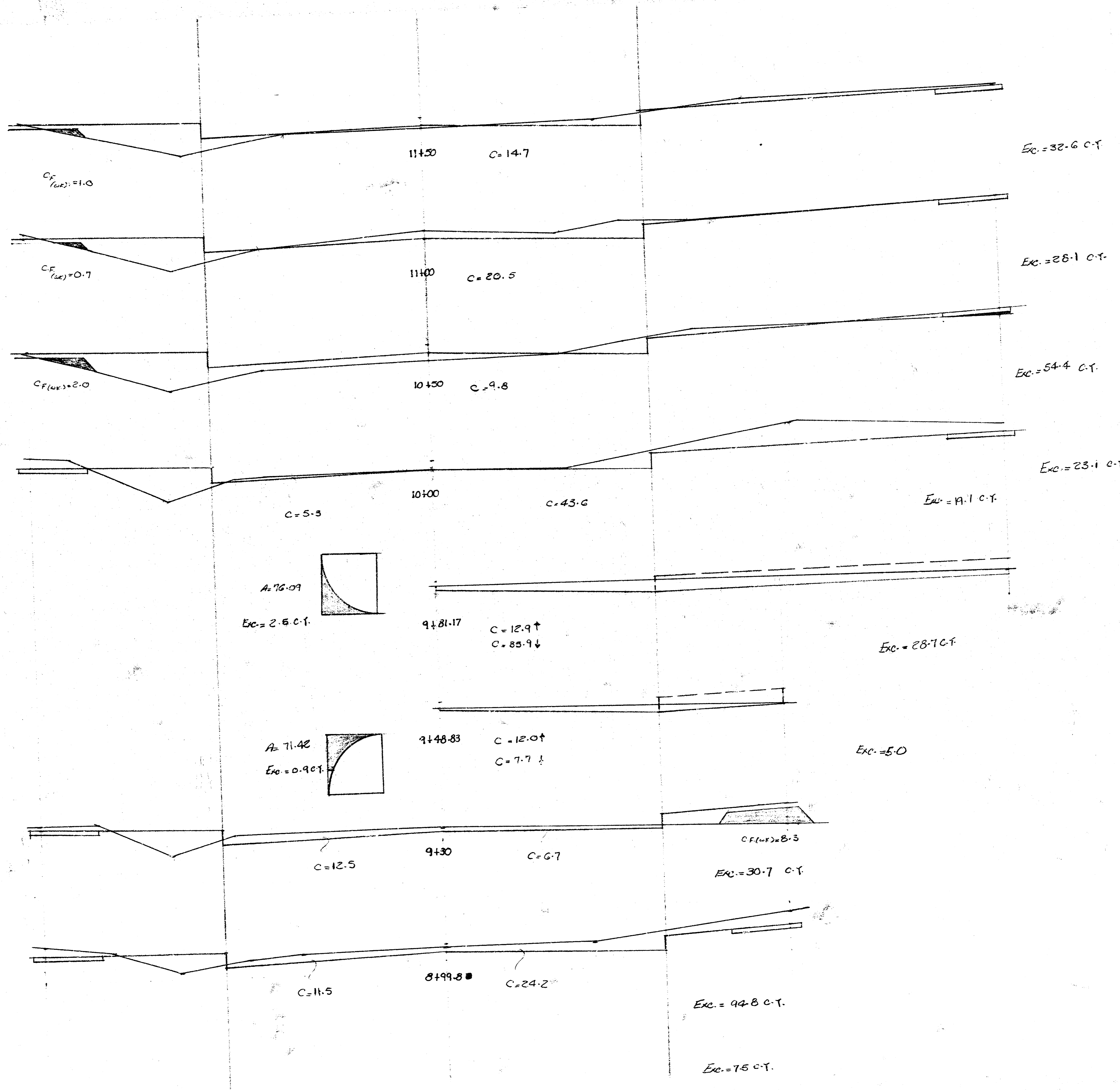

137th Street

9/15

130
125
130
125
130
125
130
125
130
125
130
125
130
125
130
125
130
125
130
125

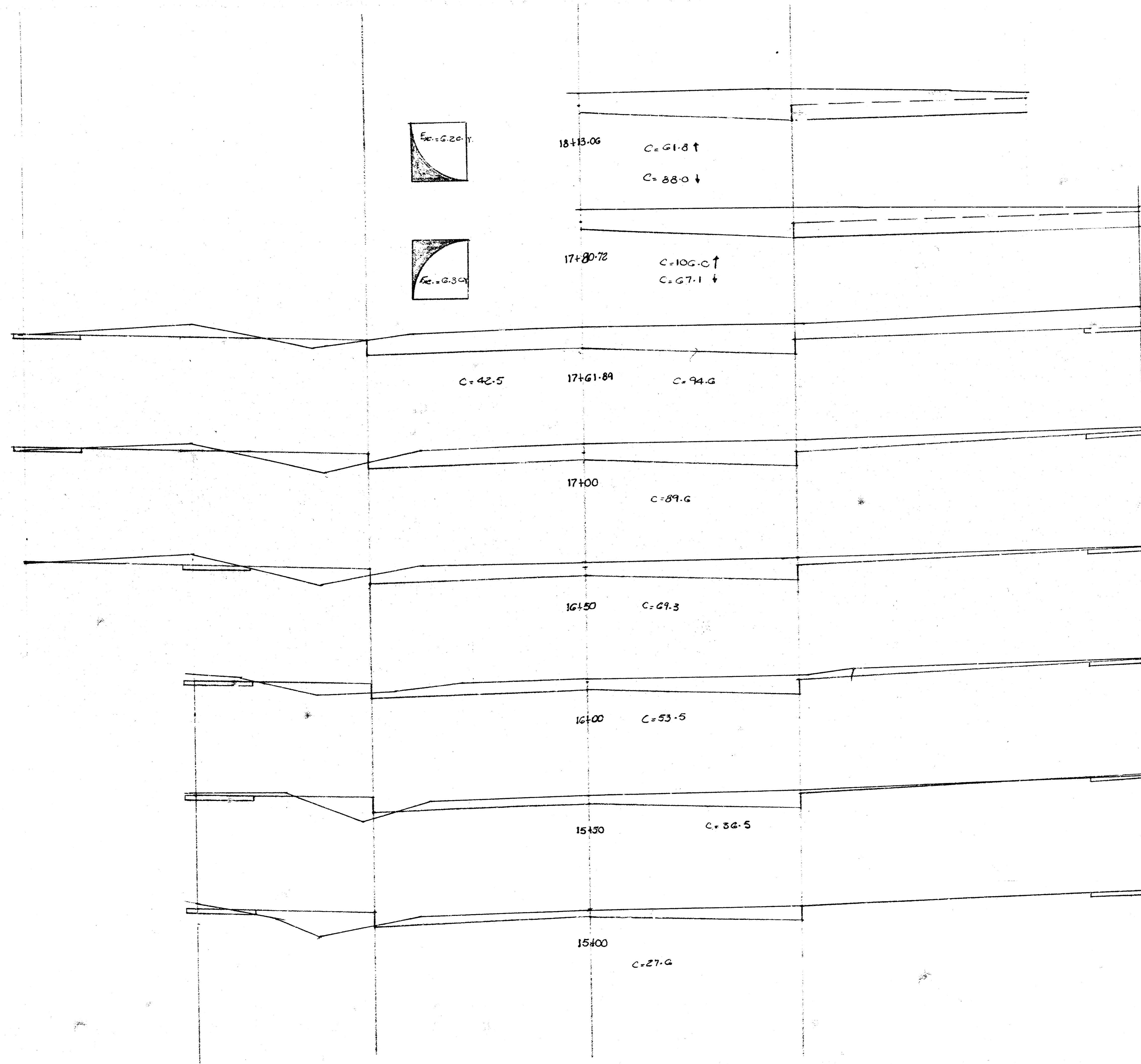

130
125
130
125
130
125
130
125
130
125
130
125
130
125
130
125

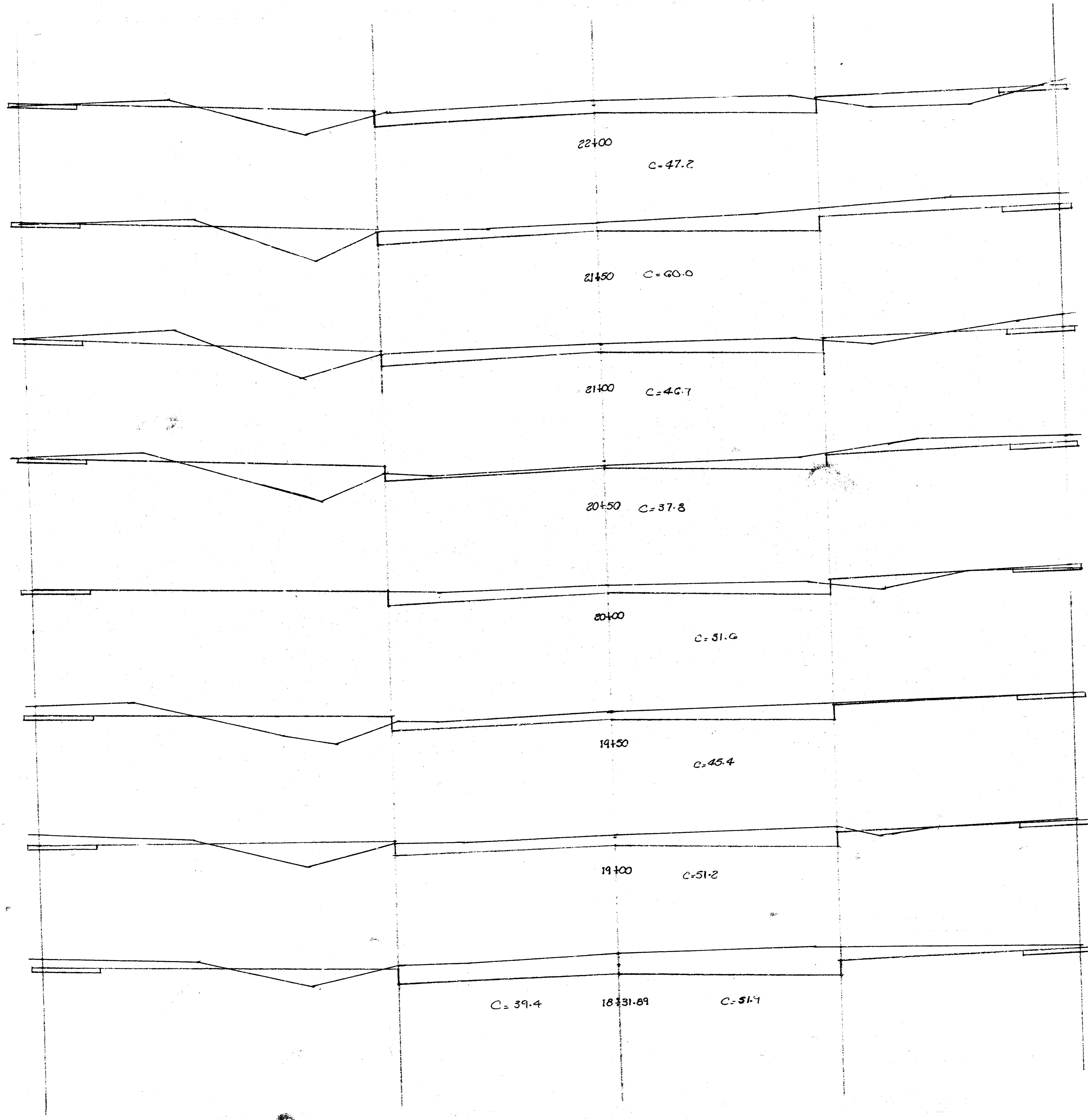

Exc. = 99.5 c.Y.
Exc. = 98.8 c.Y.
Exc. = 78.2 c.Y.
Exc. = 64.3 c.Y.
Exc. = 71.1 c.Y.
Exc. = 89.3 c.Y.
Exc. = 179.7 c.Y.
Exc. = 106.2 c.Y.
Exc. = 39.6 c.Y.

137th Street

12/15

130
125
130
125
130
125
130
125
130
125
130
125
130
125

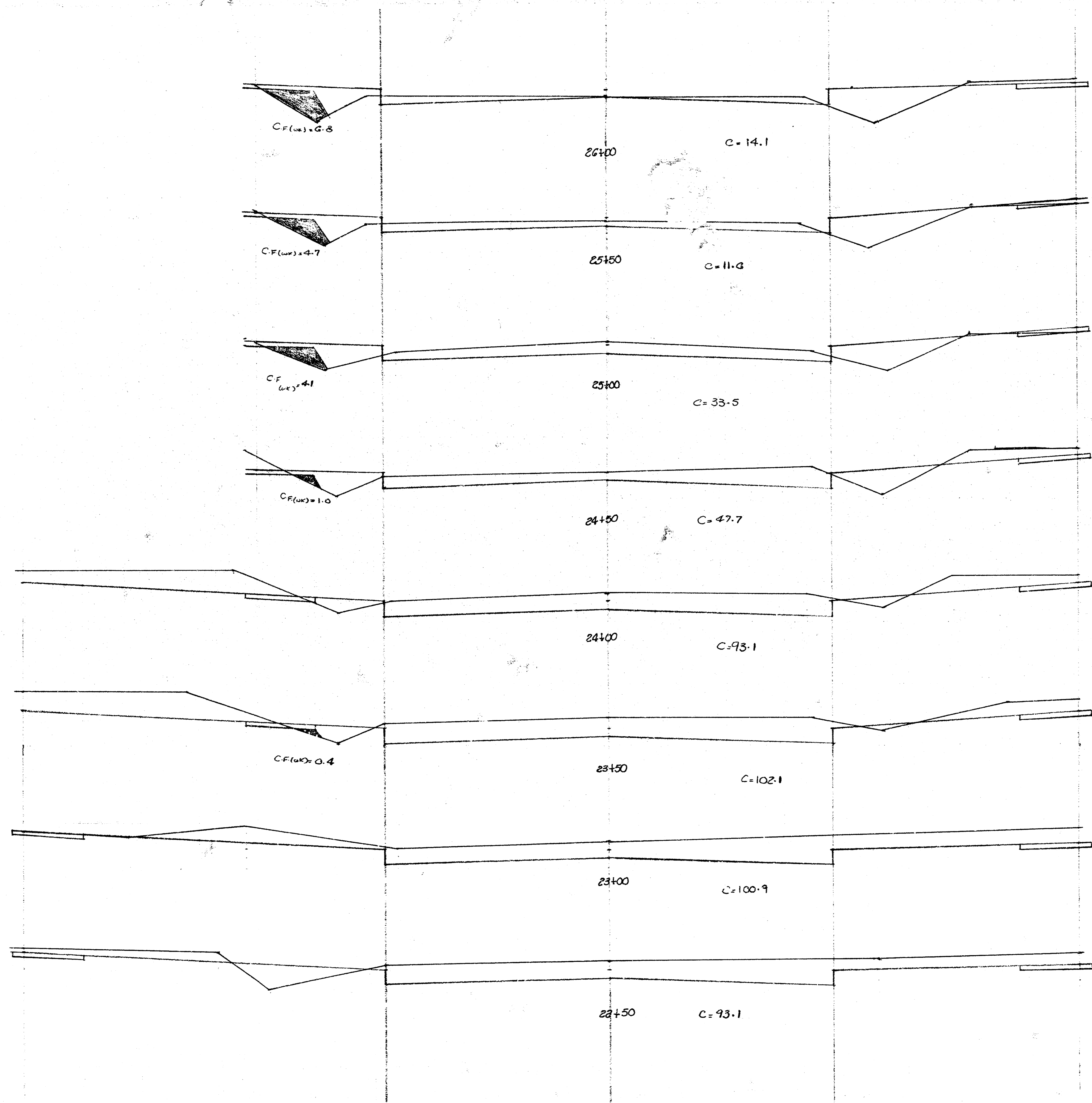

Exc. = 23.8
Exc. = 41.8 c-y.
Exc. = 75.2 c-y.
Exc. = 130.4 c-y.
Exc. = 180.7 c-y.
Exc. = 188.0 c-y.
Exc. = 179.6 c-y.
Exc. = 129.9 c-y.

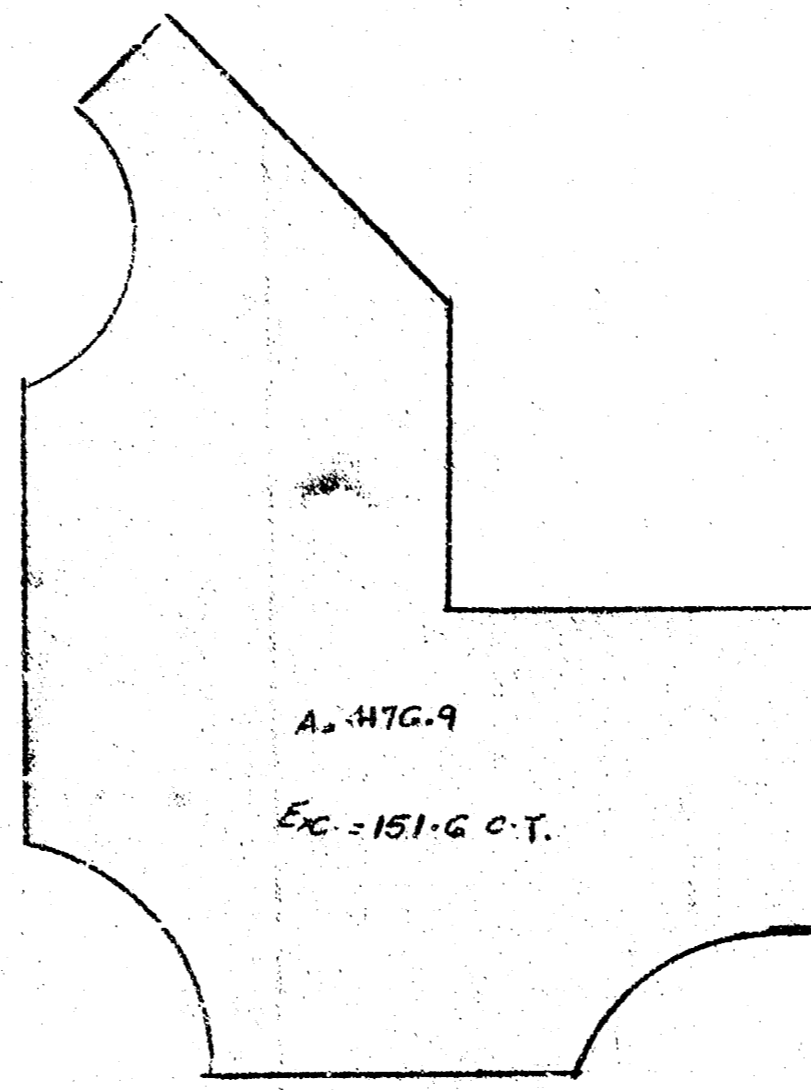

130
125
130
125
130
125

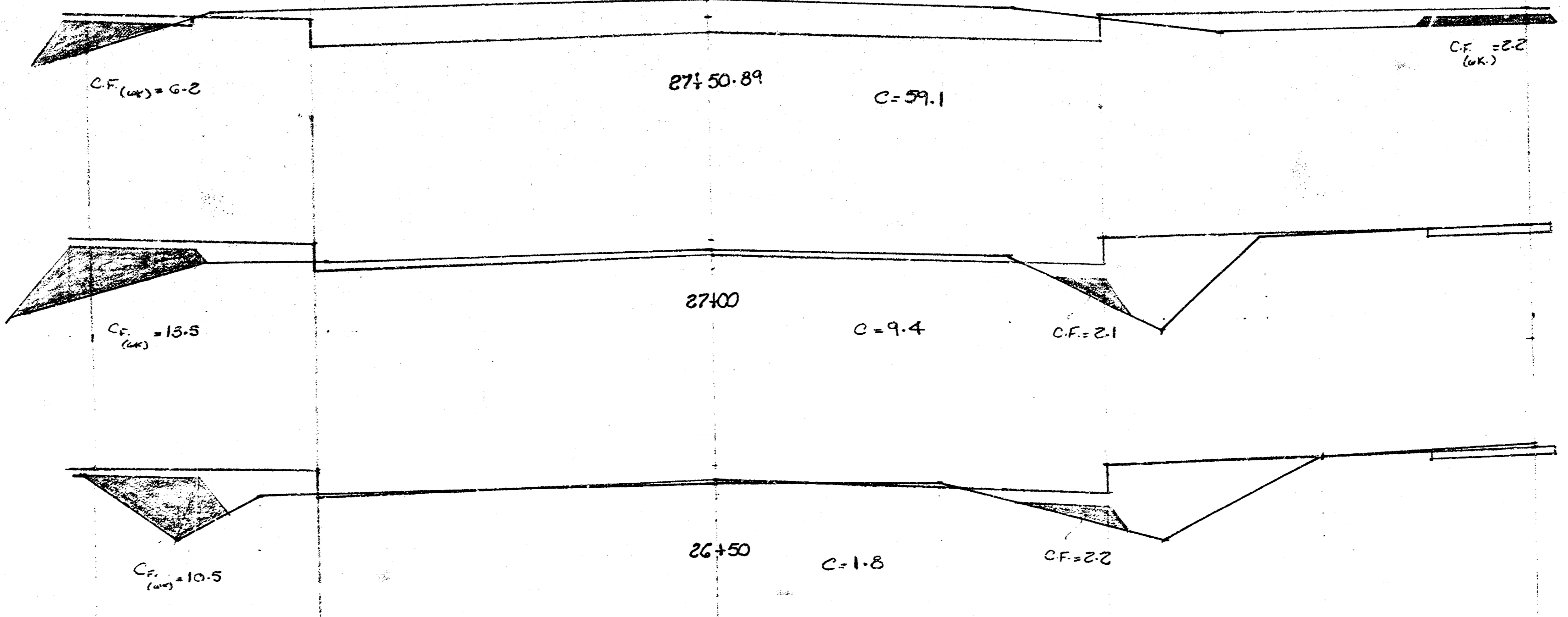

NOTE: Grates shall be imprinted on the top surface with "CITY OF WICHITA" using letters at least 1" in height. Other marking methods may be used only if approved by the engineer.

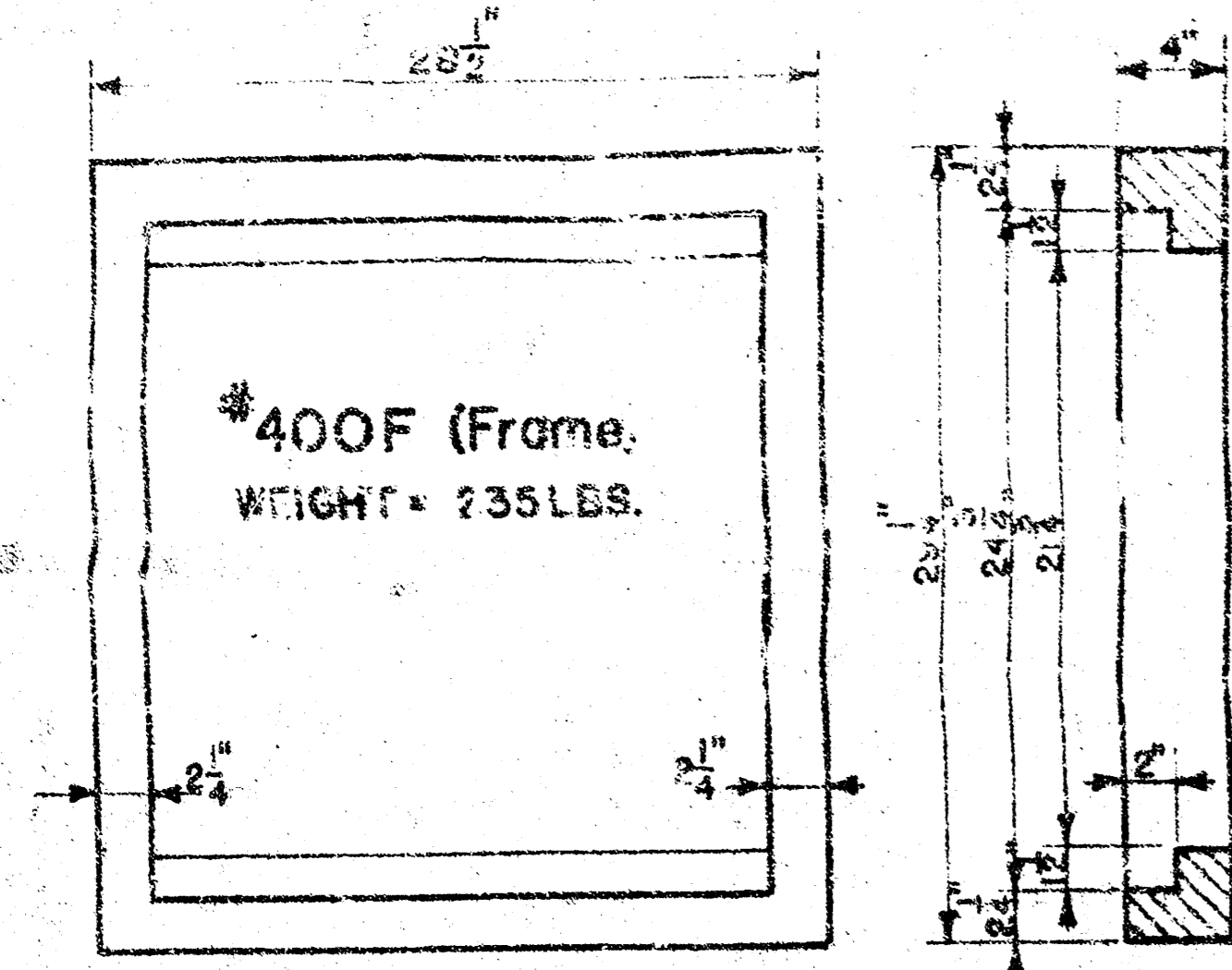

400G (Grate)
WEIGHT = 235 LBS

24"x24" Frame & Grate Detail

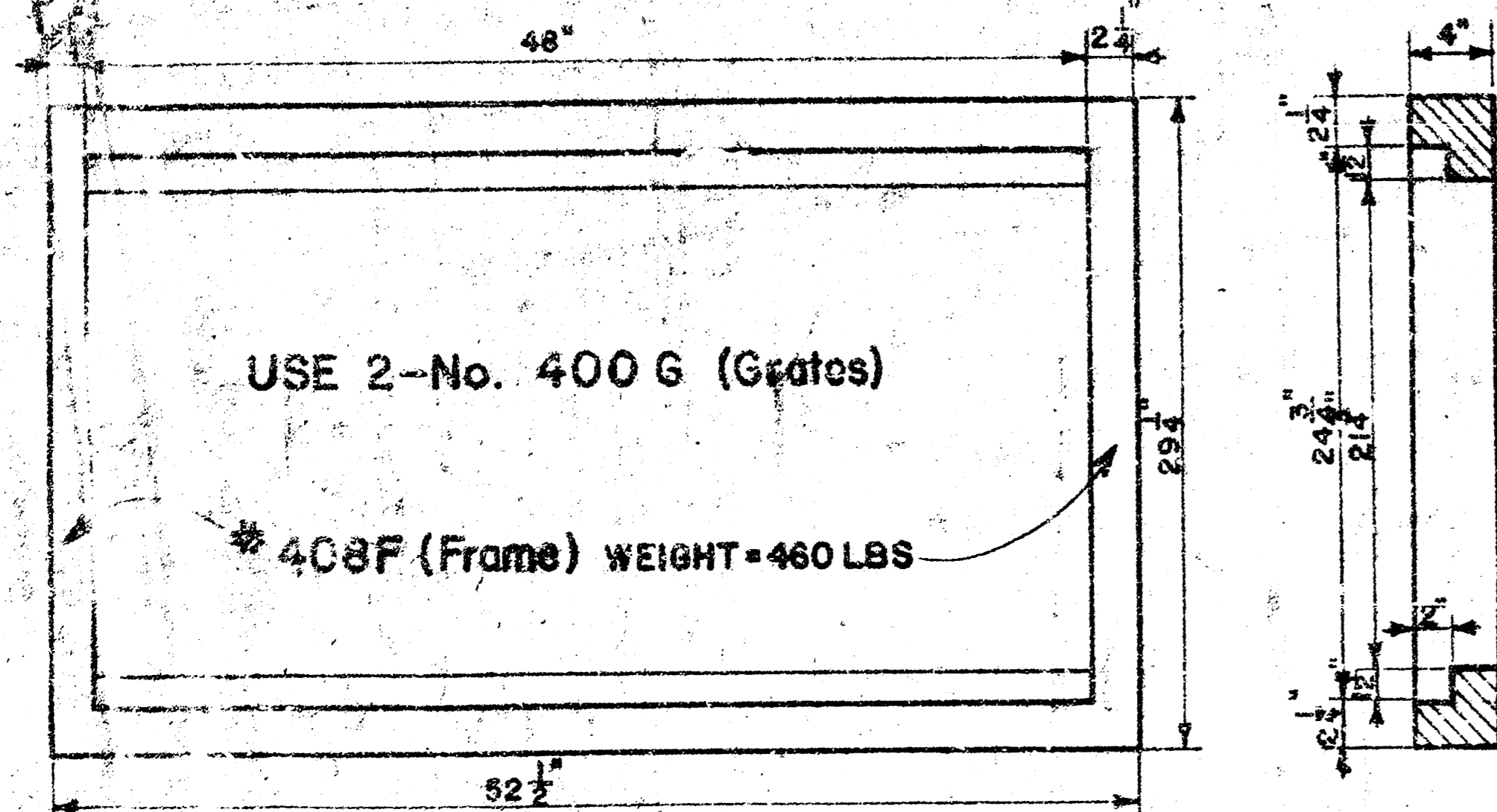

Double 24"x24" Frame Detail

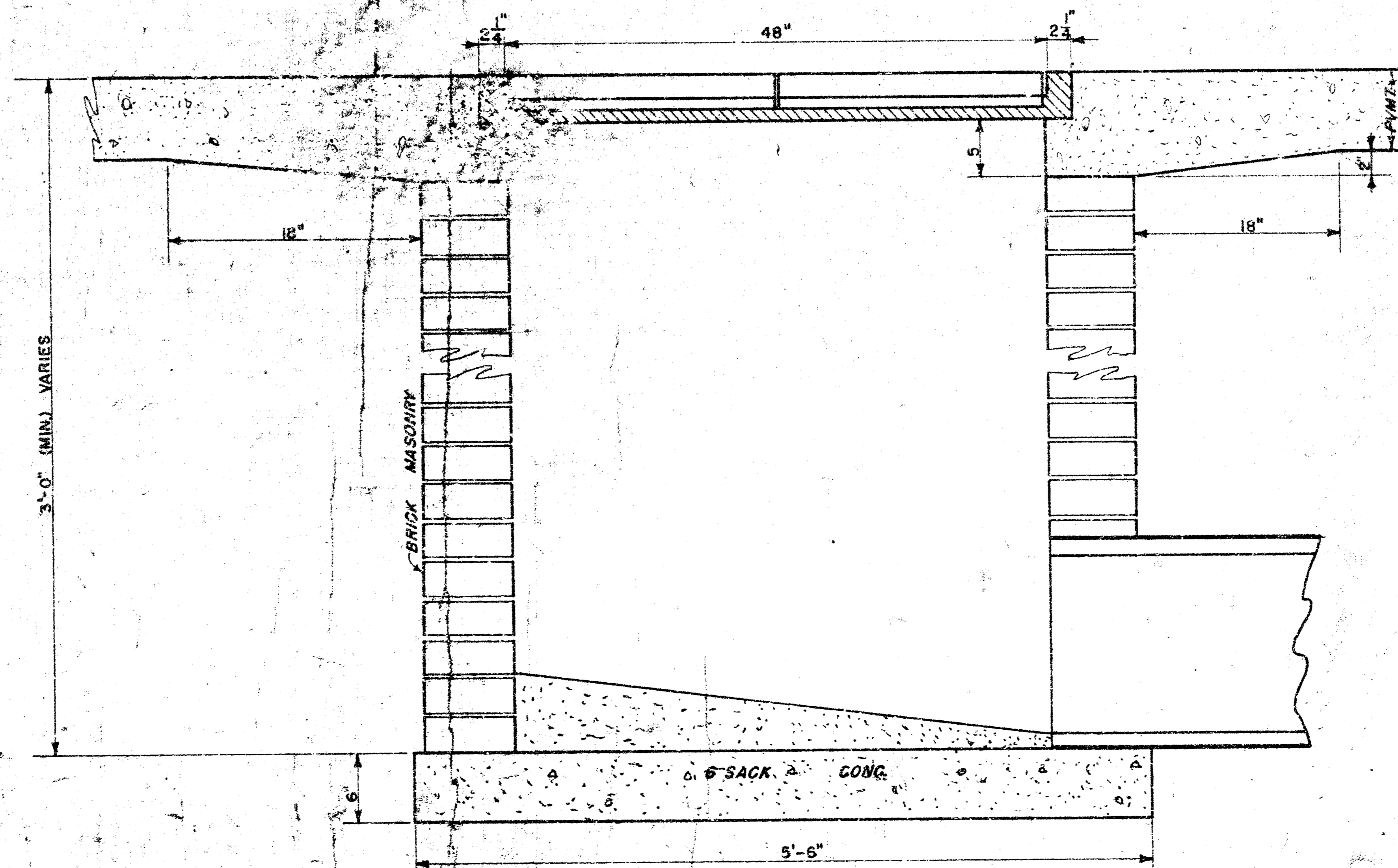
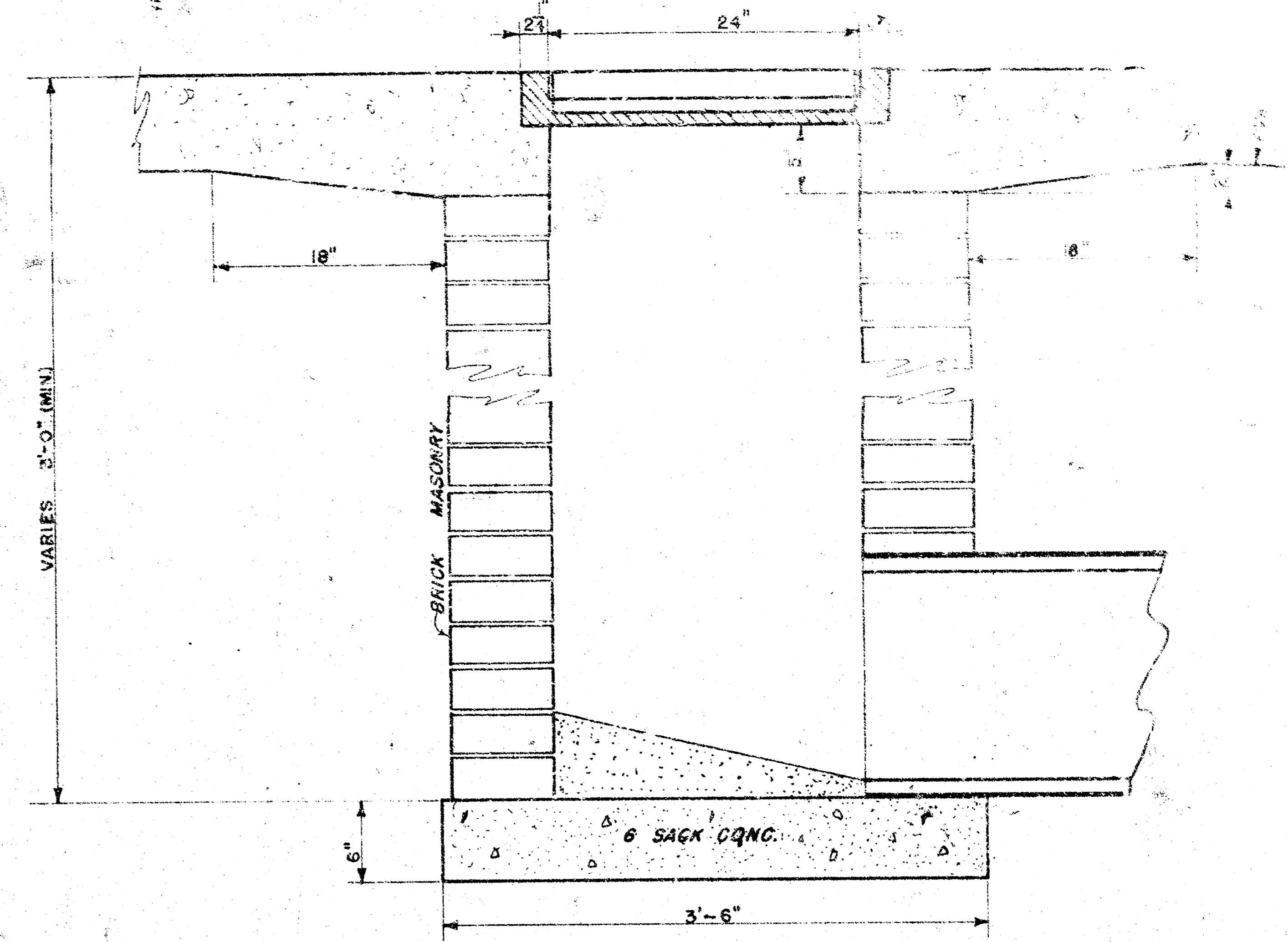
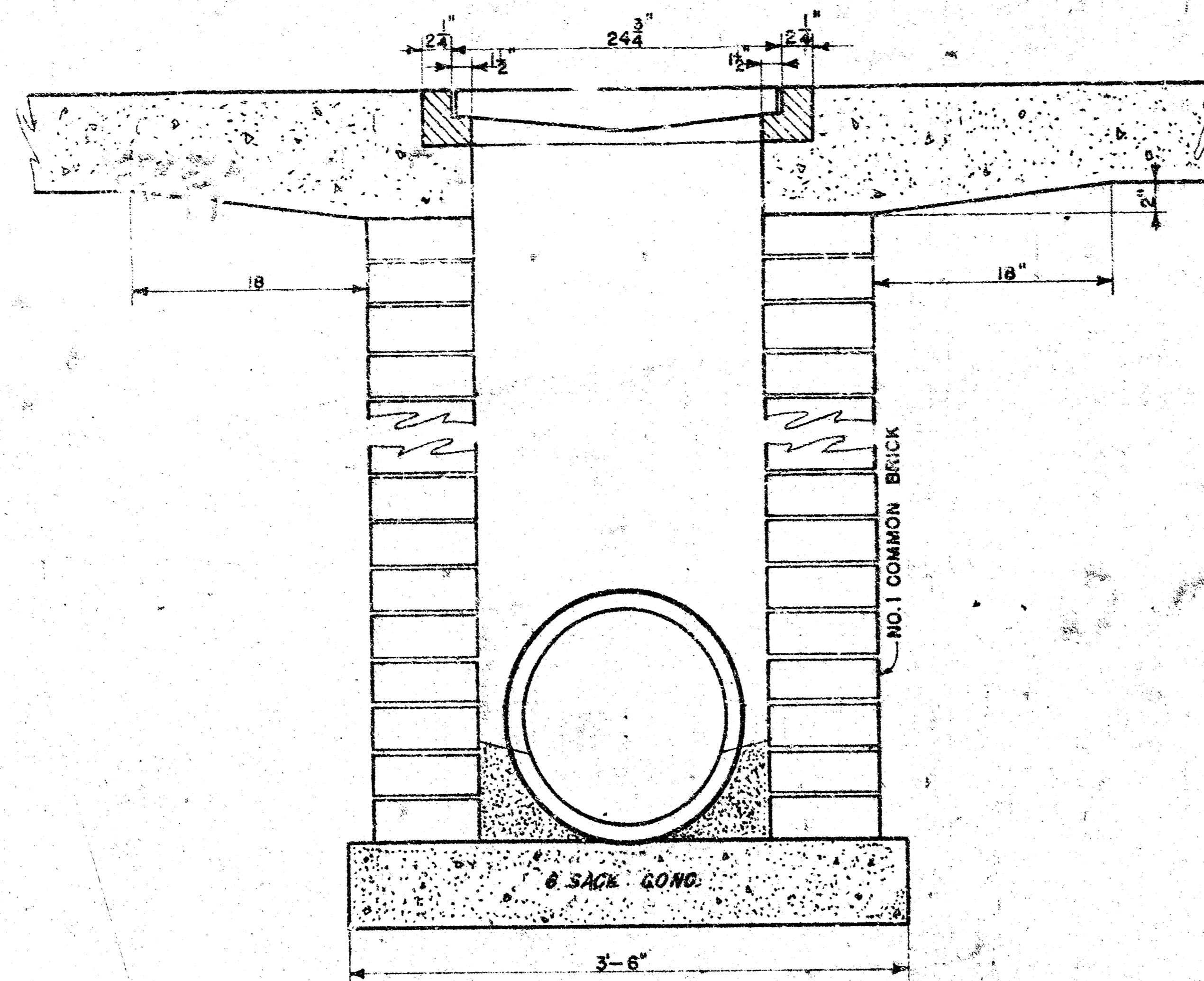

DROP INLET DETAILS

R.W. Bruggeman, City Engineer
City of Wichita, Kan.

Project

Project No.

Plate:

Scale: 1-1/2" = 1'-0"

10 10 1 10