

THIRTEENTH STREET
 E. L. 1-35W TO W. L. KANSAS
 PROJ. NO. DAKM569078
 CITY OF WICHITA, KANSAS
 R. W. LINN, CITY ENGINEER

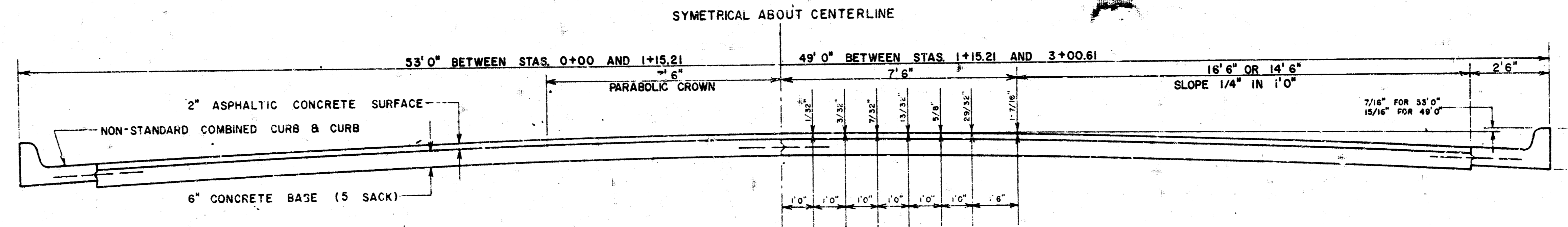

TYPICAL SECTION WITH STANDARD CROWN

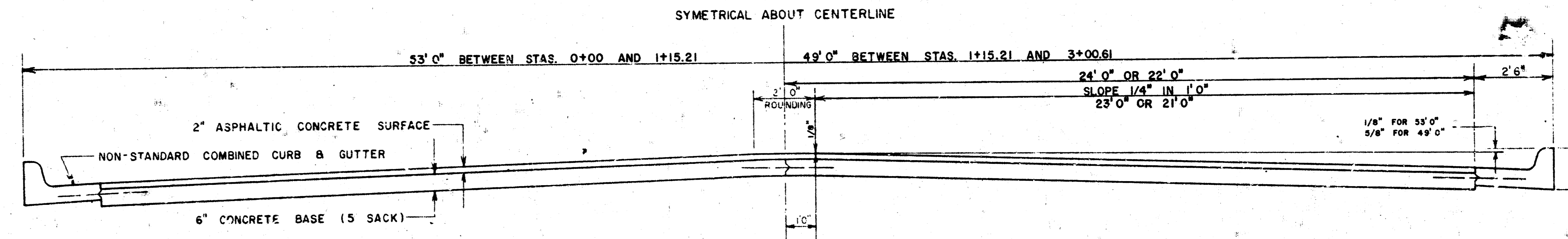

TYPICAL SECTION WITH ALTERNATE CROWN

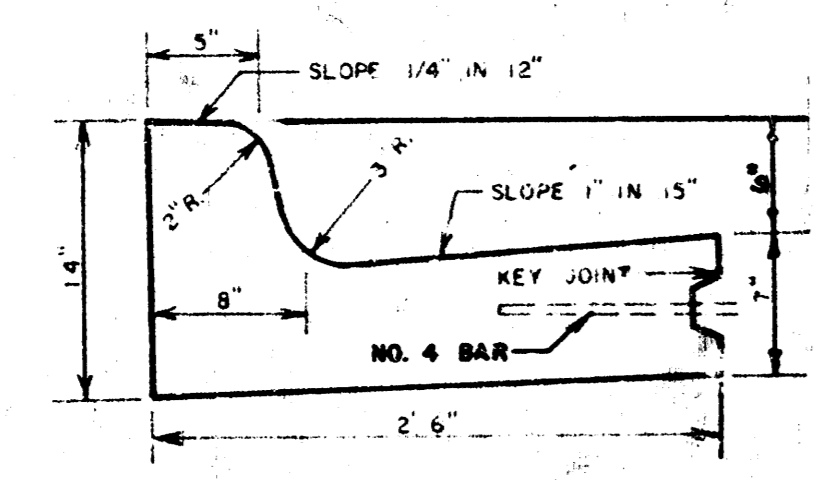

DETAIL OF NON-STANDARD COMBINED CURB & GUTTER

GENERAL NOTES
 CONTRACTION JOINTS MAY BE CONSTRUCTED IN COMBINED CURB AND GUTTER BY SAWING WITH AN APPROVED CONCRETE SAW. THE SAW CUT SHALL EXTEND 2-1/2\"/>

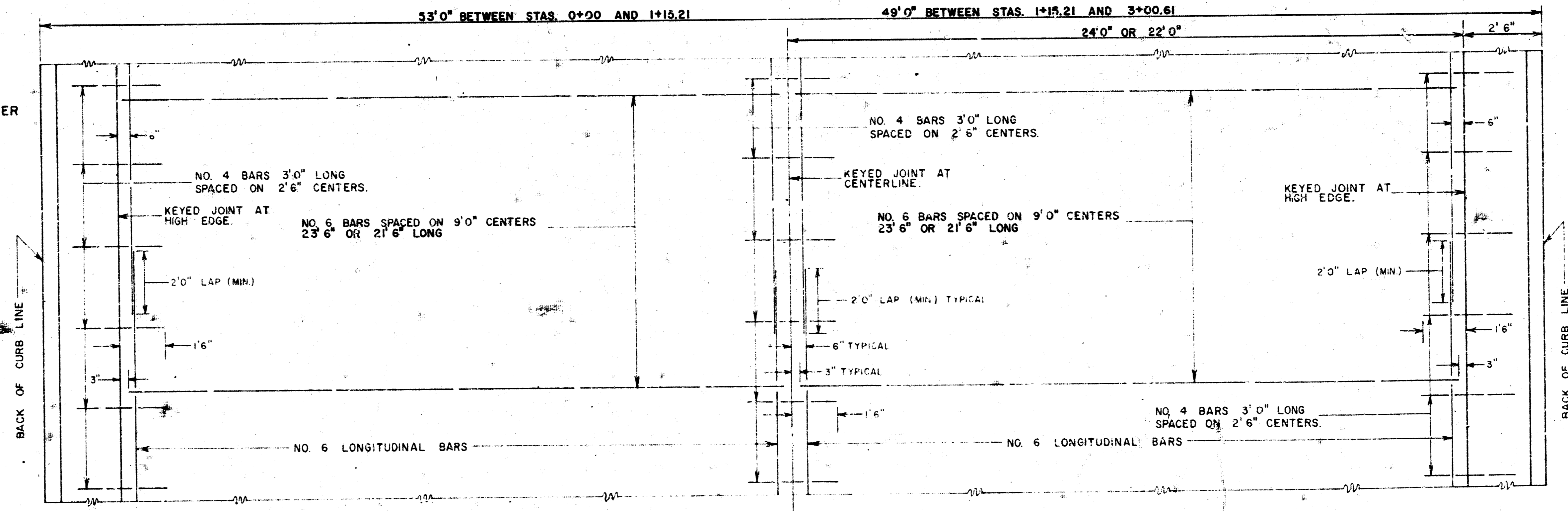

TYPICAL STEEL PATTERN

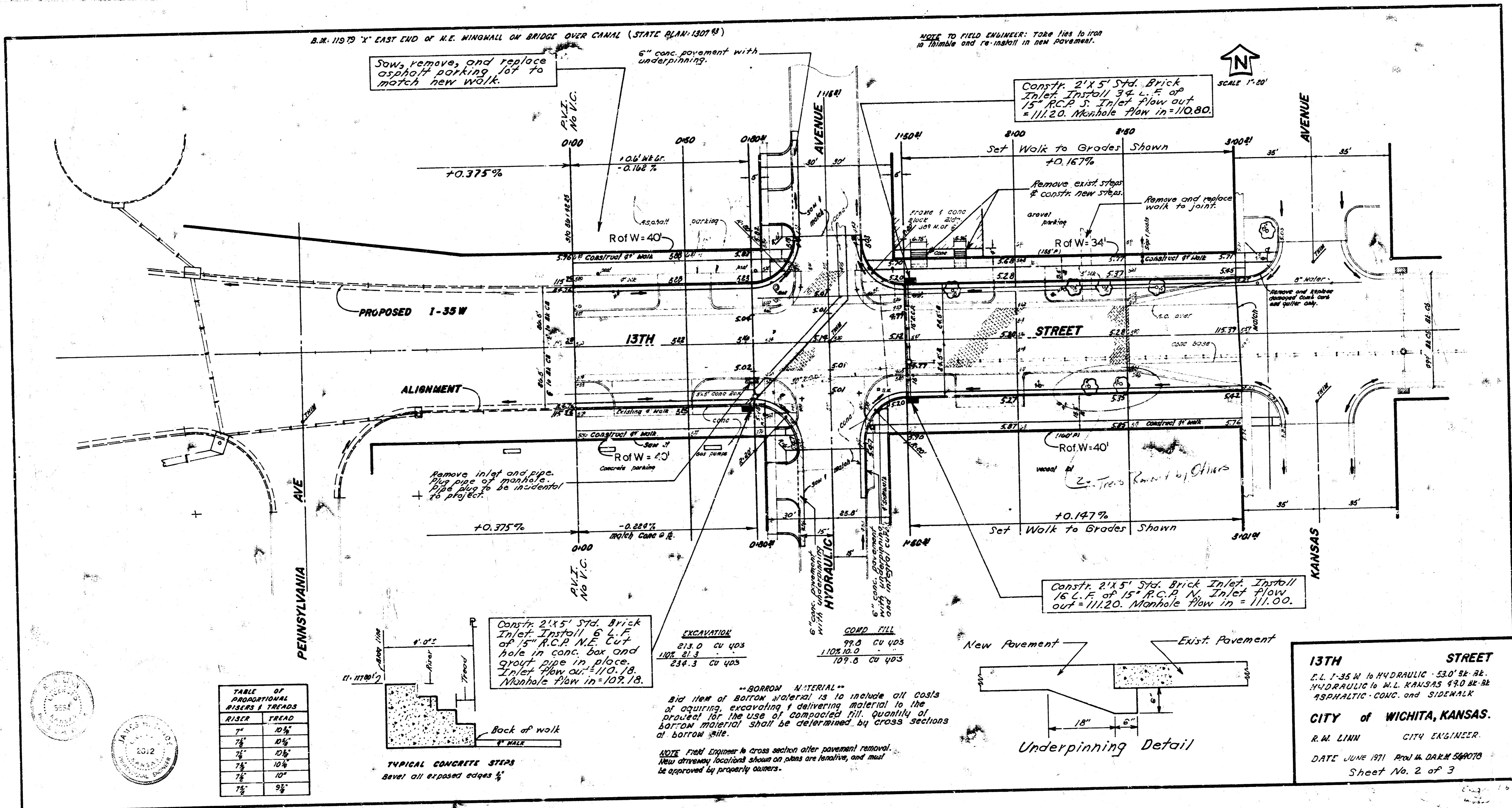
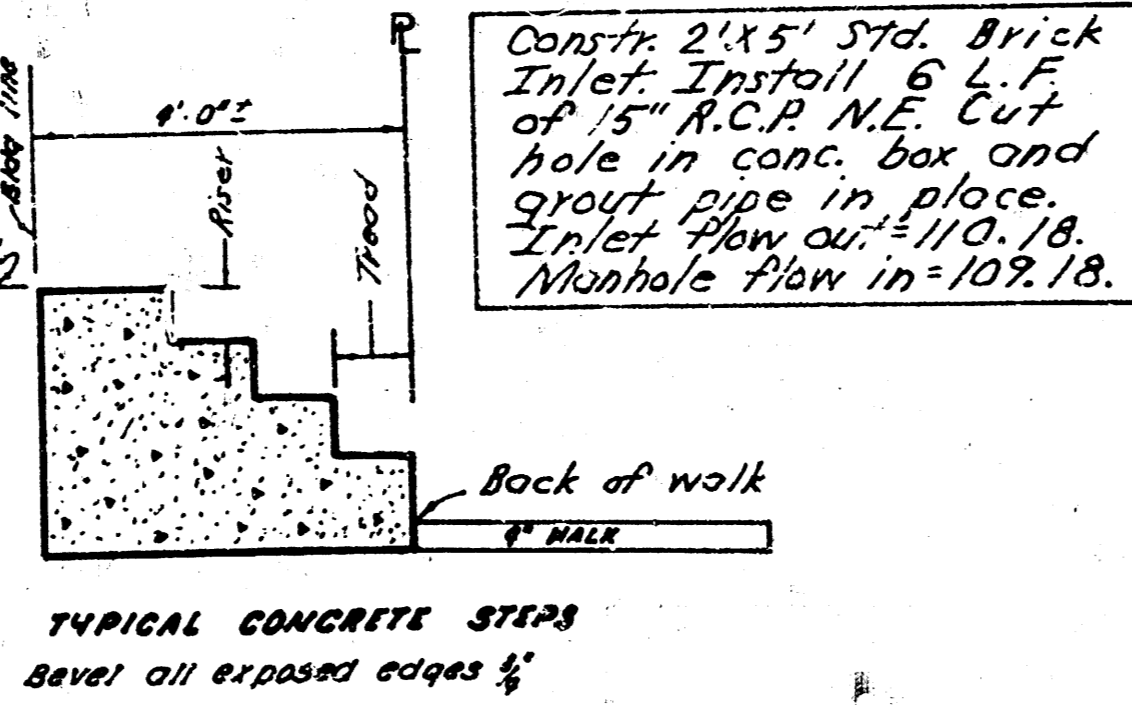

TABLE OF PROPORTIONAL RISERS & TREADS

RISER	TREAD
7"	10 1/2"
7 1/2"	10 1/2"
8"	10 1/2"
8 1/2"	10 1/2"
9"	10 1/2"
9 1/2"	10 1/2"



NOTE: Bid item of borrow material is to include all costs of acquiring, excavating & delivering material to the project for the use of compacted fill. Quantity of borrow material shall be determined by cross sections at borrow site.

NOTE: Field Engineer to cross section after pavement removal. New driveway locations shown on plans are tentative, and must be approved by property owners.

13TH STREET
E.L. 1-35 W to HYDRAULIC 53.0' BE. BE.
HYDRAULIC to ALL KANSAS 49.0 BE. BE.
ASPHALTIC CONC. and SIDEWALK

CITY OF WICHITA, KANSAS.
R.W. LINN CITY ENGINEER.
DATE JUNE 1971 Proj. No. D&M 564070
Sheet No. 2 of 3