

B.M. 11827 Top of Cb. N.E. Cor. 14th & Woodland
 B.M. 12027 N.E. Cor. Lower Step 10th 15th & Woodland

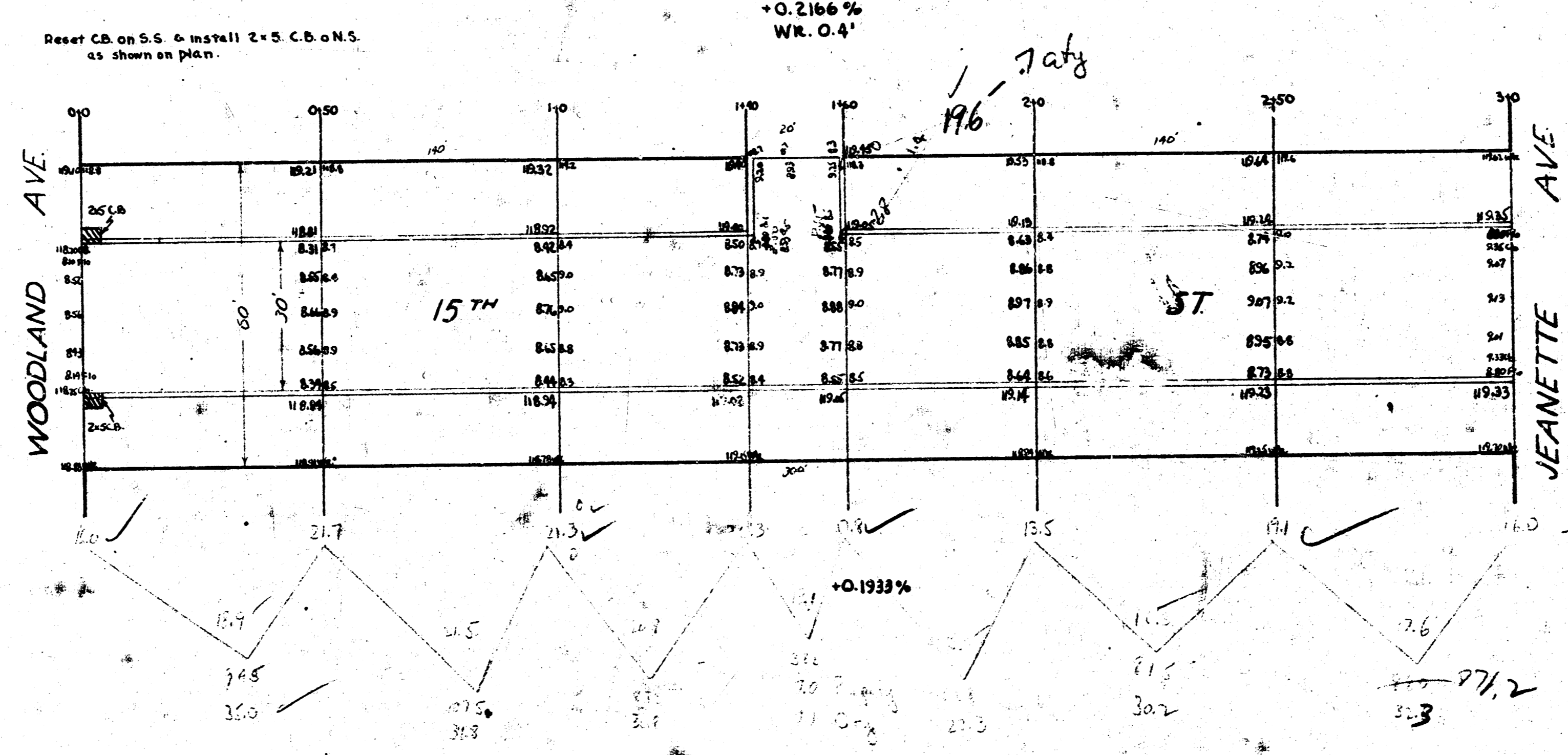

15TH ST
 EL WOODLAND TO W. JEANETTE
 30" CONCRETE & CB
 CITY OF WICHITA, KANSAS
 L. K. WHITE CITY ENGINEER
 JULY 1946

754.48 241.69