

B.M. 120.65 S.E. Corner Top
Curb. Step No. 612 E. 15th St.

NOTE: Alignment for Pavement is from Back of Curb
Sta. 0+00 to 155' (L) & (R) & Sta. 1+50

B.M. 118.13 Iron in Conc. N.L. 15th St.
111' E. of E. Barwise - S.E. Cor. Fence.

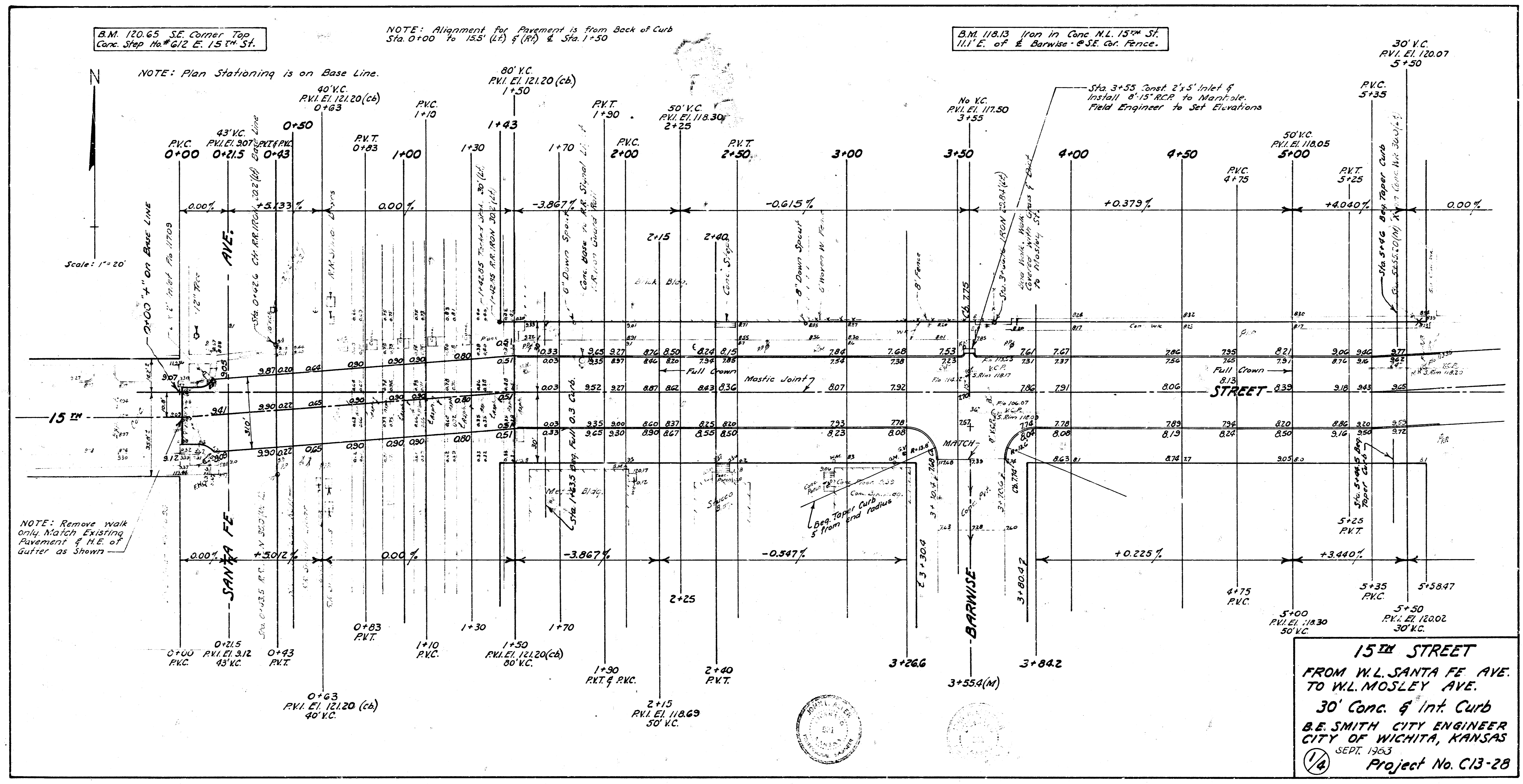

15th STREET
FROM W.L. SANTA FE AVE.
TO W.L. MOSLEY AVE.
30' Conc. & Int. Curb
B.E. SMITH CITY ENGINEER
CITY OF WICHITA, KANSAS
 SEPT. 1963
 Project No. C13-28

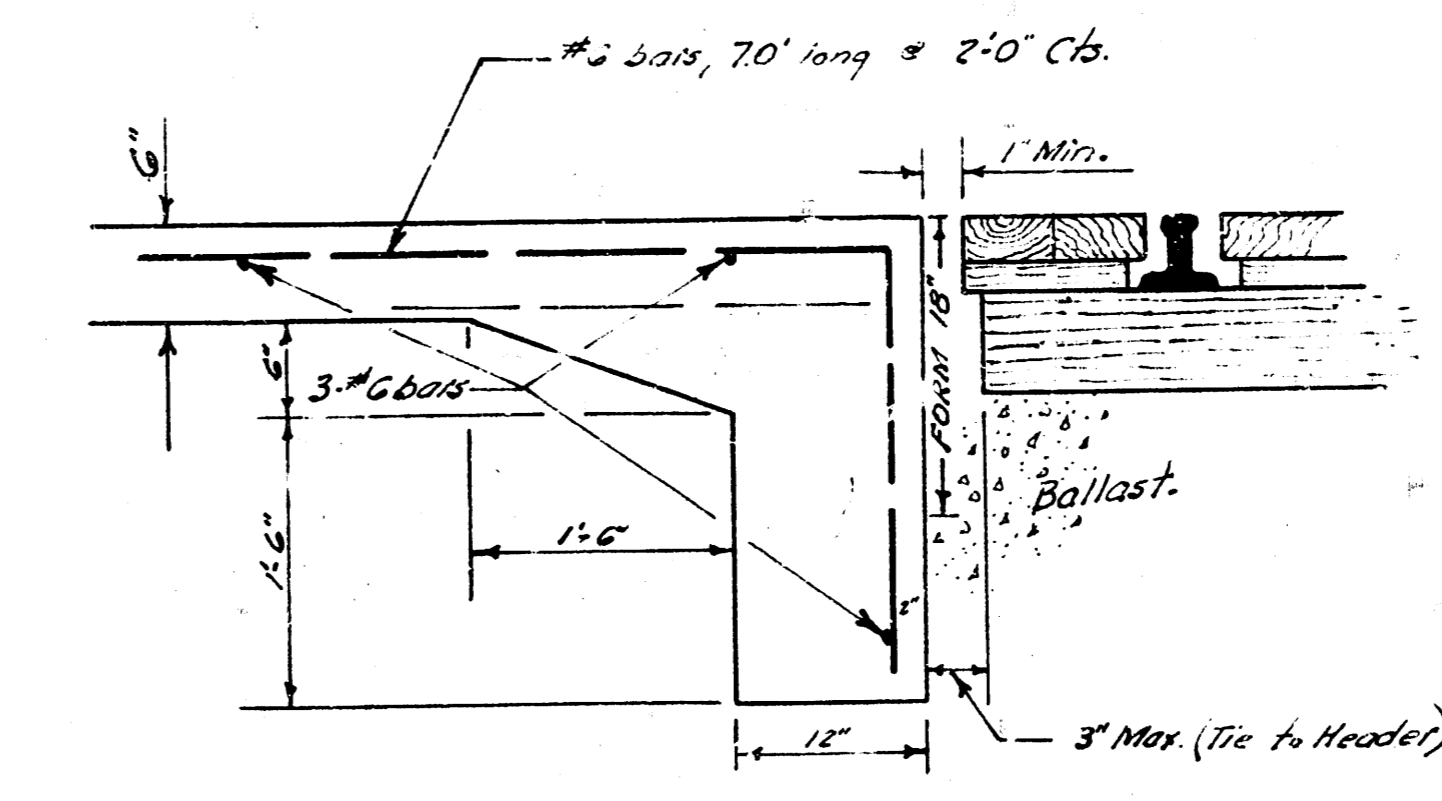
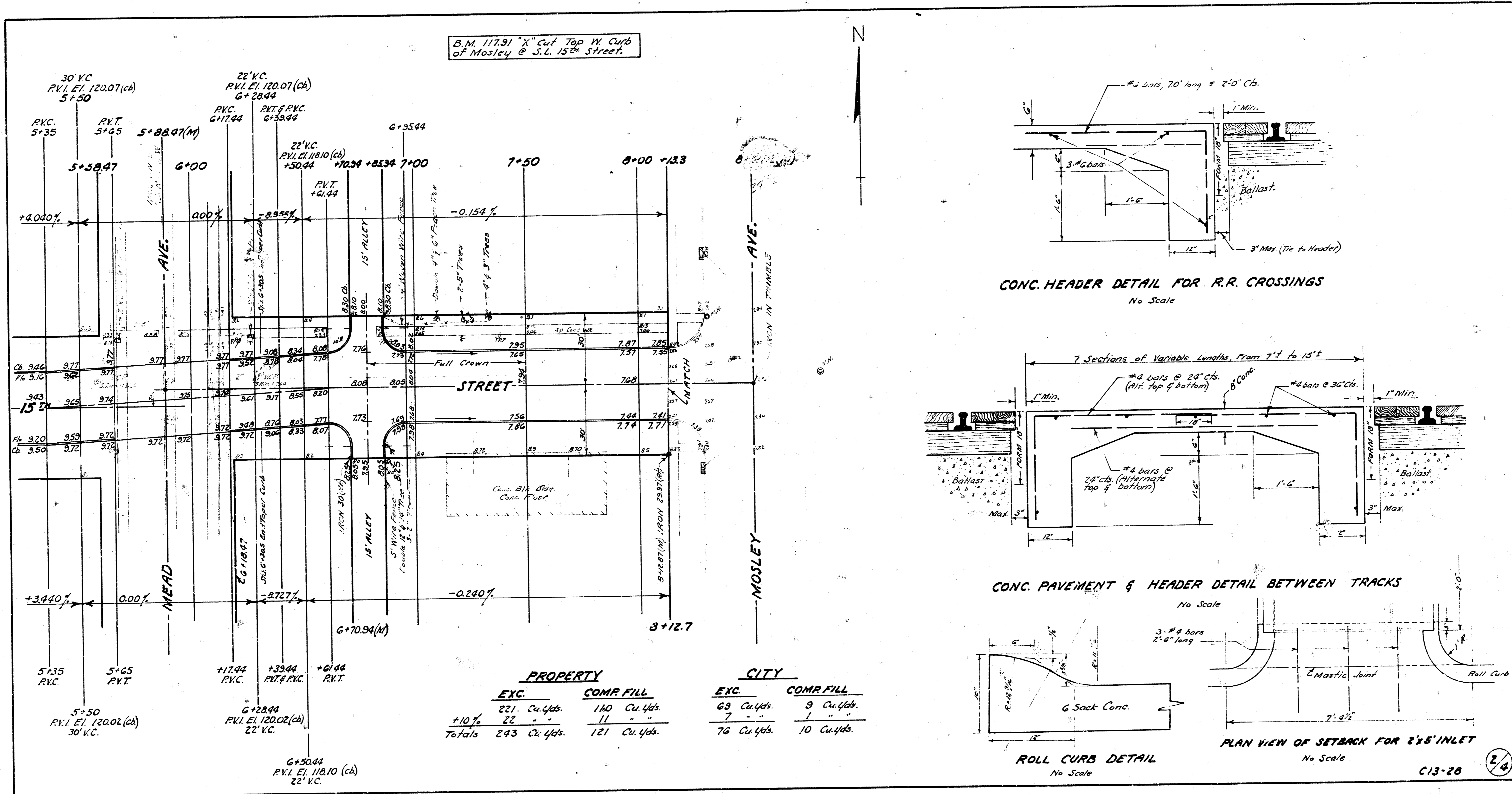

CONC. HEADER DETAIL FOR R.R. CROSSINGS
No Scale

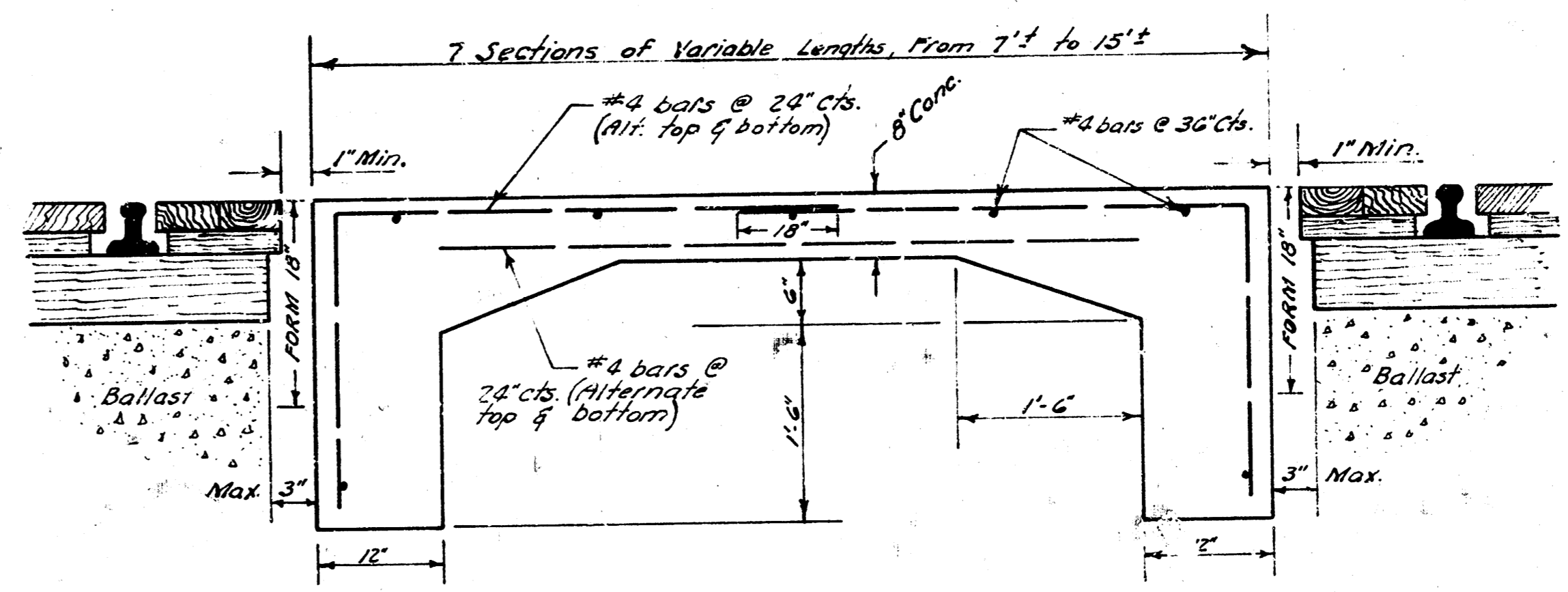

CONC. PAVEMENT & HEADER DETAIL BETWEEN TRACKS
No Scale

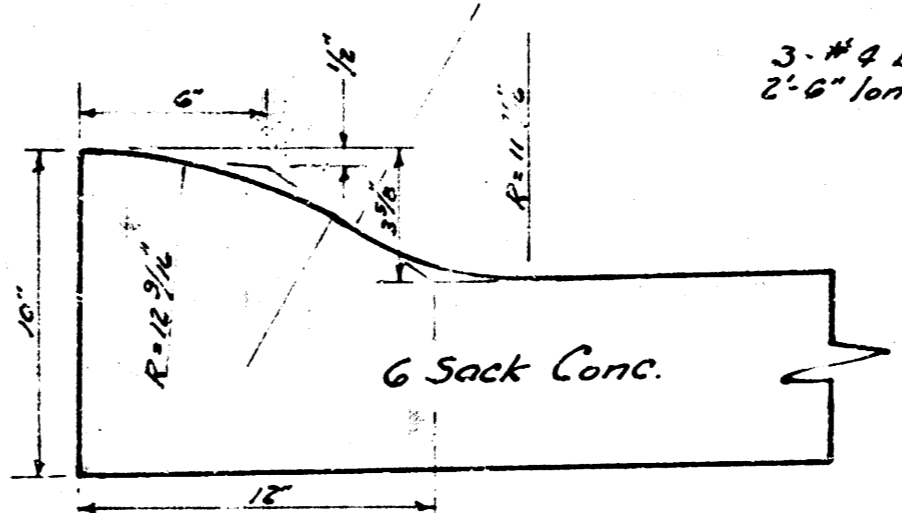

ROLL CURB DETAIL
No Scale

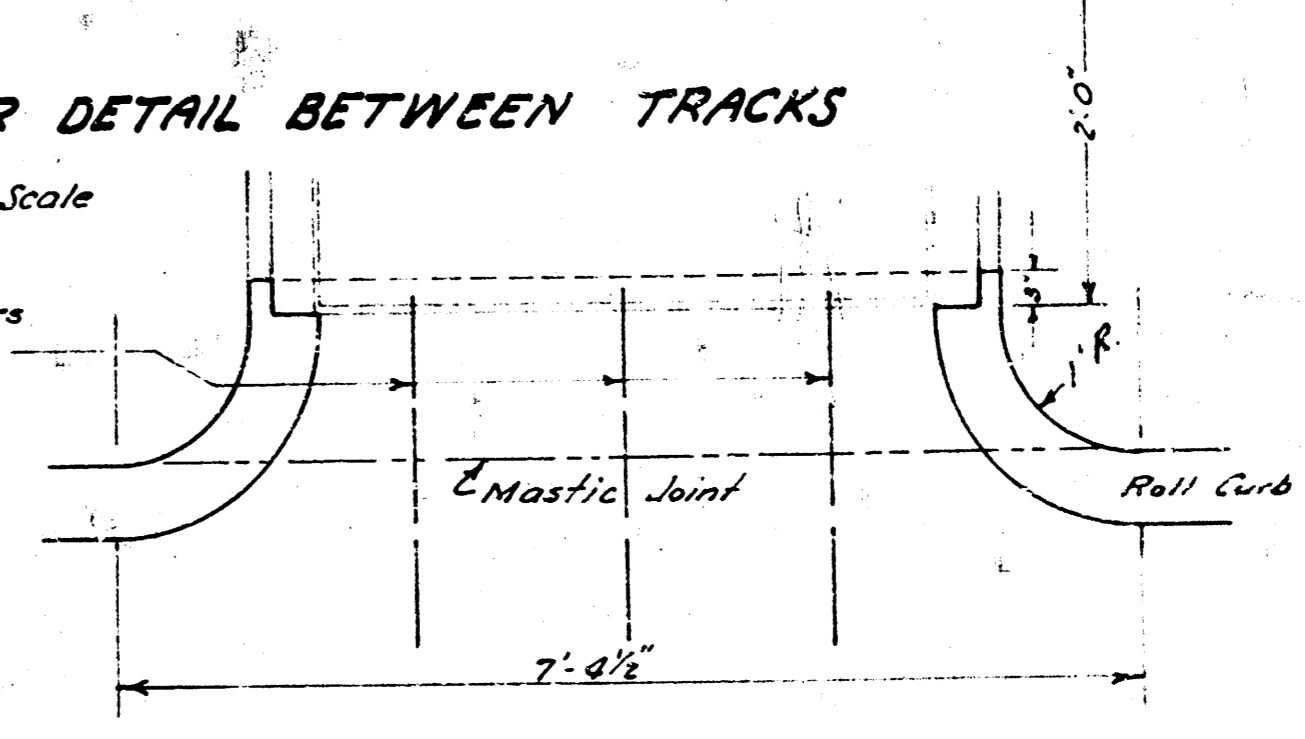

PLAN VIEW OF SETBACK FOR 2'x5' INLET
No Scale