

M&G-8

Excavation

Property
 55.4
 83.0
 80.6
 78.7
 92.2
 31.9
 419.3
 1106.41.7
 4616.2 cu yds.

BM. 142.12 "T" in Troy fire hydrant SE corner 15th of Volusia.

BM. 145.13 "B" in Blake back walk SW corner 15th of Erie.

Ties to iron monument - & Volusia Ave. of 15th St. West
 42.45' SE to "B" in Blake on walk East
 48.46' SW to "E" in Ed Tucker on walk West
 44.67' NE to "G" in Globe S and Drive. Radius No. 1802 Volusia.
 This iron monument possibly destroyed when intersection was paved.

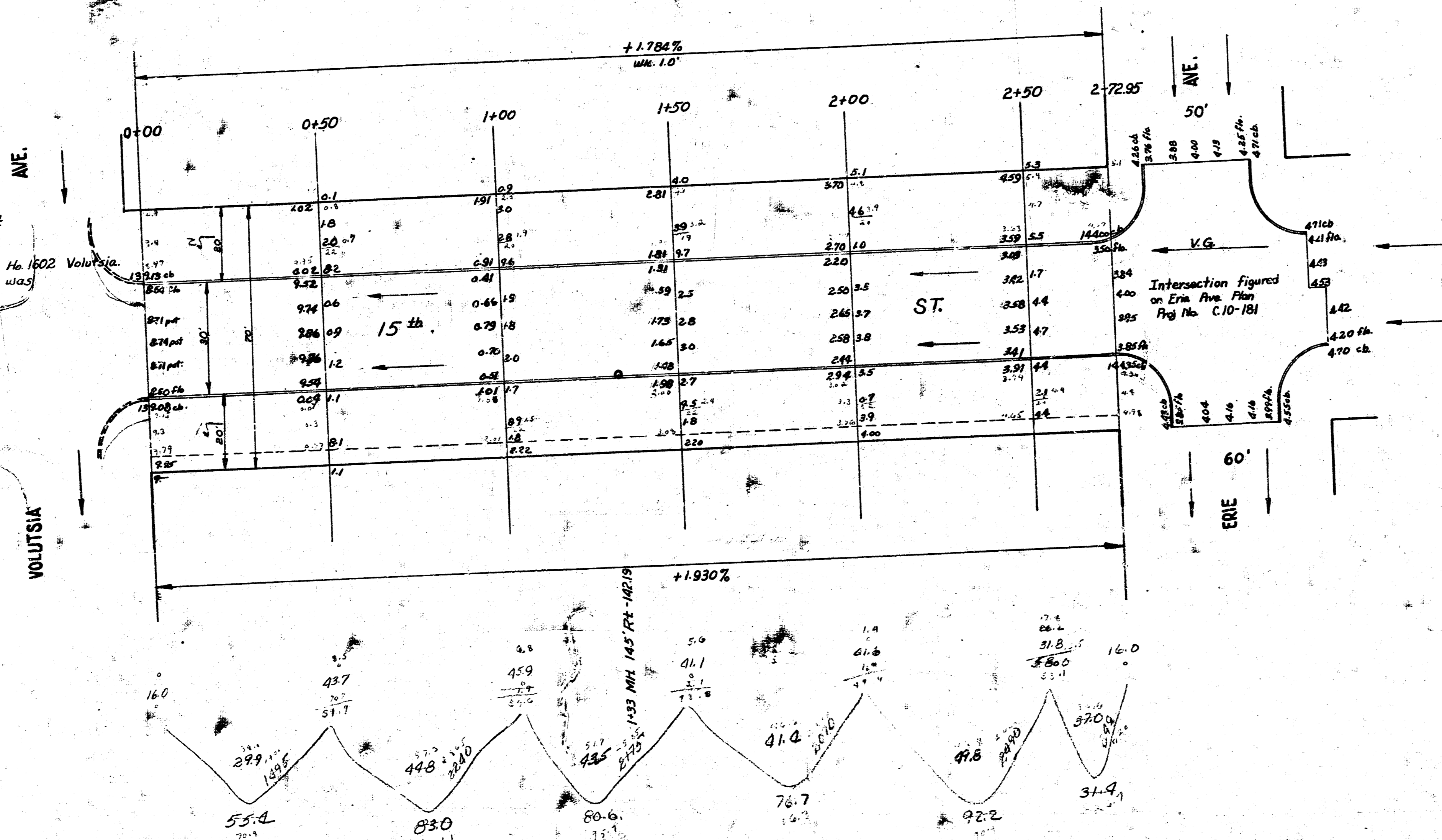

54

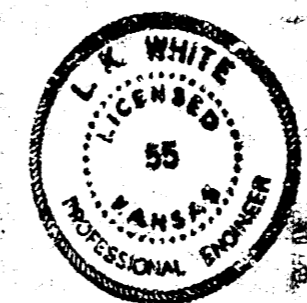

15TH ST.
 E. L. Volusia to E. L. Erie
 30' Conc. & Ch.
 CITY OF WICHITA, KANSAS
 L. K. WHITE CITY ENGINEER
 JAN. 1951 PROJ. NO. C10-176

4 2 1 1