

S.M. 120.58 R.R. SPIKE N.S. H.P. S.S. 15TH BETWEEN WAGON & CLARENCE
 BASE LINE IS A LINE EXTENDED FROM 6TH 15TH AT MERIDIAN TO A POINT AT 6TH 15TH CHARLES

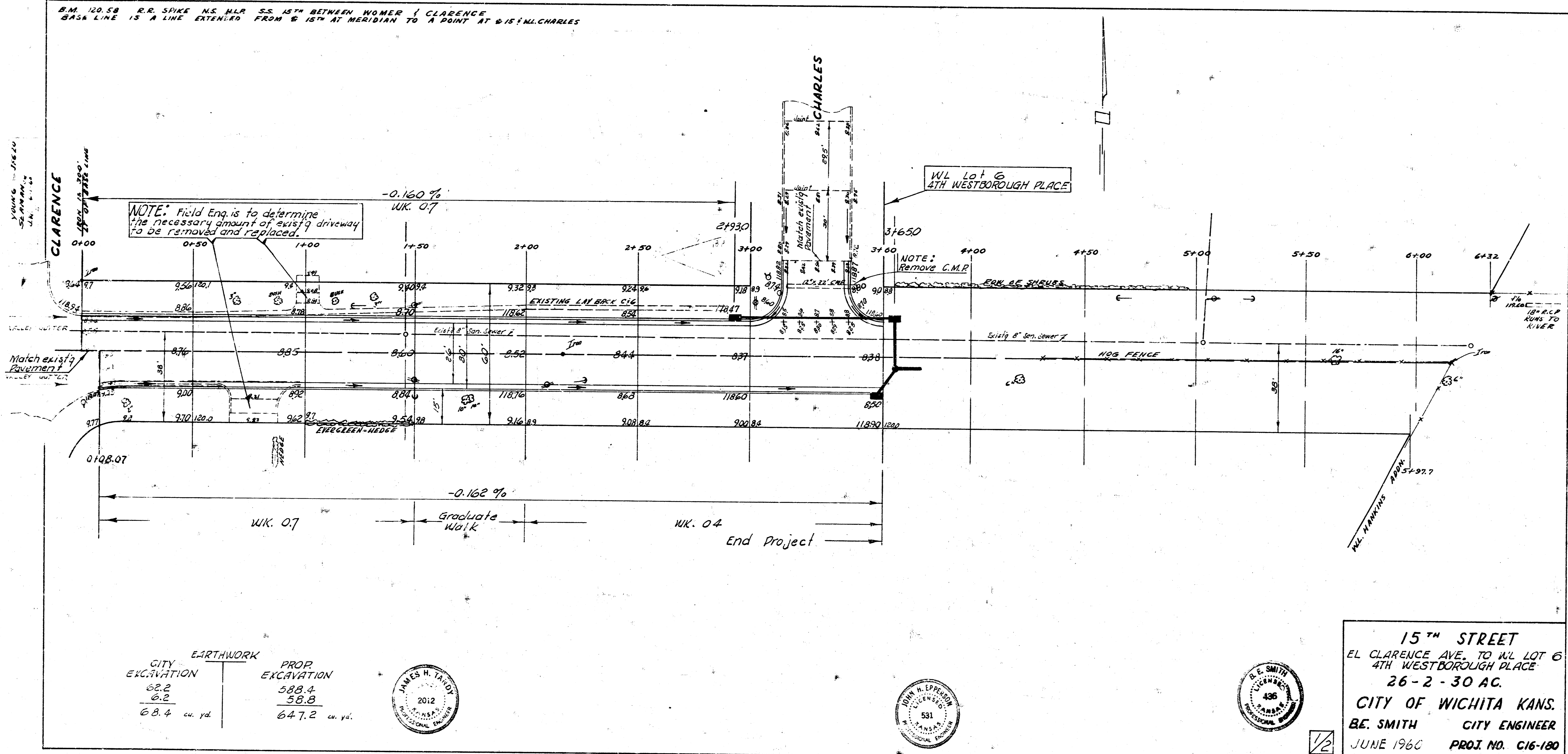

EARTHWORK	
CITY EXCAVATION	PROP. EXCAVATION
62.2	588.4
0.2	58.8
62.4 cu. yd.	647.2 cu. yd.

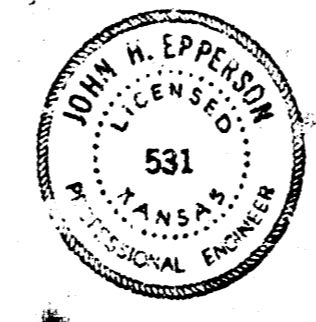

15TH STREET
 EL CLARENCE AVE. TO W.L. LOT 6
 4TH WESTBOROUGH PLACE
 26-2-30 AC.
 CITY OF WICHITA KANS.
 B.E. SMITH CITY ENGINEER
 JUNE 1966 PROJ. NO. C16-180

1/2

