

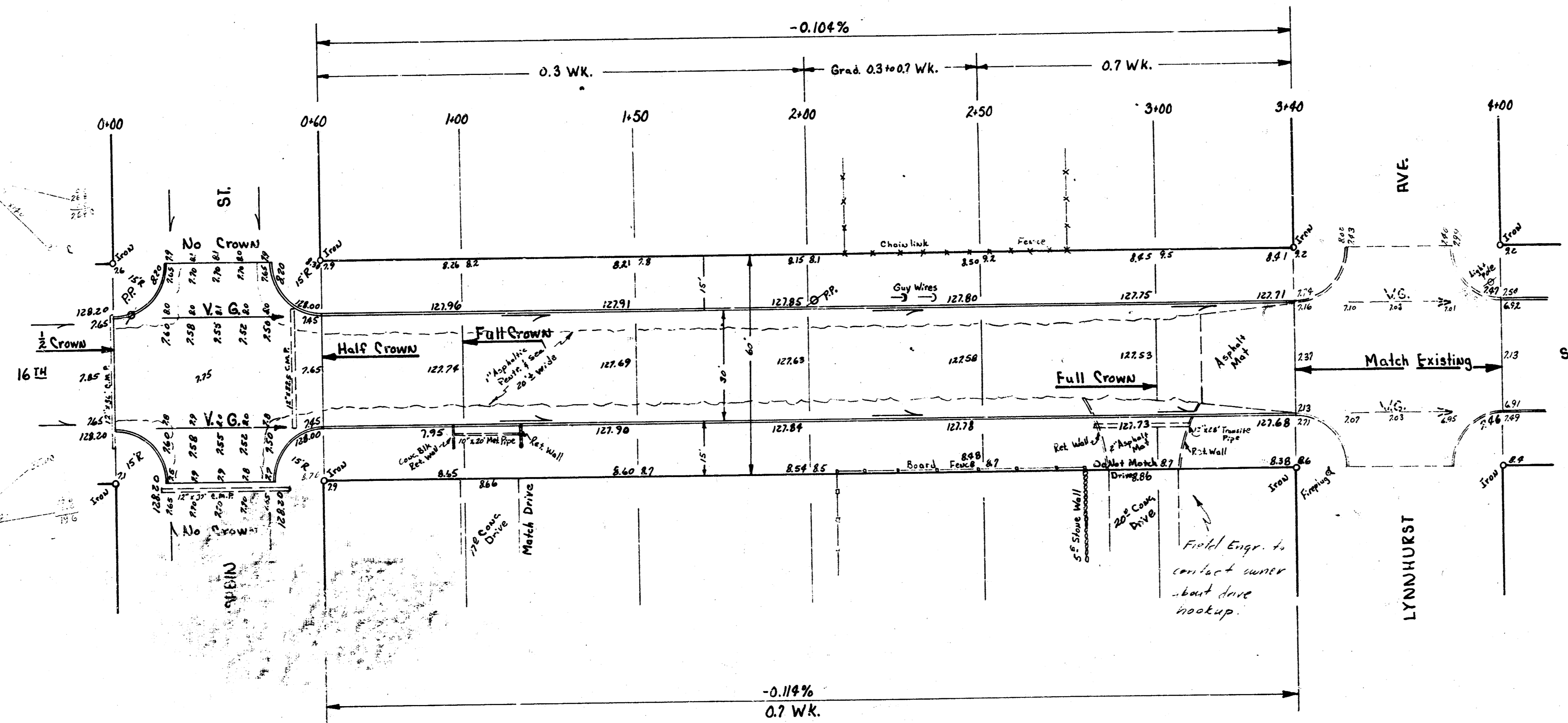

B.M. 130.45 S.E. cor. conc. perch no. 1653 Sabin  
 B.M. 133.67 Top. N.W. cor. rock handrail on perch 24' h. So. 17th on E. side Sabin  
 B.M. 130.80 N.E. cor. 1st step no. 1661 Lynnhurst  
 B.M. 130.39 Standard St. cor. 17th & West.  
 B.M. 131.62 N.W. cor. 1st step no. 4007 W. 16th St.

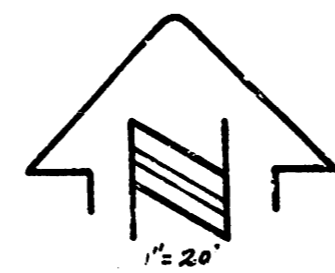

EARTHWORK		TOTALS	
CITY		PROP.	
277.9	Cu Yds Cut	378.2	Cu Yds Cut
277		37.0	
305.1	Cu Yds Cut	357.2	Cu Yds Cut
		52	Cu Yds Fill



**16TH ST.**  
 WL SABIN to EL. NEVADA  
 30" CONC. & CB.  
**CITY OF WICHITA, KANSAS**  
 B.E. SMITH CITY ENGINEER  
 DATE: MARCH, 1959 PROJ. NO. C18-195

1/3

Survey Memorandum of B.S. 114.87  
 P.L. 11. S. 11. 11. 11.  
 D. 11. 11. 11. 11. 11.