

B.M. 128.81 + 1" SQ. N. END - RADIAL ON CO. NE. 16TH E. MERIDIAN.
 B.M. 122.21 S.W. COR. CONC. STEP NO. 1718 N. ATHENIAN.

Scale 1" = 20'

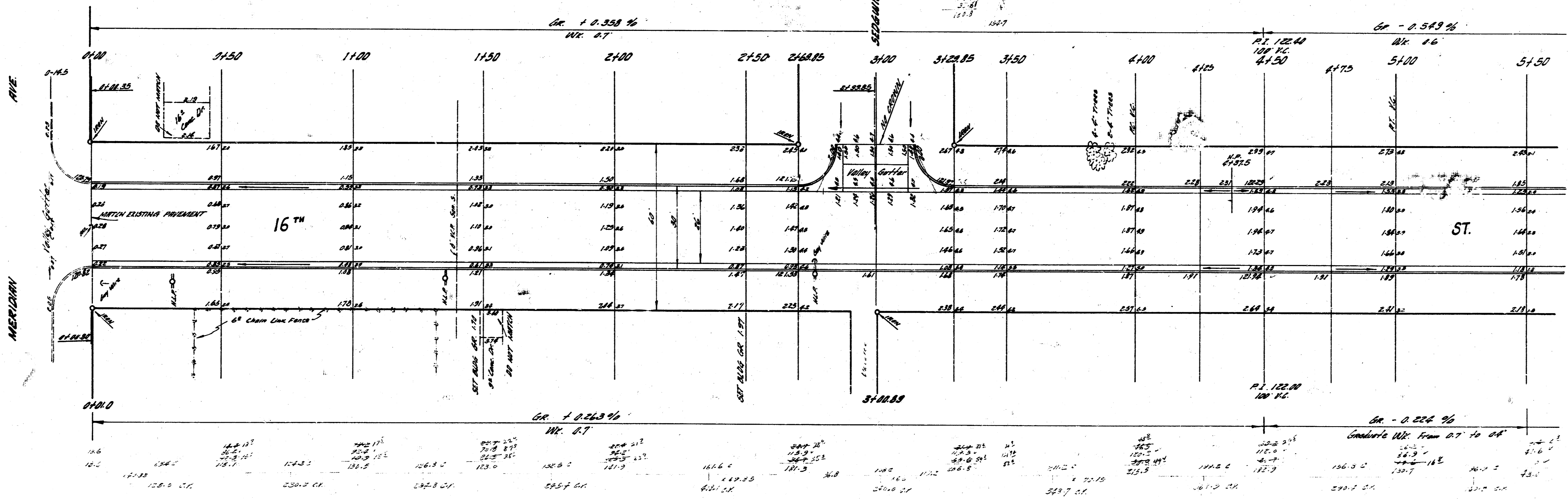

City of Wichita
 Planning Commission
 L.A. 11-19-59
 Checked by:

Station	Elevation	Station	Elevation	Station	Elevation	Station	Elevation
11.00	111.35	11.50	110.00	12.00	108.50	12.50	107.00
13.00	105.50	13.50	104.00	14.00	102.50	14.50	101.00
15.00	99.50	15.50	98.00	16.00	96.50	16.50	95.00
17.00	91.50	17.50	90.00	18.00	88.50	18.50	87.00
19.00	81.50	19.50	80.00	20.00	78.50	20.50	77.00
21.00	71.50	21.50	70.00	22.00	68.50	22.50	67.00
23.00	61.50	23.50	60.00	24.00	58.50	24.50	57.00
25.00	51.50	25.50	50.00	26.00	48.50	26.50	47.00
27.00	41.50	27.50	40.00	28.00	38.50	28.50	37.00
29.00	31.50	29.50	30.00	30.00	28.50	30.50	27.00
31.00	21.50	31.50	20.00	32.00	18.50	32.50	17.00
33.00	11.50	33.50	10.00	34.00	8.50	34.50	7.00
35.00	1.50	35.50	0.00	36.00	-1.50	36.50	-3.00

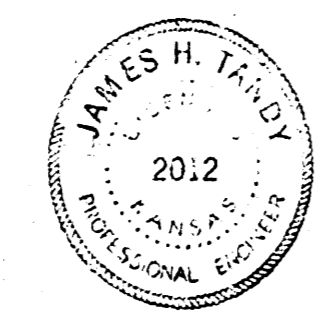

Property	City	Exception
1128 S. 22nd St.	Wichita	None
1130 S. 22nd St.	Wichita	None
1132 S. 22nd St.	Wichita	None



1/2

16TH ST.
 EL. MERIDIAN TO W.L. ATHENIAN
 26.2.30 AC.
 CITY OF WICHITA, KANSAS
 B.E. SMITH CITY ENGINEER
 DATE MAY 1959, PROJECT C-18-47



Scale 1" = 20'

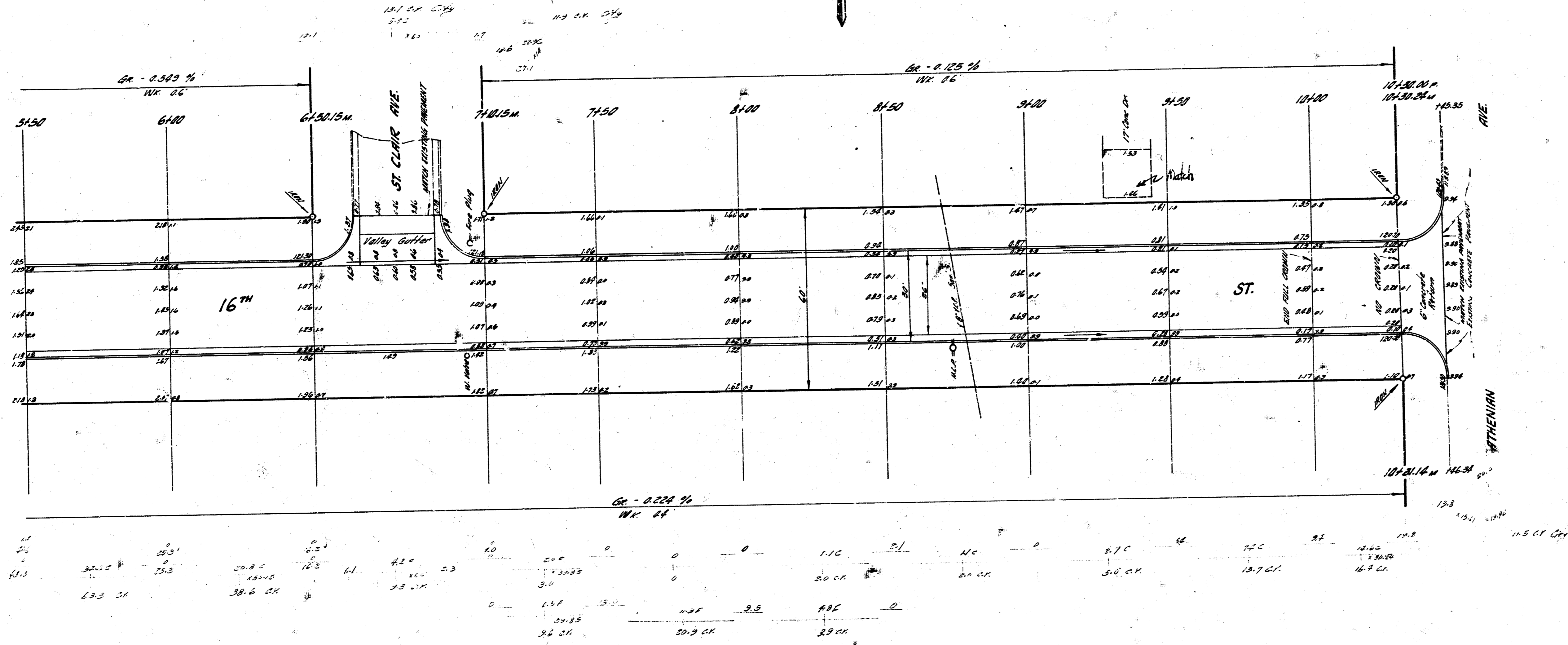

16TH ST.
EL. MARIZINI TO W.L. ATHLETIC
PROJ. NO. C.18-167