

B.M. 120²⁶ 2' IN LONG BR WKS SW COR 16TH & BURNS
 NOTE: STATIONING ON CENTER LINE

TOTALS

PROP.	CUT	FILL	CITY
148		151	151
18.6		20.9	20.9
2.0		22.4	22.4
22.6		14.2	14.2
		4.0	4.0
		99.9	99.9
		120	120
		297	297

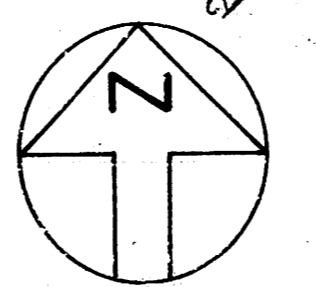
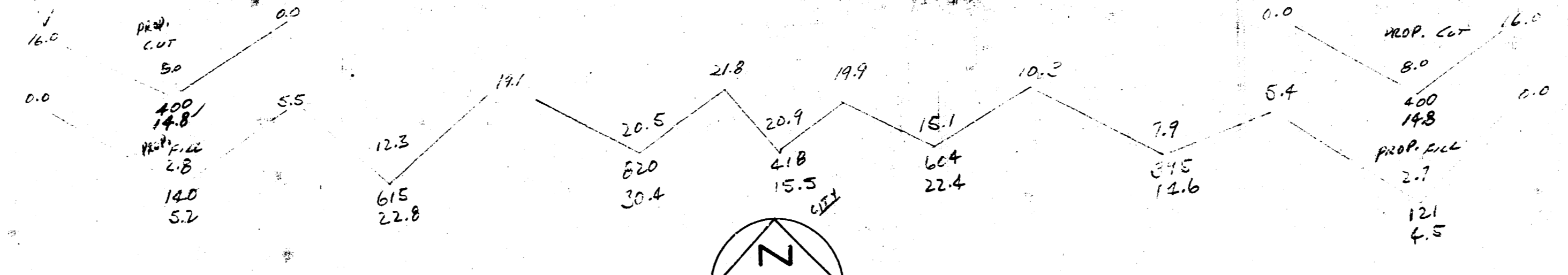
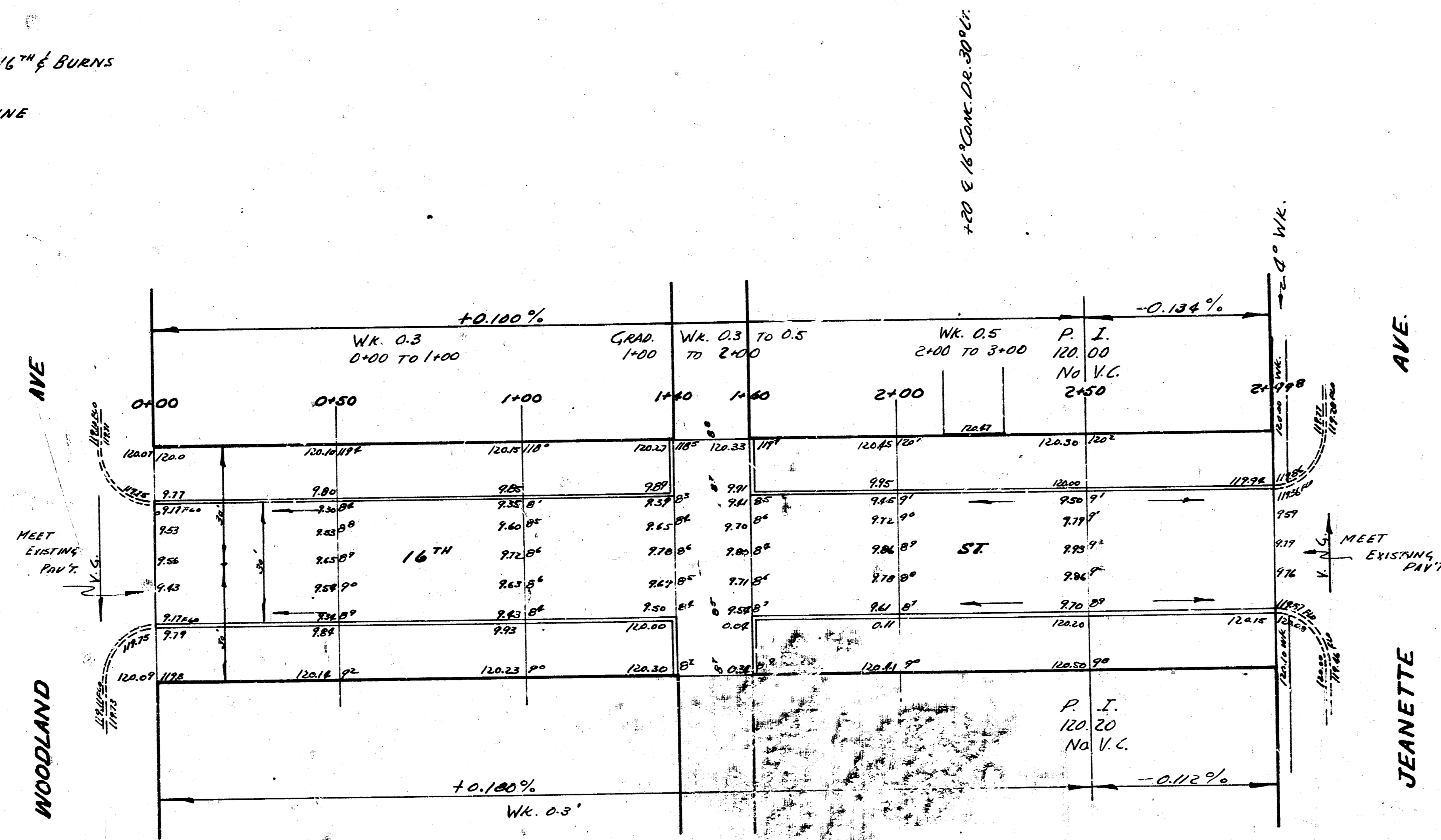

SCALE 1"=20'

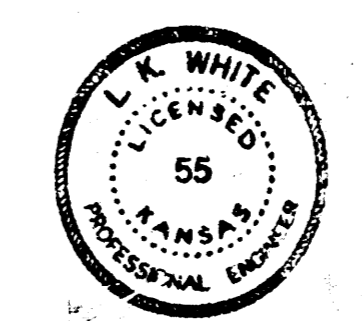

16TH ST.
 EL WOODLAND TO WL JEANETTE
 30' CONC & CG
 CITY OF WICHITA KANSAS
 LK WHITE CITY ENGINEER
 JAN. 1952 Proj. No. CII-280

B.M. 120.26 'L' in Lang, back Wk. S., S.W. Cor. 16th & Burns

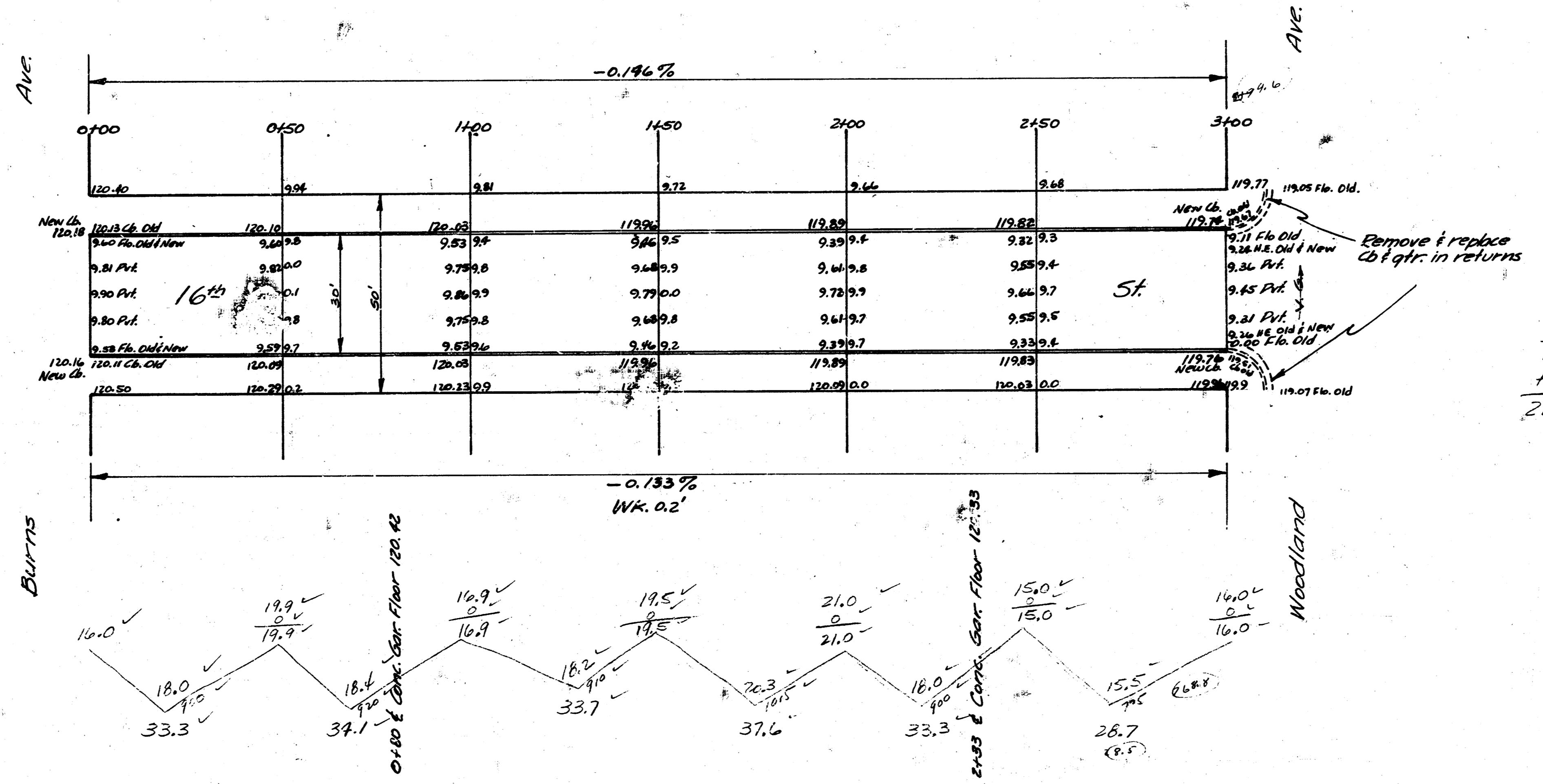

Prop.	City
33.3	0
34.1	
33.7	
37.6	
33.3	
28.7	
200.7	200.5
110.0	
220.8	cu Yds

16th St
 W.L. Woodland - E.L. Burns
 50' Conc. & Cb.
 City of Wichita, Kansas
 L.K. White City Engineer
 Aug. 1948 Proj. No. C18-130